

B 1' **6739**

SEQUENCE NO. (MDE USE ONLY)

STATE OF MARYLAND
PERMIT TO DRILL WELL
please print or type

STATE PERMIT NUMBER

HO-94-2155
fill in this form completely

Date Received (APA)

OWNER INFORMATION

8 MM DD YY 13
Highland Development
15 Last Name Owner First Name 34
P.O. Box 228
36 Street or RFD 55
Clarksdale Md. 21029
57 Town 70 State 72 Zip 76

B 3 LOCATION OF WELL

8 COUNTY **Howard** 21
23 SUBDIVISION **Knapp Property** 42
SECTION **43** LOT 48 50
Clenwood
52 NEAREST TOWN 71
MILES FROM TOWN (enter 0 if in town) **3** M 73 76 77 78

DRILLER INFORMATION

Joseph L. Mayne **MSD 024**
76 Driller's Name License No. 81
Joseph L. Mayne Well Drilling
77 Firm Name
5512 Ridge Rd. Mt. Airy 21771
78 Address
Joseph L. Mayne **3/1/99**
79 Signature Date

B 4 DIRECTION OF WELL FROM TOWN (CIRCLE BOX)

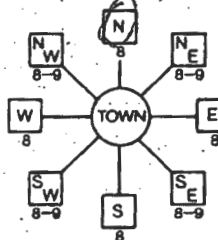

Street B
11 NEAR WHAT ROAD 30

ON WHICH SIDE OF ROAD (CIRCLE APPROPRIATE BOX)
NORTH
WEST EAST
SOUTH
34 **25** 37
DISTANCE FROM ROAD FT
ENTER FT OR MI 38 39

B 2 WELL INFORMATION
1 APPROX. PUMPING RATE (GAL. PER MIN.) 2 **5**
8 AVERAGE DAILY QUANTITY NEEDED (GAL. PER DAY) 12 **500**
14 20

TAX MAP: BLK: PARCEL

USE FOR WATER (CIRCLE APPROPRIATE BOX)

- DOMESTIC POTABLE SUPPLY & RESIDENTIAL IRRIGATION
- FARMING (LIVESTOCK WATERING & AGRICULTURAL IRRIGATION)
- INDUSTRIAL, COMMERCIAL, DEWATERING
- PUBLIC WATER SUPPLY WELL
- TEST, OBSERVATION, MONITORING
- GEO-THERMAL

NOT TO BE FILLED IN BY DRILLER HEALTH DEPARTMENT APPROVAL

HOWARD **13**
COUNTY NAME COUNTY NO.
STATE SIGNATURE INSERT S → 41
DATE ISSUED **03/23/99** **03/22/00**
43 MM DD YY 48 CO SIGNATURE EXP. DATE
NORTH GRID **544** 000 EAST GRID **0797** 000
50 55 57 63

APPROXIMATE DEPTH OF WELL **300** FEET 24 28
APPROXIMATE DIAMETER OF WELL **6** INCH NEAREST

SHOW MAJOR FEATURES OF BOX & LOCATE WELL WITH AN X → **7/14/99 9:30**
SOURCES OF DRILLING WATER
1. **WELL**
2.
3.
WRITE THE BOX NUMBER FROM THE MAP HERE
E **799**
N **544**
HO-94-2155
28' casing
25' open
8 bags grout
000 **7/14/99 BB**
000

METHOD OF DRILLING (circle one)

BORED (or Augered) JETTED Jetted & DRIVEN
30 AIR-ROTARY AIR-PERCussion ROTARY (Hydraulic Rotary)
37 CABLE REVERSE-ROTARY DRIVE-POINT
other

REPLACEMENT OR DEEPEMED WELLS (CIRCLE APPROPRIATE BOX)

- THIS WELL WILL NOT REPLACE AN EXISTING WELL
 - THIS WELL WILL REPLACE A WELL THAT WILL BE ABANDONED AND SEALED
 - THIS WELL WILL REPLACE A WELL THAT WILL BE USED AS A STANDBY-CONTACT LOCAL APPROVING AUTHORITY FOR POLICY ON STANDBY WELLS
 - THIS WELL WILL DEEPEMED AN EXISTING WELL
- PERMIT NUMBER OF WELL TO BE REPLACED OR DEEPEMED (IF AVAILABLE) 41 _____ 52

DRAW A SKETCH BELOW SHOWING LOCATION OF WELL IN RELATION TO NEARBY TOWNS AND ROADS AND GIVE DISTANCE FROM WELL TO NEAREST ROAD JUNCTION

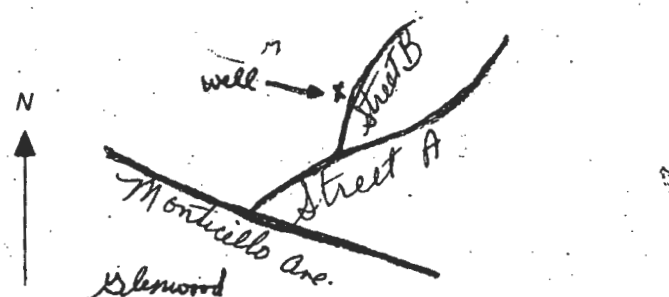

Not to be filled in by driller (MDE OR COUNTY USE ONLY)

APPROP. PERMIT NUMBER 54 _____ 63
PERMIT No. **HO-94-2155**
70 71 72 73 74 75 76 77 78 79

SPECIAL CONDITIONS
NOTE - APPROVING AUTHORITIES SHOULD USE SEPARATE SHEET IF NEEDED -

FORSYTHE ESTATES

N56°26'58" E

FOREST CONSERVATION EASEMENT B' 0.5± AC RETENTION

FOREST CONSERVATION EASEMENT R' J.3± AC RETENTION

LOT 39
50,000± S.F.

LOT 40
49,498± S.F.

LOT 41
50,000± S.F.

LOT 43
50,000± S.F.

LOT 29
49,263± S.F.

LOT 30
48,528± S.F.

LOT 28
49,077± S.F.

LOT 27
50,000± S.F.

LOT 26
50,000± S.F.

LOT 25
49,612± S.F.

LOT 24

STREET B' 10' BRL

MEDIAN ISLAND W/ BARRIER CURB

MEDIAN ISLAND W/ BARRIER CURB

MEDIAN ISLAND W/ BARRIER CURB

2nd cycle of this property OK to build

EX. HOUSE (TO BE RAZED)

EX. SHED (TO BE RAZED)

EX. BARN (TO BE RAZED)

EX. BARN TO BE RAZED

EX. BARN TO BE RAZED

EX. WELLS

EX. WELLS

EX. WELLS

EX. WELLS

EX. WELLS

EX. WELLS

EX. WELLS

EX. WELLS

EX. WELLS

EX. WELLS

EX. WELLS

EX. WELLS

EX. WELLS

EX. WELLS

EX. WELLS

EX. WELLS

EX. WELLS

EX. WELLS

EX. WELLS

EX. WELLS

EX. WELLS

EX. WELLS

EX. WELLS

EX. WELLS

EX. WELLS

EX. WELLS

EX. WELLS

EX. WELLS

EX. WELLS

EX. WELLS

EX. WELLS

EX. WELLS

EX. WELLS

EX. WELLS

EX. WELLS

EX. WELLS

EX. WELLS

EX. WELLS

EX. WELLS

EX. WELLS

EX. WELLS

EX. WELLS

EX. WELLS

EX. WELLS

EX. WELLS

EX. WELLS

EX. WELLS

EX. WELLS

EX. WELLS

EX. WELLS

EX. WELLS

EX. WELLS

EX. WELLS

EX. WELLS

EX. WELLS

EX. WELLS

EX. WELLS

EX. WELLS

EX. WELLS

EX. WELLS

EX. WELLS

EX. WELLS

EX. WELLS

EX. WELLS

EX. WELLS

EX. WELLS

EX. WELLS

EX. WELLS

EX. WELLS

EX. WELLS

EX. WELLS

EX. WELLS

EX. WELLS

EX. WELLS

EX. WELLS

EX. WELLS

EX. WELLS

EX. WELLS

EX. WELLS

EX. WELLS

EX. WELLS

EX. WELLS

EX. WELLS

EX. WELLS

EX. WELLS

EX. WELLS

EX. WELLS

EX. WELLS

EX. WELLS

EX. WELLS

EX. WELLS

EX. WELLS

EX. WELLS

EX. WELLS

EX. WELLS

EX. WELLS

EX. WELLS

EX. WELLS

EX. WELLS

EX. WELLS

EX. WELLS

EX. WELLS

EX. WELLS

EX. WELLS

EX. WELLS

EX. WELLS

EX. WELLS

EX. WELLS

EX. WELLS

EX. WELLS

EX. WELLS

EX. WELLS

EX. WELLS

EX. WELLS

EX. WELLS

EX. WELLS

EX. WELLS

EX. WELLS

EX. WELLS

EX. WELLS

EX. WELLS

EX. WELLS

EX. WELLS

EX. WELLS

EX. WELLS

EX. WELLS

EX. WELLS

EX. WELLS

EX. WELLS

EX. WELLS

EX. WELLS

EX. WELLS

EX. WELLS

EX. WELLS

EX. WELLS

EX. WELLS

EX. WELLS

EX. WELLS

EX. WELLS

EX. WELLS

EX. WELLS

EX. WELLS

EX. WELLS

EX. WELLS

EX. WELLS

EX. WELLS

EX. WELLS

EX. WELLS

EX. WELLS

EX. WELLS

EX. WELLS

EX. WELLS

EX. WELLS

EX. WELLS

EX. WELLS

EX. WELLS

EX. WELLS

EX. WELLS

EX. WELLS

EX. WELLS

EX. WELLS

EX. WELLS

EX. WELLS

EX. WELLS

EX. WELLS

EX. WELLS

EX. WELLS

EX. WELLS

EX. WELLS

EX. WELLS

EX. WELLS

EX. WELLS

EX. WELLS

EX. WELLS

EX. WELLS

EX. WELLS

EX. WELLS

EX. WELLS

EX. WELLS

EX. WELLS

EX. WELLS

EX. WELLS

EX. WELLS

EX. WELLS

EX. WELLS

EX. WELLS

EX. WELLS

EX. WELLS

EX. WELLS

EX. WELLS

EX. WELLS

EX. WELLS

EX. WELLS

EX. WELLS

EX. WELLS

EX. WELLS

EX. WELLS

EX. WELLS

EX. WELLS

EX. WELLS

EX. WELLS

EX. WELLS

EX. WELLS

EX. WELLS

EX. WELLS

EX. WELLS

EX. WELLS

EX. WELLS

EX. WELLS

EX. WELLS

EX. WELLS

EX. WELLS

EX. WELLS

EX. WELLS

EX. WELLS

EX. WELLS

EX. WELLS

EX. WELLS

EX. WELLS

EX. WELLS

EX. WELLS

EX. WELLS

EX. WELLS

EX. WELLS

EX. WELLS

EX. WELLS

EX. WELLS

EX. WELLS

EX. WELLS

EX. WELLS

EX. WELLS

EX. WELLS

EX. WELLS

EX. WELLS

EX. WELLS

EX. WELLS

EX. WELLS

EX. WELLS

EX. WELLS

EX. WELLS

EX. WELLS

EX. WELLS

EX. WELLS

EX. WELLS

EX. WELLS

EX. WELLS

EX. WELLS

EX. WELLS

EX. WELLS

EX. WELLS

EX. WELLS

EX. WELLS

EX. WELLS

EX. WELLS

EX. WELLS

EX. WELLS

EX. WELLS

EX. WELLS

EX. WELLS

EX. WELLS

EX. WELLS

EX. WELLS

EX. WELLS

EX. WELLS

EX. WELLS

EX. WELLS

EX. WELLS

EX. WELLS

EX. WELLS

EX. WELLS

EX. WELLS

EX. WELLS

EX. WELLS

EX. WELLS