

4/21/98 - 4/28
5/19/98 - 5/22

APPLICATION

PERCOLATION TESTING

HOWARD COUNTY HEALTH DEPARTMENT
BUREAU OF ENVIRONMENTAL HEALTH
3525-H ELLICOTT MILLS DRIVE/ELLICOTT CITY, MARYLAND 21043
TELEPHONE: 313-2640

56 LOTS
EXISTING HOUSE(S) - 4600-3607 LOTS
TO BE RECONSTRUCTED
4 DAYS FOR PERMITS
WET SEASON TESTING
4 DAY FOR FOLLOW-UP TESTING
WILL PROMPTLY SUBMIT FEES & IMPROVED PLAN/ APPLICATION (CW)
DISTRICT _____
DATE 4/13/98
A 59915
P _____

TO: THE COUNTY HEALTH OFFICER
ELLICOTT CITY, MARYLAND

I HEREBY APPLY FOR THE NECESSARY TEST PRIOR TO APPLICATION FOR PERMIT TO CONSTRUCT (OR RECONSTRUCT) A SEWAGE DISPOSAL SYSTEM.

PROPERTY OWNER ALFRED KNAPP

ADDRESS MONTICELLO AVE / SYKESVILLE PHONE 410-465-4242

AGENT OR PROSPECTIVE BUYER CLARK SPERRY / SDC GROUP

ADDRESS 8480 Ballman Not. PIKE PHONE 410-465-4244

PROPERTY LOCATION:

SUBDIVISION Knapp Prop. LOT NO. _____

ROAD AND DESCRIPTION M

TAX MAP _____ PARCEL # _____

SIZE OF LOT _____ TYPE BLDG. _____
(SINGLE FAMILY DWELLING OR COMMERCIAL)

THE SYSTEM INSTALLED UNDER THIS APPLICATION IS ACCEPTABLE ONLY UNTIL PUBLIC FACILITIES BECOME AVAILABLE. I FULLY UNDERSTAND THE FEE CONNECTED WITH THE FILING OF THIS PERC TEST APPLICATION IS NON-REFUNDABLE UNDER ANY CIRCUMSTANCES. I ALSO AGREE TO COMPLY WITH ALL M.O.S.H.A. REQUIREMENTS IN TESTING THIS LOT.

[Signature] SECURITY DIV.
(SIGNATURE OF APPLICANT)
STEVE SHIPLE - TSA

APPROVED BY _____ FOR _____ DATE _____

DISAPPROVED BY _____ FOR _____ DATE _____

HOLD PENDING FURTHER TESTS _____

REASONS FOR REJECTION OR HOLDING _____

PERCOLATION TEST PLAT/PRELIMINARY PLAT - TITLE OR I.D. # _____ DATE _____

SITE DEVELOPMENT PLAN/FINAL PLAT - TITLE OR I.D. # _____ DATE _____

THIS IS NOT A PERMIT

A59914/5
COUNTY#

KNAPP SUBD.

SOIL PROFILE
152 + 157

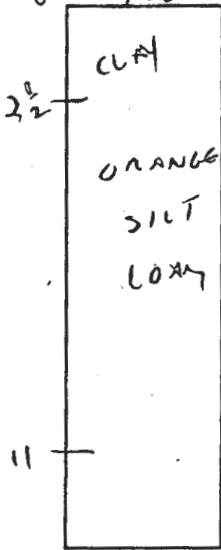

153 + 155

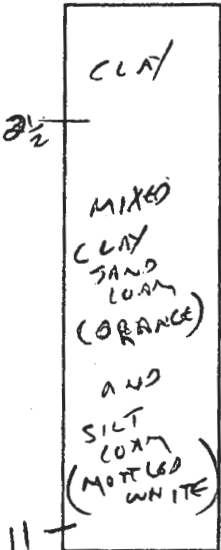

154

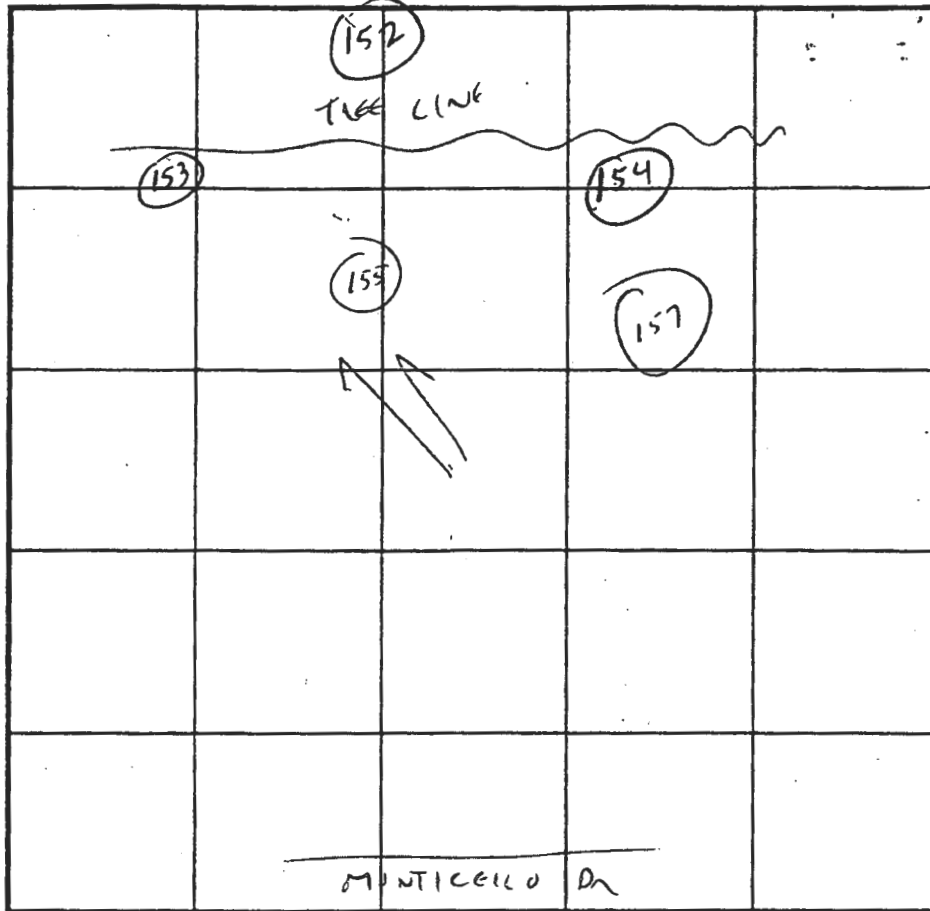
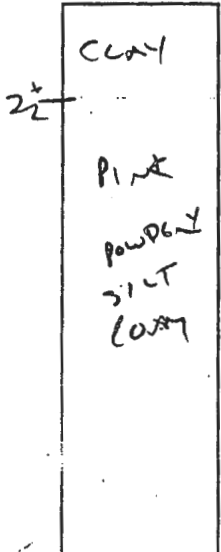

SOIL PROFILE

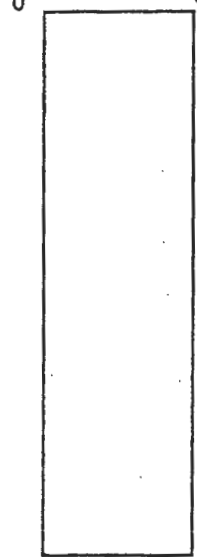

INDICATE NORTH - NAME ADJOINING ROADWAY AS BASE LINE.

DATE	TEST NO.	DEPTH	PRE-WET		TEST - 1" DROP		TIME
			START	STOP	START	STOP	
4/24/98	155	3	4:11	4:12	4:12	4:14	2 MIN
	153	3 1/2	4:13	4:15	4:15	4:17	2 MIN
	152	3 1/2	4:25	4:27	4:27	4:30	3 MIN ✓
	154	3 1/2	4:27	4:29	4:29	4:32	3 MIN ✓
	157	3	4:28	4:31	4:31	4:36	5 MIN

REMARKS # 153 + 155 - RE-EVALUATE - IRREGULAR CLAY LENSES

TYPE OF SOIL _____

TESTED BY C. Wilkins ALSO PRESENT SPERRY

TRENCH DESIGN DATA: AVERAGE PERCOLATION TIME _____ TRENCH WIDTH _____

INLET DEPTH _____ MAXIMUM BOTTOM DEPTH _____ SQ. FT./BEDROOM _____

4/21/98 - 4/28
5/19/98 - 5/22

APPLICATION

PERCOLATION TESTING

HOWARD COUNTY HEALTH DEPARTMENT
BUREAU OF ENVIRONMENTAL HEALTH
3525-H ELLICOTT MILLS DRIVE/ELLICOTT CITY, MARYLAND 21043
TELEPHONE: 313-2640

56 LOTS
EXISTING HOUSE(S) - 06223-5607165
TO BE RECONSTRUCTED
4 DAYS FOR PERMITS
WET SEASON TESTING
4 DAY 1500
FOLLOW-UP TESTING
WILL PROBABLY SUBMIT
FEEES & PLAN/
APPLICATION (CW)

A 59915
P _____

TO: THE COUNTY HEALTH OFFICER
ELLICOTT CITY, MARYLAND

4/21 - 4/24
&
5/19 - 5/22

DISTRICT _____
DATE 4/3/98

I HEREBY APPLY FOR THE NECESSARY TEST PRIOR TO APPLICATION FOR PERMIT TO CONSTRUCT (OR RECONSTRUCT) A SEWAGE DISPOSAL SYSTEM.

PROPERTY OWNER ALFRED KNAPP

ADDRESS MONTICELLO AVE. / SYKESVILLE PHONE 410-465-4242

AGENT OR PROSPECTIVE BUYER CLARK SPERRY / SOC GROUP

ADDRESS 3480 BALLHORN RD. PIKE PHONE 410-465-4244

PROPERTY LOCATION:

SUBDIVISION Knapp Prop. LOT NO. _____

ROAD AND DESCRIPTION M

TAX MAP _____ PARCEL # _____

SIZE OF LOT _____ TYPE BLDG. _____
(SINGLE FAMILY DWELLING OR COMMERCIAL)

THE SYSTEM INSTALLED UNDER THIS APPLICATION IS ACCEPTABLE ONLY UNTIL PUBLIC FACILITIES BECOME AVAILABLE. I FULLY UNDERSTAND THE FEE CONNECTED WITH THE FILING OF THIS PERC TEST APPLICATION IS NON-REFUNDABLE UNDER ANY CIRCUMSTANCES. I ALSO AGREE TO COMPLY WITH ALL M.O.S.H.A. REQUIREMENTS IN TESTING THIS LOT.

[Signature] SECURITY DIV.
(SIGNATURE OF APPLICANT)
STEVE SKIPPLE - TSA

APPROVED BY _____ FOR _____ DATE _____

DISAPPROVED BY _____ FOR _____ DATE _____

HOLD PENDING FURTHER TESTS _____

REASONS FOR REJECTION OR HOLDING _____

PERCOLATION TEST PLAT/PRELIMINARY PLAT - TITLE OR I.D. # _____ DATE _____

SITE DEVELOPMENT PLAN/FINAL PLAT - TITLE OR I.D. # _____ DATE _____

THIS IS NOT A PERMIT

A59914/5
COUNTY#

KNAPP SUBD.

SOIL PROFILE
156

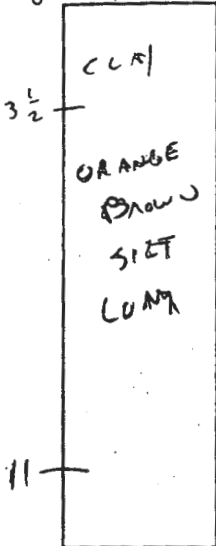

SOIL PROFILE
43-A

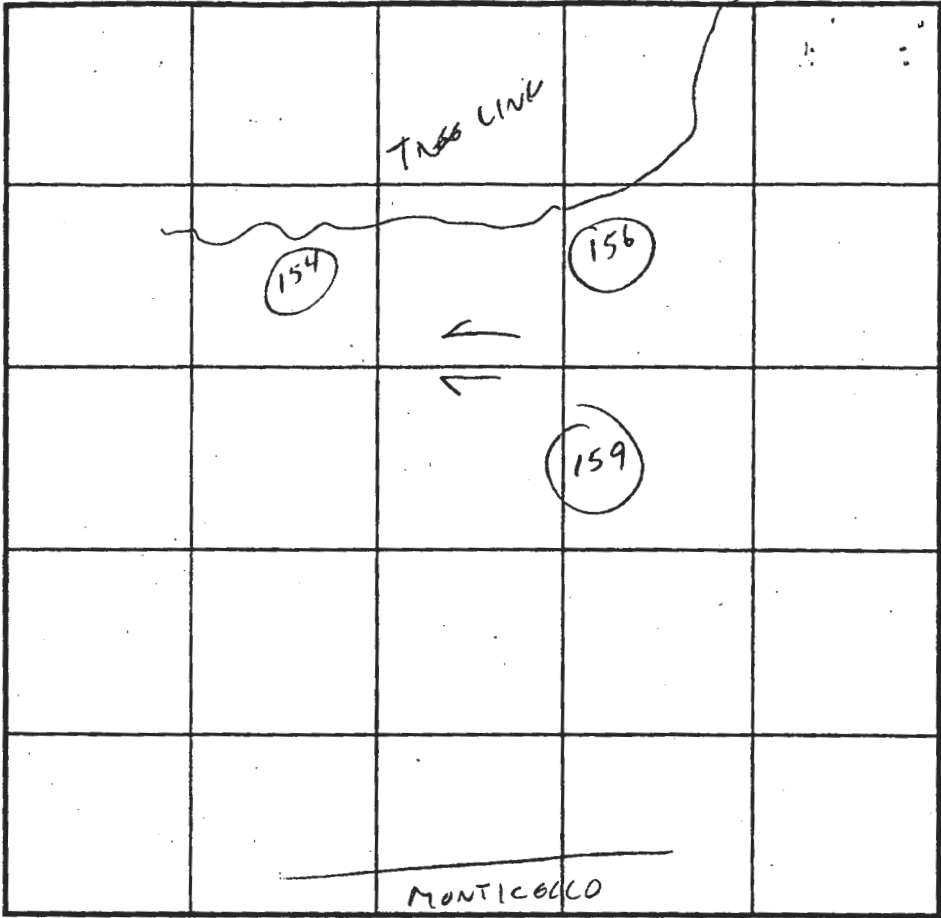
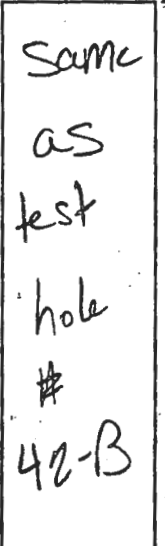

INDICATE NORTH - NAME ADJOINING ROADWAY AS BASE LINE.

159 + 158

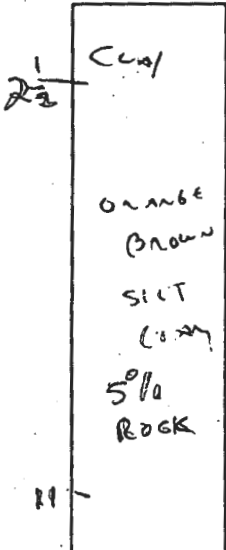

42-B

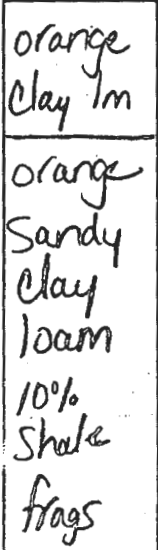

DATE	TEST NO.	DEPTH	PRE-WET		TEST - 1" DROP		TIME	
			START	STOP	START	STOP		
4/24/	156	4	4:30	4:32	4:32	4:35	3 MIN	
	159	4	4:33	4:35	4:35	4:37	2 MIN	
	158	3 1/2	4:35	4:36	4:36	4:37	2 MIN	
7.21.98	Lot 42-B	11.5'0	visual only - ok see profile					
	Lot 43-A	11.5'0	visual only - ok see profile					

REMARKS _____
 TYPE OF SOIL _____
 TESTED BY C. Wilho ALSO PRESENT SPEARY
 TRENCH DESIGN DATA: AVERAGE PERCOLATION TIME _____ TRENCH WIDTH _____
 INLET DEPTH _____ MAXIMUM BOTTOM DEPTH _____ SQ. FT./BEDROOM _____

(NON-BUILDABLE)
PRESERVATION
PARCEL 'B'
(ENVR. USE)

102,005± S.F.
OR 2.34± AC.

Handwritten: PERC LOT 5
12-8-98

