

LAND DESIGN ENGINEERING, INC.

PLANNING • ENGINEERING • SURVEYING

Ron (CW)

September 21, 1993

Mr. Craig Williams, Program Director
Bureau of Environmental Health
Howard County Health Department
3525 H Ellicott Mills Drive
Ellicott City, MD 21043

re: Lowe Property
Lots 1, 3 and 4

Woodmark Subdiv

Dear Mr. Williams:

Please find a completed Ground Water Appropriation Permit Application and Location Map for the above referenced subdivision.

Should you have any questions regarding the processing of the application, please contact our office.

Very truly yours,

LAND DESIGN ENGINEERING, INC.

Bruce D. Burton

Bruce D. Burton, P.E.
Vice President

BDB:dmm

Encs.

cc: Lois H. Lowe

APPLICATION FOR A PERMIT TO APPROPRIATE AND USE WATERS OF THE STATE

Water Resources Administration
Water Supply Section
Tawes Office Building
Annapolis, Maryland 21401

Surface Water Groundwater New Application Change in Existing Permit

Number _____

APPLICATION	LOIS H. LOWE (Owner's Name)		(410) 531-6732 (Telephone Number)	
	12325 BENSON BRANCH ROAD (Owner's Address)	ELLICOTT CITY (Street)	MD (State)	21042 (Zip Code)

WITHDRAWAL GROUNDWATER <p>Appropriate and use a yearly average of <u>650</u> gallons per day, <small>[total annual use ÷ 365 days]</small> and <u>1100</u> gallons <small>[highest total monthly use ÷ days in month]</small> for the average day of the maximum month, from <u>3</u> well(s) having a diameter of <small>[number]</small> <u>6</u> inches, and a depth of <small>[estimate]</small> <u>700</u> ft. <small>[estimate]</small></p>	SURFACE WATER Appropriate and use a yearly average of _____ gallons per <small>[total annual use ÷ 365 days]</small> day, and a maximum use of _____ gallons in any one day, from: _____ <small>[name of stream]</small> _____ <small>[exact location of withdrawal]</small>
--	---

PROJECT LOCATION		
SOUTH SIDE OF BENSON BRANCH ROAD 2400' E. WEST OF CARROLL MILL ROAD <small>[Location - be specific]</small>		
County <u>HOWARD</u>	Subdivision or town <u>WOODMARK SBL</u> <small>[Location - be specific]</small>	Phone number <u>(410) 531-6732</u>
Name and type of business <u>THREE (3) PROPOSED SINGLE FAMILY DETACHED DWELLINGS (LOTS 1, 3 AND 4)</u>		

ALL APPLICATIONS MUST INCLUDE A COPY OF LOCATION MAP SHOWING THE PROJECT SITE

PURPOSE The water will be used for: <input type="checkbox"/> Community Water Supply <input type="checkbox"/> Non-Potable supply (sanitary uses, not for drinking water) <input checked="" type="checkbox"/> Potable Supply (drinking water, etc.) <input type="checkbox"/> Cooling Water <input type="checkbox"/> Irrigation <input type="checkbox"/> Process Water <input type="checkbox"/> Other _____ <small>[explain]</small>	WASTEWATER TREATMENT AND DISPOSAL <input type="checkbox"/> Public Sewer _____ <small>[name of system]</small> <input checked="" type="checkbox"/> Groundwater <input checked="" type="checkbox"/> Subsurface (tilefield, seepage pit, etc.) <input type="checkbox"/> Spray Irrigation <input type="checkbox"/> Other, explain _____ <input type="checkbox"/> Surface Water _____ <small>[name of stream]</small> Discharge Permit # _____ or applied for _____
---	---

SIGNATURE Please sign here <u>BRUCE D. BURTON PE</u> <small>[signature]</small> <u>BRUCE D. BURTON PE (OWNERS AGENT) 9/15/93</u> <small>[please print name, title, and date here]</small>	THIS APPLICATION WILL NOT BE PROCESSED WITHOUT A SIGNATURE AND A LOCATION MAP
--	--

REVIEW BY COUNTY HEALTH DEPARTMENT OR DESIGNATED AGENCY		
THIS SECTION NOT TO BE COMPLETED BY APPLICANT		
Is this Project consistent with the County Water and Sewerage Plan and local planning and zoning?		
<input type="checkbox"/> YES <input type="checkbox"/> NO, explain _____		
Signature of county representative _____ <small>[signature]</small>	_____ <small>[title]</small>	_____ <small>[date]</small>

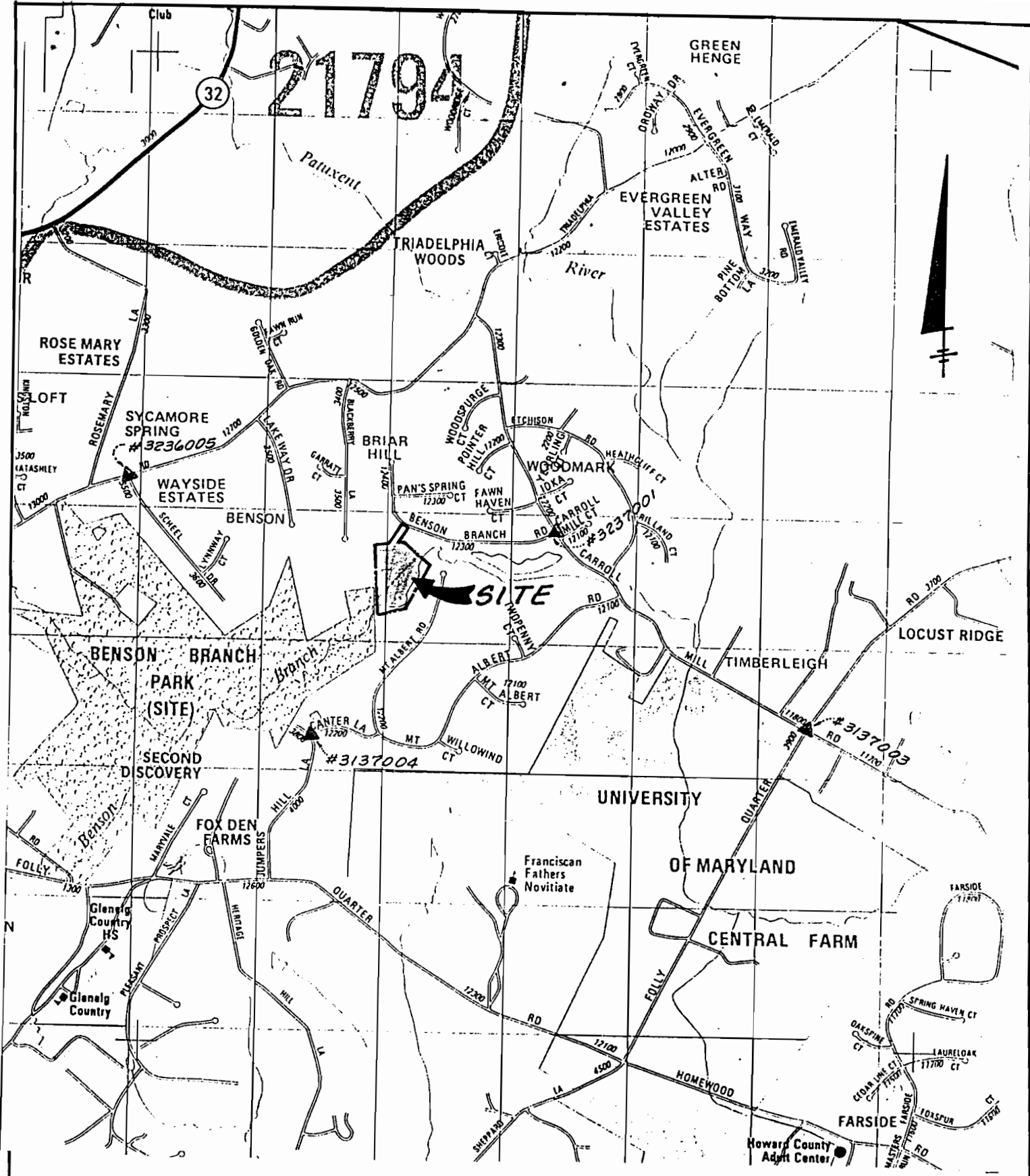

LAND DESIGN ENGINEERING, INC.

Title: *Location Map*
LOWE PROPERTY

10820 Gullford Road • Suite 210
Jesseup • Maryland 20784

(301)864-6284
(301)860-0034

Date:
May, 1993

Drawn:
LDE

ADC Map 10
Grid E-9

Scale:
1" = 2000'

LDE Job No.:
91-213

Sheet:
Figure 1