

LAYOUT _____ INSP 4 _____

INSP 2 _____ INSP 5 _____

INSP 3 _____ INSP 6 _____

ISSUE DATE: 7/25/2013

PERMIT

P 523740

APPROVAL DATE: 8/14/2014

A _____

ON-SITE SEWAGE DISPOSAL SYSTEM HOWARD COUNTY HEALTH DEPARTMENT BUREAU OF ENVIRONMENTAL HEALTH

_____ IS PERMITTED TO INSTALL ALTER

ADDRESS: _____ PHONE NUMBER: _____

SUBDIVISION: Owens Property LOT NUMBER: 14

ADDRESS: 6831 Green Hollow Way PROPERTY OWNER: _____

SEPTIC TANK CAPACITY (GALLONS): _____ OUTLET BAFFLE FILTER REQUIRED

PUMP CHAMBER CAPACITY (GALLONS): _____ COMPARTMENTED TANK REQUIRED

NUMBER OF BEDROOMS: _____

SQUARE FEET PER BEDROOM: _____

LINEAR FEET OF TRENCH REQUIRED: _____

TRENCHES:	Trench to be _____ feet wide. Inlet _____ feet below original grade. Bottom maximum depth _____ feet below original grade. Effective area begins at _____ feet below original grade. _____ feet of stone below distribution pipe.
LOCATION:	_____
NOTES:	_____

PLANS APPROVED: _____ DATE: _____

- NOTE: PERMIT VOID AFTER 2 YEARS
- NOTE: CONTRACTOR RESPONSIBLE FOR SCHEDULING A PRE-CONSTRUCTION INSPECTION FOR ALL INSTALLATIONS
- NOTE: WATERTIGHT SEPTIC TANKS REQUIRED
- NOTE: ALL PARTS OF SEPTIC SYSTEM SHALL BE 100 FEET FROM ANY WATER WELL
- NOTE: MANHOLE RISERS REQUIRED ON ALL SEPTIC TANKS AND PUMP CHAMBERS UNLESS SPECIFICALLY AUTHORIZED

NEITHER THE HOWARD COUNTY COUNCIL NOR THE HEALTH DEPARTMENT IS RESPONSIBLE FOR THE SUCCESSFUL OPERATION OF ANY SYSTEM PERMITTEE RESPONSIBLE FOR OBTAINING FINAL APPROVAL ON THIS PERMIT CALL 410-313-2640 FOR INSPECTION OF SEPTIC SYSTEM

NOT TO SCALE

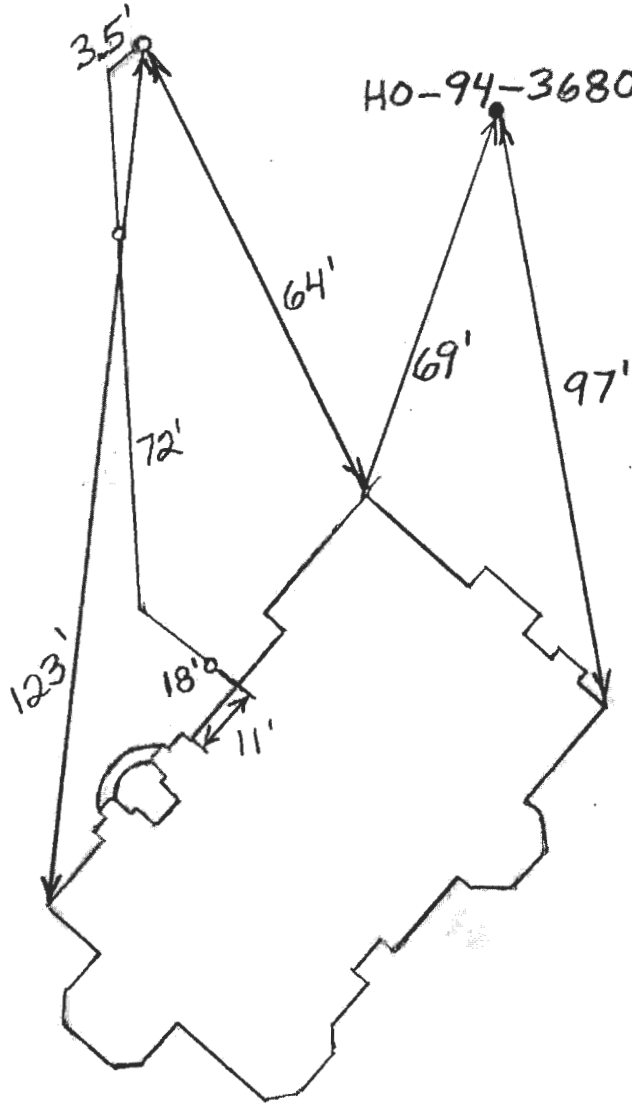

ROAD NAME

TRENCH/DRAINFIELD DATA		
WIDTH	INLET	BOTTOM
_____	_____	_____
_____	_____	_____
_____	_____	_____
_____	_____	_____
_____	_____	_____
_____	_____	_____
_____	_____	_____

SEPTIC TANK DATA	
SEPTIC TANK 1 LEVEL	_____
MANUFACTURER	_____
CAPACITY	_____ GAL
SEAM LOC	_____
TANK LID DEPTH	_____
BAFFLES	_____
BAFFLE FILTER	_____
MANHOLE LOC	_____
6" PORT LOC	_____
WATERTIGHT TEST	_____
SLOTTED	_____
DATE ON LID	_____
PUMP/SEPTIC TANK LEVEL	_____
MANUFACTURER	_____
CAPACITY	_____ GAL
SEAM LOC	_____
TANK LID DEPTH	_____
BAFFLES	_____
BAFFLE FILTER	_____
MANHOLE LOC	_____
6" PORT LOC	_____
WATERTIGHT TEST	_____
SLOTTED	_____
DATE ON LID	_____

PRE-CONSTRUCTION:

INSTALLATION: 8/13/2014 House connection made (BB)

8/14/2014 x 2 Connection from house to 8" gravity line made (BB)

FINAL INSPECTOR B. Baker DATE OF APPROVAL 8/14/2014

Clerk of the Circuit Court for
Howard County
Land Records/Licensing

The Thomas Dorsey Building
9250 Bendix Road
Columbia, MD 21045
410-313-5850

LR Agreement Recording Fee
1x 20.00

Name: patel
Ref: 32

LR - Agreement Surcharge
1x 40.00 40.00

SubTotal: 60.00
Total: 60.00

CRD-Credit 60.00
Credit Card Confirmation : 31270d

04/13/2017 13:37
#8165446 /1247/109

CC13-LH

Thank you for visiting us today~



Bureau of Environmental Health

8930 Stanford Boulevard, Columbia, MD 21045

Main: 410-313-2640 | Fax: 410-313-2648

TDD 410-313-2323 | Toll Free 1-866-313-6300

www.hchealth.org

Facebook: www.facebook.com/hocohealth

Twitter: HowardCoHealthDep

Maura J. Rossman, M.D., Health Officer

AGREEMENT FOR APPROVAL OF AN INDIVIDUAL DRINKING WELL WITH AN ON-SITE TREATMENT SYSTEM

This agreement is entered into by and between the Howard County Health Department ("the Health Department") and BHUPENDRA PATEL AND VARSHA PATEL ("the Owner").

WHEREAS, the Owner owns a tract of land at street address 6831 GREEN HOLLOW LANE
HIGHLAND, MD 20777 and the deed and subdivision plat of the property is recorded
among the Land Records of Howard County, Maryland, Tax Map # 040, Block # 04, Parcel #
44, Deed Reference # 13240/ and Tax Account # 05-440475 ("the Property").
00203

WHEREAS, the Property lacks an available public drinking water source and is required to have an individual well as the source of drinking water for the residence of the property.

WHEREAS, the Owner has installed a residential drinking well under well permit HO-44-3680 that has been tested by the Health Department (or a private laboratory certified to perform testing) for radionuclide particles. The results of the tests have shown that the gross alpha particle content and/or the gross beta particle content and/or the combined radium 226/228 levels exceeds the standards of 15 picocuries per liter (pCi/L), 4 millirems per year (mrem/yr) and/or 5pCi/L respectively.

WHEREAS, The Maryland Department of the Environment (MDE) has promulgated rules and regulations under which a Certificate of Potability may be issued and has delegated the authority to issue such Certificate to the Health Department.

WHEREAS, MDE regulations permit the Health Department to issue as a special condition, a permanent deviation to the Certificate of Potability for individual wells where treatment has been installed to meet the maximum contaminate levels (MCL's) for radionuclides.

WHEREAS, MDE has determined that radium can be effectively removed from the drinking water by the use of treatment devices (e.g., ion exchange or reverse osmosis).

WHEREAS, the Owner is requesting that the Health Department issue a Certificate of Potability contingent upon installation and maintenance of a water treatment device to reduce radionuclides.

WHEREAS, neither the Owner nor the Health Department has knowledge of an alternative safe source of water for the Property.

NOW THEREFORE, the parties have agreed to the following terms and conditions:

1. The Owner will record this Agreement among the Land Records of Howard County, Maryland and provide confirmation to the Health Dept.
2. The Owner agrees to install and maintain a water treatment device, which effectively reduces the gross alpha, gross beta and radium levels to below their respective MCL. The Health Department

