

**Bureau of Environmental Health**  
 8930 Stanford Boulevard, Columbia, MD 21045  
 Main: 410-313-2640 | Fax: 410-313-2648  
 TDD 410-313-2323 | Toll Free 1-866-313-6300  
[www.hchealth.org](http://www.hchealth.org)  
 Facebook: [www.facebook.com/hocohealth](http://www.facebook.com/hocohealth)

Maura J. Rossman, M.D., Health Officer

RECEIPT DATE: 10/30/18      **ONSITE SEWAGE DISPOSAL SYSTEM**      P 564052

APPROVAL DATE: 01/10/2019      **PERMIT:**      **REPAIR**      A \_\_\_\_\_

PROPERTY ADDRESS: 13377 Triadelphia Road

SUBDIVISION: The Corners      LOT: 1      TAX ID: 03-302369

CONTRACTOR: Freedom Septic      EMAIL: kristin@freedomseptic.com

CONTRACTOR ADDRESS: 2809 Liberty Road, Sykesville, MD 21784      PHONE: 410-795-2947

PROPERTY OWNER: Sandy Miles      EMAIL: \_\_\_\_\_

OWNER ADDRESS: 13377 Triadelphia Road, Ellicott City, MD 21042      PHONE: 443-928-4824

SEPTIC TANK SIZE (GALLONS): Existing      PUMP CHAMBER CAPACITY (GALLONS): N/A      PUMP SIZE: —

NUMBER OF BEDROOMS: 4      HOUSE SQ. FT. —      APPLICATION RATE: —

DISTRIBUTION SYSTEM:    GRAVITY FED       LOW PRESSURE DOSED

TRENCHES:	LINEAR FEET REQUIRED: <u>N/A</u>	INLET DEPTH: _____
	TRENCH WIDTH: _____	MAXIMUM BOTTOM DEPTH: _____
	MINIMUM SPACE BETWEEN TRENCHES: _____	EFFECTIVE AREA BEGINNING DEPTH: _____

LOCATION: **TO BE STAKED BY SANITARIAN DURING PRE-CONSTRUCTION INSPECTION.**

NOTES: ~~Replace 4" plumbing from tank to drywell. Replace plumbing to existing trench. Add riser and obs pipe @ end of trench.~~ Replace 4" plumbing from tank to drywell. Replace plumbing to existing trench. Add riser and obs pipe @ end of trench.

ISSUED BY: K Wolf      ISSUE DATE: 12/10/18      EXPIRATION DATE: 10/30/19

- NOTE: CONTRACTOR MUST SCHEDULE A PRE-CONSTRUCTION INSPECTION PRIOR TO BEGINNING ANY INSTALLATION
- NOTE: CONTRACTOR MUST SCHEDULE AN INSPECTION AND GAIN APPROVAL OF ALL COMPONENTS PRIOR TO COVERING
- NOTE: STONE MUST BE APPROVED BY HEALTH DEPARTMENT AND GRAVEL TICKET MUST BE AVAILABLE FOR REVIEW.
- NOTE: WATERTIGHT SEPTIC TANKS REQUIRED
- NOTE: ALL PARTS OF SEPTIC SYSTEM SHALL BE AT LEAST 100 FEET DOWNGRADE FROM ANY WATER WELL
- NOTE: MANHOLE RISERS REQUIRED ON ALL SEPTIC TANKS AND PUMP CHAMBERS
- NOTE: AN ELECTRICAL PERMIT IS REQUIRED FOR INSTALLATION OF ANY ELECTRICAL COMPONENTS OF THE SYSTEM
- ELECTRICAL PERMIT ISSUED    E N/A
- NOTE: THE HCHD DOES NOT WARRANT ANY SYSTEM AND CANNOT GUARANTEE THE PERFORMANCE OF THIS SYSTEM AS DESIGNED. BY ACCEPTING THIS PERMIT, THE OWNER AND/OR APPLICANT ACKNOWLEDGE THAT THE SPECIFICATIONS DETAILED IN THIS DESIGN ARE ONE POSSIBLE OPTION AND THAT THE HCHD WILL REVIEW OTHER PROPOSALS. YOU HAVE THE OPTION TO SEEK THE ADVICE OF A QUALIFIED DESIGN CONSULTANT OR PROFESSIONAL ENGINEER FOR FURTHER GUIDANCE.
- NOTE: MDE RECOMMENDS SEPTIC TANKS, BAT, AND OTHER PRETREATMENT UNITS BE PUMPED AT A FREQUENCY ADEQUATE TO ENSURE THAT SOLIDS ARE NOT DISCHARGED TO THE DISPOSAL AREA

**NEITHER THE HOWARD COUNTY COUNCIL NOR THE HEALTH DEPARTMENT IS RESPONSIBLE FOR THE SUCCESSFUL OPERATION OF ANY SYSTEM.**

**PERMITTEE RESPONSIBLE FOR OBTAINING FINAL APPROVAL ON THIS PERMIT.**

**CALL 410-313-1771 TO SCHEDULE INSPECTIONS.**

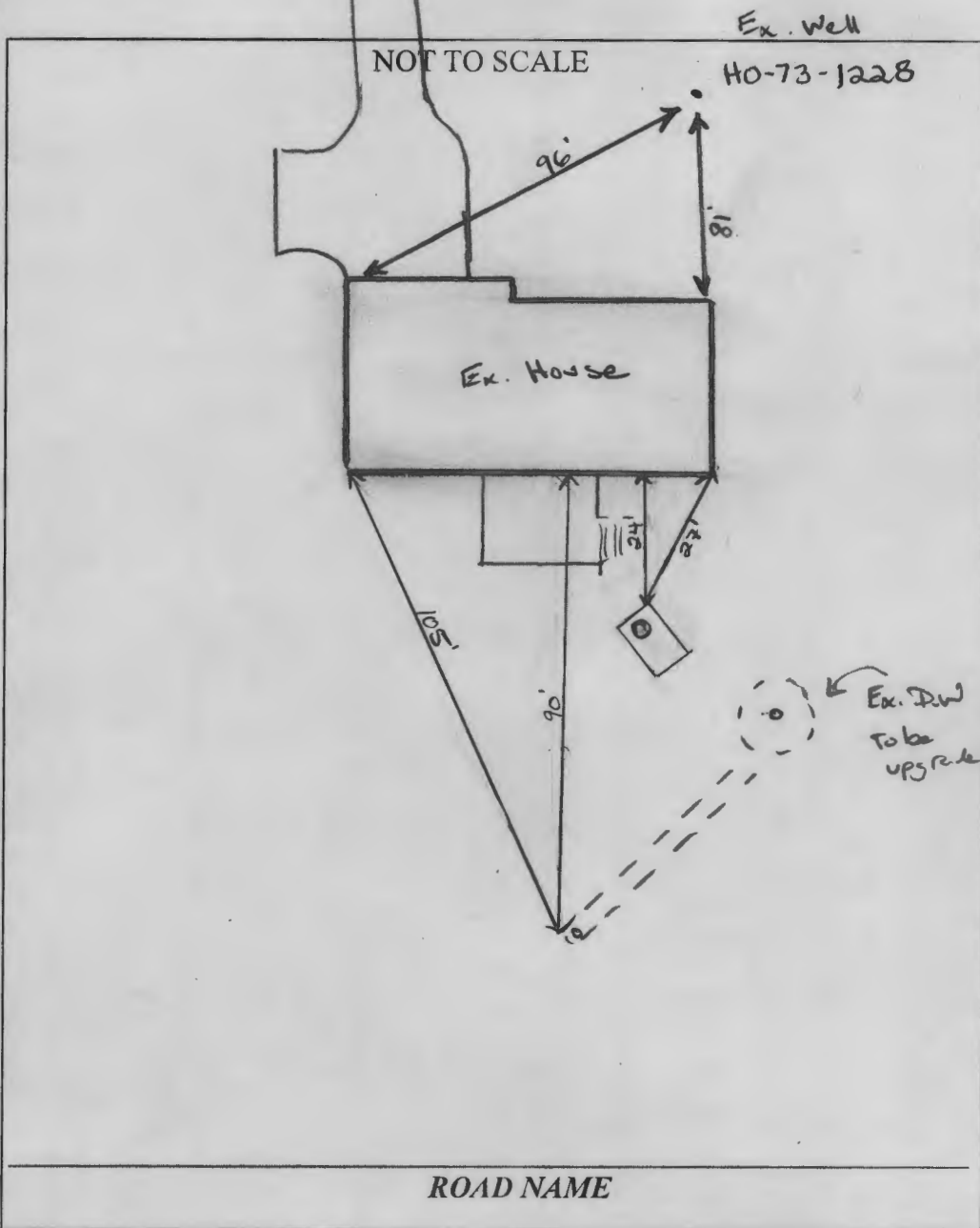

**TRENCH/DRAINFIELD DATA**

WIDTH	INLET	BOTTOM
<u>EXISTING</u>		
NUMBER OF TRENCHES	_____	
TOTAL LENGTH	_____	
ABSORPTION AREA	_____	
DISTRIBUTION BOX LEVEL	_____	
DISTRIBUTION BOX BAFFLE	_____	
DISTRIBUTION BOX PORT	_____	

**SEPTIC TANK DATA**

EXISTING

SEPTIC TANK 1 LEVEL \_\_\_\_\_

MANUFACTURER \_\_\_\_\_

CAPACITY \_\_\_\_\_ GAL

SIZE LOC \_\_\_\_\_

TANK LID DEPTH \_\_\_\_\_

PAVING \_\_\_\_\_

PERMEABLE FILTER \_\_\_\_\_

MANHOLE LOC \_\_\_\_\_

6" PORT LOC \_\_\_\_\_

WATER TIGHT TEST \_\_\_\_\_

STATUS \_\_\_\_\_

TANK LID \_\_\_\_\_

PUMP SEPTIC TANK LEVEL \_\_\_\_\_

MANUFACTURER \_\_\_\_\_

CAPACITY \_\_\_\_\_ GAL

SIZE LOC \_\_\_\_\_

TANK LID DEPTH \_\_\_\_\_

PAVING \_\_\_\_\_

PERMEABLE FILTER \_\_\_\_\_

MANHOLE LOC \_\_\_\_\_

6" PORT LOC \_\_\_\_\_

WATER TIGHT TEST \_\_\_\_\_

STATUS \_\_\_\_\_

TANK LID \_\_\_\_\_

**PRE-CONSTRUCTION:**  
 12/7/18 Talked over w/ homeowner. no surface failure. Drywell holding liquid to w/in 22" or so of outlet part of existing trench. Trench exposed, not been used. owner opted to convert drywell to add stone, remove lid, 6" perf. pipe, and install new plumbing for existing trench. Trench stone elevation verified in field within 6" of elevation start to end. (km) 12/13/18 Confirmed from contractor that owner  
**INSTALLATION:** do not want to fill drywell w/ stone. OK to proceed w/ work after (km) 01/03/2019 6" OBS ON TANK REMOVED. 20" RISER ADDED ON INLET. REPLACED CAST IRON FROM EX DW TO EX TRENCH. INSTALLED DISTAL OBS PART ON EX TRENCH (P)

FINAL INSPECTOR Jose A. Alcala DATE OF APPROVAL 01/10/2019

# Howard County Health Department

Bureau of Environmental Health, Ellicott City, Maryland 410-313-2640

SEWAGE DISPOSAL PERMIT NO. A- \_\_\_\_\_ P- 564052

PERMITTEE

Freedom Septic

LOCATION

13377 Innapdelphia Road The Corners Lot 1  
Sandy Miles

Do Not Cover Work Until Health Department Approval Appears On This Card

POST THIS CARD WHERE IT CAN BE SEEN FROM ROAD

STOP ALL CONSTRUCTION ON SEWAGE DISPOSAL SYSTEM AND CONTACT HEALTH DEPARTMENT BEFORE CONTINUING

Inspector \_\_\_\_\_

Date \_\_\_\_\_

WORK IS SATISFACTORY, CONTINUE

Inspector \_\_\_\_\_

Date \_\_\_\_\_

FINAL INSPECTION MADE, COVER ALL WORK

Inspector \_\_\_\_\_

Date \_\_\_\_\_

# FILE INQUIRY NOTES

13377 Tridelphe Road.

DATE	RESULTS OF REVIEW FOR FILE
12/6/18	<p>Upon site <del>arrival</del>, visited via 6" c/o w/ drywell                      there is currently approx. 22" or so of H<sub>2</sub>O                      below the inward of pipe to overflow trench.                      A perc test was dug approx 48' from the                      ex. drywell and end of ex. trench stone was                      encountered. Stone was dry no water. Exposed                      start of trench → cast iron pipe coming from                      drywell to trench, crossing pipe thru trench. stone                      clear. Explained to homeowner no failure or                      surface discharge. Perc test stopped @ 11 ft.                      per owner. No replacement system needed per                      owner. will discuss (owner to contractor)                      and confirm where to proceed from here. (KMW)</p>
12/7/18	<p>Contractor informed via email. owner wants to                      upgrade ex. Drywell (pump, remove lid, fill w/ stone                      6" perf. pipe), replace plumbing to drywell and to                      trench, add obs pipe to end of trench, and check                      outlet baffle. No <sup>extra</sup> fee needed. \$165 already paid.                      Permit to be typed. (KMW)</p>
12/13/18	<p>Contractor called. Owner does not want to fill drywell                      w/ stone. All other work to be performed. (KMW)</p>