

2/7/64

Visual hole needed.

APPLICATION

A 11320

SEWAGE DISPOSAL TESTING

P _____

MARYLAND STATE DEPARTMENT OF HEALTH

HOWARD COUNTY

ELLICOTT CITY

Septic Tank ¹⁸⁰⁰ 5750 gallons

DISTRICT 5

3B.R. - Dry well - 360 sq. ft. absorbent sidewall area below the inlet pipe located 50 ft from the front lot line and 84 ft from the left side lot line as seen when facing the lot from Queen St.

DATE 12/6/65

11/26/75 - VISUAL HOLE OK SEE OTHER SIDE

TO: THE COUNTY HEALTH OFFICER
ELLICOTT CITY, MARYLAND

inlet pipe 9 1/4" B.O.G.
Inlet pipe 4 ft. off area starts at 5 ft.

I, HEREBY, APPLY FOR THE NECESSARY TESTS IN ORDER TO CONSTRUCT (OR RECONSTRUCT) A SEWAGE DISPOSAL SYSTEM.

PROPERTY OWNER Marie Brown Robert Fansler

ADDRESS 12132 Scaggsville Rd
Laurel, Maryland Fulton, Md PHONE 490-8284
20759.

PROPERTY LOCATION:

SUBDIVISION Kings Manor LOT NO. 7

ROAD AND DESCRIPTION 11905 Queen Street

OCCUPANT _____ PHONE _____

PERSON TO CONSTRUCT SYSTEM _____

ADDRESS _____ PHONE _____

SIZE OF LOT 40,000 sq. ft. TYPE BLDG. 3

NUMBER OF ROOMS

IF NOT SINGLE RESIDENCE DESCRIBE: _____

SIGNATURE OF APPLICANT /s/ David Scaggs

APPROVED BY J. H. Kalmore FOR Dry well DATE 12/5/65

REJECTED BY _____ FOR _____ DATE _____

HOLD PENDING FURTHER TESTS _____ DATE _____

REASONS FOR REJECTION OR HOLDING _____

BLDG. PERMIT SIGNED
AND RETURNED 11/7/65
Inval # 57392 SF10

THIS IS NOT A PERMIT

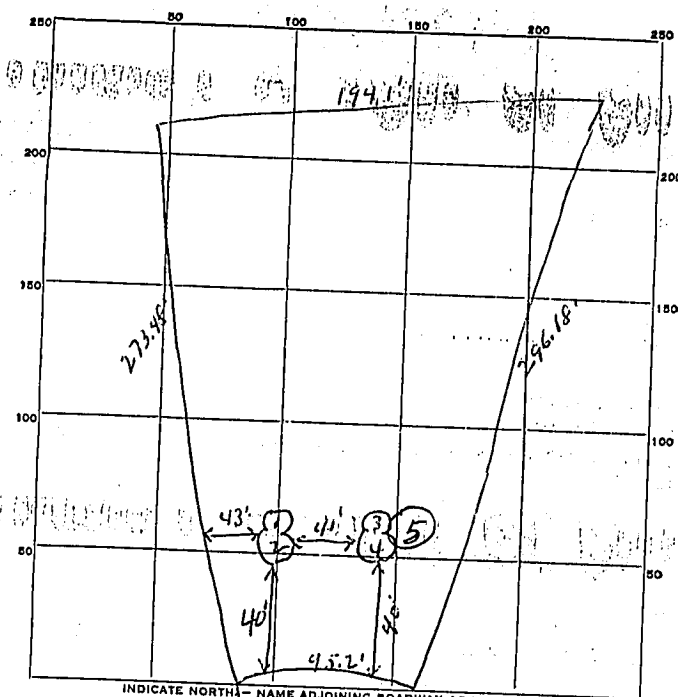

142
568
400
500

INDICATE NORTH - NAME ADJOINING ROADWAY AS BASE LINE.
Queen St

DATE	TEST NO.	DEPTH	PRE-WET		TEST - 1" DROP		TIME
			START	STOP	START	STOP	
12/8/65	1	5'	9:50	9:54	9:54	10:05	10 min
	2	9'	9:50	9:52	9:52	9:55	3 min
	3	5' W	9:56	9:58	9:58	10:01	3 min
	4	9' W	9:57	9:58	9:58	10:00	2 min
1/26/75	5	13'	TOP 5 FT OF LAY 15 FT		BOT 5 FT OF LAY 15 FT		7 min

5 min
VISUAL HOSE

SOIL AUGER FINDING _____
 TESTED BY JHK 11/26/75 Hodson Fyock & Brown
 REMARKS see pit 3-4 Elevated Sluggs present today