

5/20/03 111-510

3/28/83
3/24/83
Assess 11:00 A.M.
Second Insp. 8:30 A.M.

PERMIT

P 32419
32419
A 22314

SEWAGE DISPOSAL SYSTEM

MARYLAND STATE DEPARTMENT OF HEALTH

HOWARD COUNTY
BUREAU OF ENVIRONMENTAL HEALTH
992-2330

03-304892

ELLICOTT CITY
DISTRICT 4th.

INDEX

DATE 1/17/82

Paul Schissler IS PERMITTED TO INSTALL ALTER

ADDRESS 7311 Brangles Road, Marriottsville, Maryland PHONE 795-2642

SUBDIVISION Gwenlee Estates ROAD 3179 Sharp Road LOT 2, Sec. 3, Area 2

PROPERTY OWNER Maurice Evans

ADDRESS 8894 Town & Country Boulevard, Apt. C
Ellicott City, Maryland 21043

IF GARBAGE GRINDER IS USED INCREASE SEPTIC TANK CAPACITY BY 50% AND ABSORPTION AREA BY 22%.

GARBAGE GRINDER? YES NO

SEPTIC TANK CAPACITY 1000 GALLONS NUMBER OF BEDROOMS 3

TRENCHES - 175 sq. ft. absorption sidewall area per bedroom. Minimum Total sw. Ft. 525 sq. ft
Trench to be 2 fet. wide. Inlet 4 ft. below original grade. Maximum depth 10 ft. below
original grade. 6 Ft. of stone below distribution pipe. NOTE: (1) no trench to exceed 100 f
in length (2) If more than one trench used, a distribution box is required. (3) Trenches to
be installed on level ground. LOCATION: Begin trench 65 feet from the right side line and
125 feet from the rear lot line, and proceed to dig trench on level ground running towards the
rear of the lot. Call for inspection of trench before gravel is installed.

PLANS APPROVED BY Revised 1/3/83 Frank Skinner DATE 1/3/83

COVER NO WORK UNTIL INSPECTED AND APPROVED.

NEITHER THE HOWARD COUNTY COUNCIL NOR THE HEALTH DEPARTMENT IS RESPONSIBLE FOR THE SUCCESS OR FAILURE OF THIS PERMIT.

BUILDING PERMITS SIGNED AND RETURNED

NOTE: IF TRENCH IS USED CALL FOR INSPECTION BEFORE AND AFTER PLACING GRAVEL IN TRENCH.

NOTE: NO DRY WELL SHALL EXCEED 15 FOOT IN DIAMETER. NO ABSORPTION TRENCH TO EXCEED 100 FEET IN LENGTH. 10/28/2002 800138704 WOOD DECK

NOTE: ALL PIPE FROM HOUSE TO SEPTIC TANK MUST BE CAST IRON OR SCHEDULE 40 PVC OR ABS. 4/26/07- 807001508- 24x20- Garage & Sunroom

PERMIT VOID AFTER THREE YEARS.

NOTE: INSTALL STAND PIPE ON SEPTIC TANK AND DRY WELL. STAND PIPES MUST BE 6 INCHES IN DIAMETER. CAST IRON, CONCRETE OR TERRA COTTA, OR PVC OR ABS ACCEPTED. IF TOP OF SEPTIC TANK IS DEEPER THAN 3 FEET MANHOLE TO GRADE REQUIRED.

***INSTALLER IS RESPONSIBLE FOR OBTAINING FINAL APPROVAL ON THIS PERMIT**

*CALL 992-2330 FOR INSPECTION OF SEPTIC SYSTEMS.

EH - 2-1082

80394A 3292

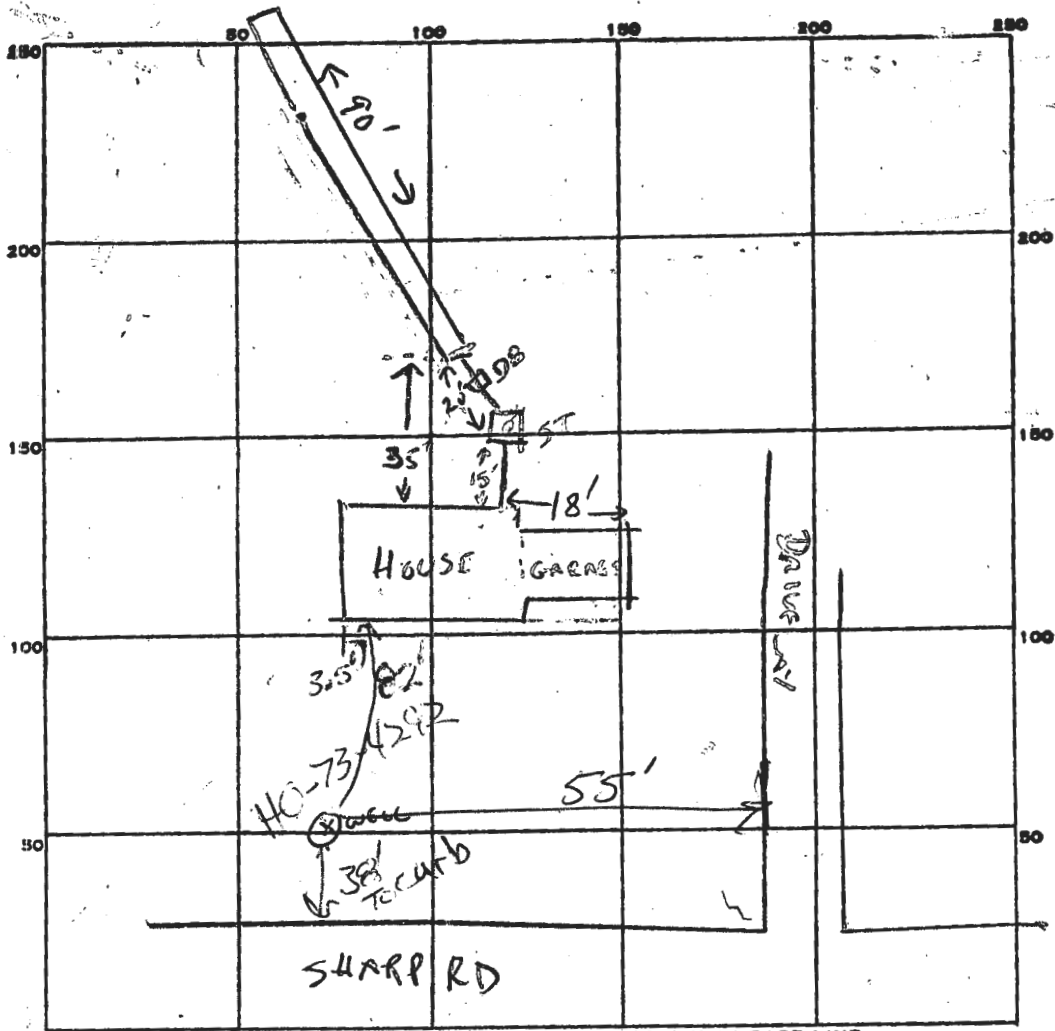

INDICATE NORTH. - NAME ADJOINING ROADWAY AS BASE LINE.

PERMIT CARD Signed final OK J.P.S.

SEPTIC TANK, LEVEL

CLEANOUTS S.T. / O.K. /

DISTRIBUTION BOX, LEVEL _____

TILE FIELD, DEPTH 10 FT. TRENCH WIDTH 2 FT.

GRAVEL DEPTH 6 FT. TOTAL LENGTH 90 FT.

NUMBER OF TRENCHES 1 ONE SIDEWALL TOTAL BOTTOM AREA 540 sq ft

SEEPAGE PITS, INSIDE DIAMETER _____ FT. DEPTH BELOW INLET 6 FT.

ABSORBENT AREA ±540 SQ. FT.

REMARKS

AND RETURNED
TRENCH OK. CONTINUE WORK 3-24-83 CW

ALL OK EXCEPT NEED HOUSE CONNECTION 3-24-83 pm CW

3/28/83 final connection OK. J.P.S.

DATE SYSTEM APPROVED 3/28/83

INSPECTOR J.P. Skinner

