

8/24/79
a.m. if possible

8/24/79 Approved
File C.R.

PERMIT

SEWAGE DISPOSAL SYSTEM

MARYLAND STATE DEPARTMENT OF HEALTH*

HOWARD COUNTY

06-394744

ELLICOTT CITY

DISTRICT 6th

INDEXED

DATE 8/23/79

P 30115

A Repair

Jack Fyock

IS PERMITTED TO INSTALL ALTER X

ADDRESS 13775 Triadelphia Road, Glenelg, Md. 21737 PHONE 988-9270

Now 10600 Shaker Drive
6505 Route 29

SUBDIVISION ROAD LOT

PROPERTY OWNER Louis M. Brown, Jr.

ADDRESS 6505 Route 29, Columbia, Md. 21046 Phone: 997-8210

SPECIFICATIONS 2-3 BR

SEPTIC TANK CAPACITY _____ GALLONS

DRAIN FIELD _____ DEPTH _____ FEET, BOTTOM AREA _____ SQ. FT.

DEEP TRENCH _____ DEPTH _____ FEET, BOTTOM AREA _____ SQ. FT.

SEEPAGE PITS _____ ABSORBENT SIDE-WALL AREA _____ SQ. FT.

INLET PIPE _____ FT. BELOW ORIGINAL GRADE. MAXIMUM DEPTH _____ FT. BELOW ORIGINAL GRADE

EFFECTIVE DEPTH AT _____ FT. BELOW ORIGINAL GRADE.

LOCATE DISPOSAL AREA _____ FT. FROM _____ LOT LINE AND _____ FT. FROM _____ LOT LINE AS SEEN WHEN

FACING LOT FROM

REPAIR - Call for an appointment when ground is opened up and Sanitarian will

recommend the repair system. 1 Trench 72' L - 10 depth
sandy loam soil; 1000 gallon tank; Hook into
existing line. Old abandoned well - filled in with

PLANS APPROVED BY Palmer F. Wine DATE 8/23/79

COVER NO WORK UNTIL INSPECTED AND APPROVED.

NEITHER THE HOWARD COUNTY COUNCIL NOR THE HEALTH DEPARTMENT IS RESPONSIBLE FOR THE SUCCESSFUL OPERATION OF ANY SYSTEM.

NOTE: IF TRENCH IS USED CALL FOR INSPECTION BEFORE PLACING GRAVEL IN TRENCH.

NOTE: NO DRY WELL SHALL EXCEED 15 FOOT IN DIAMETER.

NOTE: ALL PIPE FROM HOUSE TO DISPOSAL AREA MUST BE CAST IRON.

PERMIT VOID AFTER THREE YEARS.

NOTE: INSTALL STAND PIPE ON SEPTIC TANK AND DRY WELL. STAND PIPES MUST BE 6 INCHES IN DIAMETER. CAST IRON, CONCRETE OR TERRA COTTA ACCEPTED.

*INSTALLER IS RESPONSIBLE FOR OBTAINING FINAL APPROVAL ON THIS PERMIT.

P 30115

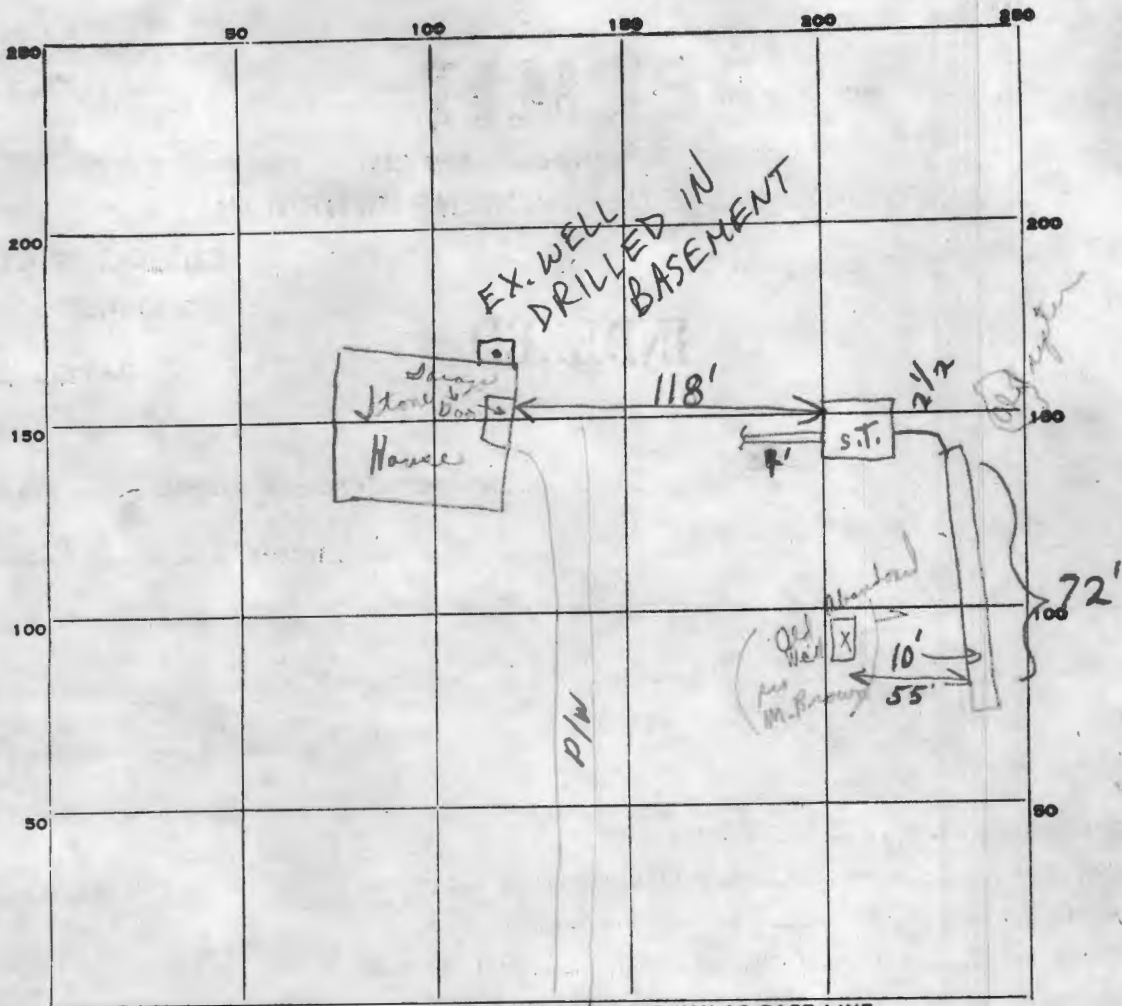

INDICATE NORTH. - NAME ADJOINING ROADWAY AS BASE LINE.

EC. ← Yes → athelton
 PERMIT CARD Yes RX 29
 SEPTIC TANK, LEVEL ok CLEANOUTS S.T. / D.W. / N/A
 DISTRIBUTION BOX, LEVEL N/A T.C
 TILE FIELD, DEPTH 10 FT. TRENCH WIDTH 2 FT.
 GRAVEL DEPTH 2.5-7 IN. TOTAL LENGTH 7 FT.
 NUMBER OF TRENCHES 1 TOTAL BOTTOM AREA _____
 SEEPAGE PITS, INSIDE DIAMETER _____ FT. DEPTH BELOW INLET _____ FT.
 ABSORBENT AREA 546+ SQ. FT.

REMARKS A.M. 8/24/79 Connected into old line {House within}
Partial; P.M. 6' more of trench added 78' long; trench completed house.
C.B.V.

DATE SYSTEM APPROVED 8/24/79 as per above INSPECTOR C. B. Streaker



HOWARD COUNTY HEALTH DEPARTMENT

Diane L. Matuszak, M.D., M.P.H., County Health Officer

November 1, 2001

TO: Clerk of the Session
Christ Memorial Presbyterian Church
6410 Amherst Avenue
Columbia, MD 21046

FROM: Mark Rifkin *MR*
Water and Sewerage Program

RE: 10600 Shaker Drive
Tax Map 36, Parcel 54

In the matter of returning the referenced vacant dwelling to occupancy status, the Health Department has no objections.

According to Health Department records, the septic system was replaced in 1979. The existing well apparently predates Health Department records, but there is no evidence of poor water quality or insufficient quantity. Moreover, the Health Department has no jurisdiction at this time to require any specific action in order for the Church to use the dwelling as temporary housing for client families.

If you have any questions, please contact me at the address below or by calling (410) 313-2640.

MR