

# APPLICATION

PERCOLATION TESTING

A 516404

P \_\_\_\_\_

HOWARD COUNTY HEALTH DEPARTMENT  
BUREAU OF ENVIRONMENTAL HEALTH  
3525-H ELLICOTT MILLS DRIVE/ELLICOTT CITY, MARYLAND 21043  
TELEPHONE: 313-2640

DISTRICT \_\_\_\_\_

DATE 11/2/01

TO: THE COUNTY HEALTH OFFICER  
ELLICOTT CITY, MARYLAND

I HEREBY APPLY FOR THE NECESSARY TEST PRIOR TO APPLICATION FOR PERMIT TO CONSTRUCT (OR RECONSTRUCT) A SEWAGE DISPOSAL SYSTEM.

PROPERTY OWNER Lucie Menassa Pettis + Brandon Scott Pettis

ADDRESS 3450 Sharp Rd, Glenwood PHONE 410 489-5662

AGENT OR PROSPECTIVE BUYER \_\_\_\_\_

ADDRESS \_\_\_\_\_ PHONE \_\_\_\_\_

PROPERTY LOCATION:

SUBDIVISION \_\_\_\_\_ LOT NO. \_\_\_\_\_

ROAD AND DESCRIPTION Sharp Rd - 3450, west side of Sharp Rd, 1000' South of  
Burntwoods.

TAX MAP 21 PARCEL # 172

SIZE OF LOT 2.9 acres TYPE BLDG. Single family dwelling  
(SINGLE FAMILY DWELLING OR COMMERCIAL)

THE SYSTEM INSTALLED UNDER THIS APPLICATION IS ACCEPTABLE ONLY UNTIL PUBLIC FACILITIES BECOME AVAILABLE. I FULLY UNDERSTAND THE FEE CONNECTED WITH THE FILING OF THIS PERC TEST APPLICATION IS NON-REFUNDABLE UNDER ANY CIRCUMSTANCES. I ALSO AGREE TO COMPLY WITH ALL M.O.S.H.A. REQUIREMENTS IN TESTING THIS LOT. Lucie Pettis Brandon Scott Pettis  
(SIGNATURE OF APPLICANT)

APPROVED BY \_\_\_\_\_ FOR \_\_\_\_\_ DATE \_\_\_\_\_

DISAPPROVED BY \_\_\_\_\_ FOR \_\_\_\_\_ DATE \_\_\_\_\_

HOLD PENDING FURTHER TESTS \_\_\_\_\_

REASONS FOR REJECTION OR HOLDING \_\_\_\_\_

PERCOLATION TEST PLAT/PRELIMINARY PLAT - TITLE OR I.D. # \_\_\_\_\_ DATE \_\_\_\_\_

SITE DEVELOPMENT PLAN/FINAL PLAT - TITLE OR I.D. # \_\_\_\_\_ DATE \_\_\_\_\_

# THIS IS NOT A PERMIT

COUNTY #

SOIL PROFILE

0' 10  
Orange brown  
L

2' Brown  
fine micaceous  
SL  
w/ < 100  
Coarse  
Fossils

11' H<sub>2</sub>O

11' Heavy Brown  
L

2' brown  
SiL

4 1/2' Heavy  
red orange  
Damp  
SiL  
w/ f 1 Fe  
mottles @ 6 1/2

8' H<sub>2</sub>O

12' Brown L

1 1/2' Brown  
SiL

3' fine  
brown  
micaceous  
SL

12'



INDICATE NORTH - NAME ADJOINING ROADWAY AS BASE LINE.

DATE	TEST NO.	DEPTH	PRE-WET		TEST - 1" DROP		TIME
			START	STOP	START	STOP	
4/16/03	10	3 / 13	9:38	9:41	9:41	9:46	5
	11	12V	possible mound Feil for trench				F
	12	3 1/2 / 12	10:20	10:24	10:24	10:31	7 ok
	13	3 / 12	10:39	10:45	10:45	10:52	7 ok

REMARKS f=faint; L=<5mm

TYPE OF SOIL

TESTED BY

J. Bord

ALSO PRESENT

TRENCH DESIGN DATA: AVERAGE PERCOLATION TIME

TRENCH WIDTH

INLET DEPTH

MAXIMUM BOTTOM DEPTH

SQ. FT./BEDROOM

# APPLICATION

PERCOLATION TESTING

A 516404

P \_\_\_\_\_

HOWARD COUNTY HEALTH DEPARTMENT  
BUREAU OF ENVIRONMENTAL HEALTH  
3525-H ELLICOTT MILLS DRIVE/ELLICOTT CITY, MARYLAND 21043  
TELEPHONE: 313-2640

DISTRICT \_\_\_\_\_

DATE 11/2/01

TO: THE COUNTY HEALTH OFFICER  
ELLICOTT CITY, MARYLAND

I HEREBY APPLY FOR THE NECESSARY TEST PRIOR TO APPLICATION FOR PERMIT TO CONSTRUCT (OR RECONSTRUCT) A SEWAGE DISPOSAL SYSTEM.

PROPERTY OWNER Lucie Menassa Pettis + Brandon Scott Pettis

ADDRESS 3450 Sharp Rd, Glenwood PHONE 410 489-5662

AGENT OR PROSPECTIVE BUYER \_\_\_\_\_

ADDRESS \_\_\_\_\_ PHONE \_\_\_\_\_

PROPERTY LOCATION:

SUBDIVISION \_\_\_\_\_ LOT NO. \_\_\_\_\_

ROAD AND DESCRIPTION Sharp Rd - 3450, west side of Sharp Rd, 1000' South of  
Burntwoods.

TAX MAP 21 PARCEL # 172

SIZE OF LOT 2.9 acres TYPE BLDG. Single family dwelling  
(SINGLE FAMILY DWELLING OR COMMERCIAL)

THE SYSTEM INSTALLED UNDER THIS APPLICATION IS ACCEPTABLE ONLY UNTIL PUBLIC FACILITIES BECOME AVAILABLE. I FULLY UNDERSTAND THE

FEE CONNECTED WITH THE FILING OF THIS PERC TEST APPLICATION IS NON-REFUNDABLE UNDER ANY CIRCUMSTANCES. I ALSO AGREE TO

COMPLY WITH ALL M.O.S.H.A. REQUIREMENTS IN TESTING THIS LOT. Lucie Pettis  
(SIGNATURE OF APPLICANT)

APPROVED BY Johann FOR Trench DATE 6/3/03

DISAPPROVED BY \_\_\_\_\_ FOR \_\_\_\_\_ DATE \_\_\_\_\_

HOLD PENDING FURTHER TESTS \_\_\_\_\_

REASONS FOR REJECTION OR HOLDING \_\_\_\_\_

PERCOLATION TEST PLAT/PRELIMINARY PLAT - TITLE OR I.D. # \_\_\_\_\_ DATE \_\_\_\_\_

SITE DEVELOPMENT PLAN/FINAL PLAT - TITLE OR I.D. # \_\_\_\_\_ DATE \_\_\_\_\_

# THIS IS NOT A PERMIT

COUNTY #

SOIL PROFILE

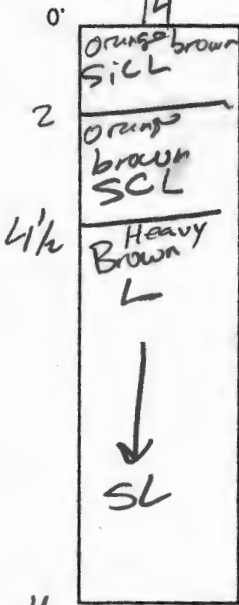

SOIL PROFILE

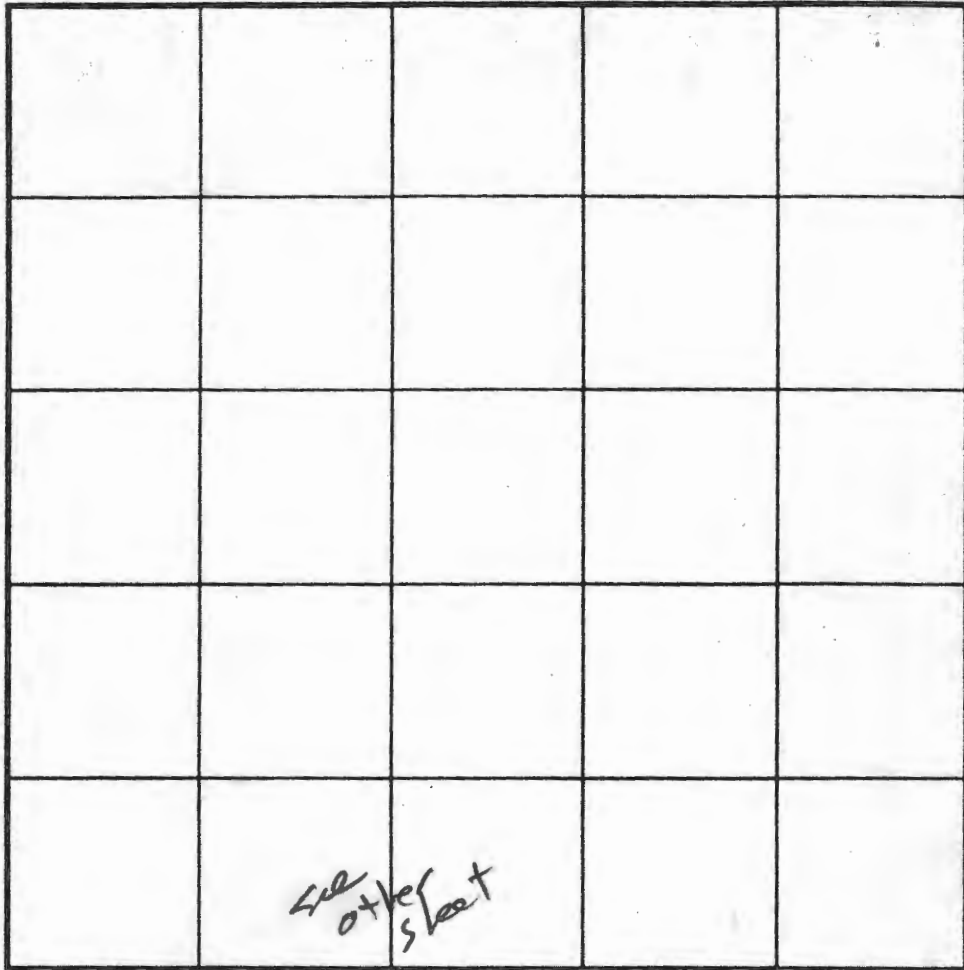

INDICATE NORTH - NAME ADJOINING ROADWAY AS BASE LINE.

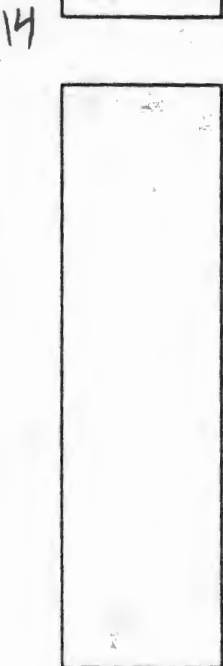

DATE	TEST NO.	DEPTH	PRE-WET		TEST - 1' DROP		TIME	
			START	STOP	START	STOP		
4/16/03	14	4 11	11:15	11:46	31 min Pre-satur		F	
	14	5 11	12:13:00	12:18:00	12:18:00	12:25:00	7	OK
	15	3 14	12:01:00	12:02:30	12:02:30	12:06:00	3:30	OK

REMARKS \_\_\_\_\_

TYPE OF SOIL \_\_\_\_\_

TESTED BY J. Boris ALSO PRESENT \_\_\_\_\_

TRENCH DESIGN DATA: AVERAGE PERCOLATION TIME 6 TRENCH WIDTH 3

INLET DEPTH \_\_\_\_\_ MAXIMUM BOTTOM DEPTH \_\_\_\_\_ SQ. FT./BEDROOM 180

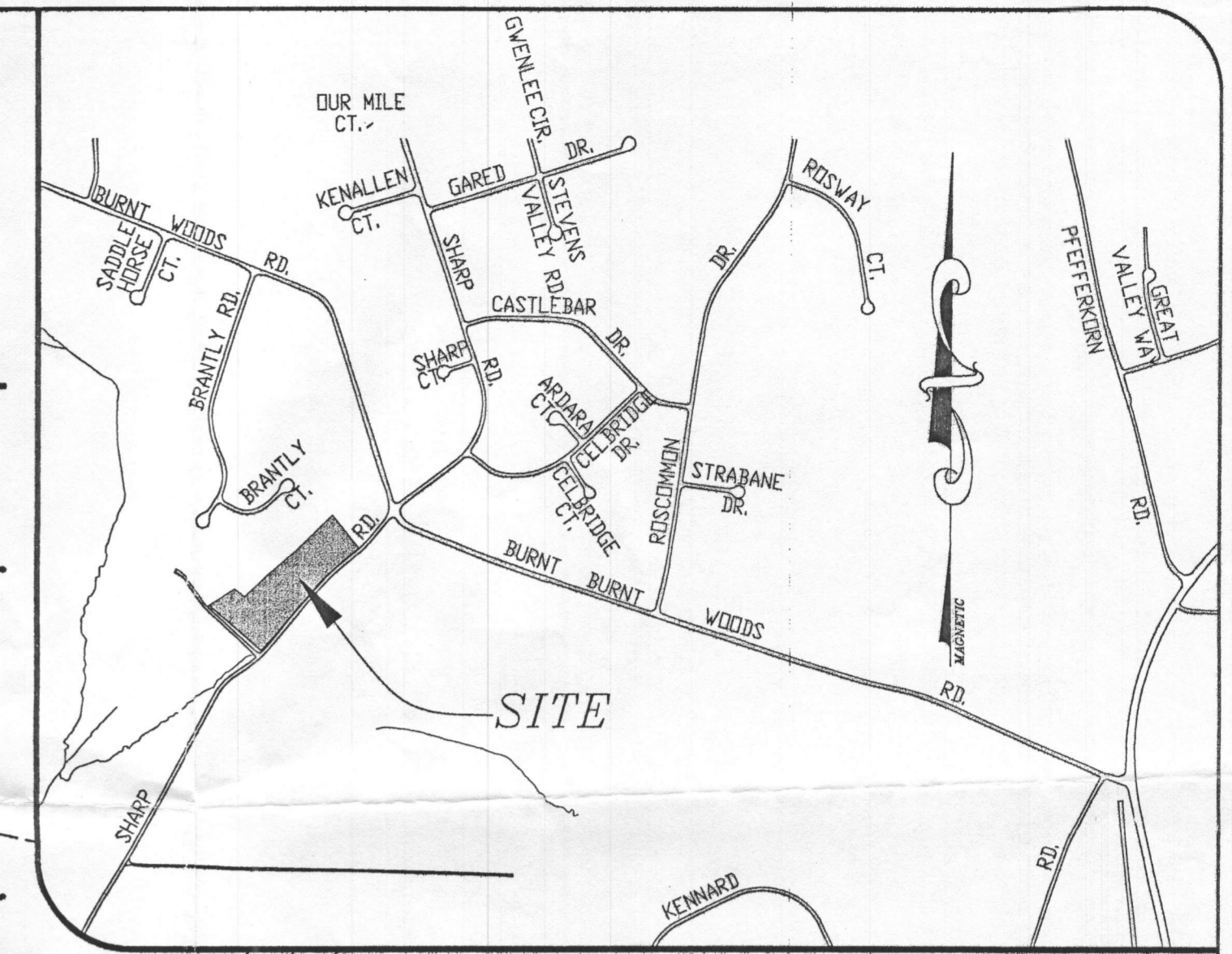
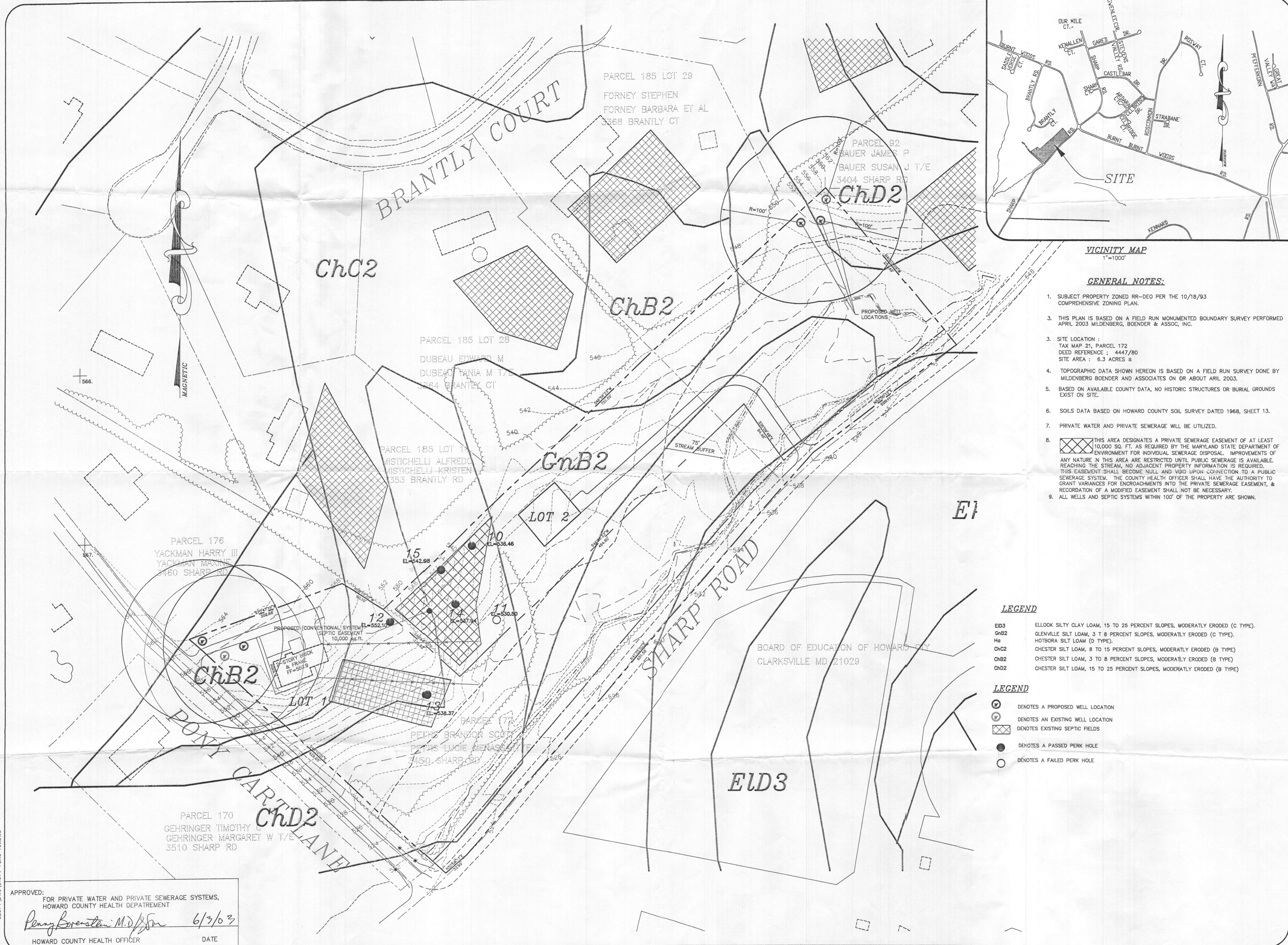

VICINITY MAP  
1"=1000'

GENERAL NOTES:

- SUBJECT PROPERTY ZONED RR-DEO PER THE 10/18/93 COMPREHENSIVE ZONING PLAN.
- THIS PLAN IS BASED ON A FIELD RUN MONUMENTED BOUNDARY SURVEY PERFORMED APRIL 2003 MILDENBERG, BOENDER & ASSOC, INC.
- SITE LOCATION :  
TAX MAP 21, PARCEL 172  
DEED REFERENCE : 4447/80  
SITE AREA : 6.3 ACRES ±
- TOPOGRAPHIC DATA SHOWN HEREON IS BASED ON A FIELD RUN SURVEY DONE BY MILDENBERG BOENDER AND ASSOCIATES ON OR ABOUT APRIL 2003.
- BASED ON AVAILABLE COUNTY DATA, NO HISTORIC STRUCTURES OR BURIAL GROUNDS EXIST ON SITE.
- SOILS DATA BASED ON HOWARD COUNTY SOIL SURVEY DATED 1968, SHEET 13.
- PRIVATE WATER AND PRIVATE SEWERAGE WILL BE UTILIZED.
- THIS AREA DESIGNATES A PRIVATE SEWERAGE EASEMENT OF AT LEAST 10,000 SQ. FT. AS REQUIRED BY THE MARYLAND STATE DEPARTMENT OF ENVIRONMENT FOR INDIVIDUAL SEWERAGE DISPOSAL. IMPROVEMENTS OF ANY NATURE IN THIS AREA ARE RESTRICTED UNTIL PUBLIC SEWERAGE IS AVAILABLE. REACHING THE STREAM, NO ADJACENT PROPERTY INFORMATION IS REQUIRED. THIS EASEMENT SHALL BECOME NULL AND VOID UPON CONNECTION TO A PUBLIC SEWERAGE SYSTEM. THE COUNTY HEALTH OFFICER SHALL HAVE THE AUTHORITY TO GRANT VARIANCES FOR ENCROACHMENTS INTO THE PRIVATE SEWERAGE EASEMENT, & RECORDATION OF A MODIFIED EASEMENT SHALL NOT BE NECESSARY.
- ALL WELLS AND SEPTIC SYSTEMS WITHIN 100' OF THE PROPERTY ARE SHOWN.

LEGEND

- E1 ELLOOK SILTY CLAY LOAM, 15 TO 25 PERCENT SLOPES, MODERATLY ERODED (C TYPE).
- ChB2 GLENVILLE SILT LOAM, 3 TO 8 PERCENT SLOPES, MODERATLY ERODED (C TYPE).
- Ho HOTBORA SILT LOAM (D TYPE).
- ChC2 CHESTER SILT LOAM, 8 TO 15 PERCENT SLOPES, MODERATLY ERODED (B TYPE).
- ChB2 CHESTER SILT LOAM, 3 TO 8 PERCENT SLOPES, MODERATLY ERODED (B TYPE).
- ChD2 CHESTER SILT LOAM, 15 TO 25 PERCENT SLOPES, MODERATLY ERODED (B TYPE).

LEGEND

- DENOTES A PROPOSED WELL LOCATION
- ⊙ DENOTES AN EXISTING WELL LOCATION
- ▨ DENOTES EXISTING SEPTIC FIELDS
- DENOTES A PASSED PERK HOLE
- DENOTES A FAILED PERK HOLE

APPROVED:  
FOR PRIVATE WATER AND PRIVATE SEWERAGE SYSTEMS,  
HOWARD COUNTY HEALTH DEPARTMENT

*Penny Brewster M.D./J.D.* 6/3/03  
HOWARD COUNTY HEALTH OFFICER DATE

project	date	approval
02074	MAY 03	SA
illustration	engineering	SA
SA	SA	SA
scale	1"=60'	approval
		RJH

no.	description	revisions	date

PETTIS PROPERTY  
TAX MAP 21, PARCEL 172  
HOWARD COUNTY, MARYLAND  
ELECTION DISTRICT  
PERCOLATION CERTIFICATION PLAN

MILDENBERG,  
BOENDER & ASSOC., INC.  
Engineers Planners Surveyors  
5072 Dorsey Hall Drive, Suite 202, Ellicott City, Maryland 21042  
(410) 987-0296 Balt. (301) 621-5521 Wash. (410) 987-0298 Fax