

2-18-97
2:00 C.O.

PERMIT

SEWAGE DISPOSAL SYSTEM

DEPARTMENT OF HEALTH AND MENTAL HYGIENE

03-319679

P 57658

A 49914-A

DISTRICT 3rd

DATE 01/31/97

DATE SYSTEM APPROVED 2-18-97

INSPECTOR DKS

HOWARD COUNTY HEALTH DEPARTMENT

BUREAU OF ENVIRONMENTAL HEALTH

~~XXXXXXXX~~ 313-2640

INDEXED

South Carroll Backhoe, Inc.

IS PERMITTED TO INSTALL ALTER

ADDRESS 4410 Salem Bottom Road, Westminster, Maryland 21157 PHONE 875-4197

SUBDIVISION Sobus Farms LOT 1 ROAD 3000 Sobus Drive

PROPERTY OWNER Altieri Homes ~~PARIENTE + LARRY HOFFMAN~~

ADDRESS Gay

SEPTIC TANK CAPACITY 1250 GALLONS

NUMBER OF BEDROOMS 4

180 SQUARE FEET PER BEDROOM

LINEAR FEET OF TRENCH REQUIRED 240

TRENCHES - Trench to be 3 feet wide. Inlet 2 feet below original grade. Bottom maximum depth 4 feet below original grade. Effective area begins at 2 feet below original grade. 2 feet of stone below distribution pipe.

LOCATION - Starting from the right rear lot corner, place distribution box 190 feet up the rear (455.00') lot line and 195 feet off that same lot line as seen when facing the lot from Sobus Drive. Run trenches on contour toward Sobus Drive.

NOTES - No trench to exceed 100 feet in length. Provide 6" - 8' diameter cleanout and cap to grade or above on septic tank.

OK 12/2/96 AH

PLANS APPROVED BY Mark Rifkin/Amy McMillen

DATE 9/26/96

COVER NO WORK UNTIL INSPECTED AND APPROVED

NEITHER THE HOWARD COUNTY COUNCIL NOR THE HEALTH DEPARTMENT IS RESPONSIBLE FOR THE SUCCESSFUL OPERATION OF ANY SYSTEM

NOTE: CLEANOUT REQUIRED EVERY 70 FEET OF SEWER LINE AND/OR AT 90° SWEEPS IN LINES FROM HOUSE TO DRAIN FIELDS, 90° ELBOWS NOT ACCEPTABLE.

NOTE: ALL PARTS OF SEPTIC SYSTEMS (I.E. TANK, DISTRIBUTION BOX TRENCHES) TO BE 100 FEET FROM WELL (UNLESS OTHERWISE SPECIFICALLY AUTHORIZED)

NOTE: IF DEEP TRENCH(ES) ARE USED CALL FOR INSPECTION BEFORE AND AFTER PLACING GRAVEL IN TRENCH(ES)

NOTE: NO DRY WELL SHALL EXCEED 15 FOOT IN DIAMETER NO ABSORPTION TRENCH TO EXCEED 100 FEET IN LENGTH

NOTE: ALL PIPE FROM HOUSE TO SEPTIC TANK MUST BE CAST IRON OR SCHEDULE 35/40 PVC OR ABS

PERMIT VOID AFTER TWO YEARS

NOTE: INSTALL STAND PIPE ON SEPTIC TANK AND DRY WELL STAND PIPES MUST BE 6 INCHES IN DIAMETER CAST IRON, CONCRETE OR TERRA COTTA OR PVA OR ABS ACCEPTED. IF TOP OF SEPTIC TANK IS DEEPER THAN 3 FEET, MANHOLE TO GRADE REQUIRED.

NOTE: DISTRIBUTION BOXES MUST HAVE BAFFLES

***INSTALLER IS RESPONSIBLE FOR OBTAINING FINAL APPROVAL ON THIS PERMIT**

HD-260(6-90)

*CALL 461-9933 FOR INSPECTION OF SEPTIC SYSTEM.

BLDG. PERMIT SIGNED
AND RETURNED 9-17-97
Seal # 490107950

49914-A
03-319679

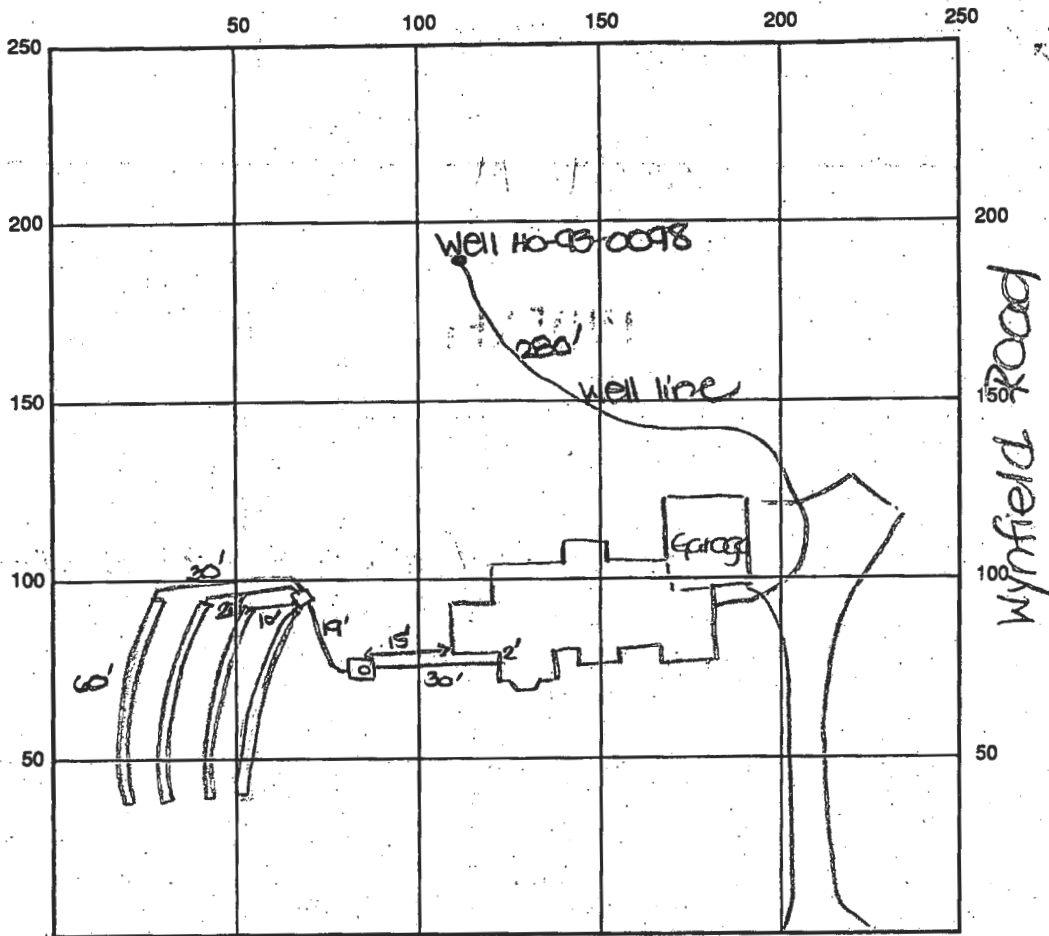

INDICATE NORTH - NAME ADJOINING ROADWAY AS BASE LINE

Sobus Drive

SEPTIC TANK LEVEL OK - 1250 gal CLEANOUTS one on s.t.

DISTRIBUTION BOX LEVEL OK

DRAIN FIELD/TITLE DEPTH 4 FT. TRENCH WIDTH 3 FT. INLET DEPTH 2 FT.

EFFECTIVE GRAVEL DEPTH 2 FT. TOTAL LENGTH 4160 FT. → 240'

NUMBER OF TRENCHES 4 ONE SIDEWALL/BOTTOM AREA 720 SQ. FT.

DRYWALL INSIDE DIAMETER — FT. EFFECTIVE DEPTH BELOW INLET — FT.

ABSORBENT AREA — SQ. FT.

REMARKS: 2/18/97 FINAL INSP - OK TO COVER ALL WORK. DKS

DATE SYSTEM APPROVED 2/18/97 INSPECTOR [Signature]