

# APPLICATION

PERCOLATION TESTING

A 41573

P \_\_\_\_\_

HOWARD COUNTY HEALTH DEPARTMENT  
BUREAU OF ENVIRONMENTAL HEALTH  
P.O. BOX 476 ELLICOTT CITY, MARYLAND 21043  
TELEPHONE 461-9933

DISTRICT 6<sup>TH</sup>

DATE April 7, 1988

TO: THE COUNTY HEALTH OFFICER  
ELLICOTT CITY, MARYLAND

I, HEREBY, APPLY FOR THE NECESSARY TEST IN ORDER TO CONSTRUCT (OR RECONSTRUCT) A SEWAGE DISPOSAL SYSTEM.

PROPERTY OWNER T.A. & T. Associates

ADDRESS 8800 Sterrett Place PHONE 730-7733

PROSPECTIVE BUYER Unknown

ADDRESS \_\_\_\_\_ PHONE \_\_\_\_\_

PROPERTY LOCATION:

SUBDIVISION T.A. & T. Property LOT NO 2

ROAD AND DESCRIPTION West side of Md. Route 108, 2,700' ± South of Guilford Road.

TAX MAP 34 PARCEL # 134

SIZE OF LOT 3 Acre Minimum TYPE BLDG S.F.D.  
(SINGLE FAMILY DWELLING OR COMMERCIAL)

THE SYSTEM INSTALLED UNDER THIS APPLICATION IS ACCEPTABLE ONLY UNTIL PUBLIC FACILITIES BECOME AVAILABLE. I FULLY UNDERSTAND THE FEE CONNECTED WITH THE FILING OF THIS PERC TEST APPLICATION IS NON-REFUNDABLE UNDER ANY CIRCUMSTANCES. I ALSO AGREE TO COMPLY WITH ALL M.O.S.H.A. REQUIREMENTS IN TESTING THIS LOT.

Dennis M. Bush

(SIGNATURE OF APPLICANT)

APPROVED BY \_\_\_\_\_ FOR \_\_\_\_\_ DATE \_\_\_\_\_

REJECTED BY \_\_\_\_\_ FOR \_\_\_\_\_ DATE \_\_\_\_\_

HOLD PENDING FURTHER TESTS \_\_\_\_\_ DATE \_\_\_\_\_

REASONS FOR REJECTION OR HOLDING \_\_\_\_\_

HD-216

# THIS IS NOT A PERMIT

A #41573

Highland ↑

HOLD FOR WET SEASON  
Openfield

2

SOIL PROFILE

HOLD FOR WET SEASON  
CBO  
ABEL  
BRIFLY

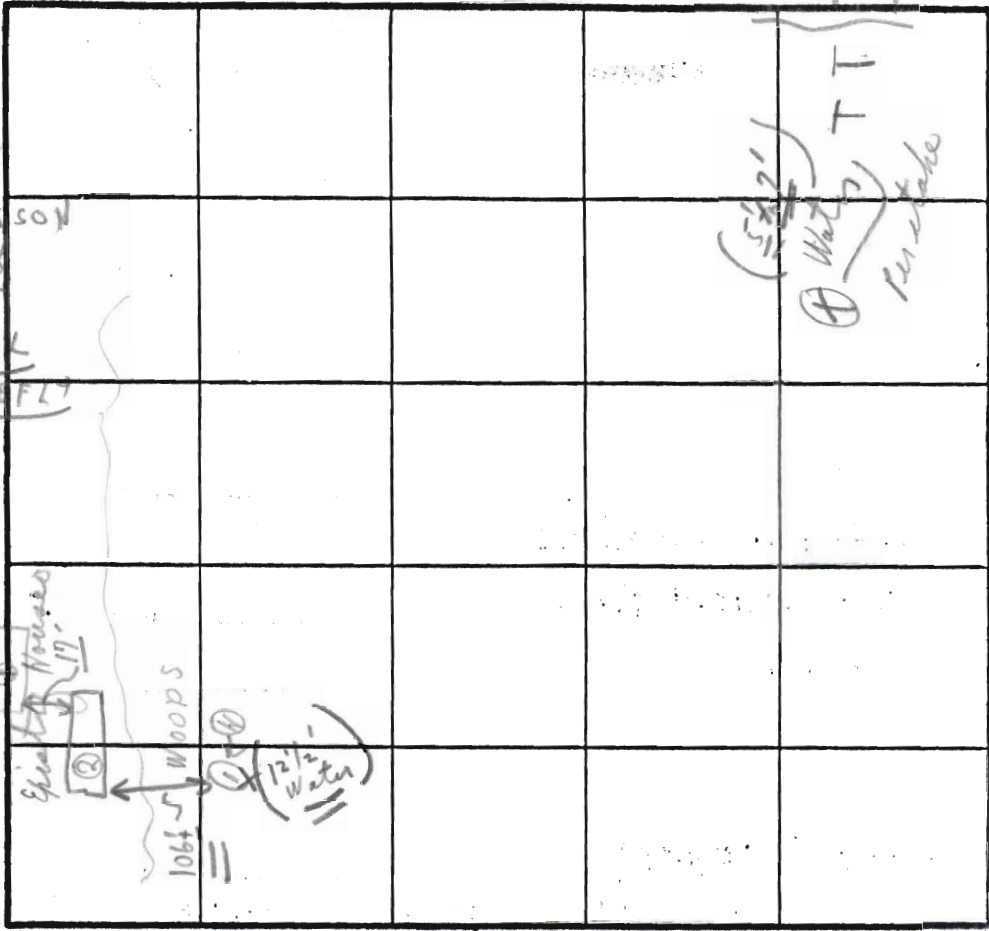
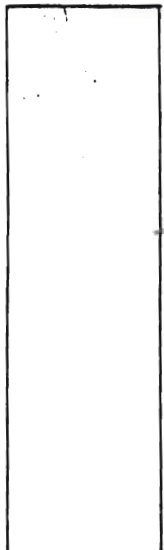

R1108

INDICATE NORTH - NAME ADJOINING ROADWAY AS BASE LINE.

CLAY TO REDDISH BROWN GRIT

| DATE     | TEST NO. | DEPTH   | PRE-WET |       | TEST - 1" DROP |       | TIME           |
|----------|----------|---------|---------|-------|----------------|-------|----------------|
|          |          |         | START   | STOP  | START          | STOP  |                |
| 9/15/88  | 1A       | 4'      | 12:15   | 12:17 | 12:17          | 12:18 | 1-2 min        |
| Thursday | 1B (H)   | 12 1/2' | Water   | :     | :              | :     | Fact for water |
|          | 2A       | '       | :       | :     | :              | :     |                |
|          | 2B       | '       | :       | :     | :              | :     |                |
|          | 3A       | '       | :       | :     | :              | :     |                |
|          | 3B       | '       | :       | :     | :              | :     |                |
|          | 4A       | '       | :       | :     | :              | :     |                |
|          | 4B       | '       | :       | :     | :              | :     |                |
|          |          |         |         |       |                |       |                |
|          |          |         |         |       |                |       |                |

REMARKS: (Tests in Woods) HOLD FOR WET SEASON  
 TYPE OF SOIL: Not per stake  
 TESTED BY: CBE  
 ALSO PRESENT: { Woody Lenton }  
SIB ABEL

# HOWARD COUNTY HEALTH DEPARTMENT

JOYCE M. BOYD, M.D., M.P.H.  
COUNTY HEALTH OFFICER



Bureau of Environmental Health  
3525 Ellicott Mills Drive  
Ellicott City, Maryland 21043

Director - 461-9956  
Water & Sewerage, Permits - 461-9933  
Community Environmental Health - 461-9944  
Technical Services - 461-9955

October 25, 1988

T.A. & T. Associates  
5560 Sterrett Place  
Columbia, Maryland 21044

RE: Percolation Testing  
4 Parcels (Route 108)  
Tax Map 34 Parcel 134

To Whom It May Concern:

Percolation testing conducted September 15, 1988 on the above property indicated limited satisfactory soil conditions.

Further review requires submission by a registered engineer of a plat showing certified locations and elevations of test holes and house and well sites. This should be submitted within sixty (60) days to allow field verification if necessary.

Follow-up testing in the wet season will likely be required.

If you have any questions regarding this matter, please feel free to contact me at the above address or by calling 461-9933.

Very truly yours,

Craig Williams, Director  
Water and Sewerage Program

CW:JR

cc: Tax Assessment Office  
Boender Associates

INCORPORATED  
SUITE 102-107 TOWN & COUNTRY PROFESSIONAL BUILDING  
ELLCOTT CITY, MARYLAND 21043  
BALTIMORE 301-465-7777

TO:

DATE: April 10, 1988

ATTENTION: Sid Able

RE: T.A. & T. Property

Howard County Health Department

FILE: 8823

- GENTLEMEN:

- WE ARE SENDING YOU  ATTACHED  UNDER SEPARATE COVER VIA \_\_\_\_\_ THE FOLLOWING ITEMS:  
 SHOP DRAWINGS  PRINTS  PLANS  SAMPLES  SPECIFICATIONS  
 COPY OF LETTER  \_\_\_\_\_

| copies | date | description                     |
|--------|------|---------------------------------|
| 2      |      | Perc test plats                 |
| 1      |      | Check in the amount of \$400.00 |
| 4      |      | Perc test applications          |

THESE ARE TRANSMITTED AS CHECKED BELOW:

- FOR APPROVAL  APPROVED AS SUBMITTED  RESUBMIT \_\_\_\_\_ COPIES FOR APPROVAL  
 FOR YOUR USE  APPROVED AS NOTED  SUBMIT \_\_\_\_\_ COPIES FOR DISTRIBUTION  
 AS REQUESTED  RETURNED FOR CORRECTIONS  RETURN \_\_\_\_\_ CORRECTED PRINTS  
 FOR REVIEW AND COMMENT  for perc date  
 FOR BIDS DUE \_\_\_\_\_ 19\_\_\_\_  PRINTS RETURNED AFTER LOAN TO US

REMARKS:

RECEIVED: Craig Wilke DATE: APRIL 11, 1988

COPIES:

IF ENCLOSURES ARE NOT AS NOTED, KINDLY NOTIFY US AT ONCE.

SIGNED: \_\_\_\_\_

BOENDER ASSOCIATES, INC.

IMPORTANT MESSAGE

FOR DATE

8/13/88

Not tested

Not Staked

RF

8/8/88

Hold to Reschel. when  
Dennis R. informs me that  
Lots have been Staked. S: alud