

# PERMIT

## SEWAGE DISPOSAL SYSTEM

### DEPARTMENT OF HEALTH AND MENTAL HYGIENE

P 50031

A 48653

DISTRICT 4th

DATE 5/13/94

DATE SYSTEM APPROVED 5/31/94

INSPECTOR (CW)

HOWARD COUNTY HEALTH DEPARTMENT

BUREAU OF ENVIRONMENTAL HEALTH

~~461-9933~~ 313-2640

INDEXED

Walter King P & H Contractors

IS PERMITTED TO INSTALL  ALTER

ADDRESS 50305 King's Court, Frederick, Maryland 21702 PHONE 831-4070

SUBDIVISION McKendree Estates LOT Parcel B ROAD 2600 McKendree Road

PROPERTY OWNER Wheeler Development, Inc. J.S + L.W. Peatt

ADDRESS \_\_\_\_\_

SEPTIC TANK CAPACITY 1250 GALLONS

NUMBER OF BEDROOMS 4

180 SQUARE FEET PER BEDROOM

LINEAR FEET OF TRENCH REQUIRED 240

TRENCHES - Trench to be 3 feet wide. Inlet 3 feet below original grade. Bottom maximum depth 5 feet below original grade. Effective area begins at 3 feet below below original grade. 2 feet of stone below distribution pipe.

LOCATION - Place the distribution box at the highest point in the sewage easement or approximately as follows: 20 feet to the rear of the house and 25 feet from the garage, at the surveyor's stake. Run the trenches on contour away from the house.

NOTES - No trench to exceed 100 feet in length. Provide 6" - 8" diameter cleanout and cap to grade or above on septic tank. OK MR 1/26/94 change per Pool review 4/29/94

PLANS APPROVED BY Raymond Hodges/Mark Rifkin REVISED DATE 12/29/93

COVER NO WORK UNTIL INSPECTED AND APPROVED

NEITHER THE HOWARD COUNTY COUNCIL NOR THE HEALTH DEPARTMENT IS RESPONSIBLE FOR THE SUCCESSFUL OPERATION OF ANY SYSTEM

NOTE: CLEANOUT REQUIRED EVERY 70 FEET OF SEWER LINE AND/OR AT 90° SWEEPS IN LINES FROM HOUSE TO DRAIN FIELDS, 90° ELBOWS NOT ACCEPTABLE.

NOTE: ALL PARTS OF SEPTIC SYSTEMS (I.E. TANK, DISTRIBUTION BOX TRENCHES) TO BE 100 FEET FROM WELL (UNLESS OTHERWISE SPECIFICALLY AUTHORIZED)

NOTE: IF DEEP TRENCH(ES) ARE USED CALL FOR INSPECTION BEFORE AND AFTER PLACING GRAVEL IN TRENCH(ES)

NOTE: NO DRY WELL SHALL EXCEED 15 FOOT IN DIAMETER NO ABSORPTION TRENCH TO EXCEED 100 FEET IN LENGTH

NOTE: ALL PIPE FROM HOUSE TO SEPTIC TANK MUST BE CAST IRON OR SCHEDULE 35/40 PVC OR ABS

PERMIT VOID AFTER TWO YEARS

NOTE: INSTALL STAND PIPE ON SEPTIC TANK AND DRY WELL STAND PIPES MUST BE 8 INCHES IN DIAMETER CAST IRON. CONCRETE OR TERRA COTTA OR PVA OR ABS ACCEPTED. IF TOP OF SEPTIC TANK IS DEEPER THAN 3 FEET. MANHOLE TO GRADE REQUIRED.

NOTE: DISTRIBUTION BOXES MUST HAVE BAFFLES

BLDG. PERMIT SIGNED

AND RETURNED 7/20/94

Serial # 53335

dech

\*INSTALLER IS RESPONSIBLE FOR OBTAINING FINAL APPROVAL ON THIS PERMIT

HD-260(6-90)

\*CALL 461-9933 FOR INSPECTION OF SEPTIC SYSTEM.

A 48653

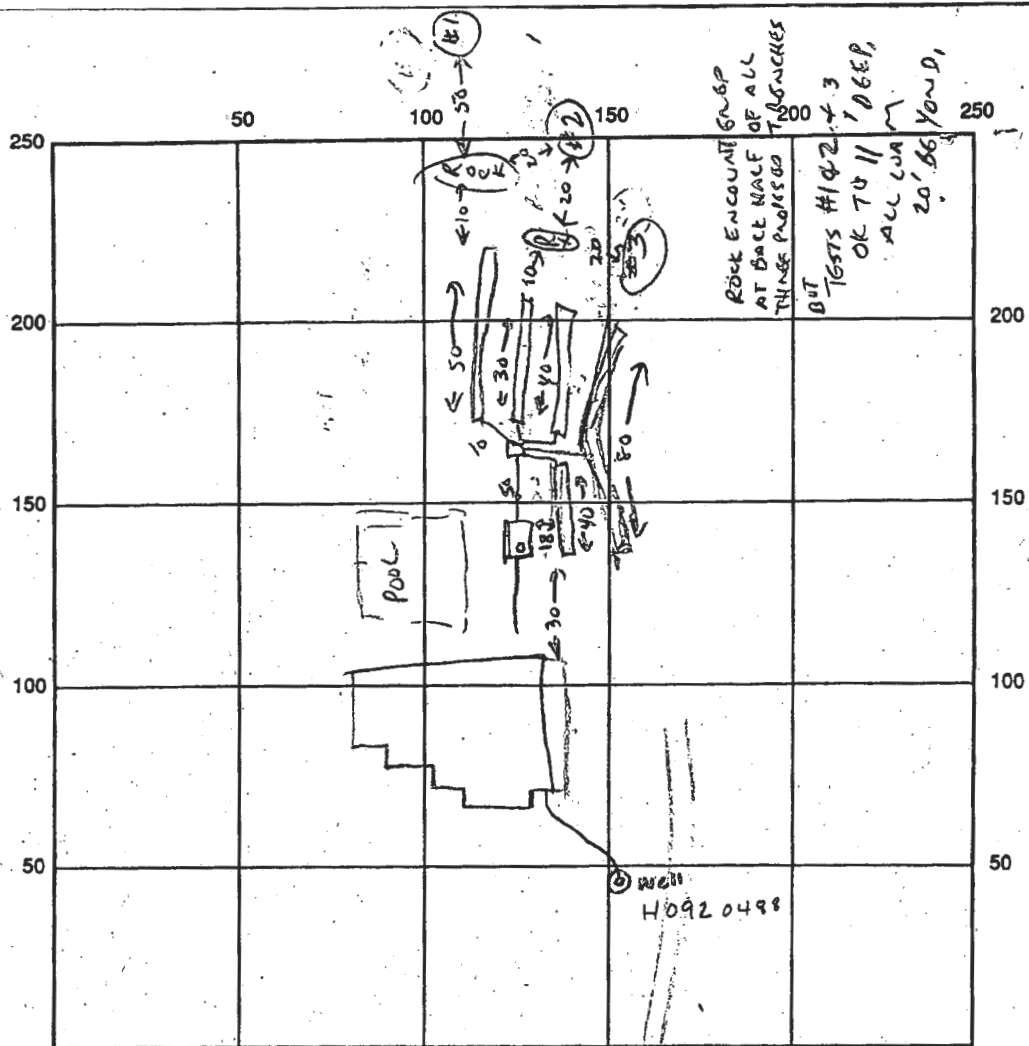

INDICATE NORTH - NAME ADJOINING ROADWAY AS BASE LINE

SEPTIC TANK LEVEL ✓ CLEANOUTS ST ✓

DISTRIBUTION BOX LEVEL ✓

DRAIN FIELD/TITLE DEPTH 5 FT. TRENCH WIDTH 3 FT. INLET DEPTH 3 FT.

EFFECTIVE GRAVEL DEPTH 2 FT. TOTAL LENGTH 240' FT.

NUMBER OF TRENCHES 5 ONE SIDEWALL/BOTTOM AREA 120 SQ. FT.

DRYWALL INSIDE DIAMETER — FT. EFFECTIVE DEPTH BELOW INLET — FT.

ABSORBENT AREA — SQ. FT.

REMARKS: 5/26 HIT MASON ROCK - GNEISS BOULDERS TO 80% OF VOLUME 50' FROM START OF FIRST TRENCH. STOPPED TRENCH AT 50'. VIBRATES OK 50' BEYOND AND ALSO 20' BELOW ROCK SPT. APPEARS TO BE LOCALIZED PROBLEM. OK TO CONTINUE AS PER ORIGINAL PLAN, PROVIDING "REASONABLE" BENTH TO THE ROCK LOCATION. (CW) 5/27/94 HIT ROCK AGAIN  
TRENCH 3 & 4 OK TO COVER 5/27/94 - ALL TRENCHES COMPLETE 5/31/94 (CW)

5/19/94 WPI OK TO COVER ALL

DATE SYSTEM APPROVED 5/31/94 INSPECTOR CW



