

Bureau of Environmental Health

7178 Gateway Drive Columbia, MD 21046  
(410) 313-2640 Fax (410) 313-2648  
TDD (410) 313-2323 Toll Free 1-866-313-6300  
website: www.hchealth.org

*Peter L. Beilenson, M.D., M.P.H., Health Officer*

4/23/2010

Homeowner  
2240 Route 97  
Cooksville, MD 21723

RE: Complaint Investigation -  
Leaking Septic Tank

Dear Sir/Madam:

As a follow-up to the inspection conducted on April 22<sup>nd</sup>, 2010 for the above referenced complaint this is to advise you that your septic system requires immediate attention. Certain conditions were observed during the inspection such as a sewage odor and wastewater pooling to the grounds surface which indicate the septic system is not functioning properly. Based on these observations, this situation is considered a nuisance under section 12.110 of the Howard County Code. The responsibility for the abatement of the nuisance belongs to the person (s) who own or rent the property on which the nuisance occurs.

It is imperative that a septic contractor come out to your property to pump out the septic tank. Upon the septic contractor's evaluation of the system a repair to the existing sand mound system may be required. If this should happen please contact the Health Dept. immediately.

If you have further questions regarding this matter please contact our office at 410-313-1771.

Sincerely,

Heidi Scott  
Bureau of Environmental Health  
Well & Septic Program

Cc:  
Well & Septic File

SITE INSPECTION SHEET

OWNER: \_\_\_\_\_ PHONE #: \_\_\_\_\_

ADDRESS: \_\_\_\_\_ CONTRACTOR: \_\_\_\_\_

\_\_\_\_\_ WELL TAG #: \_\_\_\_\_

SUBDIVISION: \_\_\_\_\_ LOT: \_\_\_\_\_ COUNTY #: \_\_\_\_\_

PROPOSAL: Inspect mound area on Historic Property  
at corner of Miller's Mill Rd & Rte. 97

LOCATION DIAGRAM

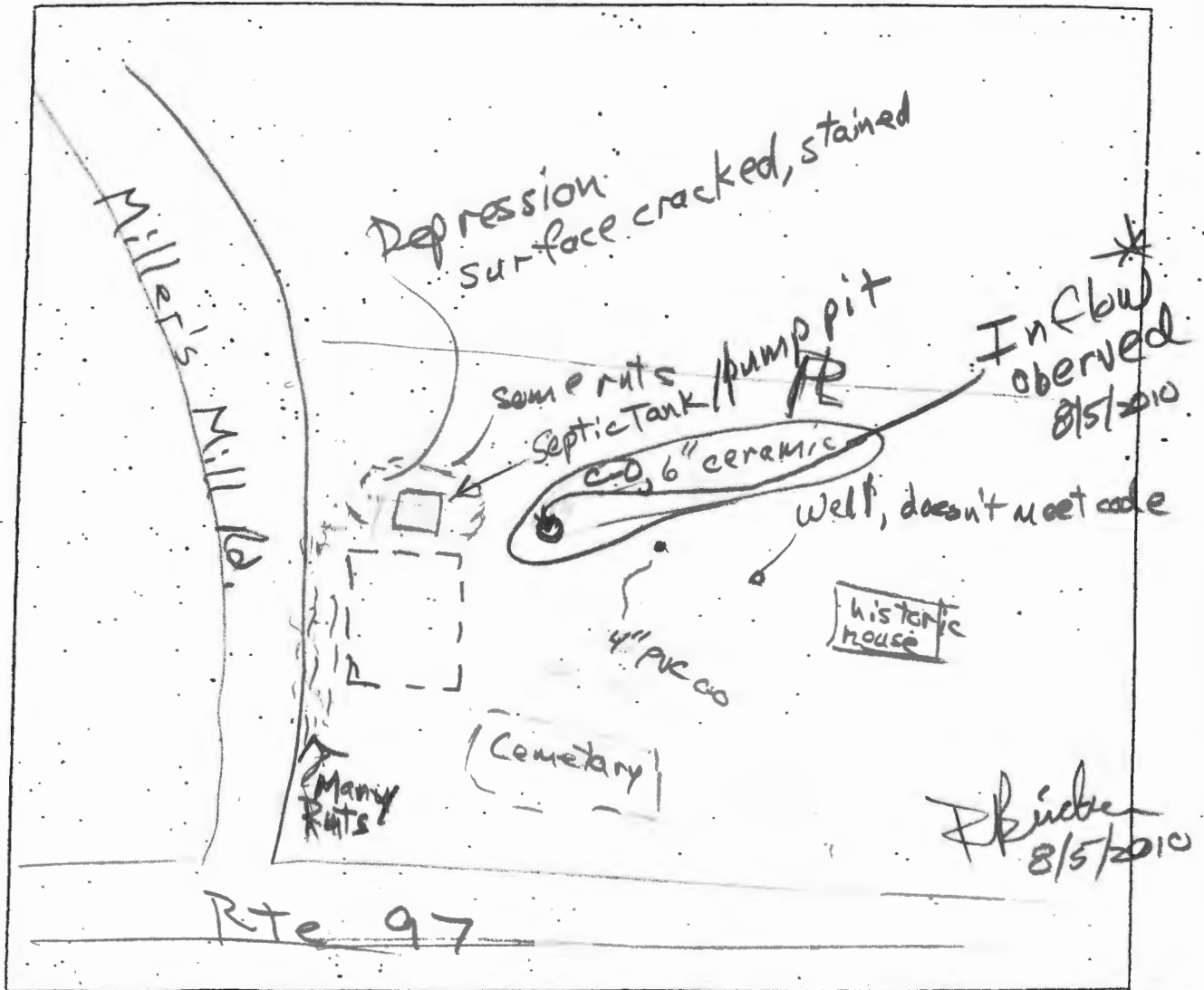

COMMENTS: Site Inspection 8/5/2010 ~ 4:30 pm

Knocked on door - no answer. Inspected Well and Septic

- \* Well is definitely in need of maintenance/repair
- \* 2-pc metal cap lays on top casing that has been mangled.
- No conduit; roped wrapped around outside; electrical conductor not noticed.

E 10.000  
N 9.800

FURNISH AND INSTALL PUMPING CHAMBER INCLUDING PUMP, VENT CONTROLS AND ALARM, COMPLETE. SEE DETAIL THIS SHEET.

ROAD  
EXISTING PAVING  
FENCED

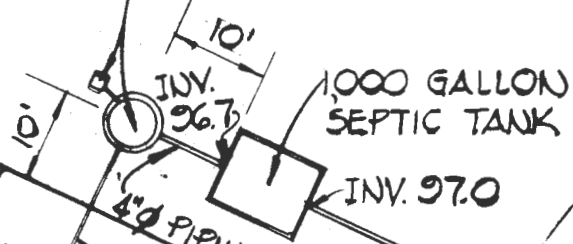

MOUND SEP. TANK SYSTEM

2" MANIFOLD P.V.C. PIPE

4" PIPING @ 4%

1" P.V.C. PIPE DISTRIBUTION LATERAL SEE PIPE LATERAL LAYOUT DETAIL

3:1 TYP.

S.B.D.

S.B.D.

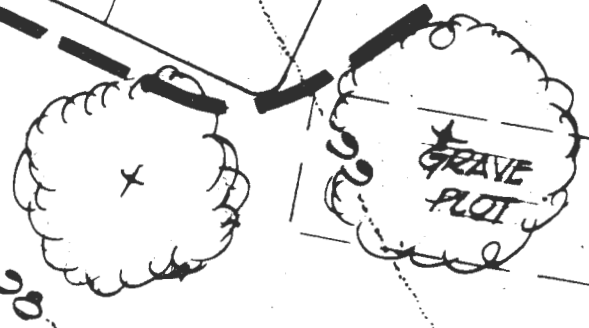

30

100

101