

PERMIT

SEWAGE DISPOSAL SYSTEM
HOWARD COUNTY HEALTH DEPARTMENT
BUREAU OF ENVIRONMENTAL HEALTH
410-313-2640

P 515300

A REPAIR

ISSUE DATE 6/21/2001

APPROVAL DATE 8/8/01

7/13/01
Repair
10:00
8/8/01-2=30 Final

04-315316

INDEXED

Fogles Septic Clean, Inc _____ IS PERMITTED TO INSTALL _____ ALTER

ADDRESS 580 Obrecht Road, Sykesville, MD 21784 PHONE 410-795-5670

SUBDIVISION _____ LOT NUMBER _____ ADDRESS 280 E Watersville Road

PROPERTY OWNER Evelyn Fountain PROPERTY OWNER'S ADDRESS Same

SEPTIC TANK CAPACITY 1200+ GALLONS (Plastic tank)

PUMP CHAMBER CAPACITY _____ GALLONS

NUMBER OF BEDROOMS 3

SQUARE FEET PER BEDROOM 180

LINEAR FEET OF TRENCH REQUIRED 180

Neighbor's Property

TRENCHES: Trenches to be 3 feet wide. Inlet 1.5 feet below original grade. Bottom maximum depth 2.5 feet below original grade. 1.0 feet of stone below distribution box. (use 1" infiltrators)

LOCATION: REPAIR - PURPOSE - Existing septic system has failed.
Call for inspection when ground is opened so sanitarian can recommend repair. 6-21-01

Install 2-90' trenches near to perc hole closer to house
Trenches to be 7' edge to edge
old tank to be pumped and collapsed.

PLANS APPROVED DICC DATE 7-8-01

- PERMIT VOID AFTER 2 YEARS
- NOTE: CONTRACTOR RESPONSIBLE FOR SCHEDULING A PRE-CONSTRUCTION INSPECTION FOR ALL INSTALLATIONS
- NOTE: TOP OF SEPTIC TANKS ARE TO BE NO DEEPER THAN 3.0 FEET BELOW FINISH GRADE
- NOTE: WATERTIGHT SEPTIC TANKS REQUIRED
- NOTE: CLEANOUT REQUIRED EVERY 70 FEET OF SEWER LINE AND/OR AT 90° SWEEPS IN LINES FROM HOUSE TO DRAIN FIELDS, 90° ELBOWS ARE NOT ACCEPTABLE
- NOTE: ALL PARTS OF SEPTIC SYSTEMS (I.E. TANK, DISTRIBUTION BOX, DRAINFIELDS) TO BE 100 FEET FROM ANY WATER WELL UNLESS OTHERWISE SPECIFICALLY AUTHORIZED
- NOTE: NO ABSORPTION TRENCH TO EXCEED 100 FEET IN LENGTH UNLESS SPECIFICALLY AUTHORIZED
- NOTE: ALL PIPE FROM HOUSE TO SEPTIC TANK MUST BE CAST IRON OR SCHEDULE 35/40 PVC OR ABS
- NOTE: MANHOLE RISERS REQUIRED ON ALL SEPTIC TANKS AND PUMP CHAMBERS
- NOTE: DISTRIBUTION BOXES MUST HAVE BAFFLES
- NOTE: IF PUMPED SEPTIC SYSTEM REQUIRED, (1) SEPTIC PUMP DETAIL TO BE PROVIDED BY INSTALLER PRIOR TO ISSUANCE OF SEPTIC PERMIT (2) PUMP PERFORMANCE TEST IS NECESSARY PRIOR TO HEALTH DEPARTMENT APPROVAL OF SEPTIC PERMIT

NEITHER THE HOWARD COUNTY COUNCIL NOR THE HEALTH DEPARTMENT IS RESPONSIBLE FOR THE SUCCESSFUL OPERATION OF ANY SYSTEM
PERMITTEE RESPONSIBLE FOR OBTAINING FINAL APPROVAL ON THIS PERMIT
CALL 410-313-2640 FOR INSPECTION OF SEPTIC SYSTEM

4515300

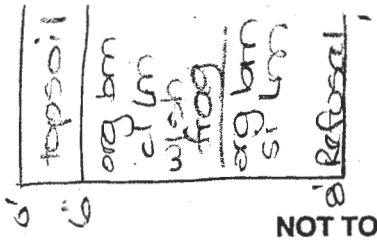

② 10:44 10:47 10:52
 ① 10:28 10:29 10:31

NOT TO SCALE

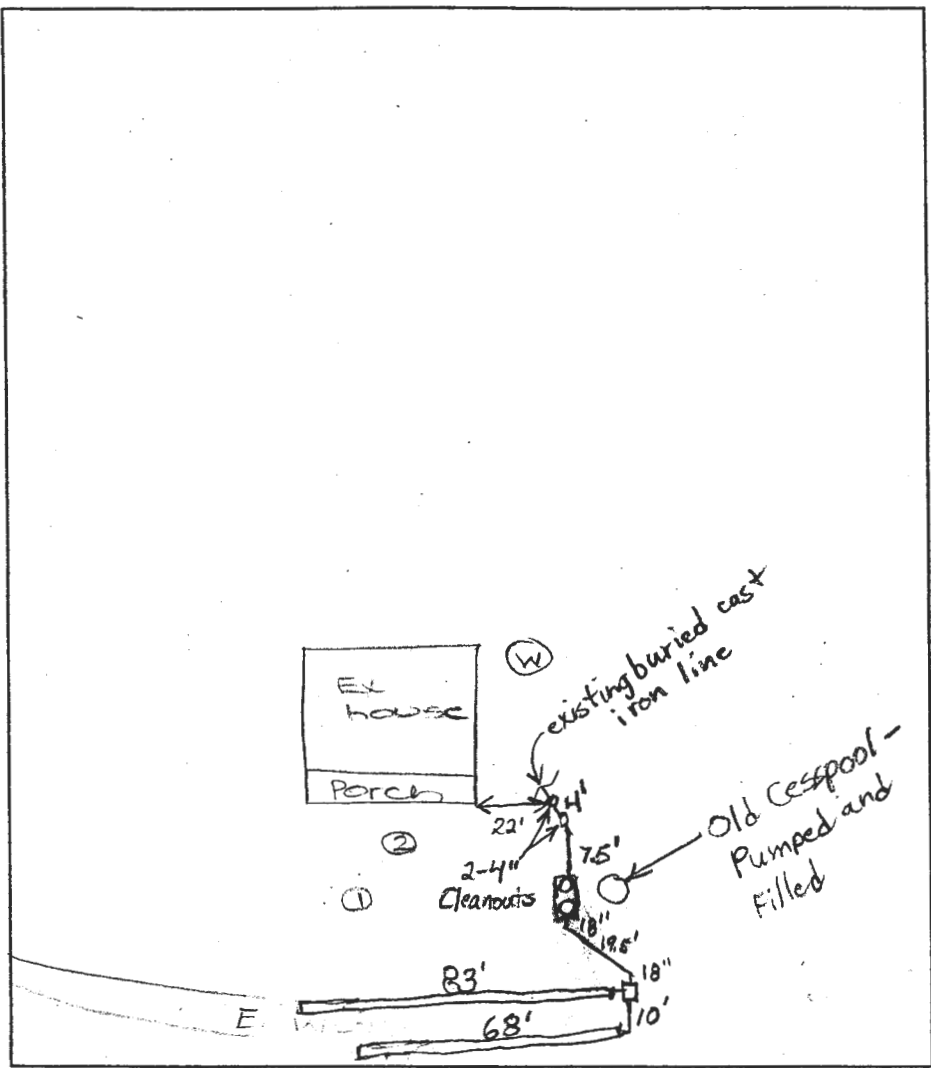

TRENCH DATA	
TRENCH WIDTH	3'
TRENCH INLET DEPTH	2'
TRENCH BOTTOM DEPTH	3'
DEPTH OF STONE	Infiltrator
NUMBER OF TRENCHES	2
TOTAL TRENCH LENGTH	151'
ABSORBENT AREA	453 sq. ft.
DISTRIBUTION BOX LEVEL	Yes
BAFFLE IN DISTRIBUTION BOX	Yes

SEPTIC TANK DATA	
SEPTIC TANK	1250 Plastic GALLONS
MANHOLE RISER	2
6 INCH INSPECTION PORT	No
PUMP CHAMBER DATA	
PUMP CHAMBER GALLONS	
MANHOLE RISER	
ALARM	
PUMP PERFORMANCE TEST	

PRE-CONSTRUCTION INSPECTION: _____

INSPECTION COMMENTS: 8/8/01 System satisfactory. Plastic septic tank and infiltrators used. Old cesspool pumped and filled with dirt. O.K. to cover. (BB)

INSPECTOR B. Baker DATE SYSTEM APPROVED 8/8/01