

**Bureau of Environmental Health**  
 8930 Stanford Boulevard, Columbia, MD 21045  
 Main: 410-313-2640 | Fax: 410-313-2648  
 TDD 410-313-2323 | Toll Free 1-866-313-6300  
[www.hchealth.org](http://www.hchealth.org)  
 Facebook: [www.facebook.com/hocohealth](http://www.facebook.com/hocohealth)

Maura J. Rossman, M.D., Health Officer

RECEIPT DATE: 10/3/18 **ONSITE SEWAGE DISPOSAL SYSTEM** P 564018

APPROVAL DATE: 1/18/19 SEC **PERMIT:** **REPAIR** A \_\_\_\_\_

PROPERTY ADDRESS: 10639 Breezewood Drive

SUBDIVISION: \_\_\_\_\_ LOT: \_\_\_\_\_ TAX ID: 03-303241

CONTRACTOR: Fogle's Septic Clean Inc. EMAIL: \_\_\_\_\_

CONTRACTOR ADDRESS: 500 Obercht Road, Sykesville, MD 21784 PHONE: 410-795-5670

PROPERTY OWNER: Htin Aung EMAIL: \_\_\_\_\_

OWNER ADDRESS: 10639 Breezewood Drive, Woodstock, MD 21163 PHONE: 443-844-2434

SEPTIC TANK SIZE (GALLONS): \_\_\_\_\_ PUMP CHAMBER CAPACITY (GALLONS): 1000 PUMP SIZE: \_\_\_\_\_

NUMBER OF BEDROOMS: 3 HOUSE SQ. FT. \_\_\_\_\_ APPLICATION RATE: 1.2 gpd/ft<sup>2</sup>

DISTRIBUTION SYSTEM: GRAVITY FED  LOW PRESSURE DOSED

TRENCHES:	LINEAR FEET REQUIRED: <u>63'</u>	INLET DEPTH: <u>2'</u>
	TRENCH WIDTH: <u>3'</u>	MAXIMUM BOTTOM DEPTH: <u>5'</u>
	MINIMUM SPACE BETWEEN TRENCHES: <u>9'</u>	EFFECTIVE AREA BEGINNING DEPTH: <u>2'</u>

LOCATION: **TO BE STAKED BY SANITARIAN DURING PRE-CONSTRUCTION INSPECTION.**

NOTES: Install a 1000-gallon pump tank, Gould's pump TBD. Install 2 x 32' trenches on contour above perc hole C.

ISSUED BY: Sarah Collins ISSUE DATE: 10/18/18 EXPIRATION DATE: 10/18/19

- NOTE: **CONTRACTOR MUST SCHEDULE A PRE-CONSTRUCTION INSPECTION PRIOR TO BEGINNING ANY INSTALLATION**
- NOTE: CONTRACTOR MUST SCHEDULE AN INSPECTION AND GAIN APPROVAL OF ALL COMPONENTS PRIOR TO COVERING
- NOTE: STONE MUST BE APPROVED BY HEALTH DEPARTMENT AND GRAVEL TICKET MUST BE AVAILABLE FOR REVIEW.
- NOTE: WATERTIGHT SEPTIC TANKS REQUIRED
- NOTE: ALL PARTS OF SEPTIC SYSTEM SHALL BE AT LEAST 100 FEET DOWNGRADIENT FROM ANY WATER WELL
- NOTE: MANHOLE RISERS REQUIRED ON ALL SEPTIC TANKS AND PUMP CHAMBERS
- NOTE: **AN ELECTRICAL PERMIT IS REQUIRED FOR INSTALLATION OF ANY ELECTRICAL COMPONENTS OF THE SYSTEM**  
 ELECTRICAL PERMIT ISSUED E 19000064
- NOTE: **THE HCHD DOES NOT WARRANT ANY SYSTEM AND CANNOT GUARANTEE THE PERFORMANCE OF THIS SYSTEM AS DESIGNED. BY ACCEPTING THIS PERMIT, THE OWNER AND/OR APPLICANT ACKNOWLEDGE THAT THE SPECIFICATIONS DETAILED IN THIS DESIGN ARE ONE POSSIBLE OPTION AND THAT THE HCHD WILL REVIEW OTHER PROPOSALS. YOU HAVE THE OPTION TO SEEK THE ADVICE OF A QUALIFIED DESIGN CONSULTANT OR PROFESSIONAL ENGINEER FOR FURTHER GUIDANCE.**
- NOTE: MDE RECOMMENDS SEPTIC TANKS, BAT, AND OTHER PRETREATMENT UNITS BE PUMPED AT A FREQUENCY ADEQUATE TO ENSURE THAT SOLIDS ARE NOT DISCHARGED TO THE DISPOSAL AREA

**NEITHER THE HOWARD COUNTY COUNCIL NOR THE HEALTH DEPARTMENT IS RESPONSIBLE FOR THE SUCCESSFUL OPERATION OF ANY SYSTEM.  
 PERMITTEE RESPONSIBLE FOR OBTAINING FINAL APPROVAL ON THIS PERMIT.  
 CALL 410-313-1771 TO SCHEDULE INSPECTIONS.**

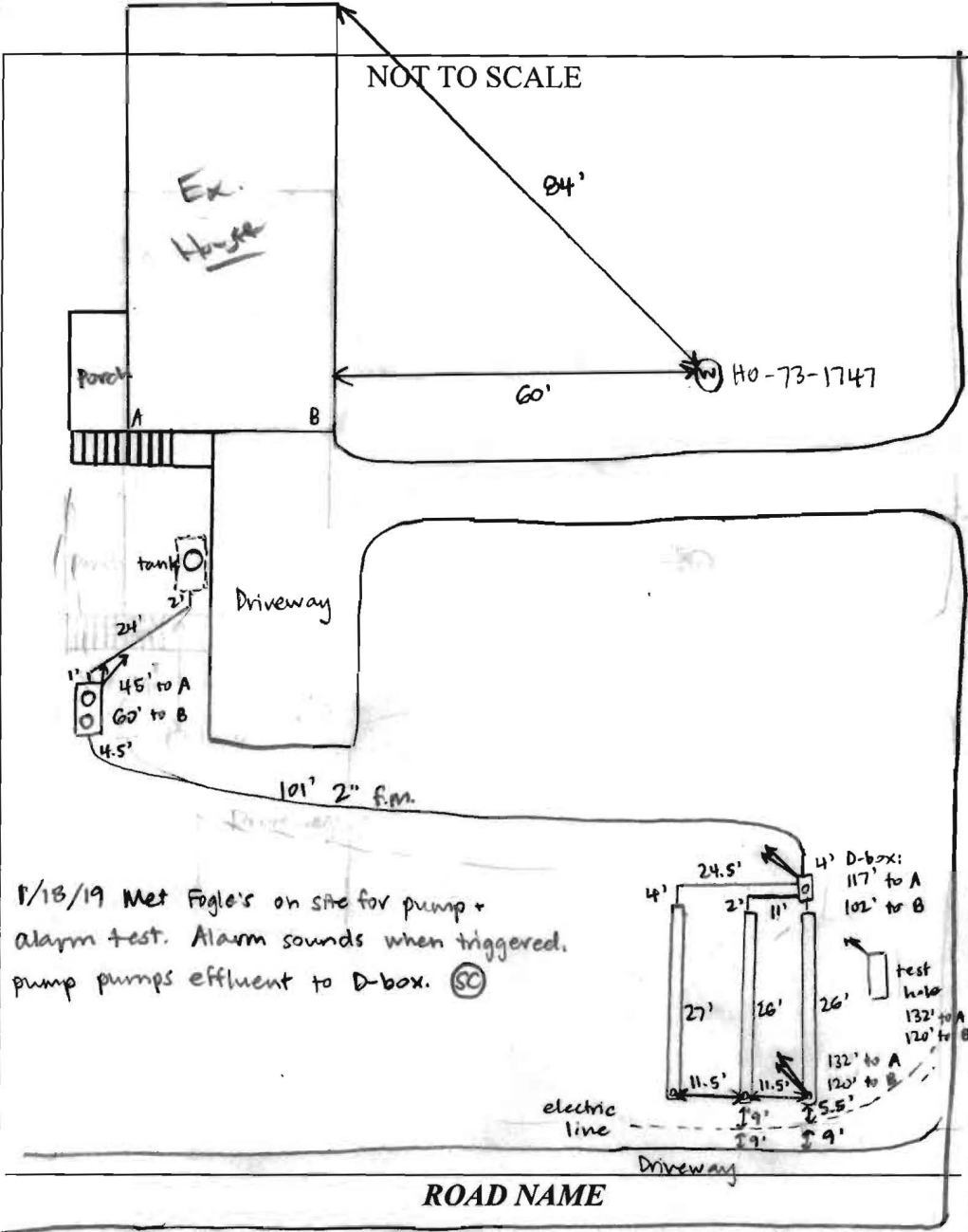

TRENCH/DRAINFIELD DATA		
WIDTH	INLET	BOTTOM
3'	2'	5'
NUMBER OF TRENCHES		3
TOTAL LENGTH		79'
ABSORPTION AREA		237' + SIDEWALL
DISTRIBUTION BOX LEVEL		YES
DISTRIBUTION BOX BAFFLE		YES
DISTRIBUTION BOX PORT		YES

SEPTIC TANK DATA	
SEPTIC TANK I LEVEL	existing
MANUFACTURER	?
CAPACITY	1000 GAL
SEAM LOC	MID
TANK LID DEPTH	6'
BAFFLES	YES
BAFFLE FILTER	NO
MANHOLE LOC	MID
6" PORT LOC	NONE
WATERTIGHT TEST	NO
SLOTTED	NO
DATE ON LID	—

PUMP/SEPTIC TANK LEVEL	YES
MANUFACTURER	BABYLON
CAPACITY	1000 GAL
SEAM LOC	TOP
TANK LID DEPTH	1-2'
BAFFLES	NO
BAFFLE FILTER	NO
MANHOLE LOC	FRONT + REAR
6" PORT LOC	NONE
WATERTIGHT TEST	NO
SLOTTED	NO
DATE ON LID	11-21-18
Pump:	

1/18/19 Met Fogle's on site for pump + alarm test. Alarm sounds when triggered, pump pumps effluent to D-box. (SC)

**PRE-CONSTRUCTION:**

10/18/18 Met James Harrison and the homeowner on site. Pulled 100' off well and neighbor's well across the street. Laid out 1 x 32' trench on contour - 2<sup>nd</sup> trench to be 12' CTC. Measured off top trench and determined that a replacement system can fit below initial. Room for more replacements closer to driveway but well would need to be moved to meet setback of 100'. Set 1000-gallon pump tank after septic tank, keep cover to 3' or less. Run pump line next to driveway to allow for future replacements. (SC)

**INSTALLATION:** 1/7/19 Met w/ Fogles onsite to go over layout. OK to set P.T. down hill in low area approx. 25' from ex. S.T. Trench layout confirmed w/ contractor 2x 32' as per 10/18/18 meeting w/ Scollers. (Kam) 1/8/19

Electric line next to neighbor's driveway marked, trenches would be too close as laid out. Install 3 x 25' trenches instead - shot contour + laid out 25' 3rd trench. Dig a test hole above upper trench to 10', no moisture. Replacement well on property to be drilled further S on property, replacement septic to be closer to ex. well. (SC) 1/9/19 Trenches installed, T1 left open for inspection + T2/T3 left open at ends - 1x1.5' to stone + 3' wide. Pump tank set, area was rocky. Fogle's bedded with dirt. (SC) 1/10/19 Force main complete, need pump + alarm test.

FINAL INSPECTOR Sarah Collins DATE OF APPROVAL 1/18/19

Fogle's to partially fill pump tank with clean water for P.A. (SC)

## Collins, Sarah

---

**From:** Collins, Sarah  
**Sent:** Friday, October 19, 2018 1:04 PM  
**To:** 'Htin Linn'  
**Cc:** Wolf, Kevin  
**Subject:** RE: Septic system info

Hi Linn,

I have passed the specs of the plastic tank onto my supervisor Kevin so that he can look things over. If this tank is approved and you choose another contractor to install the system, they would have to install this exact tank that we approved.

The system will require 63' of trench and we found an area for 2 x 32' trenches. The inlet will be 2' and the bottom 5'. I would estimate around 175' of force main is required. And as of now, we are requiring the installation of a 1000-gallon concrete pump chamber. We would also like to see a larger manhole installed on the existing tank to reduce the weight of the earth cover because the tank is set so deep.

Have a good weekend,  
Sarah

**From:** Htin Linn [<mailto:linn.htin@gmail.com>]  
**Sent:** Friday, October 19, 2018 9:07 AM  
**To:** Collins, Sarah  
**Subject:** Re: Septic system info

Good morning Sarah,

thanks for the update.

Could you please send me the design of the drain field and the measurement? I am dealing with another company and they need it for estimate. Please don't deal with James anymore. Please contact me directly if you need.

I am getting estimate from Fogel Septic and Freeform Septic.

Thanks a lot for your patience and help.

Htin Linn Aung (Linn)

On Thu, Oct 18, 2018, 3:46 PM Collins, Sarah <[SCollins@howardcountymd.gov](mailto:SCollins@howardcountymd.gov)> wrote:

Hi Linn,

The supervisor that handles the Bay Restoration Funding is in a meeting all afternoon but I will discuss it with him tomorrow morning.

Thanks,

Sarah

**From:** Htin Linn [mailto:[linn.htin@gmail.com](mailto:linn.htin@gmail.com)]  
**Sent:** Wednesday, October 17, 2018 3:50 PM  
**To:** Collins, Sarah  
**Cc:** [jvh866@gmail.com](mailto:jvh866@gmail.com)  
**Subject:** Re: Septic system info

Thanks for the update. See you tomorrow.

On Wed, Oct 17, 2018, 3:39 PM Collins, Sarah <[SCollins@howardcountymd.gov](mailto:SCollins@howardcountymd.gov)> wrote:

Hi Linn,

I spoke with my supervisor and the Bay Restoration Funding is currently depleted. The next round of funding will come in December or January and you would likely be third on the list, meaning you'd likely be funded for the septic tank. If you decide to do this option, the trenches cannot be installed ahead of time. We could have the permit ready and release it when the funds area available.

In terms of the septic field that we proposed yesterday, we need to maintain a greater setback from the well than what we measured in the field. We should be able to do this by installing two shorter trenches that stay closer to the neighbor's driveway. Hopefully we can get 100' and you won't need to worry about signing any waivers for being closer to the well.

If you'd like to not go with the Bay Restoration Funding, we can work to get a permit together now and James can start the install soon. I can meet out there tomorrow to measure the shorter trenches.

Let me know if you have any questions.



# HOWARD COUNTY HEALTH DEPARTMENT

64018

DATE 10/3/18

AP 5  
PHONE # 596-0057

Received From

HTIU LINN AUNG

PHONE #

For

Plnc Repair - 10639  
Breezewood Dr

- CASH
- CHECK

NO. 590

Three hundred thirty Dollars

\$ 330.00

Received By

J King