

Bureau of Environmental Health
 7178 Columbia Gateway Drive, Columbia, MD 21046-2147
 Main: 410-313-2640 | Fax: 410-313-2648
 TDD 410-313-2323 | Toll Free 1-866-313-6300
 www.hchealth.org
 Facebook: www.facebook.com/hocohealth
 Twitter: HowardCoHealthDep

Maura J. Rossman, M.D., Health Officer

DEMOLITION REQUEST FORM

(Please fill in all blanks)

Information of Property to be Demolished:

Cynthia Keller Scheib 9598 Route 108, Ellicott City, MD 21042
 Current Owner's Name Property Address

P/O Reserve Columbia Woodlands 12
 Subdivision (if applicable) Lot #

Shirly Eckles 30 67 02-206692
 All Prior Owners' Names (if requested or known) Tax Map Parcel # Tax ID #

Demo SFD
 Purpose/Reason for Demolition

Redevelopment in future
 Future plans of property after demo (i.e. subdivision, parking lot, re-build new house, etc...)

If a subdivision, SDP# N/A Has the structure(s) been deemed unsafe by DILP YES NO

UTILITY RECORDS:

Property currently connected to public water YES X NO

Property currently connected to public sewer YES X NO

Does the property currently have any wells and/or septic systems X YES NO

→ Explain: This is assumed due to the fact that the bureau of utilities states that it is not on there system for Sewer or water. However, I have not identified a well or septic location on site.

*Note: Any wells and/or septic systems that are to remain may require an approved percolation certification plan under *Howard County Code Sec. 3.805*

*Note: Any septic systems that are to be abandoned must be done by a septic contractor with documentation of the process.

*Note: All abandoned wells are to be sealed by a well driller licensed by the Maryland State Board of Well Drillers *COMAR Sec 26.04.04.11 Abandonment Standards D (3)*

COMMENTS:

Gregory B. Phillips 410-977-0864
 Applicant's Name (please print) Applicant's Phone #

gphillips@mred.us 410-531-9009
 Applicant's Email Applicant's Fax #

Gregory Phillips 9/18/2018
 Applicant's Signature Date

Maura J. Rossman, M.D., Health Officer

MEMORANDUM

Sent via email to gphillips@mred.us

TO: Gregory Phillips

FROM: Joseph C Cabahug *JCC 10/16/2018*
Licensed Environmental Health Specialist
Well & Septic Program

DATE: October 16th, 2018

RE: **9598 Route 108**
Ellicott City, MD 21042
M. 0030 G. 0009 P. 0067 – 1.2700 AC
(Demolition of existing sfd – Redevelopment in the future)

This is to advise that the Howard County Health Department recommends issuance of the demolition permit for the above referenced property.

A site inspection was conducted by our office on 9/19/2018 to investigate any existing well and/or septic components. During the inspection, the Health Department could not verify any existing wells or septic components on the subject property.

During the demolition of the house, if any wells or septic components are found, you are required to contact the Health Department immediately. Any wells found must be sealed by a licensed well driller with an attached MDE well abandonment report. If any septic components are found, they must be pumped out and abandoned by a licensed septic contractor. Appropriate documentation must be submitted to the Health Department that explains this process in detail.

Plans to rebuild on this parcel will require the connection to public water and sewer per Howard County Code.

IF ANY WELL OR SEPTIC COMPONENTS ARE FOUND DURING SITE WORK, YOU MUST NOTIFY THIS OFFICE IMMEDIATELY!!

JCC
Cc: File

SITE INSPECTION SHEET

OWNER: Cynthia Scheib * PHONE #: _____
ADDRESS: 9598 Route 108 CONTRACTOR: Greg Phillips
Ellicott City, MD 21042 WELL TAG #: _____
SUBDIVISION: Columbia Woods LOT: 12 COUNTY #: 13
PROPOSAL: Demo

COUNTRY
LN

LOCATION DIAGRAM

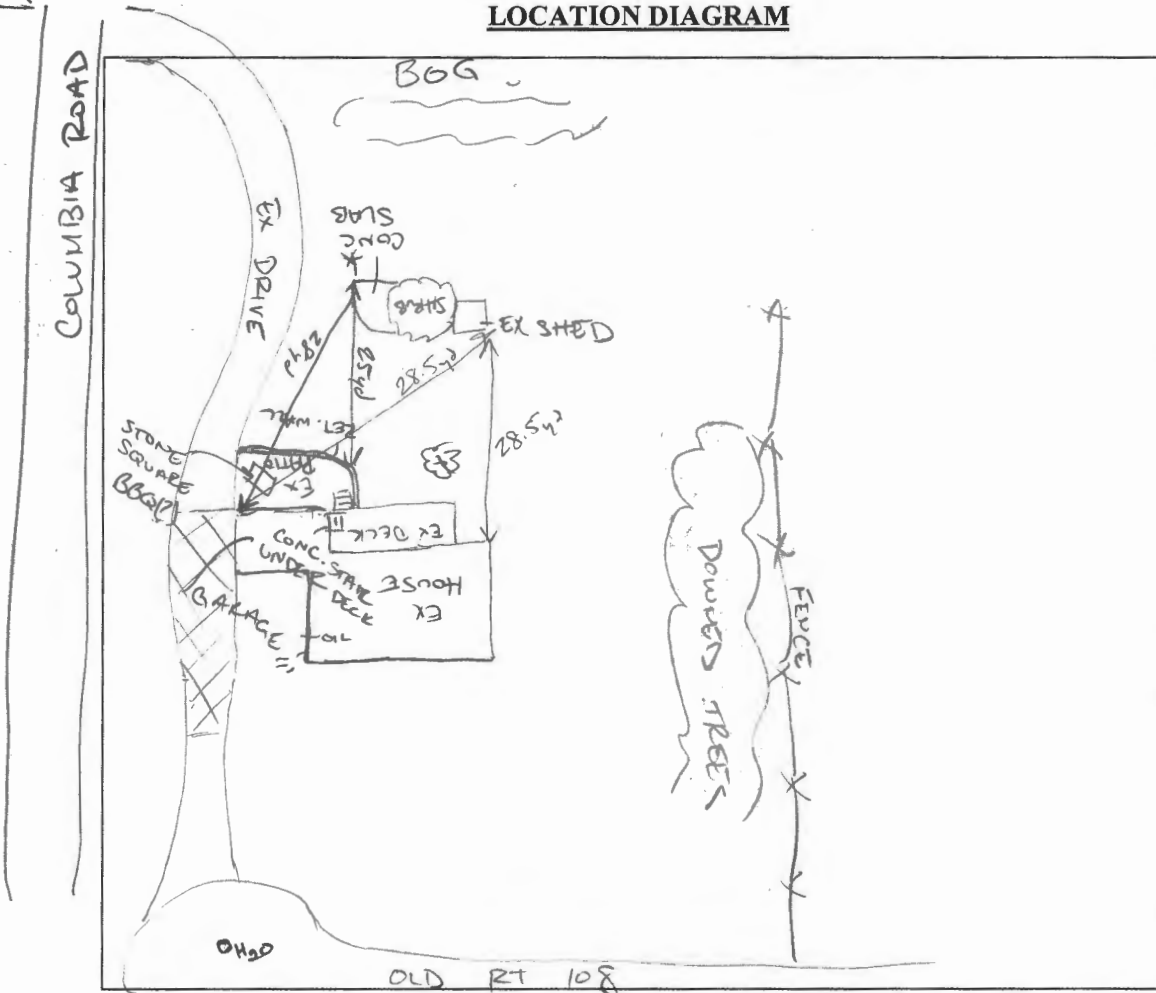

COMMENTS: NO SIGN OF SEPTIC IN FRONT OR BACK OF HOUSE. GRASS WAS TALL, NO SIGN OF SEPTIC INFLUENCE. NO DISCHARGE PIPE OBS. IN BOG REGION.

DATE: 09/19/2018

INSPECTOR: _____

[Handwritten signature]

Real Property Search (w2)

Search Result for HOWARD COUNTY

[View Map](#) [View GIS](#) [Mortgage Redemption](#) [View GroundRent Registration](#)

Tax Exempt: **Special Tax Recapture:**
Exempt Class: NONE

Account Identifier: **District - 02 Account Number - 206692**

Owner Information

Owner Name: SCHEIB GLENN ROBERT **Use:** RESIDENTIAL
 SCHEIB CYNTHIA KELLER **Principal Residence:** NO
Mailing Address: 95-957 WIKAO STREET **Deed Reference:** /17576/ 00311
 MILILANI HI 96789-

Structure Information

Premises Address: 9598 ROUTE 108 **Legal Description:** P/O LOT 12 1.272 A
 ELLICOTT CITY 21042-0000 COLUMBIA WOODLANDS

Map:	Grid:	Parcel:	Sub District:	Subdivision:	Section:	Block:	Lot:	Assessment Year:	Plat No:
0030	0009	0067		7002			12	2019	Plat Ref:

Special Tax Areas: **Town:** NONE
Ad Valorem: 104
Tax Class:

Primary Structure Built **Above Grade Living Area** **Finished Basement Area** **Property Land Area** **County Use**
 1917 1,163 SF 1.2700 AC

Stories **Basement** **Type** **Exterior** **Full/Half Bath** **Garage** **Last Major Renovation**
 1 YES STANDARD UNIT FRAME 1 full 1 Carport

	Base Value	Value	Phase-in Assessments	
		As of	As of	As of
		01/01/2016	07/01/2018	07/01/2019
Land:	189,600	189,600		
Improvements	83,100	83,100		
Total:	272,700	272,700	272,700	
Preferential Land:	0			

Transaction Information

Seller: ECKLES SHIRLEY J **Date:** 05/09/2017 **Price:** \$0
Type: NON-ARMS LENGTH OTHER **Deed1:** /17576/ 00311 **Deed2:**
Seller: **Date:** **Price:** \$0
Type: **Deed1:** /00827/ 00656 **Deed2:**
Seller: **Date:** **Price:**
Type: **Deed1:** **Deed2:**

Assessment Information

Partial Exempt Assessments: **Class** 07/01/2018 07/01/2019
County: 000 0.00
State: 000 0.00
Municipal: 000 0.00 | 0.00 |

Tax Exempt: **Special Tax Recapture:**
Exempt Class: NONE

Homestead Application Information

Homestead Application Status: Denied

Cabahug, Joseph

From: Gregory Phillips <gphillips@mred.us>
Sent: Monday, October 15, 2018 4:21 PM
To: Cabahug, Joseph; Wolf, Kevin
Subject: Re: Demolition Permit Request Form - HCHD

Mystery Solved!

I will contact Bureau of Utilities going forward.

Regards,

Gregory Phillips
Maryland Real Estate Development
6100 Day Long Lane
Suite 100
Clarksville, Maryland 21029

Direct 410.977.0864
gphillips@MRED.US



There was no immediate visible signs of well and septic, however, records show that the property was not connected to public water and sewer indicating that a well and a septic system must be associated with the property. There was a concrete slab next to a shrub and a shed behind the house and there was a lot of downed trees that might have more clues as to a well or a septic under them. It's possible that the well might be inside the house.

I have reached out to the Bureau of Utilities to reconfirm that there is not a record of public connection for this property.

Let's schedule a time to meet on site to come up with a game plan moving forward. We can locate the existing lines from inside the house and go from there.

Thanks,

Joseph C. Cabahug - LEHS
Environmental Health Specialist
Howard County Health Department - Well & Septic Program
Bureau of Environmental Health
8930 Stanford Blvd.
Columbia, MD 21045
(o) [410-313-2643](tel:410-313-2643)
(f) [410-313-2648](tel:410-313-2648)
<image001.png>
<image002.jpg> <image003.jpg>
jcabahug@howardcountymd.gov

CONFIDENTIALITY NOTICE

This message and the accompanying documents are intended only for the use of the individual or entity to which they are addressed and may contain information that is privileged, confidential, or exempt from disclosure under applicable law. If the reader of this email is not the intended recipient, you are hereby notified that you are strictly prohibited from reading, disseminating, distributing, or copying this communication. If you have received this email in error, please notify the sender immediately and destroy the original transmission.