



Building Permit Application

Howard County Maryland
 Department of Inspections, Licenses and Permits
 3430 Court House Drive
 Permits: 410-313-2455
 www.howardcountymd.gov

Date Received: _____

Permit No.: B18002212

Building Address: 15332 Greenleaf Dr.
 City: Greenbelt State: MD Zip Code: 21741
 Suite/Apt. # _____ SDP/WP/BA #: _____
 Census Tract: _____ Subdivision: _____
 Section: _____ Area: _____ Lot: 8
 Tax Map: _____ Parcel: _____ Grid: _____
 Zoning: _____ Map Coordinates: _____ Lot Size: 11000

Property Owner's Name: Nancy Wood LLC
 Address: 2215 Dewart Dr.
 City: Greenbelt State: MD Zip Code: 21741
 Phone: _____ Fax: _____
 Email: _____

Applicant's Name & Mailing Address, (If other than stated herein)
 Applicant's Name: Nancy Wood LLC
 Address: 2215 Dewart Dr.
 City: Greenbelt State: MD Zip Code: 21741
 Phone: _____ Fax: _____
 Email: _____

Existing Use: Residential
 Proposed Use: Residential
 Estimated Construction Cost: \$ 4,000
 Description of Work: 11500 sq. ft. addition to existing structure
 Occupant/Tenant Name: Owner
 Was tenant space previously occupied? Yes No
 Contact Name: _____
 Address: _____
 City: _____ State: _____ Zip Code: _____
 Phone: _____ Fax: _____
 Email: _____

Contractor Company: Rock Hill
 Contact Person: Tommy Cooney
 Address: 15600 A D Linton Highway
 City: Greenbelt State: MD Zip Code: 21741
 License No.: 88215
 Phone: 410 984 9081 Fax: _____
 Email: _____

Engineer/Architect Company: Clear
 Responsible Design Prof.: _____
 Address: _____
 City: _____ State: _____ Zip Code: _____
 Phone: _____ Fax: _____
 Email: _____

Commercial Building Characteristics	Residential Building Characteristics
Height:	<input type="checkbox"/> SF Dwelling <input type="checkbox"/> SF Townhouse
No. of stories:	Depth Width
Gross area, sq. ft./floor:	1 st floor:
	2 nd floor:
Area of construction (sq. ft.):	Basement:
	<input type="checkbox"/> Finished Basement
Use group:	<input type="checkbox"/> Unfinished Basement
	<input type="checkbox"/> Crawl Space
Construction type:	<input type="checkbox"/> Slab on Grade
<input type="checkbox"/> Reinforced Concrete	No. of Bedrooms:
<input type="checkbox"/> Structural Steel	Multi-family Dwelling
<input type="checkbox"/> Masonry	No. of efficiency units:
<input type="checkbox"/> Wood Frame	No. of 1 BR units:
<input type="checkbox"/> State Certified Modular	No. of 2 BR units:
	No. of 3 BR units:
	Other Structure:
	Dimensions:
> Roadside Tree Project Permit	Footings:
<input type="checkbox"/> Yes <input type="checkbox"/> No	Roof:
Roadside Tree Project Permit #	<input type="checkbox"/> State Certified Modular
	<input type="checkbox"/> Manufactured Home

Utilities	
Electric:	<input type="checkbox"/> Yes <input checked="" type="checkbox"/> No
Gas:	<input checked="" type="checkbox"/> Yes <input type="checkbox"/> No
Water Supply	
<input type="checkbox"/> Public	
<input checked="" type="checkbox"/> Private	
Sewage Disposal	
<input type="checkbox"/> Public	
<input checked="" type="checkbox"/> Private	
Heating System	
<input type="checkbox"/> Electric <input type="checkbox"/> Oil	
<input type="checkbox"/> Natural Gas <input type="checkbox"/> Propane Gas	
<input type="checkbox"/> Other:	
Sprinkler System:	
<input type="checkbox"/> Yes <input checked="" type="checkbox"/> No	
Grading Permit Number:	
Building Shell Permit Number:	

THE UNDERSIGNED HEREBY CERTIFIES AND AGREES AS FOLLOWS: (1) THAT HE/SHE IS AUTHORIZED TO MAKE THIS APPLICATION; (2) THAT THE INFORMATION IS CORRECT; (3) THAT HE/SHE WILL COMPLY WITH ALL REGULATIONS OF HOWARD COUNTY WHICH ARE APPLICABLE THERETO; (4) THAT HE/SHE WILL PERFORM NO WORK ON THE ABOVE REFERENCED PROPERTY NOT SPECIFICALLY DESCRIBED IN THIS APPLICATION; (5) THAT HE/SHE GRANTS COUNTY OFFICIALS THE RIGHT TO ENTER ONTO THIS PROPERTY FOR THE PURPOSE OF INSPECTING THE WORK PERMITTED AND POSTING NOTICES.

Applicant's Signature: _____ Print Name: Nancy Wood
 Email Address: _____ Date: _____
 Title/Company: _____

Checks Payable to: DIRECTOR OF FINANCE OF HOWARD COUNTY
 PLEASE WRITE NEATLY & LEGIBLY
 -FOR OFFICE USE ONLY-

AGENCY	DATE	SIGNATURE OF APPROVAL
State Highways		
Building Officials		
PSZA (Zoning)		
PSZA (Engineering)		
Health	<u>7-10-18</u>	<u>D. Bernard</u>

Is Sediment Control approval required for issuance? Yes No
 CONTINGENCY CONSTRUCTION START

DPZ SETBACK INFORMATION
Front:
Rear:
Side:
Side St.:
All minimum setbacks met? <input type="checkbox"/> Yes <input type="checkbox"/> No
Is Entrance Permit Required? <input type="checkbox"/> Yes <input type="checkbox"/> No
Historic District? <input type="checkbox"/> Yes <input type="checkbox"/> No
Lot Coverage for New Town Zone:
SDP/Red-line approval date:

Filing Fee	\$
Permit Fee	\$ <u>100</u>
Tech Fee	\$ <u>10</u>
Excise Tax	\$
PSFS	\$
Guaranty Fund	\$
Add'l per Fee	\$ <u>1100.00</u>
Total Fees	\$ <u>1210.00</u>
Sub- Total Paid	\$
Balance Due	\$
Check #	<u>1947.50</u>

Oswald, Hank

From: Oswald, Hank
Sent: Friday, April 27, 2018 8:17 AM
To: Cagle, Clint (ccagle@nvrinc.com)
Cc: 'Tony Fertitta'; Dave Harward, III (DaveH@fcc-eng.com)
Subject: B17003357_15332 Galaxy Drive_Lot 8_Floor Plans

Hello All:

You're welcome. May I have the new floor plans for Lot 8. The previous OSDS plan was for "Longwood" and the new OSDS Plan is for "Marymount".

Thanks,

Hank

Hank Oswald
Licensed Environmental Health Specialist
Howard County Health Department
Bureau of Environmental Health
Well & Septic Program
8930 Stanford Boulevard
Columbia, MD 21045
410.313.1786 (Office)
hoswald@howardcountymd.gov

CONFIDENTIALITY NOTICE

This message and the accompanying documents are intended only for the use of the individual or entity to which they are addressed and may contain information that is privileged, confidential, or exempt from disclosure under applicable law. If the reader of this email is not the intended recipient, you are hereby notified that you are strictly prohibited from reading, disseminating, distributing, or copying this communication. If you have received this email in error, please notify the sender immediately and destroy the original transmission.

FIRST FLOOR JACK SCHEDULE				
IDENTIFIER	DESCRIPTION	OPTIONS	ENG. NUM.	REMARKS
J107	JACK - (3) 2X6 SFF STUD GRADE	6CC	1073/1075	
J108	JACK - (3) 2X6 SFF STUD GRADE	6CC	1073/1075	
J109	JACK - (2) 2X4 SFF STUD GRADE	6AA	1071	
J110	JACK - (2) 2X4 SFF STUD GRADE	6AA	1071	
J111	JACK - (3) 2X4 SFF STUD GRADE		1014	
J112	JACK - (2) 2X4 SFF STUD GRADE		1048	
J113	JACK - (2) 2X4 SFF STUD GRADE		1048	
J114	JACK - (6) 2X4 SFF		1023	
J115	JACK - (3) 2X4 SFF STUD GRADE		1013	
J116	JACK - (3) 2X4 SFF STUD GRADE		1011	
J117	JACK - (2) 2X4 SFF STUD GRADE		1004	
J118	JACK - (3) 2X4 SFF STUD GRADE		1011	
J119	JACK - (6) 2X4 SFF		1023	
J120	JACK - (3) 2X4 SFF STUD GRADE	ELK	1021	
J121	JACK - (3) 2X4 SFF STUD GRADE	ELK	1021	
J126	JACK - (3) 2X4 SFF STUD GRADE		1014	
J124	JACK - (2) 2X4 SFF		1053	
J130	JACK - 2X4 SFF STUD GRADE	6AA	1021	
J131	JACK - (2) 2X4 SFF		1053	
J132	JACK - 2X4 SFF STUD GRADE	6AA	1021	
J133	JACK - (3) 2X4 SFF	ELK	2000	
J134	JACK - (3) 2X4 SFF	ELK	2000	
J135	JACK - (3) 2X4 SFF STUD GRADE	ELK	2000	

FIRST FLOOR BEAM/HEADER SCHEDULE					
IDENTIFIER	DESCRIPTION	LENGTH	OPTIONS	ENG. NUM.	REMARKS
B102	BEAM STEEL - #12X30	22'-3"	6CC,ELAB,KR	1057	
B103	BEAM BUILT 2X6 - 2 PLY	8'-4 5/16"	ELK,6CC	1062	FIELD INSTALLED
B104	EXT HEADER - 2X6 - 2 PLY	3'-10"	6AA	1021	FIELD INSTALLED
PF102-3	LVL - 20	20'-2 1/2"	6CC,ELAB,KR	1073	PORTAL FRAME
PF103-2	LVL - 11-04	13'-6 1/2"	6AA	1071	PORTAL FRAME

STEEL COLUMN SCHEDULE					
IDENTIFIER	STYLE	HEIGHT	OPTIONS	ENG. NUM.	REMARKS
C101	STANCHION - 3 IN SCHED 40	7'-11 1/8"		1057	

LEGEND

- BEARING WALL
- - - NON BEARING WALL
- ⊗ INDICATES BEARING FROM POINT-LOAD ABOVE
- J JACKS
- B BEAM/HEADER
- F PAD FOOTING
- ◇ STEEL COLUMN
- X PORTAL FRAME
- X JOIST/TRUSS
- L LVL
- X ENGINEERING PAGE NUMBER

SEE FC DETAILS FOR FRAMING CONNECTORS

- FLOOR PLAN NOTES**
- ALL HEADERS ARE (2) 2X6 w/ 2X4 WALLS OR (3) 2X6 w/ 2X6 WALLS, UNLESS OTHERWISE NOTED.
 - ALL HEADERS TO HAVE (1) 2X4 OR 2X6 JACK EACH END, UNLESS OTHERWISE NOTED.
 - ALL EXTERIOR WALLS TO BE 4" AND ALL INTERIOR WALLS TO BE 3 1/2" UNLESS OTHERWISE NOTED.
 - HATCHED AREAS INDICATE DROPPED CEILING. ALL DROPPED CEILING ARE 12" UNLESS OTHERWISE NOTED.
 - SEE BRACED WALL PANEL DETAIL SHEET FOR SPECIAL WALL FRAMING LOCATIONS AND HEADER SIZES, IF APPLICABLE.
 - ALL WINDOWS HAVE 8'-0" 1/2" HEADER HEIGHT UNLESS OTHERWISE NOTED.
 - ALL CASED OPENINGS AT T-11", UNLESS OTHERWISE NOTED.
- GYPSUM NOTES**
- AT GARAGE:
5/8" DRYWALL ON COMMON WALLS, CEILING, AND BEARING WALLS AS REQUIRED.
- AT STAIRS:
1/2" GYPSUM BOARD AT UNDERSIDE OF STAIRS AND WALLS IN CLOSET.
- WITH OPTION "SG1" - DRYWALL UNFINISHED BASEMENT CEILING AREA.
- NOTES:**
- 1/2" GYPSUM WALL BOARD REQUIRED ON CEILING IN UNFINISHED AREAS WHEN NO SPRINKLER SYSTEM IS INSTALLED.
 - A MAXIMUM AREA OF 80 SQ FT MAY BE OMITTED AS NEEDED FOR INSTALLATION OF PLUMBING, ELECTRICAL, AND/OR HVAC (TYPICALLY AN 8'-0"x8'-0" CEILING SPACE ABOVE MECHANICAL AREA).
 - PROVIDE FIRE BLOCKING AS REQUIRED AT PERIMETER OF ANY AREAS WHERE DRYWALL HAS BEEN OMITTED.

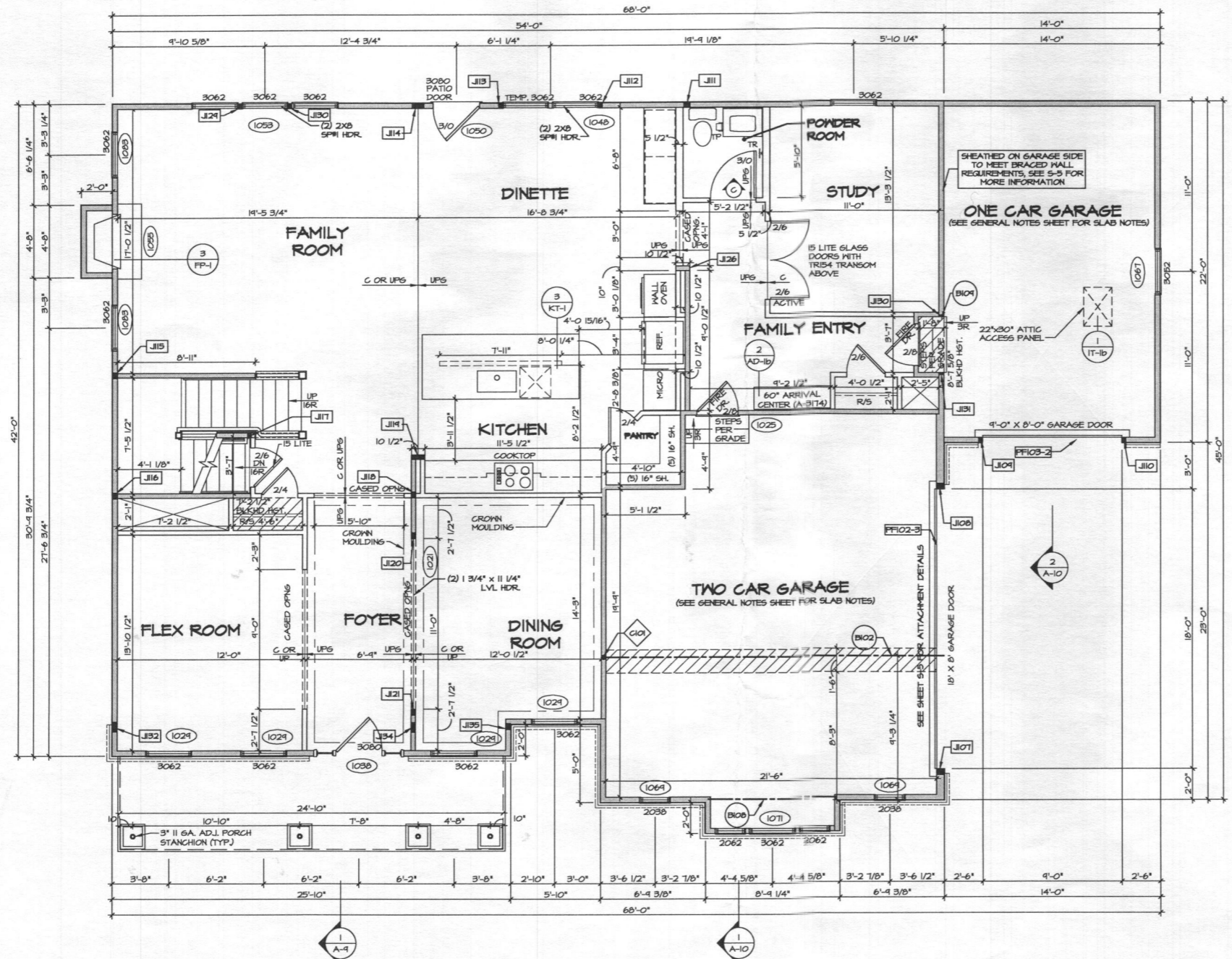

FIRST FLOOR PLAN
SCALE: 1/4" = 1'-0"

REV. NO. DATE

NVR, Inc., owner, expressly reserves the common law copyright in this drawing. These plans are not to be reproduced, stored in a retrieval system, or transmitted in any form or by any means, electronic, mechanical, photocopying, recording, or by any information storage and retrieval system, without the prior written consent of NVR, Inc.

NVR
NVR, Inc.
Architectural Services
Acacia Station, Suite 100
5285 Westview Drive
Frederick, MD 21703

SHEET NO. 25
MODEL MARYMOUNT
DRAWING TITLE FIRST FLOOR PLAN
OPTION DESCRIPTION

SET NO. 12000
VERSION 01
DRAWN BY
DATE:
OPTION

C:\NVR\Solvers\MARYMOUNT_12000_01.MOE-FF-0006.V702016\Sheets\Lot_Specific\25 A-7 PLN1.LS.dwg 04/26/18 - 4:04 AM

FLOOR PLAN NOTES

- ALL HEADERS ARE (B) 2X4 W/ 2X4 WALLS OR (B) 2X6 W/ 2X6 WALLS UNLESS OTHERWISE NOTED.
- ALL HEADERS TO HAVE (I) 2X4 OR 2X6 JACK EACH END, UNLESS OTHERWISE NOTED.
- WALLS TO BE 3/4" AND ALL INTERIOR WALLS TO BE 1/2" UNLESS OTHERWISE NOTED.
- HATCHED AREAS INDICATE PROPOSED CEILING. ALL CEILING SHALL BE 1/2" UNLESS OTHERWISE NOTED.
- SEE BRACKETED WALL PANEL DETAIL SHEET FOR SPECIAL APPLICABLE WALL FRAMING LOCATIONS AND HEADER SIZES, IF APPLICABLE.
- ALL CAGED OPENINGS AT T-11, UNLESS OTHERWISE NOTED.
- NOTED.

LEGEND

- BEARING WALL
- NON BEARING WALL
- INDICATES BEARING FROM POINT-LOAD ABOVE
- JACKS
- BEAM/HEADER
- PAD FOOTING
- STEEL COLUMN
- PORTAL FRAME
- JOIST/TRUSS
- L.V.
- ENGINEERING PAGE NUMBER
- SEE EC DETAILS FOR FRAMING CONNECTORS

SECOND FLOOR JACK SCHEDULE

IDENTIFIER	DESCRIPTION	OPTIONS	ENG. NBR.	REMARKS
J001	JACK - (B) 2X4 SPM	ELK	2000	MUST EXTEND THROUGH TOP PLATE CAP WITH 1/8" x 3-1/2" x 1/2" STEEL BEARING PLATE
J003	JACK - (B) 2X4 SPM	ELK	2000	MUST EXTEND THROUGH TOP PLATE CAP WITH 1/8" x 3-1/2" x 1/2" STEEL BEARING PLATE
J004	JACK - (B) 2X4 SPT STD GRADE	ELK	2000	

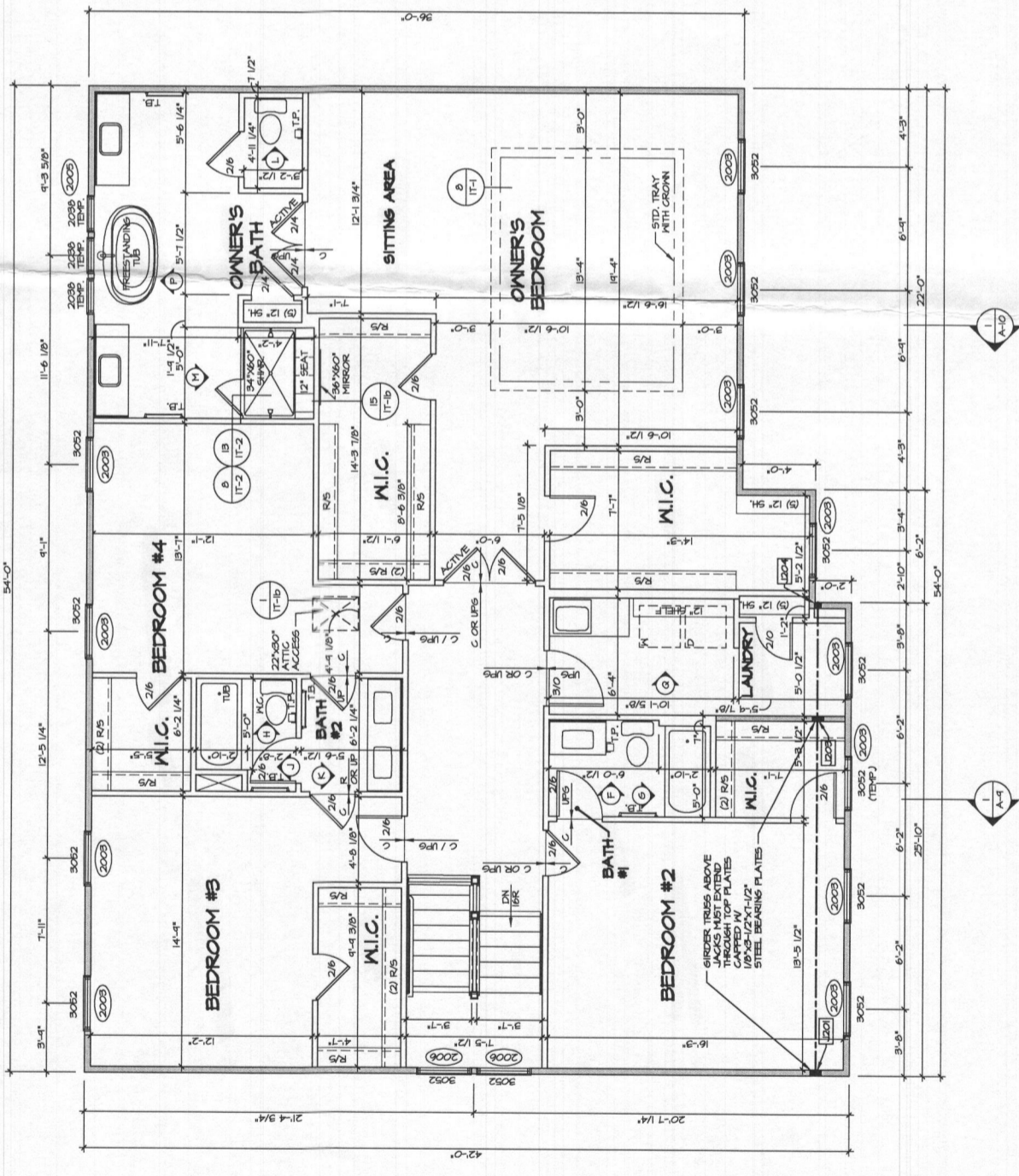

Heather

no

Name: Jim Kerwin
Street Address: PO Box 552
City, State, Zip: Woodbine MD 21797
Date: MAY 7, 2018

RECEIVED

MAY 07 2018

LICENSES & PERMITS
DIVISION

REVISION
Amendment, Permit # B17003357

Ms. Debbie Whalen
Division of Plan Review
Department of Inspections, Licenses and Permits
Howard County Government
3430 Court House Dr
Ellicott City, MD 21043

*REVISION, GEORGE HAS
ALREADY APPROVED PERMIT,
FEE ASSESSED

Dear Ms. Whalen:

I am requesting to ^{REVISE} amend Permit # B17003357 at
15332 Galaxy Drive Woodbine MD 21797 to
Change house type to "Marymount" BLV 'K', 2 car garage,
1 car side attached garage, finished lower level (Rec Room, Bath,
Bedroom and wet bar)

Enclosed: CK# 3096
INV#
 Fee: \$50.00
 Plot Plans
 Sets of Construction Drawings
Other: _____

REVIEWED FOR
CODE COMPLIANCE
DEPARTMENT OF INSPECTIONS,
LICENSES AND PERMITS
HOWARD COUNTY
DATE: 5/17/2018
BY: [Signature]
 SUBJECT TO COMMENTS OF LETTER
 SUBJECT TO FIELD INSPECTION
 SUBJECT TO COMMENTS ON PLANS
 AMENDMENT FINAL

If there is anything we can do to assist you, please let me know.

Sincerely,

Revised Plan

Name: Jim Kerwin
Title: AGENT For NV Homes
Phone: 443-309-7792
Email: Jim@DecaturbuildingServices.com

AKH

Oswald, Hank

From: Cagle, Clint <ccagle@nvrinc.com>
Sent: Monday, September 25, 2017 11:01 AM
To: Oswald, Hank
Subject: Re: B17003357_15332 Galaxy Drive

Good Morning Hank,

I will follow up with the engineer FCC on this. Also, please go ahead and start emailing me these items as Taylor has left the office and is now in the Sales Department.

Thanks,

Clint Cagle
Special Assignments Manager
Maryland East Division

P: [410-379-5956](tel:410-379-5956)

C: [301-237-5776](tel:301-237-5776)

F: [410-379-2430](tel:410-379-2430)

[9720 Patuxent Woods Drive](#)
[Columbia, MD 21046](#)

ccagle@nvrinc.com

www.nvhomes.com

Follow us on [Facebook](#)

On Sep 25, 2017, at 9:30 AM, Faris, Taylor <tfaris@NVHomes.com> wrote:

FYI, see below

Taylor Faris
Sales and Marketing Representative

Shipley's Grant- Luxury town homes in Ellicott City! Quick delivery homes available from the \$550's.

Hours: Mon, 1-6; Tue – Fri 11-6; Sat 11-5; Sun 12-5

P: 240-444-7543

<image001.png>

From: Oswald, Hank [<mailto:hoswald@howardcountymd.gov>]
Sent: Monday, September 25, 2017 9:29 AM
To: Faris, Taylor <tfaris@NVHomes.com>
Subject: B17003357_15332 Galaxy Drive

Hello Faris:

Good morning. This office received the building permit, floor plan and site plan for 15332 Galaxy Drive (Lot 8) but it did not receive the OSDS (Septic) Plan. Please forward 3 copies of the OSDS plan at your earliest convenience.

Should you have any questions or concerns, please don't hesitate to contact me.

Respectfully,

Hank

Hank Oswald, L.E.H.S.
Howard County Health Department
Bureau of Environmental Health
Well & Septic Program
8930 Stanford Boulevard
Columbia, MD 21045
410.313.1786 (Office)
410.313.2648 (Fax)

----- This email is confidential and intended solely for the use of the individual to whom it is addressed. If you have received this email in error please contact the sender and be advised that any use, dissemination, forwarding, printing, or copying of this email is strictly prohibited. The terms for the purchase and sale of any property referenced in this email shall be solely determined by a ratified Purchase Agreement. Any information provided in this email, including but not limited to, pricing, financing, features of a property and/or community, is not to be construed as the basis of the bargain for the purchase and sale of any such property.