

Bureau of Environmental Health
 8930 Stanford Boulevard, Columbia, MD 21045
 Main: 410-313-2640 | Fax: 410-313-2648
 TDD 410-313-2323 | Toll Free 1-866-313-6300
www.hchealth.org
 Facebook: www.facebook.com/hocohealth

Maura J. Rossman, M.D., Health Officer

RECEIPT DATE: 6/22/18 **ONSITE SEWAGE DISPOSAL SYSTEM** P 563033

APPROVAL DATE: 11/21/18 sec **PERMIT:** REPAIR A

PROPERTY ADDRESS: 4376 Route 97

SUBDIVISION: _____ LOT: _____ TAX ID: 04-327233

CONTRACTOR: Bill Ingram/ Farm and Home Excavating EMAIL: _____

CONTRACTOR ADDRESS: 901 Driver Road, Marriottsville, MD 21104 PHONE: 410-442-2139

PROPERTY OWNER: Thomas Sargent EMAIL: _____

OWNER ADDRESS: 4376 Route 97, Brookville, MD 20833 PHONE: 410-489-4456

SEPTIC TANK SIZE (GALLONS): 1500 PUMP CHAMBER CAPACITY (GALLONS): N/A PUMP SIZE: 6/4

NUMBER OF BEDROOMS: 3 HOUSE SQ. FT. _____ APPLICATION RATE: 0.8

DISTRIBUTION SYSTEM: GRAVITY FED LOW PRESSURE DOSED

| | | |
|-----------|--|---|
| TRENCHES: | LINEAR FEET REQUIRED: <u>102</u> | INLET DEPTH: <u>3'</u> |
| | TRENCH WIDTH: <u>2</u> | MAXIMUM BOTTOM DEPTH: <u>9'</u> |
| | MINIMUM SPACE BETWEEN TRENCHES: <u>N/A</u> | EFFECTIVE AREA BEGINNING DEPTH: <u>5'</u> |

LOCATION: **TO BE STAKED BY SANITARIAN DURING PRE-CONSTRUCTION INSPECTION.**

NOTES: Install new S.T. below ex. S.T. If pipes are clear (no roots) OK to fire plumbing back in to ex trenches.
If new trenches needed. Install Dbox w/ 205' turbs in both directions below ex. manhole. Painted/Flagged in field.

ISSUED BY: K. Wolf ISSUE DATE: 7/20/18 EXPIRATION DATE: 7/20/19

- NOTE: **CONTRACTOR MUST SCHEDULE A PRE-CONSTRUCTION INSPECTION PRIOR TO BEGINNING ANY INSTALLATION**
- NOTE: **CONTRACTOR MUST SCHEDULE AN INSPECTION AND GAIN APPROVAL OF ALL COMPONENTS PRIOR TO COVERING**
- NOTE: **STONE MUST BE APPROVED BY HEALTH DEPARTMENT AND GRAVEL TICKET MUST BE AVAILABLE FOR REVIEW.**
- NOTE: **WATERTIGHT SEPTIC TANKS REQUIRED**
- NOTE: **ALL PARTS OF SEPTIC SYSTEM SHALL BE AT LEAST 100 FEET DOWNGRADIENT FROM ANY WATER WELL**
- NOTE: **MANHOLE RISERS REQUIRED ON ALL SEPTIC TANKS AND PUMP CHAMBERS**
- NOTE: **AN ELECTRICAL PERMIT IS REQUIRED FOR INSTALLATION OF ANY ELECTRICAL COMPONENTS OF THE SYSTEM**
 ELECTRICAL PERMIT ISSUED E N/A
- NOTE: **THE HCHD DOES NOT WARRANT ANY SYSTEM AND CANNOT GUARANTEE THE PERFORMANCE OF THIS SYSTEM AS DESIGNED. BY ACCEPTING THIS PERMIT, THE OWNER AND/OR APPLICANT ACKNOWLEDGE THAT THE SPECIFICATIONS DETAILED IN THIS DESIGN ARE ONE POSSIBLE OPTION AND THAT THE HCHD WILL REVIEW OTHER PROPOSALS. YOU HAVE THE OPTION TO SEEK THE ADVICE OF A QUALIFIED DESIGN CONSULTANT OR PROFESSIONAL ENGINEER FOR FURTHER GUIDANCE.**
- NOTE: **MDE RECOMMENDS SEPTIC TANKS, BAT, AND OTHER PRETREATMENT UNITS BE PUMPED AT A FREQUENCY ADEQUATE TO ENSURE THAT SOLIDS ARE NOT DISCHARGED TO THE DISPOSAL AREA**

NEITHER THE HOWARD COUNTY COUNCIL NOR THE HEALTH DEPARTMENT IS RESPONSIBLE FOR THE SUCCESSFUL OPERATION OF ANY SYSTEM.
PERMITTEE RESPONSIBLE FOR OBTAINING FINAL APPROVAL ON THIS PERMIT.
CALL 410-313-1771 TO SCHEDULE INSPECTIONS.

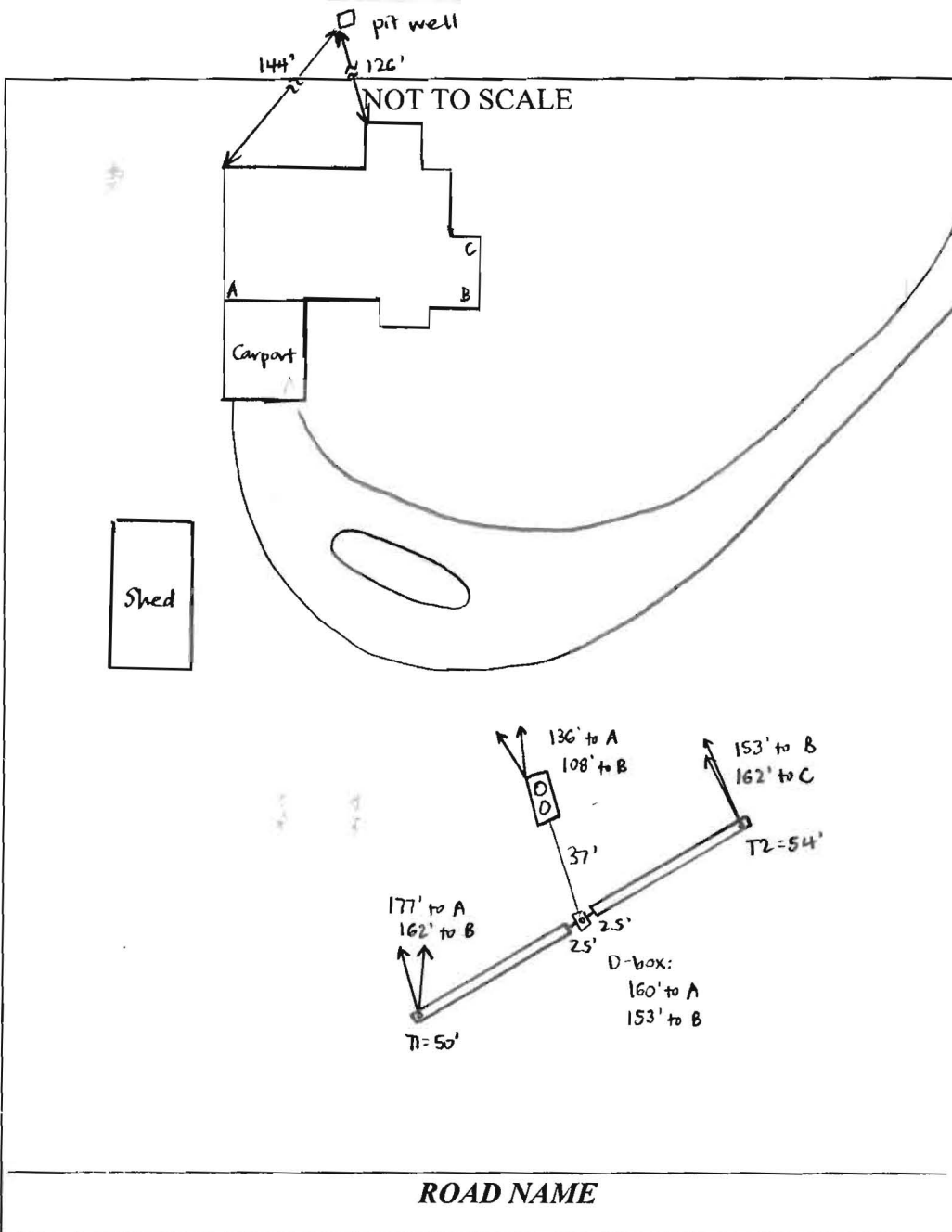

| TRENCH/DRAINFIELD DATA | | |
|-------------------------|-------|-----------------|
| WIDTH | INLET | BOTTOM |
| 2' | 3' | 9' |
| NUMBER OF TRENCHES | | 2 |
| TOTAL LENGTH | | 104' |
| ABSORPTION AREA | | 312' + SIDEWALK |
| DISTRIBUTION BOX LEVEL | | YES |
| DISTRIBUTION BOX BAFFLE | | YES |
| DISTRIBUTION BOX PORT | | YES |

| SEPTIC TANK DATA | |
|---------------------|---------------------------|
| SEPTIC TANK I LEVEL | YES |
| MANUFACTURER | BABYLON |
| CAPACITY | 1500 GAL |
| SEAM LOC | TOP |
| TANK LID DEPTH | 3-3.5' |
| BAFFLES | YES |
| BAFFLE FILTER | NO |
| MANHOLE LOC | FRONT + REAR |
| 6" PORT LOC | NONE |
| WATERTIGHT TEST | NO |
| SLOTTED | YES |
| DATE ON LID | 10-23-18 (per contractor) |

| PUMP/SEPTIC TANK LEVEL | |
|------------------------|-----|
| MANUFACTURER | |
| CAPACITY | GAL |
| SEAM LOC | |
| TANK LID DEPTH | |
| BAFFLES | |
| BAFFLE FILTER | |
| MANHOLE LOC | |
| 6" PORT LOC | |
| WATERTIGHT TEST | |
| SLOTTED | |
| DATE ON LID | |

PRE-CONSTRUCTION:

7/20/18 Layout spec's given, see attached memo 7/20/18 (Korw)

INSTALLATION: 11/19/18 New tank and trenches installed. Contractor not on site, says old tank was pumped + removed. Inlet end of tank currently has 4'+ of fill, contractor will take down to 3.5' cover at inlet, 3' cover at outlet. Observation pipes in trenches need screw caps - notified contractor. Pipes out of D-box are sealed w/ roofing tar. Need speed levelers in D-box. [Corrective action.] Trenches 2' wide, 2.5-3' to stone. (SC)

11/21/18 Contractor sent pictures of speed levelers in D-box. [Corrective action completed.] (SC)

FINAL INSPECTOR Sarah Collins DATE OF APPROVAL 11/21/18

FILE INQUIRY NOTES

| DATE | RESULTS OF REVIEW FOR FILE |
|---------|--|
| 7/20/18 | on site w/ contractor and owner. They explained that house hasn't been used in for several months. |
| | Like to get system up and running to vent. |
| | Tank full of roots, system 'exposed' at "tee" ground depth unknown / not determined. Also exposed files. |
| | Percc test performed and system designed and laid out. |
| | Told contractor and owner will issue permit to replace tank only and @ time of install contractor will |
| | expose trenches. If root laden then new trenches |
| | will be installed. (Saw) |
| | |
| | |
| | |
| | |
| | |
| | |
| | |
| | |
| | |
| | |
| | |
| | |
| | |
| | |