



Health

Building Permit Application
Howard County Maryland
Department of Inspections, Licenses and Permits
3430 Court House Drive
Permits: 410-313-2455
www.howardcountymd.gov

Date Received:
Permit No.: B18003246

Building Address: 2234 Daisy Rd
City: Woodbine State: MD Zip Code: 21797
Suite/Apt. # SDP/WP/BA #:
Census Tract: Subdivision: 0000
Section: Area: Lot:
Tax Map: 0013 Parcel: 0209 Grid: 0004
Zoning: Map Coordinates: Lot Size:

Property Owner's Name: Matthew Wiley
Address: 2234 Daisy Rd
City: Woodbine State: MD Zip Code: 21797
Phone: 703-869-2839 Fax:
Email:

Applicant's Name & Mailing Address, (if other than stated herein)
Applicant's Name:
Address:
City: State: Zip Code:
Phone: Fax:
Email:

Existing Use: SFD
Proposed Use: SFD
Estimated Construction Cost: \$ 992.00
Description of Work: Install 200# LP Tank & run line to stub outside house

Contractor Company: Southern States Petroleum
Contact Person: Jay Nusbaum
Address: 121 John St
City: Westminster State: MD Zip Code: 21157
License No.: 20100060625
Phone: 410-848-9420 Fax: 410-848-7852
Email: Jay.Nusbaum@SScorp.com

Occupant/Tenant Name: Matthew Wiley
Was tenant space previously occupied? Yes No
Contact Name: Matthew Wiley
Address: 2234 Daisy Rd
City: Woodbine State: MD Zip Code: 21797
Phone: 703-869-2839 Fax:
Email:

Engineer/Architect Company:
Responsible Design Prof.:
Address:
City: State: Zip Code:
Phone: Fax:
Email:

Table with 2 columns: Commercial Building Characteristics, Residential Building Characteristics. Rows include Height, No. of stories, Gross area, Area of construction, Use group, Construction type, etc.

Table with 2 columns: Utilities, Water Supply, Sewage Disposal, Heating System, Sprinkler System, Grading Permit Number, Building Shell Permit Number.

THE UNDERSIGNED HEREBY CERTIFIES AND AGREES AS FOLLOWS: (1) THAT HE/SHE IS AUTHORIZED TO MAKE THIS APPLICATION; (2) THAT THE INFORMATION IS CORRECT; (3) THAT HE/SHE WILL COMPLY WITH ALL REGULATIONS OF HOWARD COUNTY WHICH ARE APPLICABLE THERETO; (4) THAT HE/SHE WILL PERFORM NO WORK ON THE ABOVE REFERENCED PROPERTY NOT SPECIFICALLY DESCRIBED IN THIS APPLICATION; (5) THAT HE/SHE GRANTS COUNTY OFFICIALS THE RIGHT TO ENTER ONTO THIS PROPERTY FOR THE PURPOSE OF INSPECTING THE WORK PERMITTED AND POSTING NOTICES.
Jay Nusbaum
Jay Nusbaum
9-14-18
SEP 17 2018
LICENSES & PERMITS DIVISION

Table with 3 columns: AGENCY, DATE, SIGNATURE OF APPROVAL. Rows for State Highways, Building Officials, PSZA (Zoning), PSZA (Engineering), Health.

DPZ SETBACK INFORMATION
Front:
Rear:
Side:
Side St.:
All minimum setbacks met? Yes No
Is Entrance Permit Required? Yes No
Historic District? Yes No
Lot Coverage for New Town Zone:
SDP/Red-line approval data:

Filing Fee \$
Permit Fee \$ 100
Tech Fee \$ 10
Excise Tax \$
PSFS \$
Guaranty Fund \$
Add'l per Fee \$
Total Fees \$ 110.00
Sub-Total Paid \$
Balance Due \$
MA 17 810904688

Distribution of Copies: White: Building Officials Green: PSZA,Zoning Yellow: PSZA,Engineering Pink: Health Gold: SHA
T:\Operations\Updated Forms\Building appimp 03.21.2017.docx

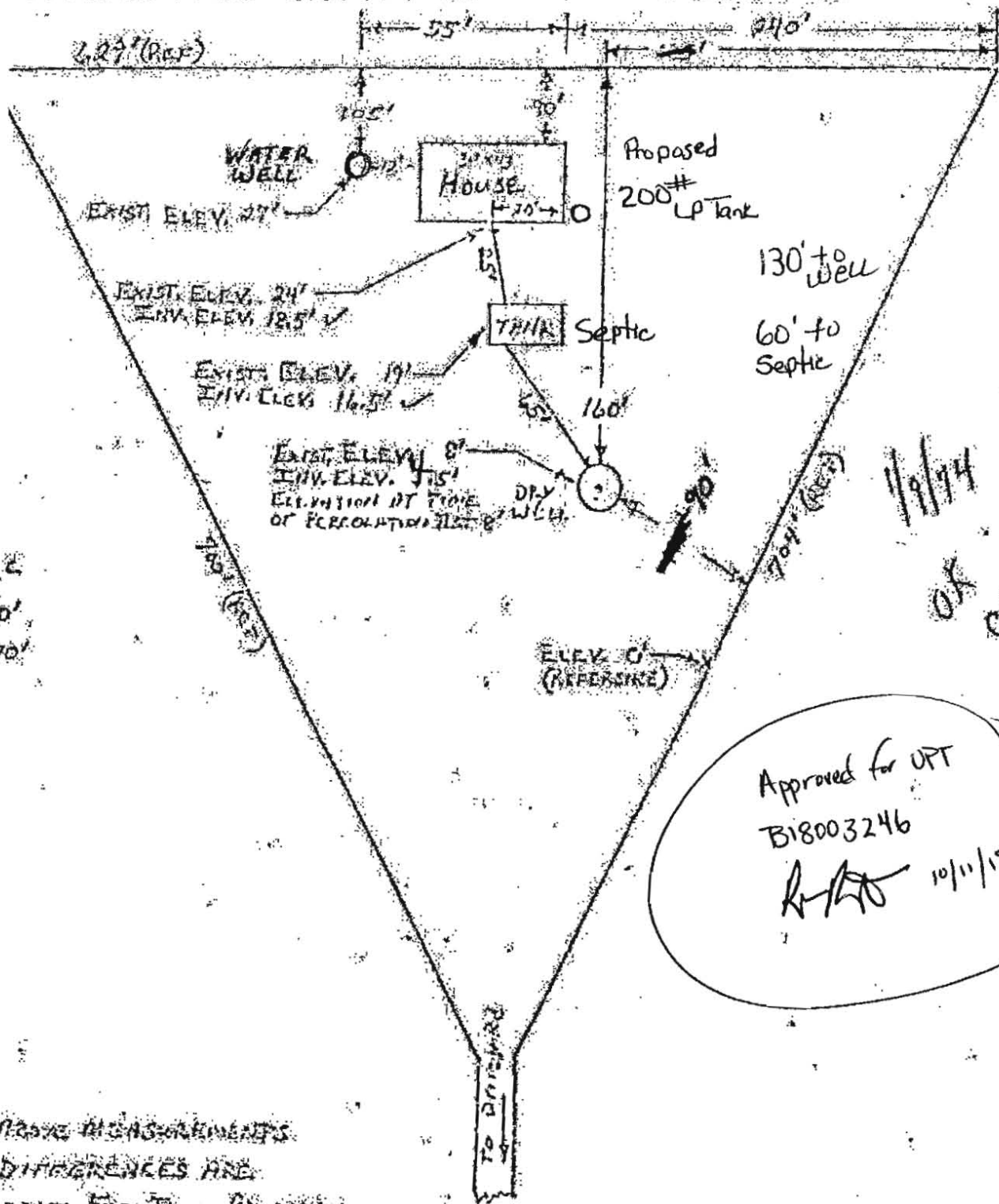

11/9/74

OK CB.S

Approved for UPT  
 B18003246  
 R/A 10/11/18

MAKE MEASUREMENTS  
 DIFFERENCES ARE  
 GREAT FOR THIS PROPERTY

PERMANENT TO