



Bureau of Environmental Health

8930 Stanford Boulevard, Columbia, MD 21045

Main: 410-313-2640 | Fax: 410-313-2648

TDD 410-313-2323 | Toll Free 1-866-313-6300

www.hchealth.org

Facebook: www.facebook.com/hocohealth

Twitter: HowardCoHealthDep

Maura J. Rossman, M.D., Health Officer

APPLICATION FOR PERCOLATION TESTING AND SITE EVALUATION

150404

PROPERTY LOCATION

SUBDIVISION/PROPERTY NAME

PROPERTY ADDRESS 7225 Mink Hollow Road Highland MD 20777

TAX ACCOUNT # TAX MAP GRID PARCEL LOT NO. PROPOSED LOT SIZE (ACRES)

ZONING CATEGORY TIER

PROPERTY OWNER(S) Karen Rafal

DAYTIME PHONE CELL EMAIL

MAILING ADDRESS 7225 Mink Hollow Road Highland MD 20777

APPLICANT Hatfields Equipment RELATIONSHIP TO OWNER: Contractor

DAYTIME PHONE 301 490 4259 CELL 410 984 4880 EMAIL khatfield@hatfieldsequipment.com

MAILING ADDRESS P O Box 519 Todd Annapolis Junction MD 20701

I HEREBY APPLY FOR THE NECESSARY TESTING/EVALUATION PRIOR TO ISSUANCE OF SEWAGE DISPOSAL SYSTEM PERMIT(S):

PROPERTY:

- SUBDIVISION: NUMBER OF LOTS INCLUDING RESIDUE: SUBDIVISION CLASSIFICATION (PER DEPT. OF PLANNING AND ZONING) MAJOR MINOR
CONSTRUCT NEW OSDS ON UNDEVELOPED LOT
REPAIR OR REPLACE FAILING OSDS
UPGRADE EXISTING OSDS

BUILDING:

- RESIDENTIAL WITH EXISTING OR PROPOSED BEDROOMS IN THE COMPLETED STRUCTURE
COMMERCIAL (PROVIDE DETAIL OF TYPE OF USE AND NUMBERS OF EMPLOYEES/CUSTOMERS ON ACCOMPANYING PLAN)

IS THE PROPERTY WITHIN 2500 FEET OF ANY RESERVOIR?

- YES
NO

AS APPLICANT, I UNDERSTAND THE FOLLOWING:

- THIS APPLICATION IS VALID FOR TWO(2) YEARS FROM DATE OF FEE PAYMENT AND APPROVAL IS BASED UPON HEALTH OFFICER SIGNATURE OF A PERC CERTIFICATION PLAN PRIOR TO EXPIRATION OF THIS PERMIT.
THE APPLICATION FEE IS NON-REFUNDABLE
THIS APPLICATION MUST BE ACCOMPANIED BY ALL APPLICABLE FEES AND A SUITABLE SITE PLAN IN ORDER TO BE PROCESSED
THIS IS A PUBLIC DOCUMENT

I declare and affirm that to the best of my knowledge, the information contained herein is correct. I declare that I am the owner of the property or duly authorized to make this application on behalf of the owner. I agree to comply with all applicable state and county regulations.

By signature of this application, I hereby grant Howard County Health Department officials the right to enter onto the property for the purpose of inspecting the property as directly related to the requested permit/service.

Signature of Applicant

11/07/15 DATE

A/P _____

- 0' **(A)**
dk brn loam
msbk
roots
- 8"
brn loam
msbk
dense, roots
- 2'
red brn cl
loam
roots
- 4'
red brn sct
few roots
- 5.5'
brn fol
platy
many mica
few roots
mn deposits
30-40% saponite
- @ 10'
- 12'

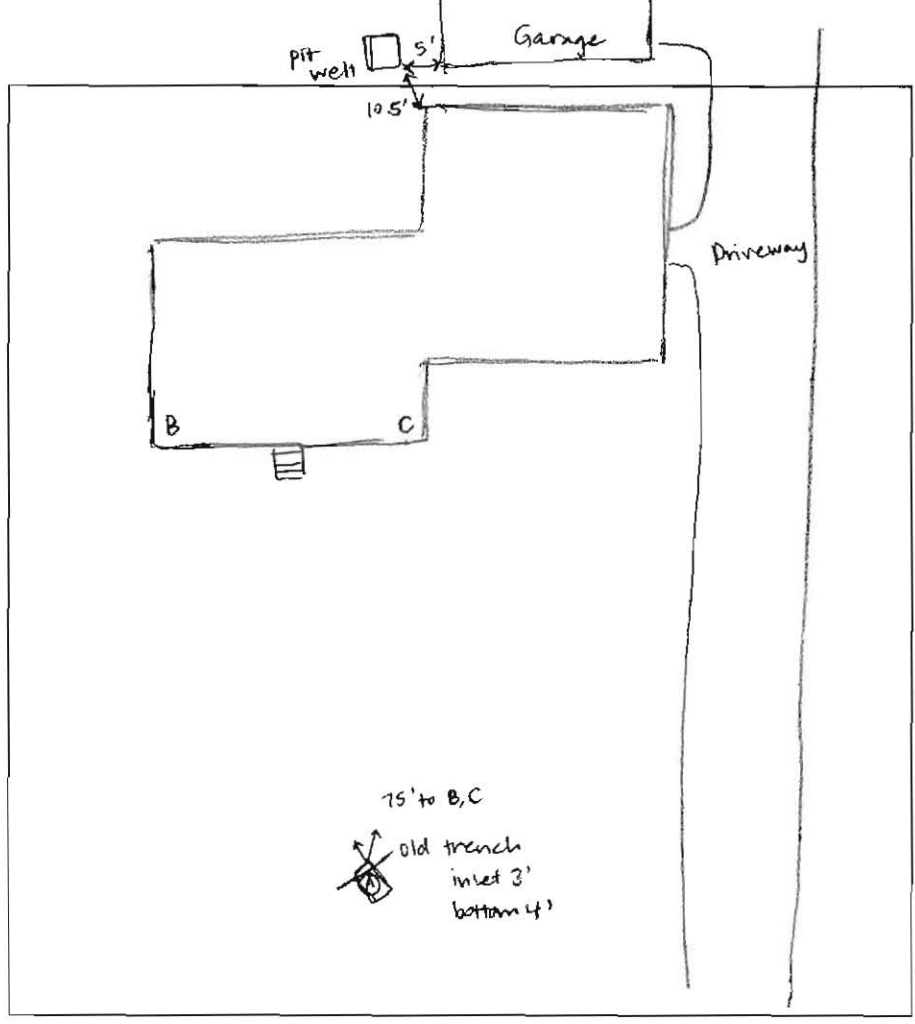

DATE	TEST #	DEPTH	START	BREAK 1" DROP	STOP 2" DROP	TIME OF 2ND INCH	P/F/H
11/14/18	A	5'/12'	0:00	pulled	→ little	movement	
		6'/12'	0:00	1:09	2:40	1:31	too fast
		repair 6'/12'	0:00	1:40	3:50	2:10	P

REMARKS _____

SANITARIAN Sarah Collins BACKHOE Donnie OTHERS Todd Tracy, 2 helpers

TEST HOLES USED IN SDA A AVG. PERC TIME 2:10 SQ. FT/BR _____

TRENCH WIDTH _____ INLET DEPTH _____ MAX. BOT DEPTH 8' EFFECTIVE SW @ 5'



Bureau of Environmental Health
 8930 Stanford Boulevard, Columbia, MD 21045
 Main: 410-313-2640 | Fax: 410-313-2648
 TDD 410-313-2323 | Toll Free 1-866-313-6300
 www.hchealth.org
 Facebook: www.facebook.com/hocohealth
 Twitter: HowardCoHealthDep

Dr. Maura J. Rossman, M.D., Health Officer

INFORMATION FORM – SEPTIC SYSTEM REPAIR/UPGRADE

Reason for Request:

- Failing System 3
- System relocation for proposed addition
- System upgrade for proposed addition
- Inadequate treatment zone
- Collapsed septic tank
- Collapsed drywell

Has the septic tank been pumped within the last month?

- Yes Date pumped: N/A
- No

Was a visual inspection of the septic tank and/or drain fields conducted?

- Yes Explain observations: _____
- No _____

Was a visual inspection of the sewage line conducted?

- Yes
 - Blockage leading to the tank
 - Yes. Explain: _____
 - No _____
 - Blockage leading to the field
 - Yes. Explain: _____
 - No _____
- No

Existing system design

- Drywell
- Trench 2
- Mound
- Unknown
- Other: _____

Is discharge surfacing on the ground?

- Yes
- No

Additional Comments: Will check drain fields at tank replacement

*For REPAIRS, are the owners proposing, or do they plan to add in the future, any additions or modifications to the property, i.e. pools, living space additions, garages, etc? This information must be disclosed at the time of this application. The Health Department will not be able to accommodate requests in the field for property modifications unrelated to the repair request. Such requests may require an additional fee, testing, and submittal of a Percolation Certification Plan, if the property does not meet current Code and Regulation.

Septic Contractor: Harfield's Equipment Contractor's Phone: 301 490 4289
 Contractor's Address: P.O. Box 519 Annapolis Junction MD 20701

Property Address: 7225 Mink Hollow Road County file: _____
 Subdivision: _____ Lot: _____ Year Built: _____
 Owner's Name: Adam Rafal Owner's Phone: _____

Name of previous owners: _____ Existing bedrooms: 4
 Proposed bedrooms: _____

Has this request been previously discussed with a Sanitarian? (Name): _____
 Public Sewer available/nearby: _____

*A Sanitarian will be in contact within three business days, depending upon the urgency of the situation, to coordinate the scheduling/review of the repair or upgrade.

Prior to scheduling inspections, scaled plans should be submitted to clarify the nature of the addition.

Print out a copy of Real Property Data via Dept. of Taxation website _____ Indexed file found _____

If public sewer may be nearby, verify whether sewer is technically "available" through the Bureau of Engineering.

If sewer is available and the property is within the Metropolitan District, connection to sewer is required. If the owner believes reason for exemption exists, the owner should justify the request in writing.

If soil/site conditions are limited and sewer and/or Metro District status is not conducive to connection, the Sanitarian may recommend pursuit of Emergency Sewer Extension or Emergency Metro District Inclusion. The Owner should contact the Bureau of Utilities for details.

No permit is to be issued nor inspection to be scheduled without prior fee collection at the office unless an emergency situation exists. The contractor is to notify office of the emergency situation as soon as possible.