

# PERMIT

P 26826

A 25392

SEWAGE DISPOSAL SYSTEM

MARYLAND STATE DEPARTMENT OF HEALTH

HOWARD COUNTY

ELLICOTT CITY

DISTRICT 3rd

DATE 9/1/77

**INDEXED**

William K. O'Donnell IS PERMITTED TO INSTALL  ALTER

ADDRESS 8966 Watchlight Court, Columbia, Md. PHONE 997-2963

A SEWAGE DISPOSAL SYSTEM LOCATED AT \_\_\_\_\_

SUBDIVISION \_\_\_\_\_ ROAD Pfefferkorn Road LOT 2

PROPERTY OWNER William K. O'Donnell

ADDRESS same as above

SPECIFICATIONS 3 bedrooms

DRAIN FIELD \_\_\_\_\_ DEPTH \_\_\_\_\_ FEET, BOTTOM AREA \_\_\_\_\_ SQ. FT.

SEEPAGE PITS \_\_\_\_\_ ABSORBENT SIDE-WALL AREA \_\_\_\_\_ SQ. FT.

SEPTIC TANK CAPACITY 1000 GALLONS

FOR GARBAGE GRINDER, INCREASE DISPOSAL AREA 22% & TANK CAPACITY 50%.

OTHER DRY WELL - 360 sq. ft. sidewall area below inlet. Dry well inlet to be 4 ft. deep below original grade. Dry well bottom to be 13 ft. deep below original grade. Place the dry well 177 ft. from the front lot line (the front lot line is 384.30 ft. long) and 150 ft. from the right side of the lot as seen when facing lot from Pfefferkorn Road.

NOTE: ALL PIPE FROM HOUSE TO DISPOSAL AREA MUST BE CAST IRON.  
PERMIT VOID AFTER THREE YEARS.

NOTE: INSTALL STAND PIPE ON SEPTIC TANK AND DRY WELL. STAND PIPES MUST BE 6 INCHES IN DIAMETER. CAST IRON, CONCRETE OR TERRA COTTA ACCEPTED.

PLANS APPROVED BY Raymond Hodges DATE 4/6/77

FILL SEPTIC TANK AND DISTRIBUTION BOX WITH WATER BEFORE CALLING FOR AN INSPECTION. COVER NO WORK UNTIL INSPECTED AND APPROVED.

NEITHER THE HOWARD COUNTY COMMISSIONERS NOR THE HEALTH DEPARTMENT IS RESPONSIBLE FOR THE SUCCESSFUL OPERATION OF ANY SYSTEM.

A25392

9/1/77 p.m.  
9/2/77 a.m.

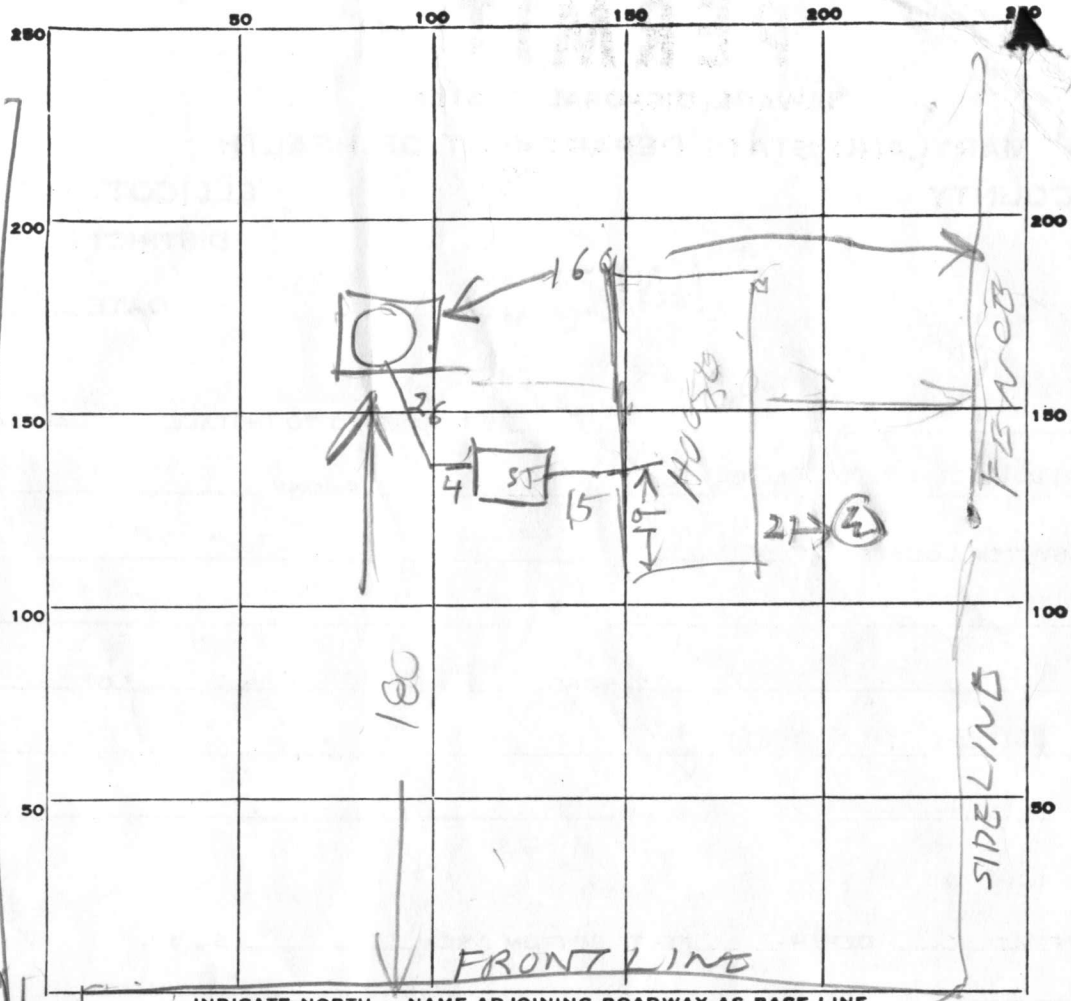

INDICATE NORTH. - NAME ADJOINING ROADWAY AS BASE LINE.

13

PERMIT CARD

SEPTIC TANK, LEVEL OK 1000

CLEANOUTS OK

DISTRIBUTION BOX, LEVEL \_\_\_\_\_

TILE FIELD, DEPTH \_\_\_\_\_ FT. TRENCH WIDTH \_\_\_\_\_ FT.

GRAVEL DEPTH \_\_\_\_\_ IN. TOTAL LENGTH \_\_\_\_\_ FT.

NUMBER OF TRENCHES \_\_\_\_\_ TOTAL BOTTOM AREA \_\_\_\_\_

SEEPAGE PITS, INSIDE DIAMETER PERIMETER 52 FT. DEPTH BELOW INLET 10 FT.

ABSORBENT AREA 520 SQ. FT.

REMARKS 9/1/77 DW inlet 3 1/2 FT deep below grade

DATE SYSTEM APPROVED

9/1/77

INSPECTOR

Raymond Hodge