

C 1 36493

SEQUENCE NO. (MDE USE ONLY)

STATE OF MARYLAND WELL COMPLETION REPORT FILL IN THIS FORM COMPLETELY PLEASE TYPE

THIS REPORT MUST BE SUBMITTED WITHIN 45 DAYS AFTER WELL IS COMPLETED.

1 2 3 6 (THIS NUMBER IS TO BE PUNCHED IN COLS. 3-6 ON ALL CARDS)

COUNTY NUMBER 13

ST/CO USE ONLY DATE RECEIVED MM DD YY 02 01 17

DATE WELL COMPLETED MM DD YY 11 20 17

Depth of Well 22 200' 26 (TO NEAREST FOOT)

PERMIT NO. FROM "PERMIT TO DRILL WELL" 1130/17 SC Ho-15-0398

OWNER Hall Joe and Hill Jennifer WELL SITE ADDRESS Old Frederick Rd TOWN Sykesville SUBDIVISION Five Hills Farm SECTION LOT 3

WELL LOG Not required for driven wells STATE THE KIND OF FORMATIONS PENETRATED, THEIR COLOR, DEPTH, THICKNESS AND IF WATER BEARING DESCRIPTION (Use additional sheets if needed) FEET FROM TO check if water bearing Sand Stone 0 36 Granite 36 200 Water 35' 55' 155'

GROUTING RECORD WELL HAS BEEN GROUTED (Circle Appropriate Box) YES Y NO N TYPE OF GROUTING MATERIAL (Circle one) CEMENT CM BENTONITE CLAY BC NO. OF BAGS 10 NO. OF POUNDS 700 GALLONS OF WATER 60 DEPTH OF GROUT SEAL (to nearest foot) from 0 ft. to 40 ft.

CASING RECORD casing types insert appropriate code below MAIN CASING TYPE ST Nominal diameter top (main) casing (nearest inch)! 6 Total depth of main casing (nearest foot) 42

OTHER CASING (if used) diameter inch depth (feet) from to

SCREEN RECORD screen type or open hole insert appropriate code below ST BR HO PL OT

NUMBER OF UNSUCCESSFUL WELLS: 0 WELL HYDROFRACTURED YES Y NO N

CIRCLE APPROPRIATE LETTER A A WELL WAS ABANDONED AND SEALED WHEN THIS WELL WAS COMPLETED E ELECTRIC LOG OBTAINED P TEST WELL CONVERTED TO PRODUCTION WELL

I HEREBY CERTIFY THAT THIS WELL HAS BEEN CONSTRUCTED IN ACCORDANCE WITH COMAR 26.04.04 "WELL CONSTRUCTION" AND IN CONFORMANCE WITH ALL CONDITIONS STATED IN THE ABOVE CAPTIONED PERMIT...

DRILLERS LIC. NO. 1 MSD024 DRILLER'S SIGNATURE LIC. NO. 1 MSD027 SITE SUPERVISOR (sign. of driller or journeyman responsible for sitework if different from permittee)

C 2 DEPTH (nearest ft.) 1 2 38 200 8 9 11 15 17 21 23 24 26 30 32 36 38 39 41 45 47 51 SLOT SIZE 1 2 3 DIAMETER OF SCREEN (NEAREST INCH) 56 60

GRAVEL PACK IF WELL DRILLED WAS FLOWING WELL INSERT F IN BOX 68 MDE USE ONLY (NOT TO BE FILLED IN BY DRILLER) T (E.R.O.S.) W Q TELESCOPE CASING LOG INDICATOR OTHER DATA

C 3 PUMPING TEST HOURS PUMPED (nearest hour) 3 PUMPING RATE (gal. per min.) 10 METHOD USED TO MEASURE PUMPING RATE Bucket WATER LEVEL (distance from land surface) BEFORE PUMPING 39 ft. WHEN PUMPING 150 ft. TYPE OF PUMP USED (for test) S submersible

PUMP INSTALLED DRILLER INSTALLED PUMP (CIRCLE) YES NO IF DRILLER INSTALLS PUMP, THIS SECTION MUST BE COMPLETED FOR ALL WELLS. TYPE OF PUMP INSTALLED PLACE (A,C,J,P,R,S,T,O) IN BOX 29 CAPACITY: GALLONS PER MINUTE (to nearest gallon) 31 35 PUMP HORSE POWER 37 41 PUMP COLUMN LENGTH (nearest ft.) 43 47 CASING HEIGHT (circle appropriate box and enter casing height) + above LAND SURFACE - below 2 (nearest foot)

LATITUDE 39.33354 LONGITUDE 76.99441 (DEFAULT COORD. WGS 84) Pursuant to §10-624 of the State Govt. Article of the Maryland Code personal info. requested on this form is used in processing this form pursuant to COMAR 26.04.04. Failure to provide the info. may result in this form not being processed.

TAB = 1/11/17

B 1 37555
1 2 3 6

SEQUENCE NO.
(MDE USE ONLY)

STATE OF MARYLAND
APPLICATION FOR PERMIT TO DRILL WELL
559858 please type

STATE PERMIT NUMBER

Ho - 15 - 0398
70 fill in this form completely 79

Date Received (APA)
12/01/16
8 MM DD YY 13

OWNER INFORMATION

15 Last Name: Hill, Joe and Hill, Jennifer
36 Street or RFD: P.O. Box 189
57 Town: Woodbine MD 70 State: 72 Zip: 21797

B 3 LOCATION OF WELL

8 COUNTY: Howard 21
23 SUBDIVISION: Five Hills Farm 42
SECTION: 44 46 LOT: 3 48 50
52 NEAREST TOWN: Sykesville 71

DRILLER INFORMATION

Driller's Name: Joseph L Mayne MS DO 24
Firm Name: Joseph L Mayne Well Drilling
Address: 5512 Ridge Rd Mt Airy MD 21771
Signature: Joseph L Mayne Date: 11-30-2016

B 4

SOURCES OF DRILLING WATER

1. well
2. HCHD Insp 1/10/17
3. 42' casing 3 gpm H2O @ 36' ± 55' bedrock @ 35'

11 Old Fredericks Rd 30
STREET ADDRESS

ON WHICH SIDE OF ROAD
(CIRCLE APPROPRIATE BOX)



34 500 37
DISTANCE FROM ROAD
ENTER FT OR MI Ft 38 39

TAX MAP: 9 BLK: 7 PARCEL 117

B 2 WELL INFORMATION

APPROX. PUMPING RATE (GAL. PER MIN.) 8 5 12
AVERAGE DAILY QUANTITY NEEDED (GAL. PER DAY) 14 500 20

USE FOR WATER (CIRCLE APPROPRIATE BOX)

- DOMESTIC POTABLE SUPPLY & RESIDENTIAL IRRIGATION
- FARMING (LIVESTOCK WATERING & AGRICULTURAL IRRIGATION)
- INDUSTRIAL, COMMERCIAL, DEWATERING
- PUBLIC WATER SUPPLY WELL
- TEST, OBSERVATION, MONITORING
- OPEN LOOP GEOTHERMAL
- CLOSED LOOP GEOTHERMAL

NOT TO BE FILLED IN BY DRILLER
HEALTH DEPARTMENT APPROVAL

Howard 13 COUNTY NAME COUNTY NO.
STATE SIGNATURE INSERT S → 41
DATE ISSUED: 12/21/16 Sub L.L. 12/21/17
43 MM DD YY 48 CO SIGNATURE EXP. DATE

Don: 1/9/17 DOG: 1/11/17 DOY: 1/11/17

APPROXIMATE DEPTH OF WELL 24 300 28 FEET

APPROXIMATE DIAMETER OF WELL 6 NEAREST INCH

METHOD OF DRILLING (circle one)

- BORED (or Augered) JETTED Jetted & DRIVEN
- 30 AIR-ROTary AIR-PERCussion ROTARY (Hydraulic Rotary)
- 37 CABLE REVERSE-ROTary DRIVE-POINT
- other

REPLACEMENT OR DEEPEMED WELLS
(CIRCLE APPROPRIATE BOX)

- THIS WELL WILL NOT REPLACE AN EXISTING WELL
- THIS WELL WILL REPLACE A WELL THAT WILL BE ABANDONED AND SEALED
- 39 THIS WELL WILL REPLACE A WELL THAT WILL BE USED AS A STANDBY-CONTACT LOCAL APPROVING AUTHORITY FOR POLICY ON STANDBY WELLS
- THIS WELL WILL DEEPEM AN EXISTING WELL

PERMIT NUMBER OF WELL TO BE REPLACED OR DEEPEMED (IF AVAILABLE) 41 52

Not to be filled in by driller (MDE OR COUNTY USE ONLY)

APPROX. PERMIT NUMBER G
PERMIT No. Ho - 15 - 0398
70 71 72 73 74 75 76 77 78 79

PROPOSED LOCATION OF WELL ON LOT
SHOW PERMANENT STRUCTURES SUCH AS BUILDINGS, SEPTIC SYSTEM, ROADS AND/OR LANDMARKS AND INDICATE NOT LESS THAN TWO DISTANCE MEASUREMENTS TO WELL

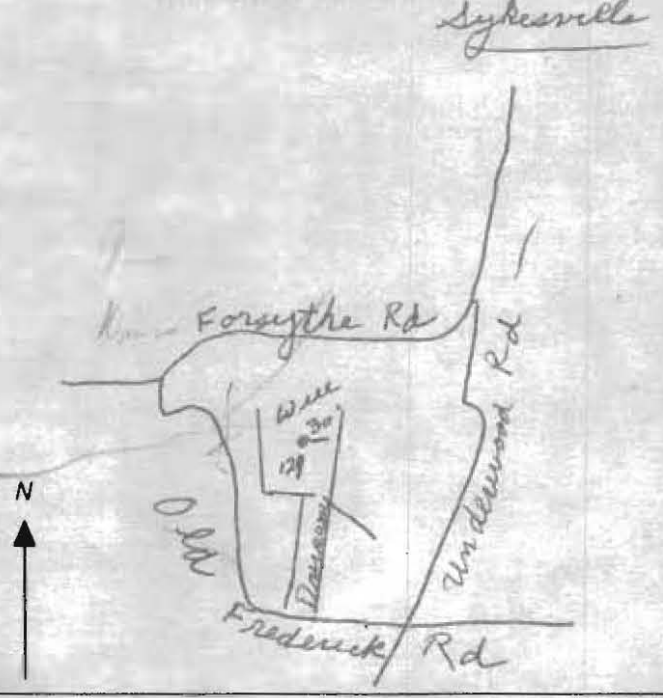

SPECIAL CONDITIONS

NOTE: APPROVING AUTHORITIES SHOULD USE SEPARATE SHEET IF NEEDED

**HOWARD COUNTY HEALTH DEPARTMENT
BUREAU OF ENVIRONMENTAL HEALTH
WELL & SEPTIC PROGRAM
TEL: (410)313-1771 FAX: (410)313-2648**

Information Form for the Installation of the Well Pump, Pitless Adapter, and Supply Piping

NOTE: The installer is responsible for requesting an inspection prior to 9 am on the day of the desired inspection. No work is to be covered until approved by the Health Department. All installations must comply with the National Standard Plumbing Code (NSPC, as amended locally) and COMAR 26.04.04 (MD Well Construction Regulations). Submission of a complete form is required prior to Use and Occupancy approval.

Company Name: Robert L. Feezer Co. Telephone #: 410-781-4655
Address: 6321 Barnett Avenue
Sykesville, MD 21784

(Must circle one) Licensed Plumber Licensed Well Driller Licensed Well Pump Installer
License # and name of individual responsible for the field installation:
Name (Print): Russel C. George License# PI0148

***A licensed individual must perform the actual installation. Apprentices must be under the supervision of a licensed journeyman or master plumber, pump installer or well driller. Licenses may be subjected to field verification. Unlicensed individuals may be reported to the appropriate licensing agency.**

Name of Property Owner: JMB Homes Telephone #: 240-372-3571
Subdivision: _____ Lot #: 3 Well Tag #: HO - 15 - 0398 ✓
Site Address: 13900 Old Frederick Road
Sykesville, MD 21784

Submersible Pump Data

Make: Schaefer
Model #: 7SR07S4-2W230
Pump Capacity 7 GPM
Well Yield: 10 GPM

Pitless Adapter

Make: Boshart
Model#: P-100-SS
Depth: 42" (36" min)
NSF/WSC approved: Yes

Well Cap and Electric Conduit

Two piece watertight cap: Yes
Screened, vented well cap: Yes
Cap secured to casing: Yes
Conduit min 18" B.G.: Yes
Conduit secured to well cap: Yes

Depth of well encountered at time of pump installation: 200 (feet)
If pump capacity exceeds well yield, a low water cut off switch is required by NSPC 1990 Section 17.8.4
Torque arrestors, Cable guards, or other acceptable method used- Must circle one
Safety rope, if used, attached to brass rope adapter or other acceptable method inside of well casing N/A

Piping to house

Type: Poly
PSI: 200 (160 psi min)
Depth of supply line: 42" (36" min)

House Connection

PVC sleeve to undisturbed soil at wall penetration: Yes
Length of sleeve(5' minimum from foundation): 10'
Sleeve sealed properly: Yes

The water supply line is required to be at least ten feet from the septic tank, pump chamber, sewage piping, distribution box, drainfields, and sewage reserve area. If this cannot be accomplished, contact this office for approval prior to installation.

Russell C. George April 28, 2018
Signature of company representative responsible for installation date

For Health Department Use Only – Not to be completed by Installer

Date Insp. Requested: 5/3/18 Date Insp. Approved: 5/3/18 Inspector: SC
Inspection Data: Pitless adapter watertight & water supply line at least 36" below grade ✓
Two piece cap installed and attached to casing securely ✓
Elec. conduit extends at least 18" below grade/attached to cap properly ✓
Safety rope not outside of well cap/casing ✓
Correct well tag attached properly and casing 8" above finished grade ✓
Water supply line sleeved adequately at house connection ✓
Adequate grout observed below pitless adapter ✓

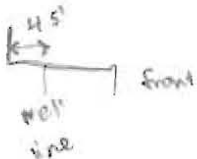

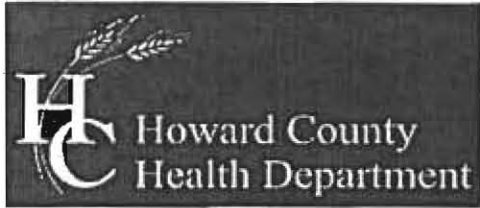

Bureau of Environmental Health

8930 Stanford Boulevard, Columbia, MD 21045

Main: 410-313-2640 | Fax: 410-313-2648

TDD 410-313-2323 | Toll Free 1-866-313-6300

www.hchealth.org

Facebook: www.facebook.com/hocohealth

Twitter: HowardCoHealthDep

Maura J. Rossman, M.D., Health Officer

TO ALL INTERESTED PARTIES

When submitting a well permit application for a proposed well, please indicate one of the following:

Well Site Location:

FIVE HILLS FARM
Subdivision/Property Name

3
Lot #

OLD FREDERICK ROAD
Road Name

The well site, as shown on the attached well site plan, has been staked by

FISHER, COLLINS & CARTER, INC.
(professional land surveyor or company employing professional land surveyors)

on 12/09/16
(date)

The well driller, builder or property owner will call the Health Department to schedule a time to meet in the field to verify the proposed well site location.

This sheet, along with two copies of an acceptable well site plan, must be attached to the green well permit application.



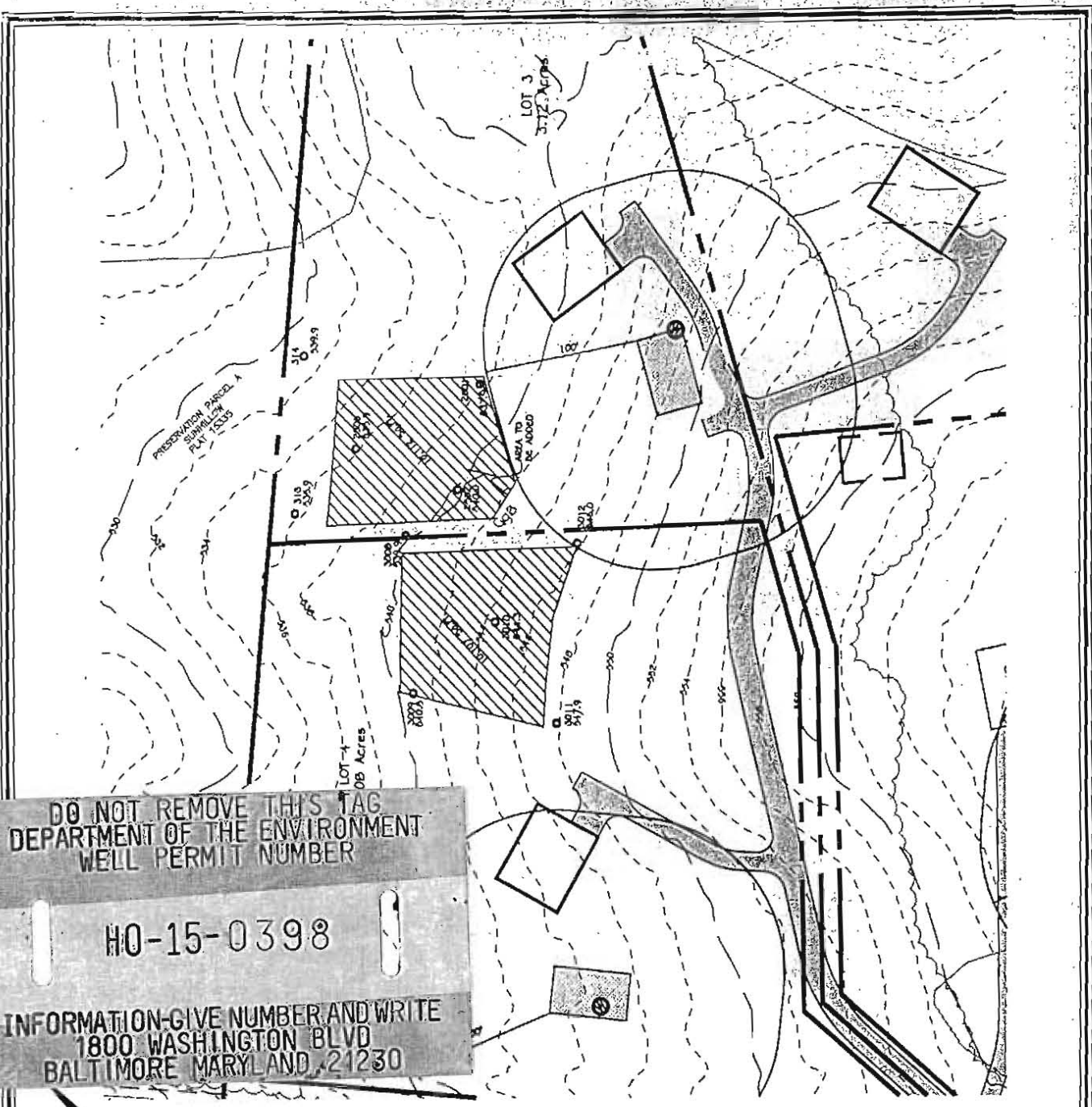

DO NOT REMOVE THIS TAG
 DEPARTMENT OF THE ENVIRONMENT
 WELL PERMIT NUMBER
 HO-15-0398
 INFORMATION-GIVE NUMBER AND WRITE
 1800 WASHINGTON BLVD
 BALTIMORE MARYLAND 21230

Well box approved
 12/21/16 SC

Well box staked by
 Fisher, Collins
 + Carter

WELL EXHIBIT
FIVE HILL FARM
 LOT 3

FISHER, COLLINS & CARTER, INC.
 CIVIL ENGINEERING CONSULTANTS & LAND SURVEYORS
 CENTENNIAL SQUARE OFFICE PARK - 10272 BALTIMORE NATIONAL PIKE
 ELLICOTT CITY, MARYLAND 21042
 (410) 461 - 2855

TAX MAP #9 GRID 7 PARCEL: 117
 4TH ELECTION DISTRICT HOWARD COUNTY, MARYLAND
 SCALE: 1"=100' DATE: NOVEMBER 29, 2016

F:\2014\14001\dwg\14001-3001 Well Exhibit.dwg, 11/29/2016, 6:56:27 AM, 17

Maura J. Rossman, M.D., Health Officer

INTERIM CERTIFICATE OF POTABILITY
PERMANENT DEVIATION FOR NITRATES

Expiration Date – JANUARY 26, 2019

July 26, 2018

Homeowner
13900 Old Frederick Road
Sykesville, MD 21784

RE: Five Hills Farm, Lot 3
13900 Old Frederick Road
Building Permit: B17002681
Well Permit: HO-15-0398

Dear Homeowner:

This is to advise you that the septic system installation and water well construction for the above referenced property have been inspected and approved. Final approval of the septic system was granted on **07/12/2018**. Final approval of the well line connection to the dwelling was granted on **05/03/2018**. The well construction was completed on **01/11/2017**. Water samples were collected on **07/17/2018**, **07/24/2018**.

The water sample results indicate that the water samples submitted for testing were free of coliform and fecal coliform bacteria at the time of sampling and are bacteriologically safe for drinking.

The untreated water sample collected on **7/17/2018** indicated a nitrate level of **20.0 mg/L**. **This exceeds the maximum contaminant limit of 10 mg/L set forth in COMAR 26.04.04.09**. After installation of a nitrate removal device (kitchen tap reverse osmosis system), a post-treatment water sample was collected on **7/24/2018** and indicated a nitrate level of **<1.0 mg/L**.

This Department will grant a **permanent deviation** to the Interim Certificate of Potability on condition that the nitrate removal system effectively maintains a nitrate-nitrogen contaminant level of **10 mg/L or less**.

Furthermore, it will be necessary for you to comply with the following conditions:

1. The system must be properly operated and maintained continuously in accordance with the service contract for the life of the residence.
2. It is recommended that a Maryland certified water laboratory certified for nitrates analysis perform a yearly nitrate analysis.
3. If you decide to sell or rent your home in the future, you must make any potential buyer/tenant aware of this permanent deviation. **A person who fails to make this disclosure is subject to the penalties set out in COMAR 26.04.04.12F Enforcement and Environment Article 9-1311, Annotated Code of Maryland.**



Bureau of Environmental Health
8930 Stanford Blvd | Columbia, MD 21045
410.313.2640 - Voice/Relay
410.313.2648 - Fax
1.866.313.6300 - Toll Free

Maura J. Rossman, M.D., Health Officer

This certifies that the initial sampling requirements of COMAR 26.04.04 "Well Regulations" have been met for the water supply system installed under well permit HO-15-0398. Although the submitted sample results are in compliance with COMAR standards, the Health Department does not guarantee water supplies.

This Interim Certificate of Potability will expire **six months** from the date of issuance. Submission of a second bacteriological test indicating the water is free of coliform and fecal coliform bacteria is required prior to the expiration date, after which time a Final Certificate of Potability will be issued. **Failure to submit an additional sample and obtain a Final Certificate of Potability will result in a Notice of Violation and is punishable as a misdemeanor under the Annotated Code of Maryland, Environment Article, 9-1311, subject to a fine of up to \$500 or imprisonment not to exceed three months.**

Please contact (410) 313-1773 to schedule a final water sample appointment or contact a Maryland certified water quality laboratory to schedule a water sample. A list of laboratories certified by the state of Maryland may be found at the following website:
<http://www.mde.state.md.us/assets/document/WSP-Labs-2010apr16.pdf>

In closing, please refer to our "[Homeowner Fact Sheet](#)" which illustrates a better understanding for your onsite sewage disposal system. You will also find a link to Maryland Department of the Environment website which describes in further detail operation and maintenance of your septic system.

Approving Authority,

A handwritten signature in black ink, appearing to read 'Kevin M. Wolf', is written over a horizontal line.

Kevin M Wolf, L.E.H.S., R.E.H.S./RS, Supervisor
Groundwater Management Section
Well & Septic Program

cc: Howard County Dept. of Inspections, Licenses, and Permits
Community Hygiene Program
File

Wolf, Kevin

From: Wolf, Kevin
Sent: Tuesday, July 24, 2018 1:53 PM
To: jberger@jmbhomes.com
Subject: 13900 Old Frederick Road
Attachments: Nitrate Agreement 7.16.18.pdf

John,
Looking at the submitted water test results, the well is elevated for Nitrates. You will need to install a treatment device capable of treating the excessive nitrates and resample for nitrate again post treatment. Also the attached nitrate agreement needs to be completed by the homeowner and brought back to us to review and sign. You will take this signed agreement to Land Records and record with the deed. Bring a copy of the receipt back to us for record of completion.

Thanks,

Kevin M. Wolf, LEHS, REHS/RS
Groundwater Mgmt. Sec. Supervisor
Well & Septic Program
Bureau of Environmental Health
8930 Stanford Blvd.
Columbia, MD 21045
(o) 410-313-2645
(f) 410-313-2648



kwolf@howardcountymd.gov

CONFIDENTIALITY NOTICE

This message and the accompanying documents are intended only for the use of the individual or entity to which they are addressed and may contain information that is privileged, confidential, or exempt from disclosure under applicable law. If the reader of this email is not the intended recipient, you are hereby notified that you are strictly prohibited from reading, disseminating, distributing, or copying this communication. If you have received this email in error, please notify the sender immediately and destroy the original transmission.

ENVIRO-CHEM LABORATORIES, INC.

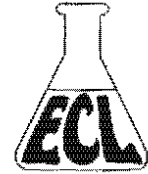

47 Loveton Circle, Suite K • Sparks, Maryland 21152

410-472-1112

FINAL REPORT OF ANALYSIS

JMB Homes
15880 Ten Estates Dr.
Woodbine, MD 21797

Report Date: 07/26/2018
Report Number: 180726094100
Use and Occupancy
PERMIT #: B17002681

LAB#- E054940-01 SAMPLE ID- 13900 Old Frederick Rd WELL # HC 15-0398
LOCATION- RO Unit SAMPLER- B Grocott #7618 BG
DATE SAMPLED- 07/24/2018 TIME SAMPLED- 13:14 CHLORINE-
DATE RECEIVED- 07/24/2018 TIME RECEIVED- 14:06
DELIVERED BY- Benjamin Grocott RECEIVED BY- Stephen Shelley
COMMENTS-

COMMENTS-

ANALYSIS	METHOD	ANALYSIS DATE/TIME	BY	RESULT	DATA FLAG
Wet Chemistry by Enviro-Chem					
Nitrate (as N)	EPA 300.0	07/25/18 20:33	SES	< 0.2 mg/L	PASS

Stephen Shelley
Laboratory Director

Certifications

State of Maryland Laboratory #192

ENVIRO-CHEM LABORATORIES, INC.



47 Loveton Circle, Suite K • Sparks, Maryland 21152

410-472-1112

FINAL REPORT OF ANALYSIS

JMB Homes
15080 Ten Estates Dr,
Woodbine, MD 21797

Report Date: 07/20/2018
Report Number: 180720103940
Use and Occupancy
PERMIT #: E17002681

LAB#- E054843-01 SAMPLE ID- 13900 Old Frederick Rd WELL # HO 15-0398
LOCATION- Powder Room DATE SAMPLED- 07/17/2018 TIME SAMPLED- 10:26 SAMPLER- B Grocott #7618 BG
DATE RECEIVED- 07/17/2018 TIME RECEIVED- 12:54 CHLORINE- <0.05 mg/L
DELIVERED BY- Benjamin Grocott RECEIVED BY- Ginny Shelley
COMMENTS- Secure well, 2 piece metal cap and casing. Sediment filter.

COMMENTS-

ANALYSIS	METHOD	ANALYSIS DATE/TIME	BY	RESULT	DATA FLAG
Microbiology by Enviro-Chem					
Total Coliform	SM 9223B	07/17/18 14:15	VPS	Absent	PASS
E. Coli	SM 9223B	07/17/18 14:15	VPS	Absent	PASS

Based on coliform bacteriological standards, at the time of sampling this water was **SAFE** for drinking water purposes.

Wet Chemistry by Enviro-Chem

Nitrate (as N)	EPA 300.0	07/16/18 13:21	BMG	20.0	mg/L	FAIL
pH	SM4500-R+B	07/17/18 16:00	FRD	5.5	SU	
Turbidity	EPA 180.1	07/17/18 16:00	FRD	3.0	NTU	

The USEPA has set a Maximum Contaminant Level (MCL) for Nitrate at 10mg/L Nitrate as N. The above sample exceeds the MCL.

*Nitrate Alert
Agreement signed/recorded*

ENVIRO-CHEM LABORATORIES, INC.

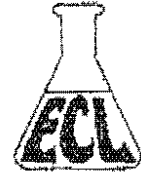

47 Loveton Circle, Suite K • Sparks, Maryland 21152

410-472-1112

FINAL REPORT OF ANALYSIS

JMB Homes
15800 Ten Estates Dr.
Woodbine, MD 21797

Report Date: 07/20/2018
Report Number: 180720103940
Use and Occupancy
PERMIT #: B17002681

LAB#- 8054843-02 SAMPLE ID- 13900 Old Frederick Rd WELL # HC 15-0398
LOCATION- Pressure Tank SAMPLER- B Grocott #7618 RG
DATE SAMPLED- 07/17/2018 TIME SAMPLED- 10:36 CHLORINE-
DATE RECEIVED- 07/17/2018 TIME RECEIVED- 12:34
DELIVERED BY- Benjamin Grocott RECEIVED BY- Ginny Shelley
COMMENTS- Secure well, 2 piece metal cap and casing. Sediment filter.

COMMENTS-

ANALYSIS	METHOD	ANALYSIS DATE/TIME	BY	RESULT	DATA FLAG
Wet Chemistry by Enviro-Chem					
Sand	EPA 160.5	07/17/18 16:15	VFS	< 0.5 ml/L/Hr	

Stephen Shelley
Laboratory Director

Certifications

State of Maryland Laboratory #192