

7/21/86
1:30 P.M.

7/31/86
approved
S. Ahe

PERMIT

SEWAGE DISPOSAL SYSTEM

MARYLAND STATE DEPARTMENT OF HEALTH*

P 36444

A REPAIR

HOWARD COUNTY
BUREAU OF ENVIRONMENTAL HEALTH

ELLICOTT CITY

DISTRICT 4

~~X7807 0830 X~~
461-9933

INDEXED

DATE 1-22-86

Bud Arnold IS PERMITTED TO INSTALL _____ ALTER X

ADDRESS Woodbine, Maryland PHONE 795-1285

SUBDIVISION _____ ROAD 18234 Penn Shop LOT _____

PROPERTY OWNER Ralph Hayne FRANK DELPH

ADDRESS 18234 Penn Shop Road
Mt. Airy, Maryland 831-5242

IF GARBAGE GRINDER IS USED INCREASE SEPTIC TANK CAPACITY BY 50% AND ABSORPTION AREA BY 22%.

GARBAGE GRINDER? YES _____ NO X

SEPTIC TANK CAPACITY 1000 GALLONS NUMBER OF BEDROOMS 2

REPAIR - CALL FOR INSPECTION WHEN GROUND IS OPENED UP SO SANITARIAN CAN RECOMMEND

REPAIR.

PLANS APPROVED BY C. Williams DATE 1/20/86

COVER NO WORK UNTIL INSPECTED AND APPROVED.

NEITHER THE HOWARD COUNTY COUNCIL NOR THE HEALTH DEPARTMENT IS RESPONSIBLE FOR THE SUCCESSFUL OPERATION OF ANY SYSTEM.

NOTE: IF TRENCH IS USED CALL FOR INSPECTION BEFORE AND AFTER PLACING GRAVEL IN TRENCH.

NOTE: NO DRY WELL SHALL EXCEED 15 FOOT IN DIAMETER. NO ABSORPTION TRENCH TO EXCEED 100 FEET IN LENGTH.

NOTE: ALL PIPE FROM HOUSE TO SEPTIC TANK MUST BE CAST IRON OR SCHEDULE 40 PVC OR ABS.

PERMIT VOID AFTER THREE YEARS.

NOTE: INSTALL STAND PIPE ON SEPTIC TANK AND DRY WELL. STAND PIPES MUST BE 6 INCHES IN DIAMETER CAST IRON, CONCRETE OR TERRA COTTA, OR PVC OR ABS ACCEPTED. IF TOP OF SEPTIC TANK IS DEEPER THAN 3 FEET MANHOLE TO GRADE REQUIRED

***INSTALLER IS RESPONSIBLE FOR OBTAINING FINAL APPROVAL ON THIS PERMIT**

CALL 992-2930 FOR INSPECTION OF SEPTIC SYSTEMS.

EH - 2-1082

A 36444

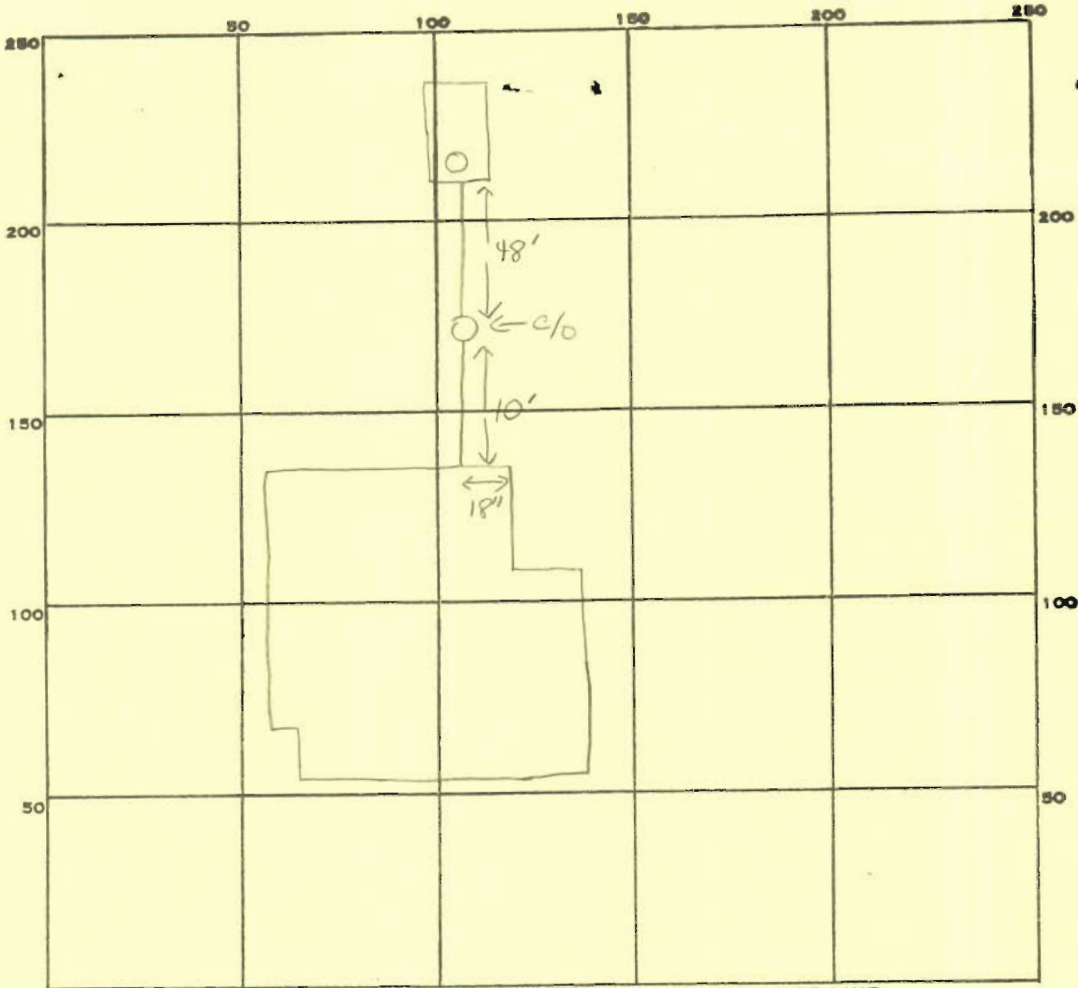

INDICATE NORTH. - NAME ADJOINING ROADWAY AS BASE LINE.

PENN SHOP RD.

PERMIT CARD

SEPTIC TANK, LEVEL 1000 GAL Holding CLEANOUTS IN LINE & TANK

DISTRIBUTION BOX, LEVEL N/A

TILE FIELD, DEPTH _____ FT. TRENCH WIDTH _____ FT.

GRAVEL DEPTH _____ IN. TOTAL LENGTH _____ FT.

NUMBER OF TRENCHES _____ TOTAL BOTTOM AREA _____

SEEPAGE PITS, INSIDE DIAMETER _____ FT. DEPTH BELOW INLET _____ FT.

ABSORBENT AREA _____ SQ. FT.

REMARKS 7/31/86 - ALARM INSTALLED AND WORKING. S. Abel

DATE SYSTEM APPROVED TEMPORARY 7-31-86 INSPECTOR S. Abel