



Building Permit Application

Howard County Maryland
Department of Inspections, Licenses and Permits
3430 Court House Drive
Permits: 410-313-2455
www.howardcountymd.gov

Date Received: _____

Permit No.: _____

Building Address: 6567 BELMONT WOODS RD
City: ELKRIDGE State: MD Zip Code: 21075
Suite/Apt. #: _____ SDP/WP/BA #: _____
Census Tract: _____ Subdivision: BELMONT WOODS
Section: _____ Area: _____ Lot: _____
Tax Map: _____ Parcel: _____ Grid: _____
Zoning: _____ Map Coordinates: _____ Lot Size: _____

Existing Use: DECK
Proposed Use: NEW DECK
Estimated Construction Cost: \$ 15,100.00
Description of Work: NEW PT DECK
REPLACING OLD ONE
OF SAME SIZE

Occupant/Tenant Name: _____
Was tenant space previously occupied? Yes No
Contact Name: _____
Address: _____
City: _____ State: _____ Zip Code: _____
Phone: _____ Fax: _____
Email: _____

Property Owner's Name: BOYD, MEG
Address: 6567 BELMONT WOODS RD
City: ELKRIDGE State: MD Zip Code: 21075
Phone: 410-206-1601 Fax: _____
Email: _____

Applicant's Name & Mailing Address, (if other than stated herein)
Applicant's Name: KAREL STRAKA
Address: 4428 BRITTANY DR
City: ELICOTT CITY State: MD Zip Code: 21094
Phone: 301-256-5457 Fax: _____
Email: INFO@STRAKACONTRACTING.COM

Contractor Company: STRAKA CONTRACTING LLC
Contact Person: KAREL STRAKA
Address: 4428 BRITTANY DR
City: ELICOTT CITY State: MD Zip Code: 21093
License No.: 104115
Phone: 855-578-7252 Fax: _____
Email: INFO@STRAKACONTRACTING.COM

Engineer/Architect Company: _____
Responsible Design Prof.: _____
Address: _____
City: _____ State: _____ Zip Code: _____
Phone: _____ Fax: _____
Email: _____

Commercial Building Characteristics	Residential Building Characteristics	
Height:	<input checked="" type="checkbox"/> SF Dwelling <input type="checkbox"/> SF Townhouse	
No. of stories:	<u>Depth</u>	<u>Width</u>
Gross area, sq. ft./floor:	1 st floor:	
	2 nd floor:	
Area of construction (sq. ft.):	Basement:	
	<input type="checkbox"/> Finished Basement	
Use group:	<input type="checkbox"/> Unfinished Basement	
	<input type="checkbox"/> Craw Space	
<u>Construction type:</u>	<input type="checkbox"/> Slab on Grade	
<input type="checkbox"/> Reinforced Concrete	No. of Bedrooms:	
<input type="checkbox"/> Structural Steel	<u>Multi-family Dwelling</u>	
<input type="checkbox"/> Masonry	No. of efficiency units:	
<input type="checkbox"/> Wood Frame	No. of 1 BR units:	
<input type="checkbox"/> State Certified Modular	No. of 2 BR units:	
	No. of 3 BR units:	
	Other Structure:	
	Dimensions:	
<input checked="" type="checkbox"/> Roadside Tree Project Permit	Footings:	
<input type="checkbox"/> Yes <input type="checkbox"/> No	Roof:	
<u>Roadside Tree Project Permit #</u>	<input type="checkbox"/> State Certified Modular	
	<input type="checkbox"/> Manufactured Home	

Utilities	
Electric:	<input checked="" type="checkbox"/> Yes <input type="checkbox"/> No
Gas:	<input type="checkbox"/> Yes <input checked="" type="checkbox"/> No
Water Supply	
<input type="checkbox"/> Public	
<input checked="" type="checkbox"/> Private	
Sewage Disposal	
<input type="checkbox"/> Public	
<input checked="" type="checkbox"/> Private	
Heating System	
<input checked="" type="checkbox"/> Electric <input type="checkbox"/> Oil	
<input type="checkbox"/> Natural Gas <input type="checkbox"/> Propane Gas	
<input type="checkbox"/> Other:	
Sprinkler System:	
<input type="checkbox"/> Yes <input checked="" type="checkbox"/> No	
Grading Permit Number:	
Building Shell Permit Number:	

THE UNDERSIGNED HEREBY CERTIFIES AND AGREES AS FOLLOWS: (1) THAT HE/SHE IS AUTHORIZED TO MAKE THIS APPLICATION; (2) THAT THE INFORMATION IS CORRECT; (3) THAT HE/SHE WILL COMPLY WITH ALL REGULATIONS OF HOWARD COUNTY WHICH ARE APPLICABLE THERETO; (4) THAT HE/SHE WILL PERFORM NO WORK ON THE ABOVE REFERENCED PROPERTY NOT SPECIFICALLY DESCRIBED IN THIS APPLICATION; (5) THAT HE/SHE GRANTS COUNTY OFFICIALS THE RIGHT TO ENTER ONTO THIS PROPERTY FOR THE PURPOSE OF INSPECTING THE WORK PERMITTED AND POSTING NOTICES.

Applicant's Signature

INFO@STRAKACONTRACTING.COM
Email Address

Print Name

KAREL STRAKA

Date

6-14-18

Checks Payable to: DIRECTOR OF FINANCE OF HOWARD COUNTY

PLEASE WRITE NEATLY & LEGIBLY

-FOR OFFICE USE ONLY-

AGENCY	DATE	SIGNATURE OF APPROVAL
State Highways		
Building Officials		
PSZA (Zoning)		
PSZA (Engineering)		
Health	<u>6/18/18</u>	<u>[Signature]</u>

Is Sediment Control approval required for issuance? Yes No
 CONTINGENCY CONSTRUCTION START

DPZ SETBACK INFORMATION	
Front:	
Rear:	
Side:	
Side St.:	
All minimum setbacks met?	<input type="checkbox"/> Yes <input type="checkbox"/> No
Is Entrance Permit Required?	<input type="checkbox"/> Yes <input type="checkbox"/> No
Historic District?	<input type="checkbox"/> Yes <input type="checkbox"/> No
Lot Coverage for New Town Zone:	
SDP/Red-line approval date:	

Filing Fee	\$
Permit Fee	\$
Tech Fee	\$
Excise Tax	\$
PSFS	\$
Guaranty Fund	\$
Add'l per Fee	\$
Total Fees	\$
Sub- Total Paid	\$
Balance Due	\$
Check	#

APPROVED
WALK-THRU BUILDING PERMIT
BP# _____ A# _____
APP. SAN Robert Trema DATE: 6/19/18
DESC. OF WORK: Replacing Existing

Deck
same
size

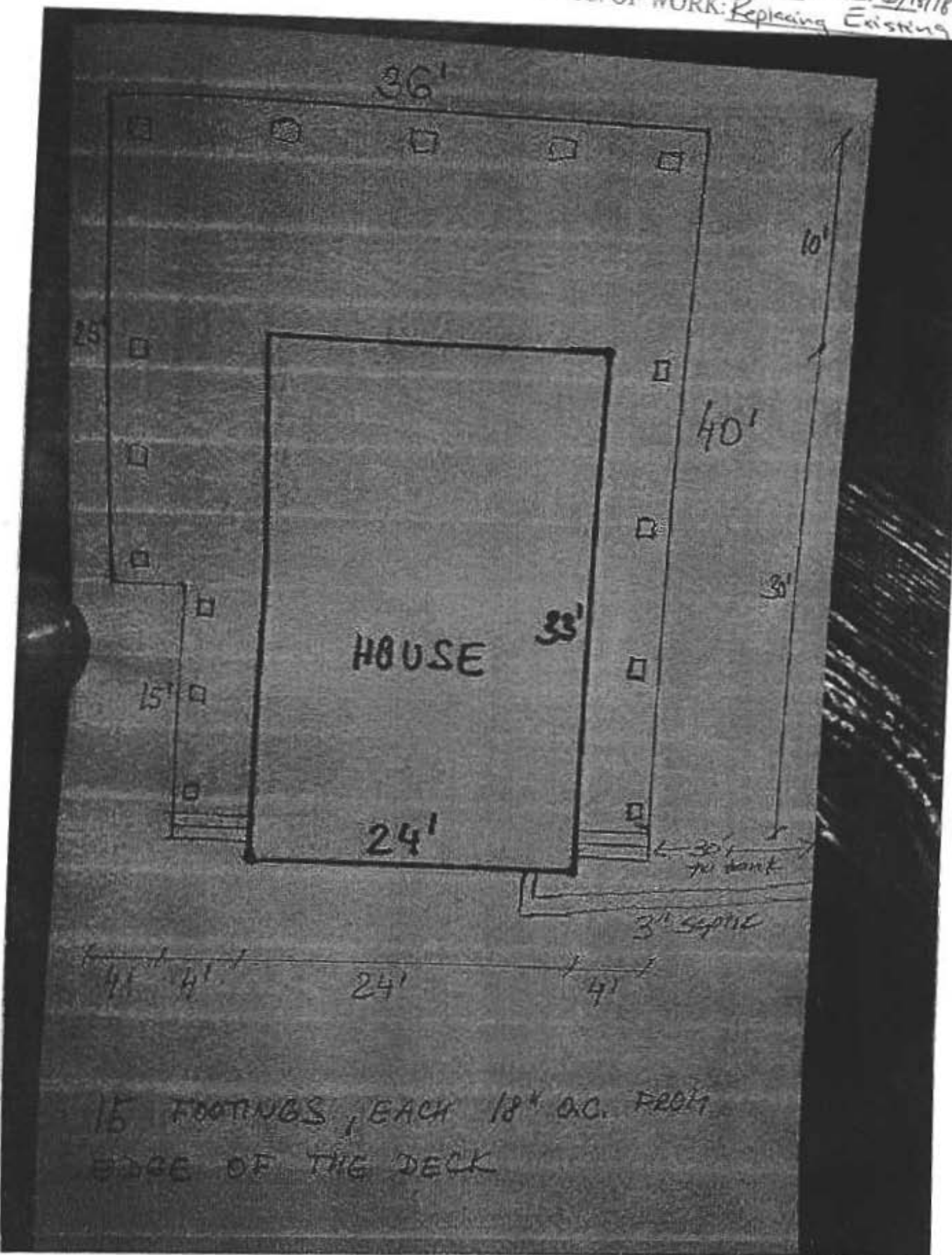

15 FOOTINGS, EACH 18" O.C. FROM
EDGE OF THE DECK

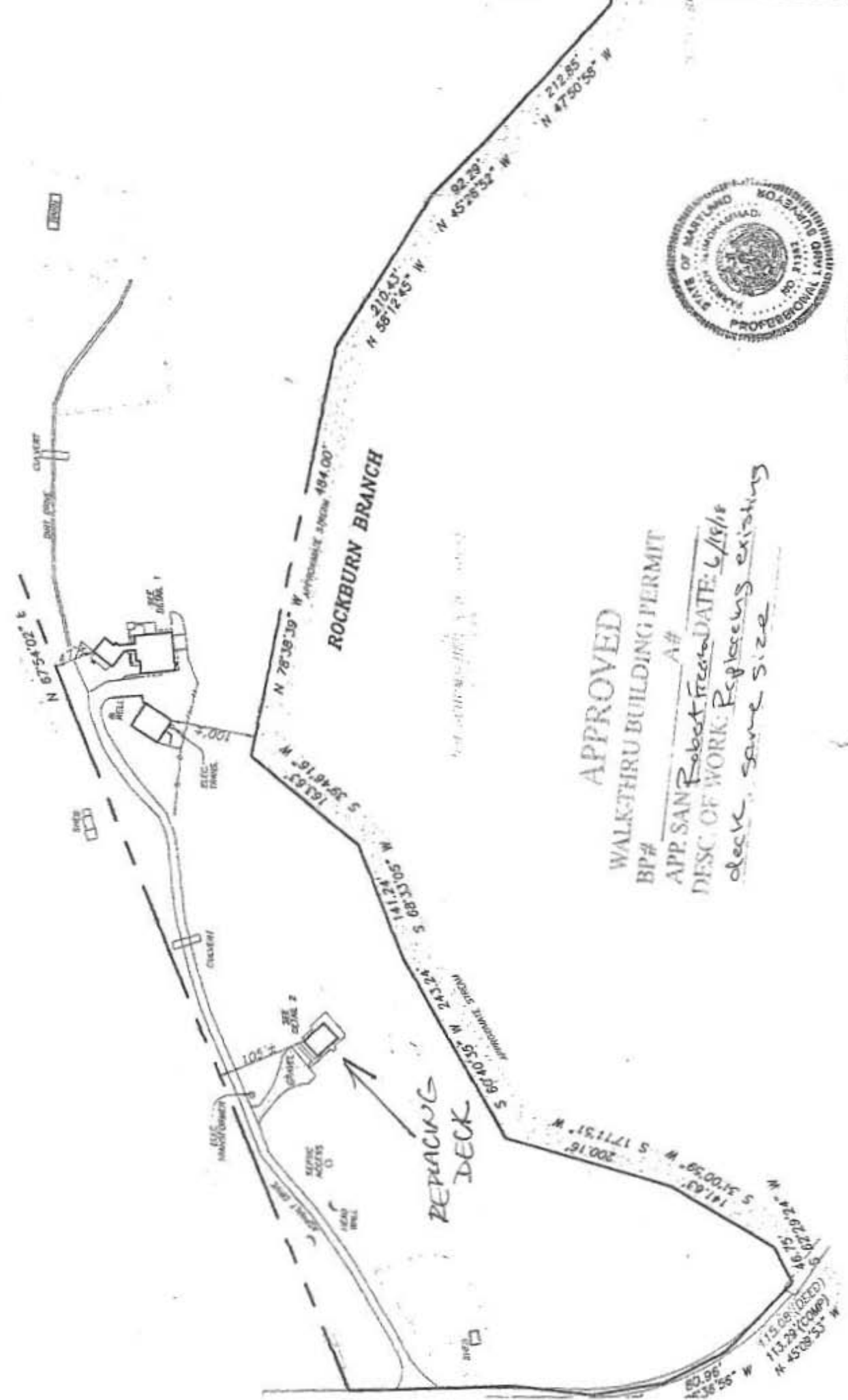

APPROVED
WALKTHRU BUILDING PERMIT
BP# _____ A# _____
APP. SAN Robert Treto DATE: 6/19/18
DESC. OF WORK: Repairing existing
deck, same size