

Bureau of Environmental Health

8930 Stanford Boulevard, Columbia, MD 21045

Main: 410-313-2640 | Fax: 410-313-2648

TDD 410-313-2323 | Toll Free 1-866-313-6300

www.hchealth.org

Facebook: www.facebook.com/hocohealth

Maura J. Rossman, M.D., Health Officer

RECEIPT DATE: 2/1/18 **ONSITE SEWAGE DISPOSAL SYSTEM** P 562420

APPROVAL DATE: 2/6/18 **PERMIT: UPGRADE** A _____

PROPERTY ADDRESS: 11900 Route 216

SUBDIVISION: _____ LOT: _____ TAX ID: 05-360617

CONTRACTOR: Fogle's Septic Clean Inc. EMAIL: kim@foglesinc.com

CONTRACTOR ADDRESS: 580 Obrecht Road, Sykesville, MD 21784 PHONE: 410-795-5670

PROPERTY OWNER: Wallace Mitchell EMAIL: _____

OWNER ADDRESS: 11900 Route 216, Fulton, MD 20759 PHONE: 410-489-9139

SEPTIC TANK SIZE (GALLONS): 1500 PUMP CHAMBER CAPACITY (GALLONS): N/A PUMP SIZE: N/A

NUMBER OF BEDROOMS: 6 HOUSE SQ. FT. 2614 APPLICATION RATE: 0.8

DISTRIBUTION SYSTEM: GRAVITY FED LOW PRESSURE DOSED (existing)

TRENCHES: *Tie into existing trench	LINEAR FEET REQUIRED: <u>N/A</u>	INLET DEPTH: <u>N/A</u>
	TRENCH WIDTH: <u>N/A</u>	MAXIMUM BOTTOM DEPTH: <u>N/A</u>
	MINIMUM SPACE BETWEEN TRENCHES: <u>N/A</u>	EFFECTIVE AREA BEGINNING DEPTH: <u>N/A</u>

LOCATION: **TO BE STAKED BY SANITARIAN DURING PRE-CONSTRUCTION INSPECTION.**

NOTES: Ab ex st, 2 boxes, initial system
New st moved out of 100' Radius of well - To be connected to Ex 22' Replacement trench

ISSUED BY: K. WOLF ISSUE DATE: 2/6/18 EXPIRATION DATE: 2/6/19

- NOTE: CONTRACTOR MUST SCHEDULE A PRE-CONSTRUCTION INSPECTION PRIOR TO BEGINNING ANY INSTALLATION
- NOTE: CONTRACTOR MUST SCHEDULE AN INSPECTION AND GAIN APPROVAL OF ALL COMPONENTS PRIOR TO COVERING
- NOTE: STONE MUST BE APPROVED BY HEALTH DEPARTMENT AND GRAVEL TICKET MUST BE AVAILABLE FOR REVIEW.
- NOTE: WATERTIGHT SEPTIC TANKS REQUIRED
- NOTE: ALL PARTS OF SEPTIC SYSTEM SHALL BE AT LEAST 100 FEET DOWNGRADIENT FROM ANY WATER WELL
- NOTE: MANHOLE RISERS REQUIRED ON ALL SEPTIC TANKS AND PUMP CHAMBERS
- NOTE: AN ELECTRICAL PERMIT IS REQUIRED FOR INSTALLATION OF ANY ELECTRICAL COMPONENTS OF THE SYSTEM
 ELECTRICAL PERMIT ISSUED E N/A
- NOTE: THE HCHD DOES NOT WARRANTY ANY SYSTEM AND CANNOT GUARANTEE THE PERFORMANCE OF THIS SYSTEM AS DESIGNED. BY ACCEPTING THIS PERMIT, THE OWNER AND/OR APPLICANT ACKNOWLEDGE THAT THE SPECIFICATIONS DETAILED IN THIS DESIGN ARE ONE POSSIBLE OPTION AND THAT THE HCHD WILL REVIEW OTHER PROPOSALS. YOU HAVE THE OPTION TO SEEK THE ADVICE OF A QUALIFIED DESIGN CONSULTANT OR PROFESSIONAL ENGINEER FOR FURTHER GUIDANCE.
- NOTE: MDE RECOMMENDS SEPTIC TANKS, BAT, AND OTHER PRETREATMENT UNITS BE PUMPED AT A FREQUENCY ADEQUATE TO ENSURE THAT SOLIDS ARE NOT DISCHARGED TO THE DISPOSAL AREA

NEITHER THE HOWARD COUNTY COUNCIL NOR THE HEALTH DEPARTMENT IS RESPONSIBLE FOR THE SUCCESSFUL OPERATION OF ANY SYSTEM.

**PERMITTEE RESPONSIBLE FOR OBTAINING FINAL APPROVAL ON THIS PERMIT.
CALL 410-313-1771 TO SCHEDULE INSPECTIONS.**

NOT TO SCALE

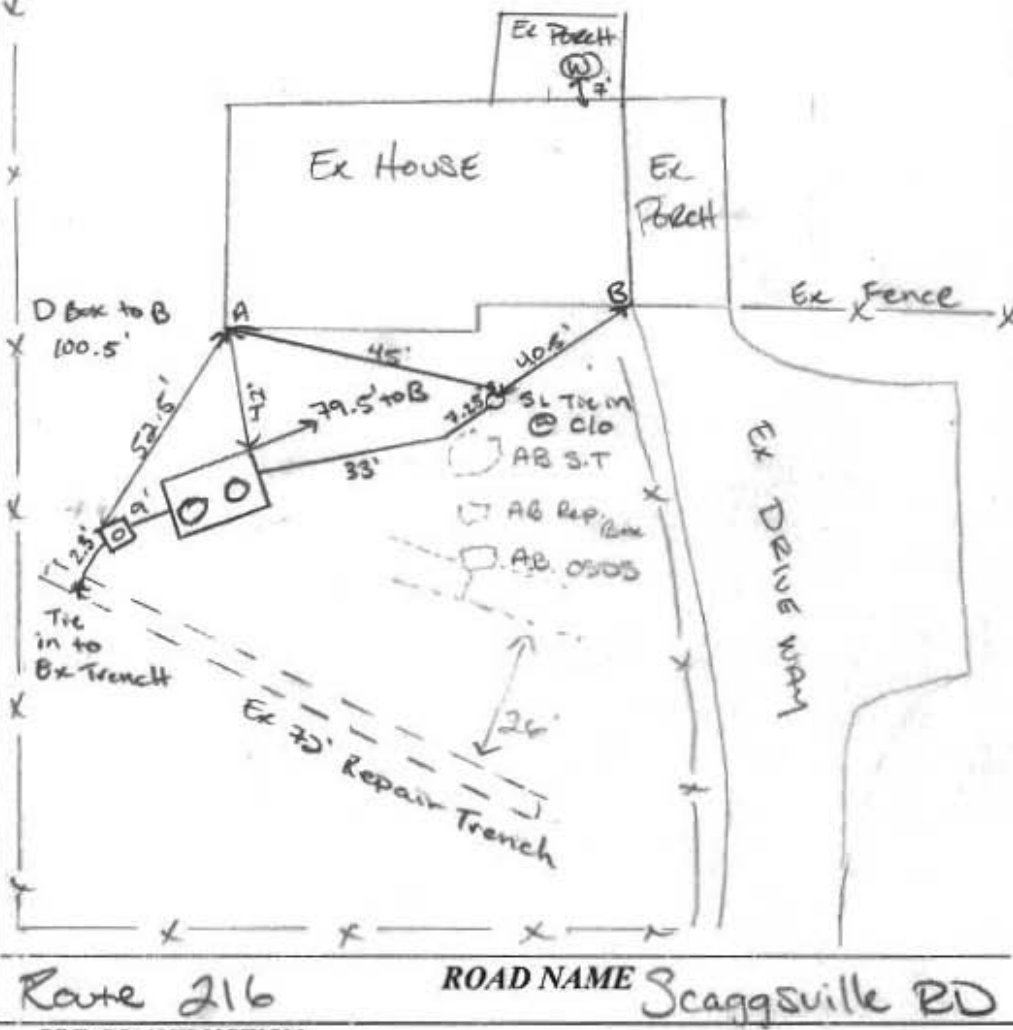

TRENCH/DRAINFIELD DATA

WIDTH	INLET	BOTTOM
2'	4'	11"
NUMBER OF TRENCHES 1		
TOTAL LENGTH 72		
ABSORPTION AREA 504 sq ft (504)		
DISTRIBUTION BOX LEVEL No		
DISTRIBUTION BOX BAFFLE Yes		
DISTRIBUTION BOX PORT Yes		

EXISTING REP. TRENCH (1991)

SEPTIC TANK DATA

SEPTIC TANK I LEVEL	DNI
MANUFACTURER	Babylon
CAPACITY	1500 GAL
SEAM LOC	Top
TANK LID DEPTH	12" - 18" (12")
BAFFLES	Yes
BAFFLE FILTER	No
MANHOLE LOC	Front/Back
6" PORT LOC	Inlet
WATERTIGHT TEST	-
SLOTTED	Yes
DATE ON LID	12/30/17
PUMP/SEPTIC TANK LEVEL	
MANUFACTURER	
CAPACITY	GAL
SEAM LOC	
TANK LID DEPTH	
BAFFLES	N/A
BAFFLE FILTER	
MANHOLE LOC	
6" PORT LOC	
WATERTIGHT TEST	
SLOTTED	
DATE ON LID	

Route 216 ROAD NAME Scaggsville RD

PRE-CONSTRUCTION:

2/5/18 contractor called to discuss tank layout location in regards to a site inspection. Short staffed. Rich contractor OK to set up layout @ noon (2/5/18 Original D Box determined unusable - To be Abandoned). Ex ST. to be AB. New ST site brought out of 100' well radius. AB Ex D Box, S.T., Rep. D Box, Trenches. Connect new ST + D Box to 72' Replacement Trench.

INSTALLATION:

2/6/18 Tank installed. SL. tied into existing line, marked w/ cle. Baffles installed in tank. D Box set. No speed level (one trench). Effluent line tied into existing trench towards North West end (to)

2/6/18
* SL SCH 40 pvc Solvent welded (to)

FINAL INSPECTOR

[Signature]

DATE OF APPROVAL 02/06/2018



HOWARD COUNTY HEALTH DEPARTMENT

62420

DATE
2/1/18

PS

Received From

Jasper Septic
Clean Inc.

PHONE #

410-995-567

For

Septic Repair - 11900 Kt. 216

CASH

CHECK

NO.

59915

One thousand one hundred and fifty dollars

Dollars

\$

1105 100

Received By

Jasper



Bureau of Environmental Health

8930 Stanford Boulevard, Columbia, MD 21045

Main: 410-313-2640 | Fax: 410-313-2648

TDD 410-313-2323 | Toll Free 1-866-313-6300

www.hchealth.org

Facebook: www.facebook.com/hocohealth

Twitter: HowardCoHealthDep

Dr. Maura J. Rossman, M.D., Health Officer

INFORMATION FORM - SEPTIC SYSTEM REPAIR/UPGRADE

Reason for Request:

- Failing System
System relocation for proposed addition
System upgrade for proposed addition
Inadequate treatment zone
Collapsed septic tank
Collapsed drywell

Has the septic tank been pumped within the last month?

- Yes Date pumped:
No

Was a visual inspection of the septic tank and/or drain fields conducted?

- Yes Explain observations: Collapsed tank
No Drain fields D17

Existing system design

- Drywell
Trench
Mound
Unknown
Other:

Was a visual inspection of the sewage line conducted?

- Yes
Blockage leading to the tank
Yes Explain:
No
Blockage leading to the field
Yes Explain: Never Making it passed
No tank

Is discharge surfacing on the ground?

- Yes
No

Additional Comments:

*For REPAIRS, are the owners proposing, or do they plan to add in the future, any additions or modifications to the property, i.e. pools, living space additions, garages, etc? This information must be disclosed at the time of this application. The Health Department will not be able to accommodate requests in the field for property modifications unrelated to the repair request. Such requests may require an additional fee, testing, and submittal of a Percolation Certification Plan, if the property does not meet current Code and Regulation.

Septic Contractor: Fogles Septic Contractor's Phone: 410-795-5670
Contractor's Address: 3000 Brecht Rd Sykesville, Md. 21784
Property Address: 11900 Rt 216 Fulton, Md. 20759 County file:
Subdivision: Lot: Year Built: 1962
Owner's Name: Wallace Mitchell Owner's Phone: 410-651-1540
Name of previous owners: Existing bedrooms: 3 Proposed bedrooms: 4
Has this request been previously discussed with a Sanitarian? (Name): No
Public Sewer available/nearby: No

*A Sanitarian will be in contact within three business days, depending upon the urgency of the situation, to coordinate the scheduling/review of the repair or upgrade.

Prior to scheduling inspections, scaled plans should be submitted to clarify the nature of the addition.

Print out a copy of Real Property Data via Dept. of Taxation website Indexed file found

If public sewer may be nearby, verify whether sewer is technically "available" through the Bureau of Engineering.

If sewer is available and the property is within the Metropolitan District, connection to sewer is required: If the owner believes reason for exemption exists, the owner should justify the request in writing.

If soil/site conditions are limited and sewer and/or Metro District status is not conducive to connection, the Sanitarian may recommend pursuit of Emergency Sewer Extension or Emergency Metro District Inclusion. The Owner should contact the Bureau of Utilities for details.

No permit is to be issued nor inspection to be scheduled without prior fee collection at the office unless an emergency situation exists. The contractor is to notify office of the emergency situation as soon as possible.