

~~8/12/83~~ ~~9/11/83~~  
final  
9/17/83  
bunch map

APPROVED  
9/13/83 RJ  
P 3295 Y

# PERMIT

SEWAGE DISPOSAL SYSTEM

MARYLAND STATE DEPARTMENT OF HEALTH

A 26245

HOWARD COUNTY

BUREAU OF ENVIRONMENTAL HEALTH

992-2330

ELLICOTT CITY

DISTRICT 4th

**INDEX**

DATE July 14, 1983

Olen Ketterman IS PERMITTED TO INSTALL  ALTER

ADDRESS 14960 Frederick Road, Woodbine, MD 21797 PHONE 442-1336

SUBDIVISION Upper Trail ROAD 16374 Old Frederick Rd. LOT 23

PROPERTY OWNER Michael D. Luke

ADDRESS 1859 Eagle Ct., Severn, MD 21164 Phone: 1-672-3657

IF GARBAGE GRINDER IS USED INCREASE SEPTIC TANK CAPACITY BY 50% AND ABSORPTION AREA BY 22%.

GARBAGE GRINDER? YES  NO

SEPTIC TANK CAPACITY 2000 GALLONS NUMBER OF BEDROOMS 4

Shallow trench system to have 193 sq. ft. absorbant bottom area per bedroom. Trench inlets to be at 3 ft. below original grade. Max. depth permitted for trench(es) is 5 ft. below original grade. Distribution box to be used to connect trenches via cast iron pipe to septic tank. Place the first trench on level ground, the center of this trench should pass through perc. hole #2 which is about 200 ft. from the 691.29 ft. long lot line and 100 ft. from the 702.61 ft. long lot line. No trench may exceed 100 ft. in length. Trenches should be 3 ft. wide and contain at least 1 1/2 ft. of gravel, or use 8 ft. wide 100 ft. long trench(es). *Olen stated trench is 5 ft. deep, 10 ft. wide and 80 ft. long.*

PLANS APPROVED BY Frank Skinner DATE 12/13/78

- COVER NO WORK UNTIL INSPECTED AND APPROVED.
- NEITHER THE HOWARD COUNTY COUNCIL NOR THE HEALTH DEPARTMENT IS RESPONSIBLE FOR THE SUCCESSFUL OPERATION OF ANY SYSTEM.
- NOTE: IF TRENCH IS USED CALL FOR INSPECTION BEFORE AND AFTER PLACING GRAVEL IN TRENCH.
- NOTE: NO DRY WELL SHALL EXCEED 15 FOOT IN DIAMETER. NO ABSORPTION TRENCH TO EXCEED 100 FEET IN LENGTH.
- NOTE: ALL PIPE FROM HOUSE TO SEPTIC TANK MUST BE CAST IRON OR SCHEDULE 40 PVC OR ABS.
- PERMIT VOID AFTER THREE YEARS.
- NOTE: INSTALL STAND PIPE ON SEPTIC TANK AND DRY WELL. STAND PIPES MUST BE 6 INCHES IN DIAMETER. CAST IRON, CONCRETE, OR TERRA COTTA, OR PVC OR ABS ACCEPTED. IF TOP OF SEPTIC TANK IS DEEPER THAN 3 FEET MANHOLE TO GRADE REQUIRED.

ADD. PERMIT SIGNATURE  
AND RETURNED 9-24-99  
Serial # 510/20357  
*detached garage*

**\*INSTALLER IS RESPONSIBLE FOR OBTAINING FINAL APPROVAL ON THIS PERMIT**

\*CALL 992-2330 FOR INSPECTION OF SEPTIC SYSTEMS.

96245

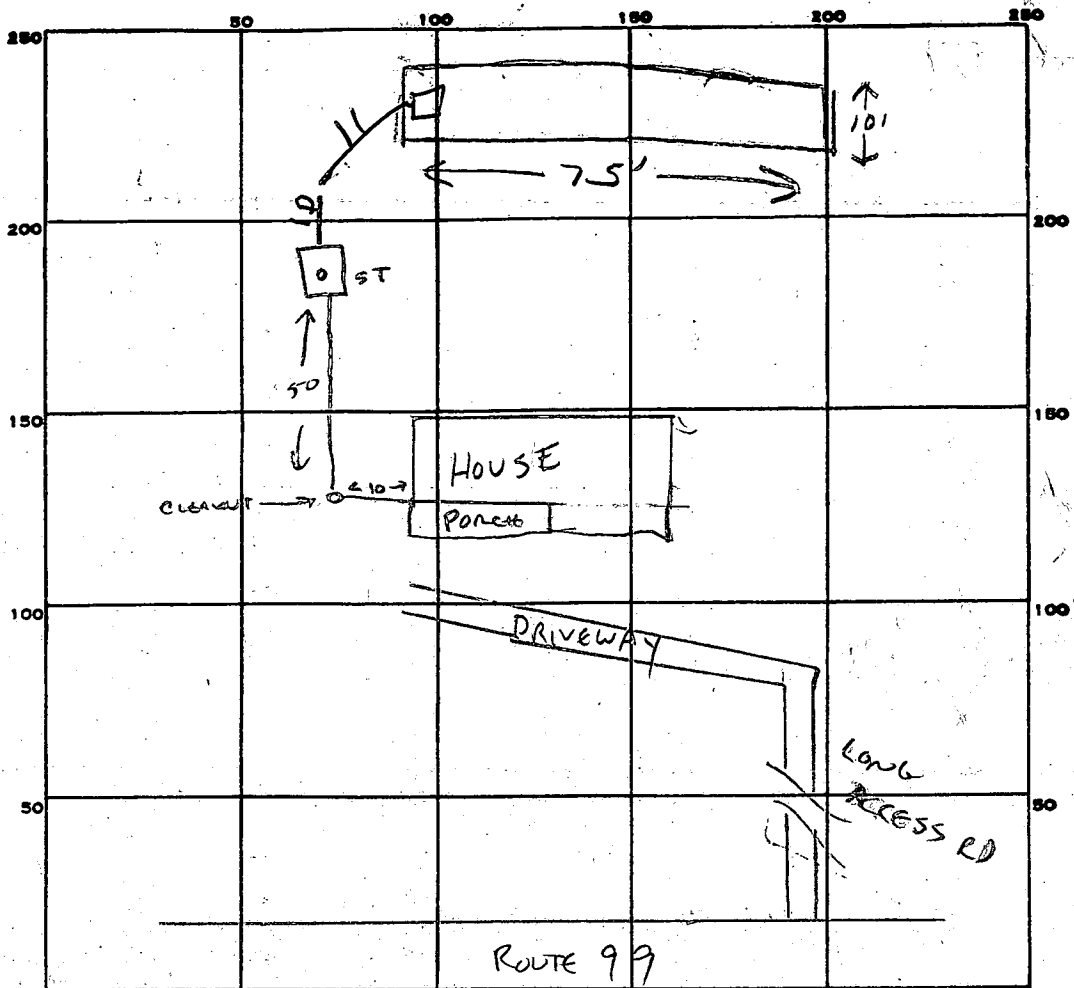

INDICATE NORTH. - NAME ADJOINING ROADWAY AS BASE LINE.

PERMIT CARD NO

SEPTIC TANK, LEVEL 2000 g CLEANOUTS ST IN LINE

DISTRIBUTION BOX, LEVEL 01'

TILE FIELD, DEPTH 5 FT. TRENCH WIDTH 10 FT.

GRAVEL DEPTH 1 1/2 FT IN. TOTAL LENGTH 75 FT.

NUMBER OF TRENCHES 1 TOTAL BOTTOM AREA \_\_\_\_\_

SEEPAGE PITS, INSIDE DIAMETER \_\_\_\_\_ FT. DEPTH BELOW INLET \_\_\_\_\_ FT.

ABSORBENT AREA \_\_\_\_\_ SQ. FT.

REMARKS SYSTEM OK TO SEPTIC TANK 8-18-83 CWILLIAMS  
9/1/83 OK to add stone in trench of  
9/13/83 LEACHING BED OK

DATE SYSTEM APPROVED 9/13/83 INSPECTOR Raymond Hodges