

12/7/84
H: 10:00 AM final
1-2-84

approved
1-2-85
SMB

PERMIT

SEWAGE DISPOSAL SYSTEM

MARYLAND STATE DEPARTMENT OF HEALTH*

P. 34506
A REPAIR
STREET MAP 7

04-335066

INDEXED

ELLICOTT CITY

DISTRICT _____

DATE 10/23/84

12/6/84
Trench
final - pm

HOWARD COUNTY
BUREAU OF ENVIRONMENTAL HEALTH
992-2330

Arnold Septic Tank Service IS PERMITTED TO INSTALL _____ ALTER X

ADDRESS Jacobs Road, Mt. Airy, Maryland PHONE 795-7873

SUBDIVISION _____ ROAD 2460 Mullinix Mill LOT _____

PROPERTY OWNER Gordan Stewart Vittorio + Maria Nicastri
2460 Mullinix Mill Road

ADDRESS Mt. Airy, Maryland 21771

IF GARBAGE GRINDER IS USED INCREASE SEPTIC TANK CAPACITY BY 50% AND ABSORPTION AREA BY 22%.

GARBAGE GRINDER? YES _____ NO X

SEPTIC TANK CAPACITY _____ GALLONS NUMBER OF BEDROOMS 3

TRENCHES - 200 sq. ft. per bedroom. (3 bedrooms - 600 sq. ft. 200 ft. long - at least 2 trenches.) Trench to be 2 feet wide. Inlet 4 feet below original grade. Bottom maximum depth 7 feet below original grade. Effective area begins at 4 feet below original grade. 3 feet of stone below distribution pipe. LOCATION: Place the trenches between & near perc holes (2) & (3). Perc hole (2) is located 106 feet down from the old tank and 87 feet from the right side of the lot as seen when facing the lot from Mullinix Mill Road. Perc hole (3) is located 78 feet down from the old tank and 21 feet from the right side of the lot as seen when facing the lot from Mullinix Mill Road. Space the trenches at least 10 feet apart. NOTE: No trench to exceed 100 feet in length. If more than one trench used, a distribution box is required. Trenches to be installed on level ground. Call for inspection of trench before and after gravel is installed. Provide 6" - 8" diameter cleanout and cap to grade or above on septic tank.

PLANS APPROVED BY Raymond Hodges DATE 10/22/84

COVER NO WORK UNTIL INSPECTED AND APPROVED.

NEITHER THE HOWARD COUNTY COUNCIL NOR THE HEALTH DEPARTMENT IS RESPONSIBLE FOR THE SUCCESSFUL OPERATION OF ANY SYSTEM.

NOTE: IF TRENCH IS USED CALL FOR INSPECTION BEFORE AND AFTER PLACING GRAVEL IN TRENCH.

NOTE: NO DRY WELL SHALL EXCEED 15 FOOT IN DIAMETER. NO ABSORPTION TRENCH TO EXCEED 100 FEET IN LENGTH.

NOTE: ALL PIPE FROM HOUSE TO SEPTIC TANK MUST BE CAST IRON OR SCHEDULE 40 PVC OR ABS.

PERMIT VOID AFTER THREE YEARS.

NOTE: INSTALL STAND PIPE ON SEPTIC TANK AND DRY WELL. STAND PIPES MUST BE 6 INCHES IN DIAMETER. CAST IRON, CONCRETE OR TERRA COTTA OR PVC OR ABS ACCEPTED. IF TOP OF SEPTIC TANK IS DEEPER THAN 3 FEET MANHOLE TO GRADE REQUIRED.

BLDG. PERMIT SIGNED
AND RETURNED 03/21/94
Serial # 53973
Addition family

*INSTALLER IS RESPONSIBLE FOR OBTAINING FINAL APPROVAL ON THIS PERMIT

*CALL 992-2330 FOR INSPECTION OF SEPTIC SYSTEMS.

EH - 2-1082

X
A 34506
10/23/84

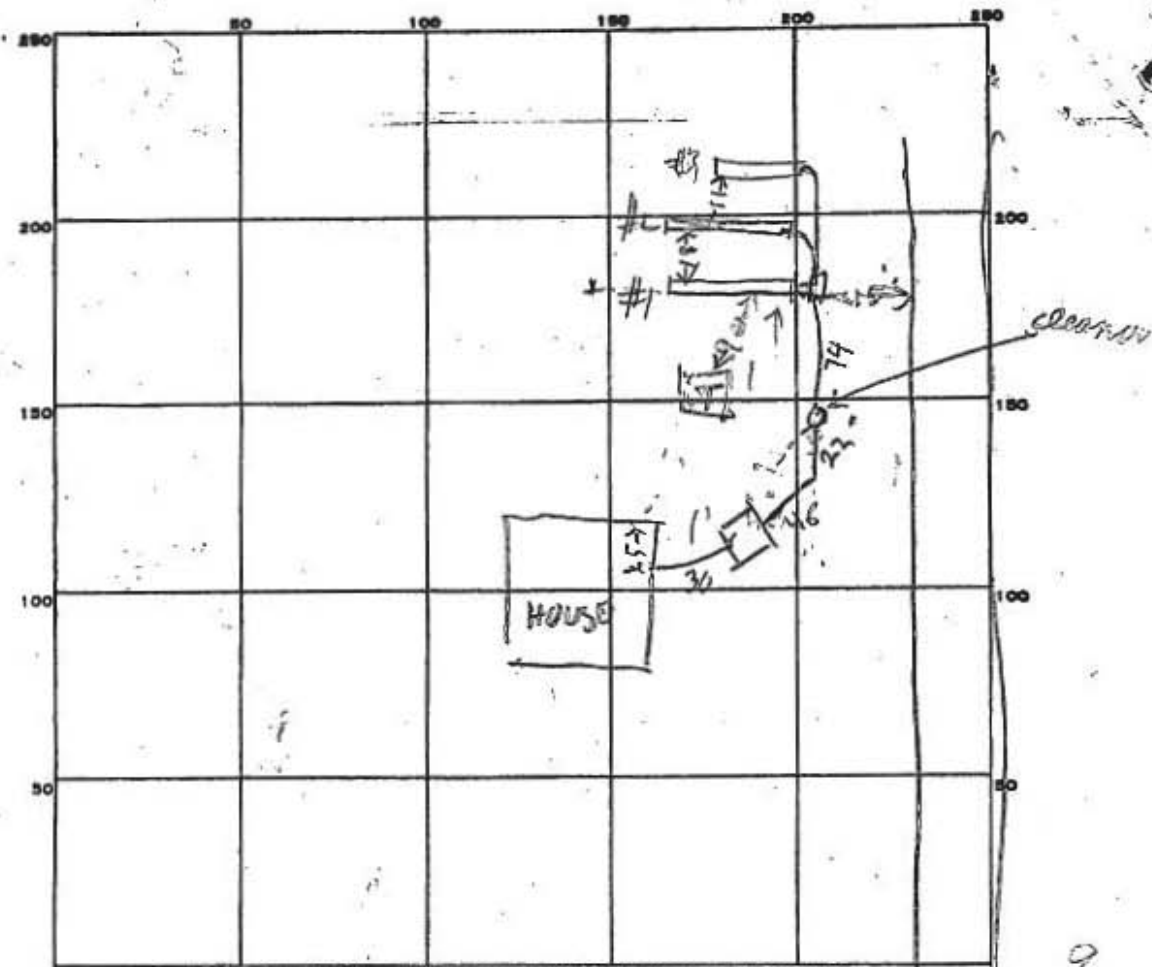

INDICATE NORTH. - NAME ADJOINING ROADWAY AS BASE LINE.

MULLINIX Mill RD

PERMIT CARD

SEPTIC TANK, LEVEL OK 1000 Top 1/2 Fiberglass ST
CLEANOUTS OK

DISTRIBUTION BOX, LEVEL

TILE FIELD, DEPTH 7 7 7 FT. TRENCH WIDTH 2 2 2 FT.

GRAVEL DEPTH 3 3 4 IN. TOTAL LENGTH 10 74 57 FT.

NUMBER OF TRENCHES 3 TOTAL BOTTOM AREA 210 222 115 = 547

SEEPAGE PITS, INSIDE DIAMETER _____ FT. DEPTH BELOW INLET _____ FT.

ABSORBENT AREA _____ SQ. FT.

REMARKS 12/6/84 11:30 AM - LOCATION TRENCHES OK OK TO COVER
TANK & SEWER LINES FINISH ADDING STONE TO TRENCHES & FILL IN OLD TANK R/H
12/6/84 12:02 PM - OK TO COVER TRENCH #3 R/H
12/7/84 - TRENCH #2 & #1 - STONE ADDED OK TO COVER
FILL IN OLD TANK & CALL R/H
1-2-85 old septic tank filled in system complete

DATE SYSTEM APPROVED 1-2-85 INSPECTOR S. Abel