

12/17/84
H. Hodges final
1-2-84
12/16/84
Trench final - pm

Approved
1-2-85
S. Hubel P 34506

PERMIT

SEWAGE DISPOSAL SYSTEM

MARYLAND STATE DEPARTMENT OF HEALTH

A REPAIR
Sheet MAP 7

HOWARD COUNTY
BUREAU OF ENVIRONMENTAL HEALTH
992-2330

04-335066

ELLICOTT CITY

INDEXED

DISTRICT _____

DATE 10/23/84

Arnold Septic Tank Service IS PERMITTED TO INSTALL _____ ALTER X

ADDRESS Jacobs Road, Mt. Airy, Maryland PHONE 795-7873

SUBDIVISION _____ ROAD 2460 Mullinix Mill LOT _____

PROPERTY OWNER Cordan Stewart Vittorio & Maria Nicastri

ADDRESS 2460 Mullinix Mill Road
Mt. Airy, Maryland 21771

IF GARBAGE GRINDER IS USED INCREASE SEPTIC TANK CAPACITY BY 50% AND ABSORPTION AREA BY 22%.

GARBAGE GRINDER? YES _____ NO X

SEPTIC TANK CAPACITY _____ GALLONS NUMBER OF BEDROOMS 3

TRENCHES - 200 sq. ft. per bedroom. (3 bedrooms - 600 sq. ft. 200 ft. long - at least 2 trenches.) Trench to be 2 feet wide. Inlet 4 feet below original grade. Bottom maximum depth 7 feet below original grade. Effective area begins at 4 feet below original grade. 3 feet of stone below distribution pipe. LOCATION: Place the trenches between & near perccholes (2) & (3). Perc hole (2) is located 106 feet down from the old tank and 87 feet from the right side of the lot as seen when facing the lot from Mullinix Mill Road. Perc hole (3) is located 78 feet fown from the old tank and 21 feet from the right side of the lot as seen when facing the lot from Mullinix Mill Road. Space the trenches at least 10 feet apart. NOTE: No trench to exceed 100 feet in length. If more than one trench used, a distribution box is required. Trenches to be installed on level ground. Call for inspection of trench before and after gravel is installed. Provide 6" - 8" diameter cleanout and cap to grade or above on septic tank.

PLANS APPROVED BY Raymond Hodges DATE 10/22/84

COVER NO WORK UNTIL INSPECTED AND APPROVED.

NEITHER THE HOWARD COUNTY COUNCIL NOR THE HEALTH DEPARTMENT IS RESPONSIBLE FOR THE SUCCESSFUL OPERATION OF ANY SYSTEM.

NOTE: IF TRENCH IS USED CALL FOR INSPECTION BEFORE AND AFTER PLACING GRAVEL IN TRENCH.

NOTE: NO DRY WELL SHALL EXCEED 15 FOOT IN DIAMETER. NO ABSORPTION TRENCH TO EXCEED 100 FEET IN LENGTH.

NOTE: ALL PIPE FROM HOUSE TO SEPTIC TANK MUST BE CAST IRON OR SCHEDULE 40 PVC OR ABS.

PERMIT VOID AFTER THREE YEARS.

NOTE: INSTALL STAND PIPE ON SEPTIC TANK AND DRY WELL. STAND PIPES MUST BE 6 INCHES IN DIAMETER. CAST IRON, CONCRETE OR TERRA COTTA, OR PVC OR ABS ACCEPTED. IF TOP OF SEPTIC TANK IS DEEPER THAN 3 FEET MANHOLE TO GRADE REQUIRED.

BLDG. PERMIT SIGNED
AND RETURNED 03/21/94
Sheet # 52813
Additional family
11/77

X
A 34506

*INSTALLER IS RESPONSIBLE FOR OBTAINING FINAL APROVAL ON THIS PERMIT

*CALL 992-2330 FOR INSPECTION OF SEPTIC SYSTEMS.

EH - 2-1082

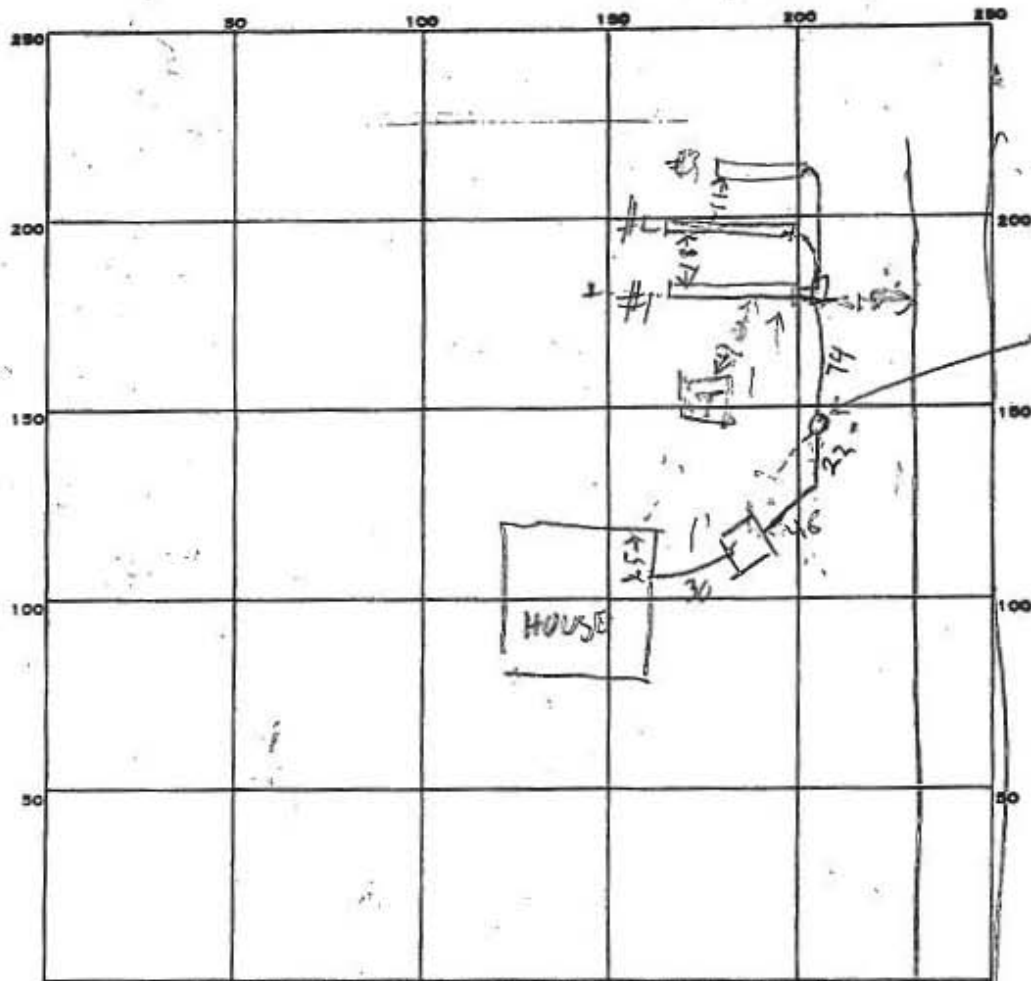

INDICATE NORTH. - NAME ADJOINING ROADWAY AS BASE LINE.

MULLINIX RD

PERMIT CARD

SEPTIC TANK, LEVEL OK 1000 Top 1/2 Fiberglass CLEANOUTS ST OK

DISTRIBUTION BOX, LEVEL

TILE FIELD, DEPTH 7 FT. TRENCH WIDTH 2 FT.

GRAVEL DEPTH 3 IN. TOTAL LENGTH 70 FT.

NUMBER OF TRENCHES 3 TOTAL BOTTOM AREA 210 222 115 = 547

SEEPAGE PITS, INSIDE DIAMETER _____ FT. DEPTH BELOW INLET _____ FT.

ABSORBENT AREA _____ SQ. FT.

REMARKS 12/6/84 11:30 AM - LOCATION TRENCHES OK OK TO COVER

TANK & SEWER LINES FINISH ADDING STONE TO TRENCHES & FILL IN OLD TANK RH

12/6/84 12:02 PM - OK TO COVER TRENCH #3 RH

12/7/84 - TRENCH #2 & #1 - STONE ADDED OK TO COVER

FILL IN OLD TANK & CALL RH

1-2-85 old septic tank filled in system complete

DATE SYSTEM APPROVED 1-2-85 INSPECTOR S. Abel

A REPAIR

SUBDIVISION:

LOT NUMBER:

DRY WELL OR DRY WELL AND TRENCH

sq. ft./bedroom

	<u>Septic Tank</u>	<u>Minimum Total square Feet</u>
3 bedroom	1000 gallon	_____
4 bedroom	1250 gallon	_____
5 bedroom	1500 gallon	_____

Inlet _____ feet below original grade.

Bottom maximum depth _____ feet below original grade.

Effective area begins at _____ feet below original grade.

NOTE: If trench is used to make up absorbent area, run the trench on level ground and leave a 5 foot earth buffer between dry well and trench. No trench is to exceed 100 feet in length. Trench inlet to be same as dry well, with _____ feet of stone below distribution pipe.

TRENCHES

200 sq. ft./bedroom

Trench to be 2 wide.

Inlet 4 feet below original grade.

Bottom maximum depth 7 feet below original grade.

Effective area begins at 4 feet below original grade.

3 feet of stone below distribution pipe.

3 BED ROOMS - 6005 SQ FT
200 FT LONG
AT LEAST 2 TRENCH

- NOTE:
- (1) No trench to exceed 100 feet in length.
 - (2) If more than one trench used, a distribution box is required.
 - (3) Trenches to be installed on level ground.
 - (4) Call for inspection of trench before gravel is installed.
 - (5) Provide 6"-8" diameter cleanout and cap to grade or above on septic tank and drywell.
 - (6) If a Garbage disposal is used, increase septic tank capacity by 50% and increase absorbant sidewall area by 22%.

LOCATION: 10/22/84 - PLACE THE TRENCHES BETWEEN &

NEAR PERC HOLES (2) & (3) PERC HOLE (2) IS LOCATED 106 FT DOWN FROM THE OLD TANK & 87 FT FROM THE RIGHT SIDE OF THE LOT AS SEEN WHEN FACING THE LOT FROM MULLINIX MILL RD PERC HOLE (3) IS LOCATED 78 FT DOWN FROM THE OLD TANK & 21 FT FROM THE RIGHT SIDE OF THE LOT AS SEEN WHEN FACING THE LOT FROM MULLINIX MILL RD SPACE THE TRENCHES AT LEAST 10 FT. APART.