

11/17/83
2:10 PM
12/20/83

05-392861

12/20/83 App'd F.S.

PERMIT

SEWAGE DISPOSAL SYSTEM

MARYLAND STATE DEPARTMENT OF HEALTH

P 32688

A 31720

HOWARD COUNTY
BUREAU OF ENVIRONMENTAL HEALTH
992-2330

INDEX

ELLICOTT CITY
DISTRICT 5th

DATE 4/25/83

Oskar Schulz, Inc. IS PERMITTED TO INSTALL ALTER

ADDRESS 6610 Blackwatch Lane, Highland, Md. 20777 PHONE 531-2000

SUBDIVISION Dunfreeten Estates ROAD 13742 Pasture Green LOT 7

PROPERTY OWNER Edward B. Knipling

ADDRESS 6555 Mink Hollow Road, Highland, Md. 20777 Phone: 854-0359

IF GARBAGE GRINDER IS USED INCREASE SEPTIC TANK CAPACITY BY 50% AND ABSORPTION AREA BY 22%.

GARBAGE GRINDER? YES NO

SEPTIC TANK CAPACITY 1250 GALLONS NUMBER OF BEDROOMS 4

DRY WELL OR DRY WELL AND TRENCH - 125 sq. ft. per bedroom. Minimum total square feet for 4 bedrooms is 500 sq. ft. Inlet at 4 ft. below original grade and bottom maximum depth 10 feet below original grade. Effective area begins at 4 feet below original grade. If trench is used to make up absorbent area, run the trench on level ground and leave a 5 ft. earth buffer between dry well and trench. No trench to exceed 100 feet in length. Trench inlet to be same as dry well, with 6 feet of stone below distribution pipe.

TRENCHES - 158 sq. ft. per bedroom. Trench to be 2 ft. wide. Inlet 4 ft. below original grade. Bottom maximum depth 10 ft. below original grade. Effective area begins at 4 ft. below original grade. 6 feet of stone below distribution pipe. NOTE: If more than one trench used, a distribution box is required. Call for inspection of trench before gravel is installed. Provide 6-8" diameter clean-out and cap to grade or above on septic tank and dry well. Place dry well at perc hole #1 or start the ditch at perc hole #1. Perc hole #1 is located 280 ft. from the back lot line and 50 ft. from the right side line, as seen when facing lot from the 178.34 ft.

PLANS APPROVED BY Raymond Hodges & Frank A. Skinner DATE 5/3/83

COVER NO WORK UNTIL INSPECTED AND APPROVED. lot line and run the ditch toward the left side of the lot (178.34 ft. lot line). The back lot line is 367.42 ft. long.

NEITHER THE HOWARD COUNTY COUNCIL NOR THE HEALTH DEPARTMENT IS RESPONSIBLE FOR THE SUCCESSFUL OPERATION OF ANY SYSTEM.

NOTE: IF TRENCH IS USED CALL FOR INSPECTION BEFORE AND AFTER PLACING GRAVEL IN TRENCH.

NOTE: NO DRY WELL SHALL EXCEED 15 FOOT IN DIAMETER. NO ABSORPTION TRENCH TO EXCEED 100 FEET IN LENGTH.

NOTE: ALL PIPE FROM HOUSE TO SEPTIC TANK MUST BE CAST IRON OR SCHEDULE 40 PVC OR ABS.

PERMIT VOID AFTER THREE YEARS.

NOTE: INSTALL STAND PIPE ON SEPTIC TANK AND DRY WELL. STAND PIPES MUST BE 6 INCHES IN DIAMETER. CAST IRON, CONCRETE OR TERRA COTTA, OR PVC OR ABS ACCEPTED. IF TOP OF SEPTIC TANK IS DEEPER THAN 3 FEET MANHOLE TO GRADE REQUIRED.

***INSTALLER IS RESPONSIBLE FOR OBTAINING FINAL APPROVAL ON THIS PERMIT**

*CALL 992-2330 FOR INSPECTION OF SEPTIC SYSTEMS.

EH - 2-1082

A 31720

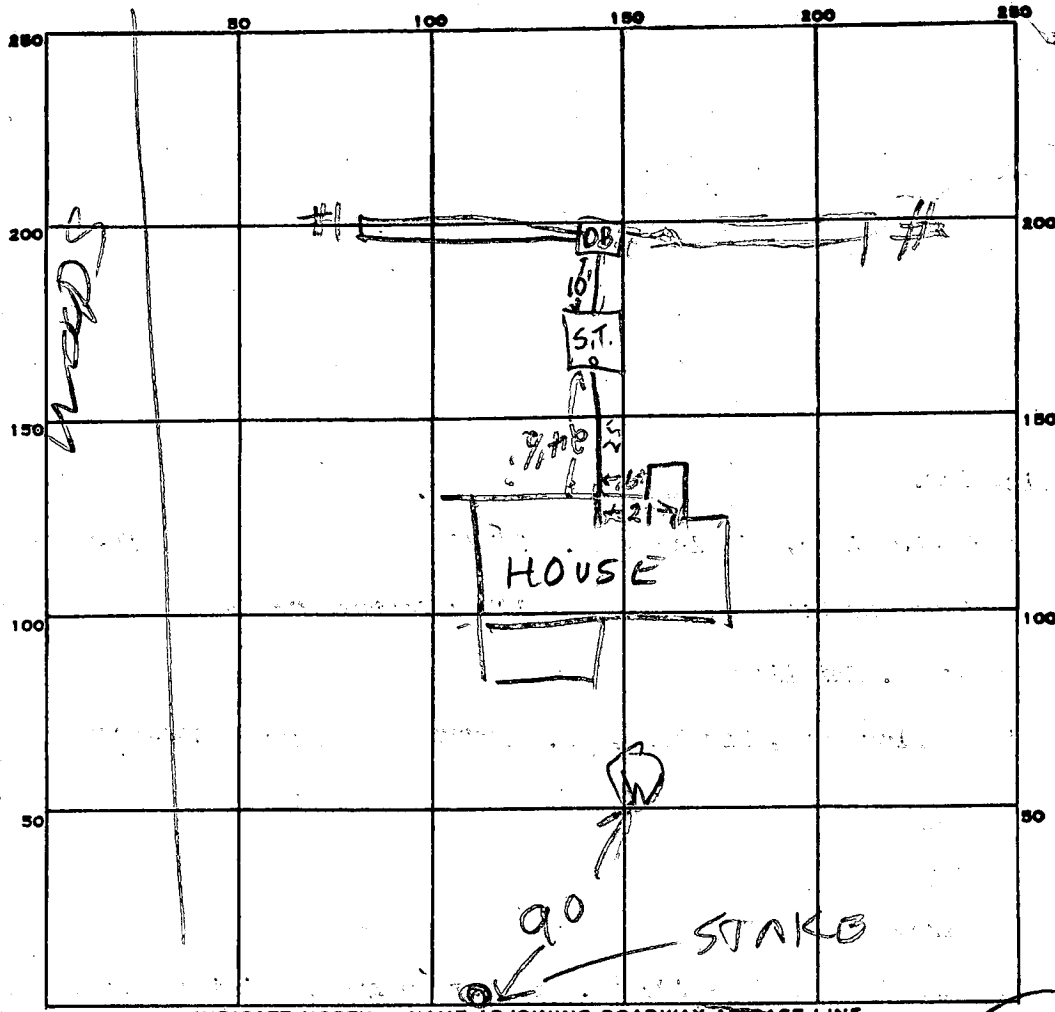

INDICATE NORTH - NAME ADJOINING ROADWAY AS BASE LINE.

PERMIT CARD no

SEPTIC TANK, LEVEL OK 1500

CLEANOUTS OK

DISTRIBUTION BOX, LEVEL OK

TILE FIELD, DEPTH

#1	#2
9.5	2

 FT. TRENCH WIDTH

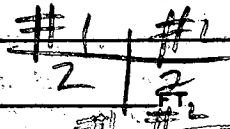

GRAVEL DEPTH FT. TOTAL LENGTH 32 | 66 FT.

NUMBER OF TRENCHES 2

ONE SIDEWALL TOTAL BOTTOM AREA ±605

62
5.5
310
311.0
264
605.0

66
4
264

SEEPAGE PITS, INSIDE DIAMETER FT. DEPTH BELOW INLET 4±5 1/2 FT.

ABSORBENT AREA ±605 SQ. FT. LOCATION OK

REMARKS GROUND CUT 10R 2FT IN VICINITY OF DISTRIBUTION BOX & TRENCH 2. OK TO ADD STONE & PIPE, FINISH JOB & CALL RH 12/20/83 System now complete, OK to cover all work. F.S.

DATE SYSTEM APPROVED 12/20/83 INSPECTOR Frank Skinner

SUBDIVISION: DUNFRETTE ESTATES LOT NUMBER: 7

DRY WELL OR DRY WELL AND TRENCH

125 sq. ft./bedroom

	<u>Septic Tank</u>	<u>Minimum Total square Feet</u>
3 bedroom	1000 gallon	
→ 4 bedroom	1250 gallon	<u>500 sqft</u>
5 bedroom	1500 gallon	

Inlet 4 feet below original grade.
 Bottom maximum depth 10 feet below original grade.
 Effective area begins at 4 feet below original grade.

NOTE: If trench is used to make up absorbent area, run the trench on level ground and leave a 5 foot earth buffer between dry well and trench. No trench is to exceed 100 feet in length. Trench inlet to be same as dry well, with 6 feet of stone below distribution pipe.

OR
TRENCHES

158 sq. ft./bedroom

Trench to be 2 wide.
 Inlet 4 feet below original grade.
 Bottom maximum depth 10 feet below original grade.
 Effective area begins at 4 feet below original grade.
6 feet of stone below distribution pipe.

- NOTE:
- (1) No trench to exceed 100 feet in length.
 - (2) If more than one trench used, a distribution box is required.
 - (3) Trenches to be installed on level ground.
 - (4) Call for inspection of trench before gravel is installed.
 - (5) Provide 6"-8" diameter cleanout and cap to grade or above on septic tank and drywell.
 - (6) If a Garbage disposal is used, increase septic tank capacity by 50% and increase absorbant sidewall area by 22%.

LOCATION: PLACE DRY WELL AT PERC HOLE #1 OR START THE DITCH AT PERC HOLE #1. PERC HOLE #1 IS LOCATED 80 FT FROM THE BACK LOT LINE & 50 FT FROM THE RIGHT SIDE OF THE LOT AS SEEN WHEN FACING THE LOT FROM THE 178.34' LONG LOT LINE & RUN THE DITCH TOWARD THE LEFT SIDE OF THE LOT AS SEEN WHEN FACING THE LOT FROM THE 178.34' LONG LOT LINE. THE BACK LOT LINE IS THE 367.42 FT LONG LOT LINE ON THE WESTERN PART OF THE LOT
 5/31/03 BH