

Oswald, Hank

From: Oswald, Hank
Sent: Thursday, June 04, 2015 10:41 AM
To: 'Robertbaxter27@aol.com'
Subject: RE: LIANG Feasibility Plan 16035 Carr's Mill Road
Attachments: GIS_16035 Carrs Mill Road.pdf

Hi Bob:

A couple of additional comments regarding the revised plan.

- Showing the existing tile field won't be an issue.
- The Do Not Test Co soil unit boundary is not at the flood plain line. The Co soil line retains right around the 495 contour and up to the 500 contour line on the north property boundary (See attached GIS image). Please show this line and then stay 25' off of that. In addition, show the soil unit boundaries as they are represented on the official USDA soil survey.
- The SDA must also be 25' from the steep slopes on the lower side as well as the upper side.
- The well area on lot 1 is down gradient of the septic area, but far less than 200' away.

Should you have any questions, please don't hesitate to ask.

Thanks

Hank

From: Robertbaxter27@aol.com [mailto:Robertbaxter27@aol.com]
Sent: Wednesday, June 03, 2015 2:06 PM
To: Oswald, Hank
Cc: lianguizhi@yahoo.com
Subject: Re: LIANG Feasibility Plan 16035 Carr's Mill Road

Hank,

We have no records as to where an existing tile field would be located and you've verified you have no records. The plan would be to provide a new septic system for the existing house.

Thanks!

Bob Baxter
Diversified Permits, Inc.
(410)227-0373

In a message dated 6/3/2015 8:09:45 A.M. Eastern Daylight Time, hoswald@howardcountymd.gov writes:

Hi Bob:

Assuming the setbacks have been met and the scale is correct, it looks to be okay. Please show the existing drain field on Lot #1?

Thanks,

Hank

From: Robertbaxter27@aol.com [mailto:Robertbaxter27@aol.com]

Sent: Tuesday, June 02, 2015 2:56 PM

To: Oswald, Hank

Cc: liangguizhi@yahoo.com

Subject: Fwd: LIANG Feasibility Plan 16035 Carr's Mill Road

Hank,

Per our conversation yesterday, attached is an updated Percolation Test Plan pdf per your comments dated April 27th, 2015.

Once you find it to be acceptable, we will have our engineer sign, seal the plans and get the owner to resubmit back to your office.

Also, we plan to revise the stake out per the latest plan. We placed the 1,500 sq. ft. Well Boxes within the Floodplain limits per our conversation as well.

Thanks!

Bob Baxter

Diversified Permits Inc.

(410)227-0373

From: coryjevans@verizon.net

To: robertbaxter27@aol.com

Sent: 6/2/2015 4:06:57 A.M. Eastern Daylight Time

Subj: LIANG Feasibility Plan PDF

7/30/91

FULLER RESIDENCE
16035 CARRS MILL ROAD

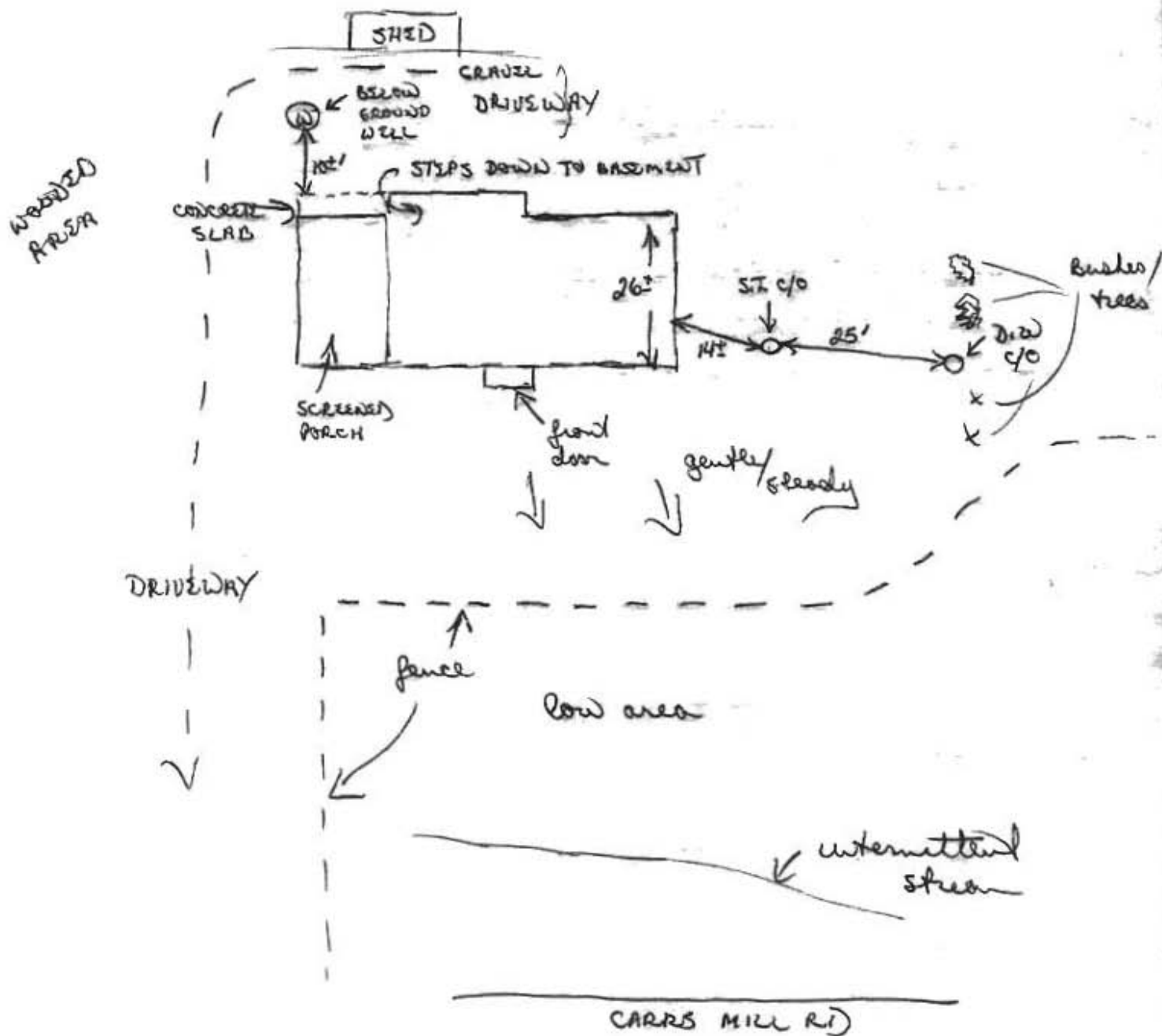



DEPARTMENT OF PUBLIC WORKS

Charles I. Ecker, County Executive

August 26, 1991

The Fuller Family
16035 Carrs Mill Road
Woodbine, MD 21797

Dear The Fuller Family:

On July 30th and July 31st, Evelyn Tomlin of my staff and Bert Nixon of the Environmental Health Department sampled the well water for volatile organic chemicals in several homes on Carrs Mill Road. The laboratory did **not** detected any volatile organic chemicals (VOCs) in any residential well. Your water is within the drinking water standards for VOCs.

Thank you for your assistance.

Very truly yours,

John J. O'Hara, Chief
Bureau of Environmental Services

cc: Bert Nixon
Evelyn Tomlin
\\p\e\carrs\correspo\res

STATE OF MARYLAND

DEPARTMENT OF HEALTH AND MENTAL HYGIENE

Laboratories Administration

201 W. Preston Street

P.O. Box 2355, Baltimore, Maryland 21203

J. Mehsen Joseph, Ph.D., Director

LAB NO. 91-1313

SEND REPORT TO:

BERT NIXON

HEALTH DEPT (HOWARD)

3525-H ELKOTT MILLS DR

ELKOTT CITY

GAS CHROMATOGRAPHY-MASS SPECTROMETRY LABORATORY
SDWA ANALYSIS REPORT FORM

FULLER

KITCHEN SINK

16035 CARRS MILL RD

WOODBINE, MD 21797

COLLECTOR: B. NIXON / 9:45 / 7/30/91

SAMPLE SOURCE: _____

BOTTLE NUMBER: H-FULLER-3

PRESERVATION USED: 1+1 HCL

PWSID #: _____

SYSTEM NAME: _____

CHAIN OF CUSTODY: FROM: B. NIXON 9:45 7/30/91 TO: BOB BAYES 13:00 7/30/91

FROM: BOB BAYES 13:00 7/30/91 TO: K. Jones 13:00 7/30/91

FROM: _____ TO: _____

REMARKS: PLEASE RUN FULL SCAN PAPER / CSAND FILTER ONLY

CONTAMINANT	EPACONT ID	MCL	ACTUAL LEVEL (ppb)	CONTAMINANT	EPACONT ID	ACTUAL LEVEL (ppb)
TRIHALOMETHANES						
Chloroform	2941		<1	Dibromomethane	2408	<1
Bromodichloromethane	2943			p-Xylene	2962	
Dibromochloromethane	2944			o-Xylene	2967	
Bromoform	2942		✓	m-Xylene	2966	
TOTAL THMs	2950	100		1,1-Dichloropropene	2410	<1
REGULATED				trans-1,3-Dichloropropene	2224	
Benzene	2990	5	<1	cis-1,3-Dichloropropene	2413	
Carbon Tetrachloride	2982	5		1,1,2,2-Tetrachloroethane	2988	
p-Dichlorobenzene	2969	75		1,3-Dichloropropane	2412	
1,1-Dichloroethene	2977	7		2,2-Dichloropropane	2416	
1,2-Dichloroethane	2980	5		o-Chlorotoluene	2965	
1,1,1-Trichloroethane	2981	200		p-Chlorotoluene	2968	
Trichloroethene	2984	5		Bromobenzene	2903	
Vinyl Chloride	2976	2		1,2,4-Trimethylbenzene	2418	
UNREGULATED				1,2,4-Trichlorobenzene	2378	
*trans-1,2-Dichloroethene	2979	100		1,2,3-Trichlorobenzene	2420	
*cis-1,2-Dichloroethene	2380	70		n-Propylbenzene	2998	
*1,2-Dichlorobenzene	2968	600		n-Butylbenzene	2422	
*1,2-Dichloropropane	2983	5		Naphthalene	2248	
*Tetrachloroethene	2987	5		Hexachlorobutadiene	2248	
*Chlorobenzene	2989	100		Isopropylbenzene	2994	
*Toluene	2991	1000		1,2,3-Trichloropropane	2414	
*Ethylbenzene	2992	700		1,2-Dibromo-3-Chloropropane	2931	
*Total Xylenes	2955	10000	<2	1,3,5-Trimethylbenzene	2424	
*Styrene	2996	100	<1	p-Isopropyltoluene	2030	
Chloromethane	2210		<5	tert-Butylbenzene	2426	
Bromomethane	2214		<1	sec-Butylbenzene	2428	
Dichlorodifluoromethane	2212			Bromochloromethane	2430	
Chloroethane	2216			Dichloromethane	2964	
Trichlorofluoromethane	2218			1,1,2-Trichloroethane	2985	
1,1-Dichloroethane	2978			1,1,1,2-Tetrachloroethane	2986	
m-Dichlorobenzene	2967					
Methylene Chloride	2964					

* PROPOSED MCLs

DATE RECEIVED: AUG 30 1991

DATE ANALYZED: 7/30/91

CHEMIST: [Signature]

ppb — parts per billion (micrograms per liter)
MCL — maximum contaminant level
ND — not detected
NA — not analyzed

DHMH 4362 2/90

SUBMITTER'S COPY



Interactive Map



Oswald, Hank

From: Oswald, Hank
Sent: Monday, April 27, 2015 11:19 AM
To: 'Liangguizhi@yahoo.com'
Subject: Perc Plan Review Comments_16035 Carrs Mill road

Mr. Liang:

This email is in response to the Preliminary Percolation Plan submitted for 16035 Carrs Mill Road. Upon review of the plan, a few issues were observed and need to be addressed on the plan. They are as follows:

1. The proposed septic easements are partially located within the Codurus soil line. The Co are "DO Not Test" soils. Both septic areas need to be 25 feet away from this soil.
2. Show septic drain field on Lot#1.
3. Show existing well with a 100 foot radius around it. Also show two potential replacement well sites on Lot #1.
4. Correct scale on plan. It appears to be 100 not 40.
5. The well box on Lot # 2 is only 70 feet away from septic easement. It needs to be 100 feet.
6. The driveway on Lot # 1 cannot go over easement.
7. The preparer must sign plan.

Please make the necessary corrections to the plan and resubmit for review. Should you have any questions, please don't hesitate to ask.

Respectfully,

Hank

Hank Oswald, L.E.H.S.
Howard County Health Department
Bureau of Environmental Health
Well & Septic Program
410.313.1786



Interactive Map

Map Layers

All Layers

Base Maps & Aerial Photos

- Howard County Base Map
- Aerial Photo 2014
- Aerial Photo 2013
- Aerial Photo 2011
- Aerial Photo 2007
- Aerial Photo 2006
- Aerial Photo 2004
- Aerial Photo 2002
- Aerial Photo 1999
- Aerial Photo 1993
- Aerial Photo 1988
- Aerial Photo 1985
- Aerial Photo 1984
- Aerial Photo 1962
- Aerial Photo 1950
- Aerial Photo 1977
- Aerial Photo 1971
- Aerial Photo 1970
- Aerial Photo 1963
- Aerial Photo 1962
- Aerial Photo 1943
- Google Satellite
- OpenStreetMap
- Blank

Annotation Layers

HUC8 Base Map Layers

- Contours 2004
- County Boundary
- Stream Centerline Buffer 75ft
- Building Permits (New)
- Scanned PDF Drawings Inter
- Address Points

