

Bureau of Environmental Health

8930 Stanford Boulevard, Columbia, MD 21045
Main: 410-313-2640 | Fax: 410-313-2648
TDD: 410-313-2323 | Toll Free 1-866-313-6300
www.hchealth.org
Facebook: www.facebook.com/hocohealth

Maura J. Rossman, M.D., Health Officer

RECEIPT DATE: 4/25/18 ONSITE SEWAGE DISPOSAL SYSTEM P 562972
APPROVAL DATE: 5/15/18 SEC PERMIT: REPAIR A
PROPERTY ADDRESS: 1605 Old Annapolis Road
SUBDIVISION: LOT: TAX ID: 04-315839
CONTRACTOR: Marc D. Hereth EMAIL: marcdherethconstruction@gmail.com
CONTRACTOR ADDRESS: 2551 Florence Road, Woodbine, MD 21797 PHONE: 301-580-5977
PROPERTY OWNER: Clyde Frank Gibson II EMAIL:
OWNER ADDRESS: 1605 Old Annapolis Road, Woodbine, MD 21797 PHONE: 443-340-5596

SEPTIC TANK SIZE (GALLONS): PUMP CHAMBER CAPACITY (GALLONS): PUMP SIZE:
NUMBER OF BEDROOMS: 3 HOUSE SQ. FT. APPLICATION RATE: 0.8
DISTRIBUTION SYSTEM: GRAVITY FED [checked] LOW PRESSURE DOSED [ ]

Table with 2 columns: TRENCHES, LOCATION. Rows include: LINEAR FEET REQUIRED: 95', INLET DEPTH: 4', TRENCH WIDTH: 3', MAXIMUM BOTTOM DEPTH: 8', MINIMUM SPACE BETWEEN TRENCHES: -, EFFECTIVE AREA BEGINNING DEPTH: 5'.

LOCATION: TO BE STAKED BY SANITARIAN DURING PRE-CONSTRUCTION INSPECTION.

NOTES: Install 1 x 95' trench on contour. Existing drywell must be pumped + filled in with clean dirt or stone.

ISSUED BY: Sarah Collins ISSUE DATE: 5/9/18 EXPIRATION DATE: 5/9/19

- NOTE: CONTRACTOR MUST SCHEDULE A PRE-CONSTRUCTION INSPECTION PRIOR TO BEGINNING ANY INSTALLATION
NOTE: CONTRACTOR MUST SCHEDULE AN INSPECTION AND GAIN APPROVAL OF ALL COMPONENTS PRIOR TO COVERING
NOTE: STONE MUST BE APPROVED BY HEALTH DEPARTMENT AND GRAVEL TICKET MUST BE AVAILABLE FOR REVIEW.
NOTE: WATERTIGHT SEPTIC TANKS REQUIRED
NOTE: ALL PARTS OF SEPTIC SYSTEM SHALL BE AT LEAST 100 FEET DOWNGRADIENT FROM ANY WATER WELL
NOTE: MANHOLE RISERS REQUIRED ON ALL SEPTIC TANKS AND PUMP CHAMBERS
NOTE: AN ELECTRICAL PERMIT IS REQUIRED FOR INSTALLATION OF ANY ELECTRICAL COMPONENTS OF THE SYSTEM
NOTE: THE HCHD DOES NOT WARRANTY ANY SYSTEM AND CANNOT GUARANTEE THE PERFORMANCE OF THIS SYSTEM AS DESIGNED.
NOTE: MDE RECOMMENDS SEPTIC TANKS, BAT, AND OTHER PRETREATMENT UNITS BE PUMPED AT A FREQUENCY ADEQUATE TO ENSURE THAT SOLIDS ARE NOT DISCHARGED TO THE DISPOSAL AREA

NEITHER THE HOWARD COUNTY COUNCIL NOR THE HEALTH DEPARTMENT IS RESPONSIBLE FOR THE SUCCESSFUL OPERATION OF ANY SYSTEM.
PERMITTEE RESPONSIBLE FOR OBTAINING FINAL APPROVAL ON THIS PERMIT.
CALL 410-313-1771 TO SCHEDULE INSPECTIONS.

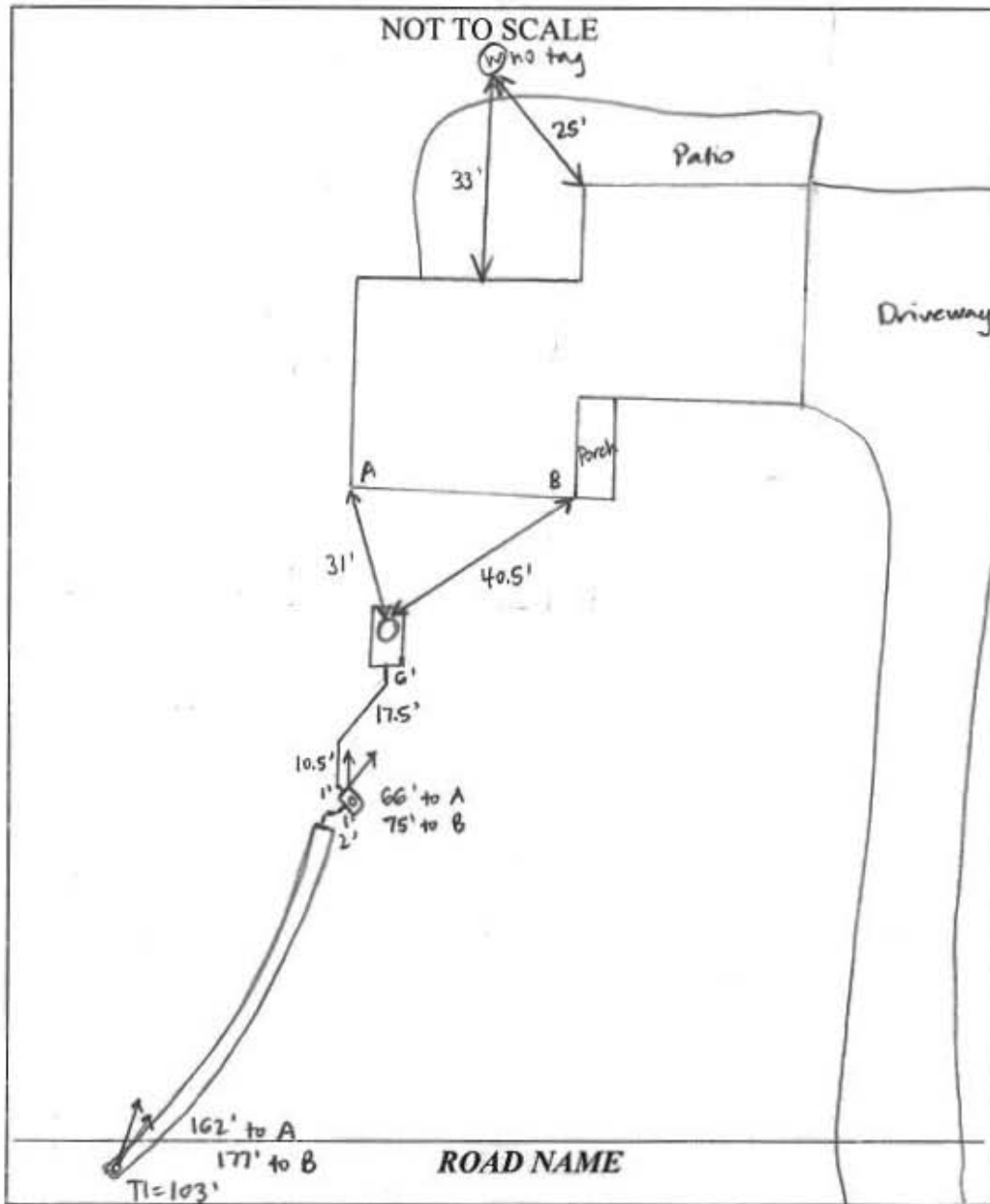

TRENCH/DRAINFIELD DATA		
WIDTH	INLET	BOTTOM
3'	4'	8'
NUMBER OF TRENCHES	1	
TOTAL LENGTH	103'	
ABSORPTION AREA	309' + SIDEWALL	
DISTRIBUTION BOX LEVEL	YES	
DISTRIBUTION BOX BAFFLE	YES	
DISTRIBUTION BOX PORT	YES	

SEPTIC TANK DATA	
SEPTIC TANK I LEVEL	(existing)
MANUFACTURER	(existing)
CAPACITY	1000? GAL
SEAM LOC	MID
TANK LID DEPTH	
BAFFLES	YES
BAFFLE FILTER	NO
MANHOLE LOC	MIDDLE
6" PORT LOC	NONE
WATERTIGHT TEST	NO
SLOTTED	NO
DATE ON LID	

PUMP/SEPTIC TANK LEVEL	
MANUFACTURER	
CAPACITY	GAL
SEAM LOC	
TANK LID DEPTH	
BAFFLES	
BAFFLE FILTER	
MANHOLE LOC	
6" PORT LOC	
WATERTIGHT TEST	
SLOTTED	
DATE ON LID	

**PRE-CONSTRUCTION:**

5/9/18 Shot contours, laid out 10x100' trench. Keep 10' off drywell with trench. Run line from tank to D-box around drywell. (SC)

5/10/18 Tank + drywell uncovered, liquid above drywell lid. Both will be pumped today. (SC)

INSTALLATION: 5/15/18 Installation complete. D-box - ends of trench left open for inspection. Contractor sent pics + measurements of pipe from tank to D-box. Drywell pumped + filled in w/ dirt; pipe to D-box goes around old drywell. D-box has hydraulic cement around TI outlet. TI is 3' wide, 3' to stone. Manhole riser added to tank. (SC)

FINAL INSPECTOR Sarah Collins DATE OF APPROVAL 5/15/18

**Freedom Septic Services, Inc.**

2809 Liberty Road  
 Sykesville, MD 21784  
 Phone: 410-795-2947

# Invoice

DATE	INVOICE #
5/14/2018	104574

<b>BILL TO</b>
Marc Hereth Construction

P.O. NO.	TERMS	PROJECT

SERVICED	QUANTITY	DESCRIPTION	RATE	AMOUNT
5/10/2018	1	Pump Septic & drywell - 1605 Old Annapolis Rd. - 7,000 gallons	795.00	795.00
		MD State Tax	6.00%	0.00
			<b>Total</b>	\$795.00
			<b>Balance Due</b>	\$795.00

Web Site
<a href="http://www.poophappens.com">www.poophappens.com</a>

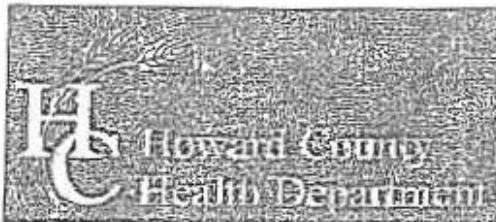

Bureau of Environmental Health

8930 Stanford Boulevard, Columbia, MD 21045
Main: 410-313-2640 | Fax: 410-313-2648
TDD 410-313-2323 | Toll Free 1-866-313-6300
www.hchealth.org
Facebook: www.facebook.com/hocohealth
Twitter: HowardCoHealthDep

Dr. Maura J. Rossman, M.D., Health Officer

INFORMATION FORM - SEPTIC SYSTEM REPAIR/UPGRADE

Reason for Request:

- Failing System
System relocation for proposed addition
System upgrade for proposed addition
Inadequate treatment zone
Collapsed septic tank
Collapsed drywell

Has the septic tank been pumped within the last month?

- Yes Date pumped: 3/22/18
No

Was a visual inspection of the septic tank and/or drain fields conducted?

- Yes Explain observations: Drywell Full
No

Existing system design

- Drywell
Trench
Mound
Unknown
Other:

Was a visual inspection of the sewage line conducted?

- Yes Blockage leading to the tank
Yes Explain: TANK Full
No

Blockage leading to the field

- Yes Explain: Drywell Full
No

Is discharge surfacing on the ground?

- Yes
No

No

Additional Comments:

\*For REPAIRS, are the owners proposing, or do they plan to add in the future, any additions or modifications to the property, i.e. pools, living space additions, garages, etc? This information must be disclosed at the time of this application. The Health Department will not be able to accommodate requests in the field for property modifications unrelated to the repair request. Such requests may require an additional fee, testing, and submittal of a Percolation Certification Plan, if the property does not meet current Code and Regulation.

Septic Contractor: MAREK D HERETH CONST Contractor's Phone: 301-580-5977
Contractor's Address: 2551 FLORENCE RD WOODBINE MD 21797

Property Address: 1605 OLD ANNAPOLIS RD County file: H62405

Subdivision: Lot: Year Built:

Owner's Name: CYRIL FRANK GIBSON III Owner's Phone: 443-340-5596

Name of previous owners: Existing bedrooms: 3
Proposed bedrooms:

Has this request been previously discussed with a Sanitarian? (Name):

Public Sewer available/nearby: No

\*A Sanitarian will be in contact within three business days, depending upon the urgency of the situation, to coordinate the scheduling/review of the repair or upgrade.

\*Prior to scheduling inspections, scaled plans should be submitted to clarify the nature of the addition.\*

Print out a copy of Real Property Data via Dept. of Taxation website Indexed file found

If public sewer may be nearby, verify whether sewer is technically "available" through the Bureau of Engineering.

If sewer is available and the property is within the Metropolitan District, connection to sewer is required: If the owner believes reason for exemption exists, the owner should justify the request in writing.

If soil/site conditions are limited and sewer and/or Metro District status is not conducive to connection, the Sanitarian may recommend pursuit of Emergency Sewer Extension or Emergency Metro District Inclusion. The Owner should contact the Bureau of Utilities for details.

No permit is to be issued nor inspection to be scheduled without prior fee collection at the office unless an emergency situation exists. The contractor is to notify office of the emergency situation as soon as possible.