

**Bureau of Environmental Health'**  
 8930 Stanford Boulevard, Columbia, MD 21045  
 Main: 410-313-2640 | Fax: 410-313-2648  
 TDD 410-313-2323 | Toll Free 1-866-313-6300  
[www.hchealth.org](http://www.hchealth.org)  
 Facebook: [www.facebook.com/hocohealth](http://www.facebook.com/hocohealth)

Maura J. Rossman, M.D., Health Officer

RECEIPT DATE: 1/29/18      **ONSITE SEWAGE DISPOSAL SYSTEM**      P 562414

INSTALLATION APPROVAL DATE: 4/11/18       **PERMIT**      A \_\_\_\_\_  
**SEWER HOUSE CONNECTION**

PROPERTY ADDRESS: 5050 Crape Myrtle Court

SUBDIVISION: Walnut Creek      LOT: 149      TAX ID: \_\_\_\_\_

CONTRACTOR: Craftmark Homes      EMAIL: jpavlik@craftmarkhomes.com

CONTRACTOR ADDRESS: 1355 Beverly Road Suite 300, McClean VA, 22101      PHONE: 703-932-0573

PROPERTY OWNER: NVR Inc.      EMAIL: \_\_\_\_\_

OWNER ADDRESS: 9720 Patuxent Woods Road, Columbia, MD 21046      PHONE: 410-379-5956

NUMBER OF BEDROOMS: 5      CONNECTED TO PUBLIC WATER:     YES     NO

LOCATION:	INSTALL 4" SEWER LINE PER APPROVED SITE PLAN.
NOTES:	

ISSUED BY: Dana Bernard      ISSUE DATE: 1/29/18      EXPIRATION DATE: 1/29/19

- NOTE: HOWARD COUNTY BUREAU OF UTILITIES APPROVAL OF GRINDER PUMP INSTALLATION IS REQUIRED PRIOR TO SEPTIC PERMIT APPROVAL
- NOTE: CONTRACTOR MUST SCHEDULE AN INSPECTION AND GAIN APPROVAL OF ALL COMPONENTS PRIOR TO COVERING
- NOTE: AN ELECTRICAL PERMIT IS REQUIRED FOR INSTALLATION OF ANY ELECTRICAL COMPONENTS OF THE SYSTEM

**NEITHER THE HOWARD COUNTY COUNCIL NOR THE HEALTH DEPARTMENT IS RESPONSIBLE FOR THE SUCCESSFUL OPERATION OF ANY SYSTEM. PERMITTEE RESPONSIBLE FOR OBTAINING FINAL APPROVAL ON THIS PERMIT. CALL 410-313-1771 FOR INSPECTION OF SEPTIC SYSTEM.**

W) H0-15-0119

NOT TO SCALE

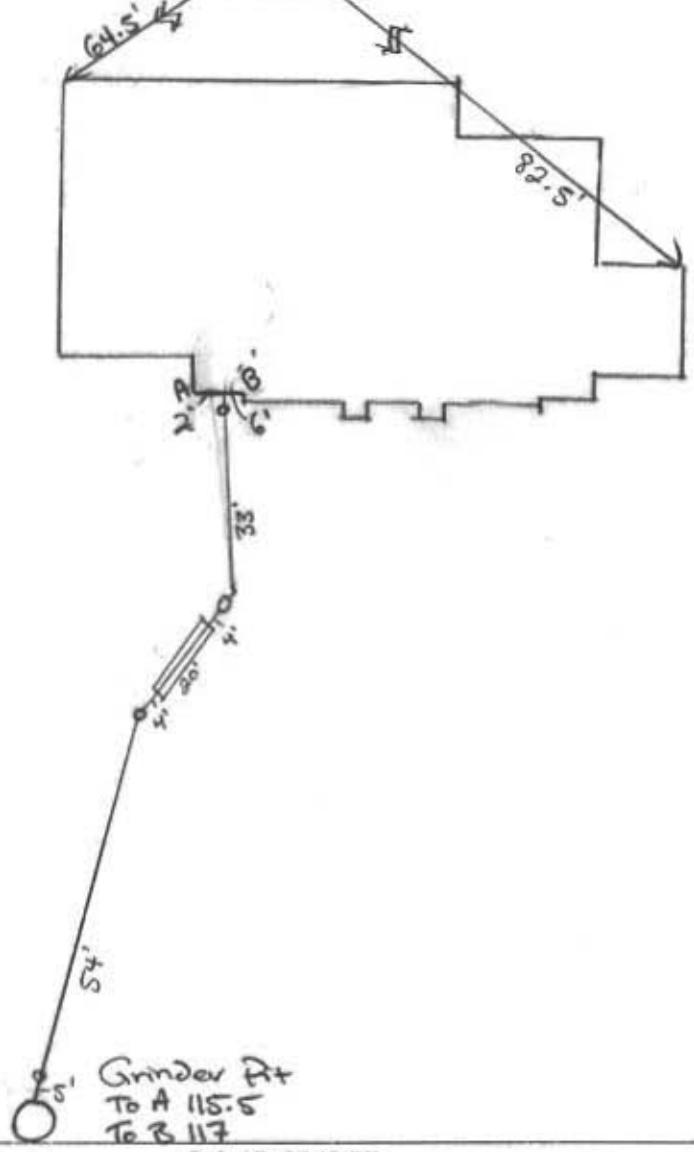

**TRENCH/DRAINFIELD DATA**

WIDTH	INLET	BOTTOM
_____	_____	_____
NUMBER OF TRENCHES	_____	
TOTAL LENGTH	_____	
ABSORPTION AREA	_____	
DISTRIBUTION BOX LEVEL	_____	
DISTRIBUTION BOX BAFFLE	_____	
DISTRIBUTION BOX PORT	_____	

**SEPTIC TANK DATA**

**SEPTIC TANK 1 LEVEL** \_\_\_\_\_

MANUFACTURER \_\_\_\_\_

CAPACITY \_\_\_\_\_ GAL

SEAM LOC \_\_\_\_\_

TANK LID DEPTH \_\_\_\_\_

BAFFLES \_\_\_\_\_

BAFFLE FILTER \_\_\_\_\_

MANHOLE LOC \_\_\_\_\_

6" PORT LOC \_\_\_\_\_

WATERTIGHT TEST \_\_\_\_\_

SLOTTED \_\_\_\_\_

DATE ON LID \_\_\_\_\_

**PUMP/SEPTIC TANK LEVEL** \_\_\_\_\_

MANUFACTURER \_\_\_\_\_

CAPACITY \_\_\_\_\_ GAL

SEAM LOC \_\_\_\_\_

TANK LID DEPTH \_\_\_\_\_

BAFFLES \_\_\_\_\_

BAFFLE FILTER \_\_\_\_\_

MANHOLE LOC \_\_\_\_\_

6" PORT LOC \_\_\_\_\_

WATERTIGHT TEST \_\_\_\_\_

SLOTTED \_\_\_\_\_

DATE ON LID \_\_\_\_\_

GRAPE ROAD NAME MYRTLE CT

**PRE-CONSTRUCTION:**

PIPE SPEC: 4" Silverline Coex Cellular Core PVC-DWV PIPE 1PS

SEH 40 Series [ASTM F-891-10 NSF/DWV V0 Non Pressure

\* Solvent welded

\* Trace wire (Blue) (a)

**INSTALLATION:** 02/14/18 Sewer line installed from house to Grinder pit.

Blue Trace wire. Awaiting Start up from Utilities (a)

1/11/18 Start-up accid. (know)

FINAL INSPECTOR

*[Signature]*

DATE OF APPROVAL

4/11/18

## **Wolf, Kevin**

---

**From:** Bozzell, Duane  
**Sent:** Wednesday, April 04, 2018 6:46 AM  
**To:** Miscbilling  
**Cc:** Hart, Amy; Rocco, Anthony; Martin, Sharhonda; Williams, Jeffrey; Bozzell, Duane; Bernard, Dana; Wolf, Kevin; Collins, Sarah; Cagle, Clint; Srour, Matthew; John Pavlik  
**Subject:** U&O Release5050 Crapemyrtle)

On the morning of 4-4-2018 observed the start-up of a Sewage Grinder Pump at the Maplewood Farm Shared Septic System:

Walnut Creek, Contract #4773  
Craftmark Homes, Lot # 149  
5050 Crapemyrtle rd  
Ellicott City, MD 21042

The Sewage Grinder Pump test was successful; the Bureau of Utilities releases its hold on this property for U&O.

*Thank You.*

*Duane Bozzell*

*DPW-Bureau of utilities*  
*Phone: (410)313-4900*  
*Fax: (410)313-4989*