

HOWARD COUNTY  
PERMIT APPLICATION

PERMIT NUMBER

307001455

Building Address 6555 PAPER PLACE  
Suite/Apt. #: \_\_\_\_\_ SDP/WP/Petition #: \_\_\_\_\_  
Census Tract \_\_\_\_\_ Subdivision \_\_\_\_\_  
Section \_\_\_\_\_ Area \_\_\_\_\_ Lot \_\_\_\_\_  
Tax Map \_\_\_\_\_ Parcel \_\_\_\_\_ Grid \_\_\_\_\_  
Zoning \_\_\_\_\_ Map Coordinates \_\_\_\_\_ Lot size \_\_\_\_\_

Property Owner's Name Shawn Cooke  
Address 6555 Paper Pl.  
City Highland State MD Zip Code 20777  
Home Phone 410 340 4945 Work Phone \_\_\_\_\_  
Applicant's Name & Mailing Address, (if other than stated hereon):  
Phone \_\_\_\_\_ Fax \_\_\_\_\_

Existing Use SFD  
Proposed Use SFD  
Estimated Construction Cost \$ \_\_\_\_\_  
Description of Work Deck 19'x41' irreg. (900sf) w/stairs

Contractor Company Welcome Home Impts.  
Contact Person John Manzari  
Address 2460 Johnson Mill Rd.  
City Forest Hill State MD Zip Code 21050  
License No. 82887  
Phone 443-752 3455 Fax \_\_\_\_\_

Occupant or Tenant Shawn Cooke  
Contact Name \_\_\_\_\_  
Address Same as above  
City \_\_\_\_\_ State \_\_\_\_\_ Zip Code \_\_\_\_\_  
Phone \_\_\_\_\_ Fax \_\_\_\_\_

Engineer or Architect Company N/A  
Contact Person \_\_\_\_\_  
Address \_\_\_\_\_  
City \_\_\_\_\_ State \_\_\_\_\_ Zip Code \_\_\_\_\_  
Phone \_\_\_\_\_ Fax \_\_\_\_\_

BUILDING DESCRIPTION - COMMERCIAL

BUILDING DESCRIPTION - RESIDENTIAL

Building Characteristics	Utilities
Height: _____	Water Supply: _____ Public <input type="checkbox"/> Private <input type="checkbox"/>
No. of stories: _____	Sewage Disposal: _____ Public <input type="checkbox"/> Private <input type="checkbox"/>
Gross area, sq. ft. per floor: _____	Electric Yes <input type="checkbox"/> No <input type="checkbox"/> Gas Yes <input type="checkbox"/> No <input type="checkbox"/>
Use group: _____	Heating System: _____ Electric <input type="checkbox"/> Oil <input type="checkbox"/> Natural Gas <input type="checkbox"/> Propane Gas <input type="checkbox"/>
Construction type: _____ Reinforced Concrete <input type="checkbox"/> Structural Steel <input type="checkbox"/> Masonry <input type="checkbox"/> Wood Frame <input type="checkbox"/> State Certified Modular <input type="checkbox"/>	Sprinkler system: <u>N/A</u> <input type="checkbox"/> Full <input type="checkbox"/> Partial <input type="checkbox"/> Other Suppression <input type="checkbox"/> # of Heads _____

Building Characteristics	Utilities
SF Dwelling <input checked="" type="checkbox"/> SF Townhouse <input type="checkbox"/> Depth _____ Width _____	Water Supply: _____ Public <input type="checkbox"/> Private <input checked="" type="checkbox"/>
1st floor: _____	Sewage Disposal: _____ Public <input type="checkbox"/> Private <input checked="" type="checkbox"/>
2nd floor: _____	Electric Yes <input checked="" type="checkbox"/> No <input type="checkbox"/> Gas Yes <input checked="" type="checkbox"/> No <input type="checkbox"/>
Basement: _____ Finished Basement <input type="checkbox"/> Unfinished Basement <input type="checkbox"/> Crawl space <input type="checkbox"/> Slab on Grade <input type="checkbox"/>	Heating System: _____ Electric <input type="checkbox"/> Oil <input type="checkbox"/> Natural Gas <input type="checkbox"/> Propane Gas <input type="checkbox"/>
No. of Bedrooms _____ Height: _____ Multi-family dwellings: No. of efficiency units: _____ No. of 1 BR units: _____ No. of 2 BR units: _____ No. of 3 BR units: _____	Sprinkler system: <u>N/A</u> <input type="checkbox"/> NFPA #13D _____ NFPA #13R _____ Other: _____
Other Structure: _____ Dimensions: _____ Footings: _____ Roof Height: _____ State Certified Modular <input type="checkbox"/> Manufactured Home <input type="checkbox"/>	

THE UNDERSIGNED HEREBY CERTIFIES AND AGREES AS FOLLOWS: (1) THAT HE/SHE IS AUTHORIZED TO MAKE THIS APPLICATION; (2) THAT THE INFORMATION IS CORRECT; (3) THAT HE/SHE WILL COMPLY WITH ALL REGULATIONS OF HOWARD COUNTY WHICH ARE APPLICABLE THERETO; (4) THAT HE/SHE WILL PERFORM NO WORK ON THE ABOVE REFERENCED PROPERTY NOT SPECIFICALLY DESCRIBED IN THIS APPLICATION; (5) THAT HE/SHE GRANTS COUNTY OFFICIALS THE RIGHT TO ENTER ONTO THIS PROPERTY FOR THE PURPOSE OF INSPECTING THE WORK PERMITTED AND POSTING NOTICES.

[Signature]  
Applicant's Signature  
Title/Company \_\_\_\_\_

John Manzari  
Print Name  
4/25/07.  
Date

Checks payable to: **DIRECTOR OF FINANCE OF HOWARD COUNTY**

\*\* PLEASE WRITE NEATLY AND LEGIBLY. \*\*

FOR OFFICE USE ONLY

AGENCY	DATE	SIGNATURE APPROVAL
Land Development DPZ		
State Highways		
Building Official		
Dev. Engineering DPZ	<u>4/25/07</u>	<u>R. Buisson</u>
Health		
Fire Protection		
Is Sediment Control approval required prior to issuance? YES <input type="checkbox"/> NO <input type="checkbox"/>		
CONTINGENCY CONSTRUCTION START: <input type="checkbox"/>		
ONE STOP SHOP: <input type="checkbox"/>		
Distribution of Copies: White: Building Official Green: LDD, DPZ		

DPZ SETBACK INFORMATION	PROPERTY ID#:
Front: _____	Filing fee \$ _____
Rear: _____	Permit fee \$ _____
Side: _____	Excise tax \$ _____
Side St: _____	Add'l per. fee \$ _____
All minimum setbacks met? YES <input type="checkbox"/> NO <input type="checkbox"/>	TOTAL FEES \$ _____
Is Entrance Permit required? YES <input type="checkbox"/> NO <input type="checkbox"/>	Sub-total paid \$ _____
Historic District? YES <input type="checkbox"/> NO <input type="checkbox"/>	Balance due \$ _____
Lot Coverage for NewTown Zone _____	Check # _____
SDP/Red-line approval date _____	Validation # _____
Accepted by _____	

REENE PROPERTY  
LOT 1  
PLAT 5208  
ZONED RR-DEO

N87°31'23"E

100 Year Floodplain,  
Drainage & Utility Easement  
Plat #12949

LOT 4  
5.67 Ac.

Forest Conservation  
Area, A1 - 0.3 Ac  
Plat #12949

M02°10'39"W

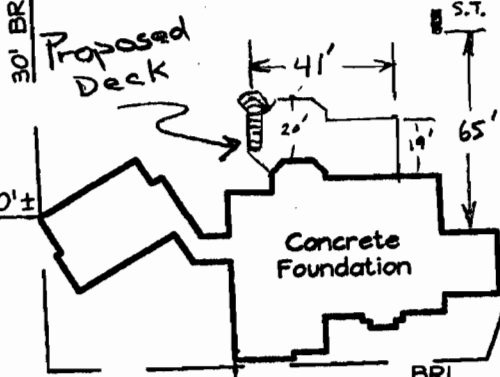
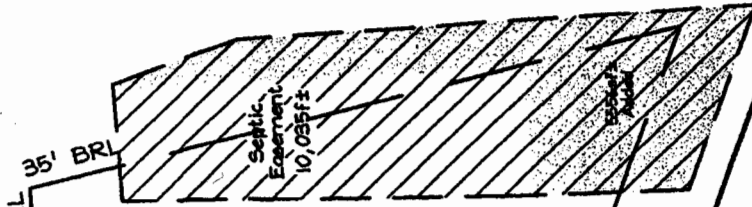

Concrete Foundation

Proposed Deck

Well #HO-94-3893

ZONED RR-DEO

894.93'

30.0'±

30' BRL  
35' BRL

30' BRL

M19°26'27"W

30' BRL

32.8'±

178.4'±

9/7/05  
well check ok

**APPROVED**  
WALK-THRU BUILDING PERMIT  
BP# 80700195  
APP. SAN *R. Walker* A#  
DESC. OF WORK: *construct deck* DATE: 4/25/07  
AS SHOWN - approx. 900 sq ft total

N02°10'39"W

S02°11'07"E

VANIT HOFF PROF  
LOT 2  
PLAT 12949  
ZONED RR-DI

**PLAN VIEW**  
SCALE: 1"=60'