



Building Permit Application

Howard County Maryland
 Department of Inspections, Licenses and Permits
 3430 Court House Drive
 Permits: 410-313-2455
 www.howardcountymd.gov

Date Received: _____

Permit No.: _____

Building Address: 14561 Edgewoods Way
 City: Glenelg State: MD Zip Code: 21737
 Suite/Apt. #: _____ SDP/WP/BA #: _____
 Census Tract: _____ Subdivision: _____
 Section: _____ Area: _____ Lot: _____
 Tax Map: _____ Parcel: _____ Grid: _____
 Zoning: _____ Map Coordinates: _____ Lot Size: _____

Property Owner's Name: Jagtar Singh Sandhu
 Address: 14561 Edgewoods Way 21737
 City: Glenelg State: MD Zip Code: _____
 Phone: 240 821 4548 Fax: _____
 Email: _____

Existing Use: _____
 Proposed Use: Building a New Deck
 Estimated Construction Cost: \$ 30,000
 Description of Work: approx 900'sq' Deck using composite decking and Vinyl Railing with 2 sets of stairs and landing
 Occupant/Tenant Name: Jagtar Singh Sandhu
 Was tenant space previously occupied? Yes No
 Contact Name: _____
 Address: _____
 City: _____ State: _____ Zip Code: _____
 Phone: _____ Fax: _____
 Email: _____

Applicant's Name & Mailing Address, (If other than stated herein)
 Applicant's Name: Luis Osorio
 Address: 4902 Ridge View Ln.
 City: Bowie State: MD Zip Code: 20715
 Phone: 240 645 9651 Fax: _____
 Email: _____

Contractor Company: Home Owner
 Contact Person: _____
 Address: _____
 City: _____ State: _____ Zip Code: _____
 License No.: _____
 Phone: _____ Fax: _____
 Email: _____

Engineer/Architect Company: _____
 Responsible Design Prof.: _____
 Address: _____
 City: _____ State: _____ Zip Code: _____
 Phone: _____ Fax: _____
 Email: _____

Commercial Building Characteristics	Residential Building Characteristics	
Height:	<input checked="" type="checkbox"/> SF Dwelling <input type="checkbox"/> SF Townhouse	
No. of stories:	Depth	Width
Gross area, sq. ft./floor:	1 st floor:	
	2 nd floor:	
Area of construction (sq. ft.):	Basement:	
	<input type="checkbox"/> Finished Basement	
Use group:	<input type="checkbox"/> Unfinished Basement	
	<input type="checkbox"/> Crawl Space	
Construction type:	<input type="checkbox"/> Slab on Grade	
<input type="checkbox"/> Reinforced Concrete	No. of Bedrooms:	
<input type="checkbox"/> Structural Steel	Multi-family Dwelling	
<input type="checkbox"/> Masonry	No. of efficiency units:	
<input type="checkbox"/> Wood Frame	No. of 1 BR units:	
<input type="checkbox"/> State Certified Modular	No. of 2 BR units:	
	No. of 3 BR units:	
	Other Structure:	
	Dimensions:	
<input checked="" type="checkbox"/> Roadside Tree Project Permit	Footings:	
<input type="checkbox"/> Yes <input checked="" type="checkbox"/> No	Roof:	
Roadside Tree Project Permit #	<input type="checkbox"/> State Certified Modular	
	<input type="checkbox"/> Manufactured Home	

Utilities	
Electric:	<input checked="" type="checkbox"/> Yes <input type="checkbox"/> No
Gas:	<input type="checkbox"/> Yes <input type="checkbox"/> No
Water Supply	
<input type="checkbox"/> Public	
<input checked="" type="checkbox"/> Private	
Sewage Disposal	
<input type="checkbox"/> Public	
<input checked="" type="checkbox"/> Private	
Heating System	
<input checked="" type="checkbox"/> Electric	<input type="checkbox"/> Oil
<input type="checkbox"/> Natural Gas	<input type="checkbox"/> Propane Gas
<input type="checkbox"/> Other:	
Sprinkler System:	
<input type="checkbox"/> Yes	<input checked="" type="checkbox"/> No
Grading Permit Number:	
Building Shell Permit Number:	

THE UNDERSIGNED HEREBY CERTIFIES AND AGREES AS FOLLOWS: (1) THAT HE/SHE IS AUTHORIZED TO MAKE THIS APPLICATION; (2) THAT THE INFORMATION IS CORRECT; (3) THAT HE/SHE WILL COMPLY WITH ALL REGULATIONS OF HOWARD COUNTY WHICH ARE APPLICABLE THERETO; (4) THAT HE/SHE WILL PERFORM NO WORK ON THE ABOVE REFERENCED PROPERTY NOT SPECIFICALLY DESCRIBED IN THIS APPLICATION; (5) THAT HE/SHE GRANTS COUNTY OFFICIALS THE RIGHT TO ENTER ONTO THIS PROPERTY FOR THE PURPOSE OF INSPECTING THE WORK PERMITTED AND POSTING NOTICES.

Luis Osorio
 Applicant's Signature
Luisosorio585@gmail.com
 Email Address
C+J improvements.
 Title/Company

Luis Osorio
 Print Name
05-07-18
 Date

Checks Payable to: DIRECTOR OF FINANCE OF HOWARD COUNTY
 PLEASE WRITE NEATLY & LEGIBLY
 -FOR OFFICE USE ONLY-

AGENCY	DATE	SIGNATURE OF APPROVAL
State Highways		
Building Officials		
PSZA (Zoning)		
PSZA (Engineering)		
Health	<u>5/7/18</u>	<u>R. Buckler</u>

Is Sediment Control approval required for issuance? Yes No
 CONTINGENCY-CONSTRUCTION START

DPZ SETBACK INFORMATION
Front:
Rear:
Side:
Side St.:
All minimum setbacks met? <input type="checkbox"/> Yes <input type="checkbox"/> No
Is Entrance Permit Required? <input type="checkbox"/> Yes <input type="checkbox"/> No
Historic District? <input type="checkbox"/> Yes <input type="checkbox"/> No
Lot Coverage for New Town Zone:
SDP/Red-line approval date:

Filing Fee	\$
Permit Fee	\$
Tech Fee	\$
Excise Tax	\$
PSFS	\$
Guaranty Fund	\$
Add'l per Fee	\$
Total Fees	\$
Sub- Total Paid	\$
Balance Due	\$
Check	#

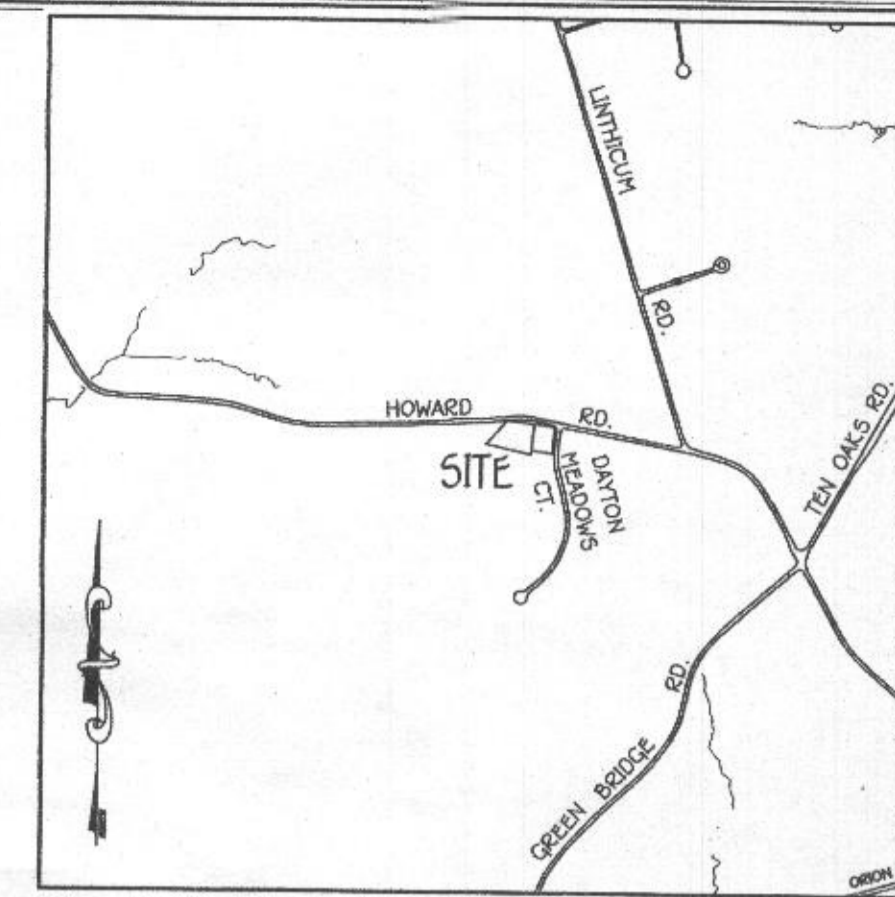

VICINITY MAP
SCALE: 1" = 1200'
ADC STREET MAP: MAP 24, GRID C4



GENERAL NOTES:

- 1) THIS BOUNDARY SURVEY WAS PERFORMED WITHOUT A CURRENT TITLE REPORT.
- 2) CURRENT DEED REFERENCE PER SDAT IS LIBER 81, FOLIO 405. THIS APPEARS TO BE AN ERROR. DEEDS USED FOR THIS SURVEY ARE LIBER 30, FOLIO 101 AND LIBER 36 FOLIO 353, AND MAY NOT BE THE MOST CURRENT DEED.
- 3) PROPERTY TOTAL AREA: AREA 1= 41,370 SQ.FT. AREA 2= 21,755 SQ.FT.*
- 4) THE OFFSETS FROM BUILDING LINE TO PROPERTY LINE AS SHOWN ON THE DRAWING HEREON ARE ACCURATE TO PLUS OR MINUS 0.2'
- 5) SUBJECT PROPERTY IS SHOWN IN ZONE 'X' ON THE NATIONAL FLOOD INSURANCE PROGRAM FLOOD INSURANCE RATE MAP OF HOWARD COUNTY, MARYLAND, COMMUNITY PANEL No. 24027 C 0130 D, EFFECTIVE DATE: 11/06/2013.
- 6) I HEREBY CERTIFY THAT THESE DOCUMENTS WERE PREPARED OR APPROVED BY ME, AND THAT I AM A DULY LICENSED PROFESSIONAL LAND SURVEYOR UNDER THE LAWS OF THE STATE OF MARYLAND. LICENSE NO. 10692 EXPIRATION DATE: DECEMBER 13, 2016
- 7) ADJOINING BUILDINGS AND DRIVEWAYS ARE BASED ON HOWARD COUNTY GIS DATA AND HAVE NOT BEEN FIELD VERIFIED.

Terrell A. Fisher 4/27/17
TERRELL A. FISHER
PROFESSIONAL LAND SURVEYOR DATE

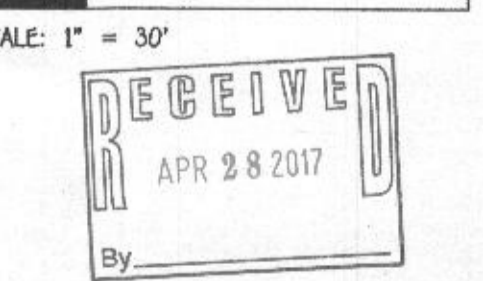
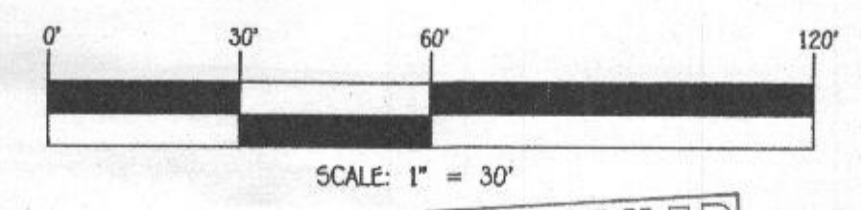

NONCONFORMING USE PLAN
BROWNS CHAPEL

FISHER, COLLINS & CARTER, INC.
CIVIL ENGINEERING CONSULTANTS & LAND SURVEYORS
CENTENNIAL SQUARE OFFICE PARK - 10272 BALTIMORE NATIONAL PIKE
ELLSWORTH CITY, MARYLAND 21042
(410) 461-2895

OWNER/PETITIONER'S
BROWNS CHAPEL
13601 DAYTON MEADOW COURT
DAYTON, MARYLAND 21036

ZONING: RR-DEO
TAX MAP No. 28 GRID No. 07 PARCEL No. 296
5TH ELECTION DISTRICT HOWARD COUNTY, MARYLAND
DATE: MAR. 13, 2017 FCC W/O# 30184-1001
REVISED: APRIL 27, 2017

K:\SDS\PROJ\30134\Engineering\Drawings\30134 Survey W/S.dwg, 4/27/2017 10:25:35 PM, 11