

PUB. SEWER STATUS VERIFIED BY _____

ISSUE DATE: 07/08/09

P 531076

APPROVAL DATE: 7/14/09

A REPAIR

PERMIT

MINOR SEPTIC REPAIR

Tax ID # 04-334310 *In Pat Trac*

**ON-SITE SEWAGE DISPOSAL SYSTEM
HOWARD COUNTY HEALTH DEPARTMENT
BUREAU OF ENVIRONMENTAL HEALTH
SEWER HOUSE CONNECTION**

K & K Excavating IS PERMITTED TO INSTALL ALTER

ADDRESS: 15882 Frederick Road, Lisbon MD 21765 PHONE NUMBER: 410-442-1336

SUBDIVISION: _____ LOT NUMBER: _____

ADDRESS: 3273 Our Mile Court PROPERTY OWNER: Stephen Schuster

SEPTIC TANK CAPACITY (GALLONS): _____

PUMP CHAMBER CAPACITY (GALLONS): _____

NUMBER OF BEDROOMS: 4

SQUARE FOOTAGE (OF HOUSE): _____

LINEAR FEET OF TRENCH REQUIRED: _____

*Line from tank to
drywell blocked up*

TRENCHES:	Trench to be feet wide. Inlet at feet below original grade. Bottom maximum depth feet below original grade. Effective area begins at feet below original grade. feet of stone below the distribution pipe.
LOCATION:	
ADDITIONAL NOTES:	

PLANS APPROVED: _____ DATE: _____

- NOTE: PERMIT VOID AFTER 2 YEARS
- NOTE: CONTRACTOR RESPONSIBLE FOR SCHEDULING A PRE-CONSTRUCTION INSPECTION FOR ALL INSTALLATIONS
- NOTE: WATERTIGHT SEPTIC TANKS REQUIRED
- NOTE: ALL PARTS OF SEPTIC SYSTEM SHALL BE 100 FEET FROM ANY WATER WELL
- NOTE: MANHOLE RISERS REQUIRED ON ALL SEPTIC TANKS AND PUMP CHAMBERS

NEITHER THE HOWARD COUNTY COUNCIL OR THE HEALTH DEPARTMENT IS RESPONSIBLE FOR THE SUCCESSFUL OPERATION OF ANY SYSTEM PERMITTEE RESPONSIBLE FOR OBTAINING FINAL APPROVAL ON THIS PERMIT CALL 410-313-2640 FOR INSPECTION OF SEPTIC SYSTEM

NOT TO SCALE

See As-Built
Drawing On Separate
Sheet

ROAD NAME

TRENCH/DRAINFIELD DATA

WIDTH	INLET	BOTTOM
_____	_____	_____
_____	_____	_____
_____	_____	_____
_____	_____	_____
_____	_____	_____
_____	_____	_____
_____	_____	_____
_____	_____	_____

SEPTIC TANK DATA

SEPTIC TANK 1 LEVEL Yes

MANUFACTURER _____

CAPACITY 1250? GAL

SEAM LOC Midseam

TANK LID DEPTH 3.5'-4'

BAFFLES Yes

BAFFLE FILTER No

MANHOLE LOC Front+Rear

6" PORT LOC None

WATERTIGHT TEST No

SLOTTED No

DATE ON LID N/A

PUMP/SEPTIC TANK LEVEL N/A

MANUFACTURER _____

CAPACITY _____ GAL

SEAM LOC _____

TANK LID DEPTH _____

BAFFLES _____

BAFFLE FILTER _____

MANHOLE LOC _____

6" PORT LOC _____

WATERTIGHT TEST _____

SLOTTED _____

DATE ON LID _____

PRE-CONSTRUCTION:

INSTALLATION: 7/14/09 Existing tank pumped out. Manhole risers installed. Line from tank to drywell cleaned and repaired. (BB)

FINAL INSPECTOR B. Baker DATE OF APPROVAL 7/14/09

HO-73-1173

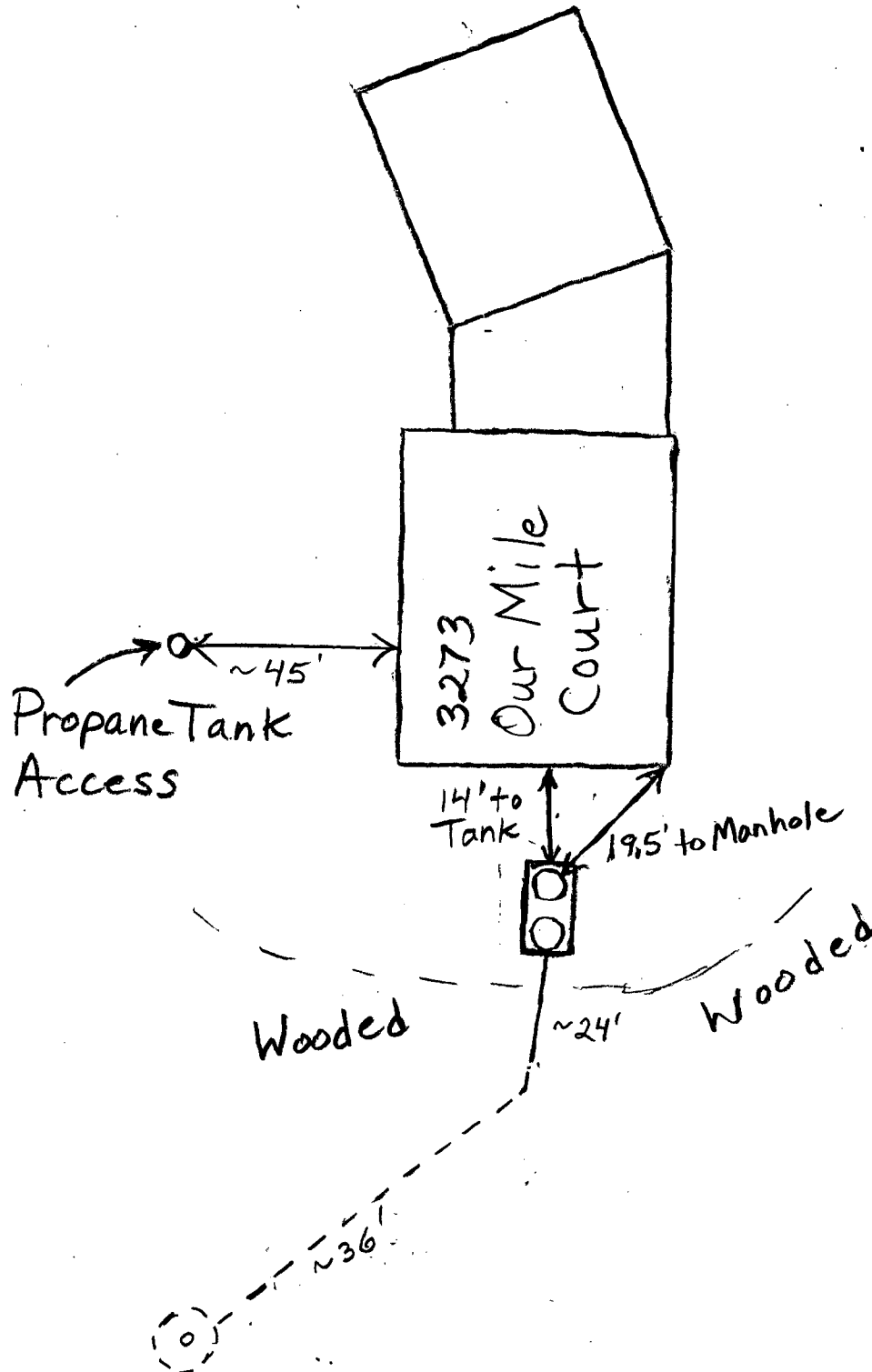

NOT TO SCALE