

**Bureau of Environmental Health**  
 8930 Stanford Boulevard, Columbia, MD 21045  
 Main: 410-313-2640 | Fax: 410-313-2648  
 TDD 410-313-2323 | Toll Free 1-866-313-6300  
[www.hchealth.org](http://www.hchealth.org)  
 Facebook: [www.facebook.com/hocohealth](http://www.facebook.com/hocohealth)

Maura J. Rossman, M.D., Health Officer

RECEIPT DATE: 4/13/18      **ONSITE SEWAGE DISPOSAL SYSTEM**      P 562955  
 APPROVAL DATE: 4/24/18 SEC      **PERMIT:**      **UPGRADE**      A \_\_\_\_\_  
 PROPERTY ADDRESS: 1276 Route 97  
 SUBDIVISION: \_\_\_\_\_ LOT: \_\_\_\_\_ TAX ID: 04-312678  
 CONTRACTOR: Hatfield's Equipment      EMAIL: ken@hatfieldsequipment.com  
 CONTRACTOR ADDRESS: P.O. Box 519, Annapolis Junction, MD 21701      PHONE: 301-490-4289  
 PROPERTY OWNER: Keith and Sharon Nelson      EMAIL: \_\_\_\_\_  
 OWNER ADDRESS: 1276 Route 97, Cooksville, MD 21723      PHONE: \_\_\_\_\_

SEPTIC TANK SIZE (GALLONS): 1500      PUMP CHAMBER CAPACITY (GALLONS): \_\_\_\_\_      PUMP SIZE: \_\_\_\_\_  
 NUMBER OF BEDROOMS: 3      HOUSE SQ. FT. \_\_\_\_\_      APPLICATION RATE: 1.2  
 DISTRIBUTION SYSTEM:    GRAVITY FED       LOW PRESSURE DOSED

TRENCHES:	LINEAR FEET REQUIRED: <u>80</u>	INLET DEPTH: <u>4</u>
	TRENCH WIDTH: <u>3</u>	MAXIMUM BOTTOM DEPTH: <u>6</u>
	MINIMUM SPACE BETWEEN TRENCHES: _____	EFFECTIVE AREA BEGINNING DEPTH: _____
LOCATION:	<b>TO BE STAKED BY SANITARIAN DURING PRE-CONSTRUCTION INSPECTION.</b>	
NOTES:	<i>System based on perc data from 1986 (-KMD)</i> <i>Install 2 - 40' trenches on contour just below likely spot of perc hole</i> <i>H1. Par 1. Existing <sup>metal</sup> tank must be pumped + removed.</i>	

ISSUED BY: Sarah Collins      ISSUE DATE: 4/20/18      EXPIRATION DATE: 4/20/19

- NOTE: CONTRACTOR MUST SCHEDULE A PRE-CONSTRUCTION INSPECTION PRIOR TO BEGINNING ANY INSTALLATION
- NOTE: CONTRACTOR MUST SCHEDULE AN INSPECTION AND GAIN APPROVAL OF ALL COMPONENTS PRIOR TO COVERING
- NOTE: STONE MUST BE APPROVED BY HEALTH DEPARTMENT AND GRAVEL TICKET MUST BE AVAILABLE FOR REVIEW.
- NOTE: WATERTIGHT SEPTIC TANKS REQUIRED
- NOTE: ALL PARTS OF SEPTIC SYSTEM SHALL BE AT LEAST 100 FEET DOWNGRADIENT FROM ANY WATER WELL
- NOTE: MANHOLE RISERS REQUIRED ON ALL SEPTIC TANKS AND PUMP CHAMBERS
- NOTE: AN ELECTRICAL PERMIT IS REQUIRED FOR INSTALLATION OF ANY ELECTRICAL COMPONENTS OF THE SYSTEM  
 ELECTRICAL PERMIT ISSUED    E N/A
- NOTE: THE HCHD DOES NOT WARRANT ANY SYSTEM AND CANNOT GUARANTEE THE PERFORMANCE OF THIS SYSTEM AS DESIGNED. BY ACCEPTING THIS PERMIT, THE OWNER AND/OR APPLICANT ACKNOWLEDGE THAT THE SPECIFICATIONS DETAILED IN THIS DESIGN ARE ONE POSSIBLE OPTION AND THAT THE HCHD WILL REVIEW OTHER PROPOSALS. YOU HAVE THE OPTION TO SEEK THE ADVICE OF A QUALIFIED DESIGN CONSULTANT OR PROFESSIONAL ENGINEER FOR FURTHER GUIDANCE.
- NOTE: MDE RECOMMENDS SEPTIC TANKS, BAT, AND OTHER PRETREATMENT UNITS BE PUMPED AT A FREQUENCY ADEQUATE TO ENSURE THAT SOLIDS ARE NOT DISCHARGED TO THE DISPOSAL AREA

**NEITHER THE HOWARD COUNTY COUNCIL NOR THE HEALTH DEPARTMENT IS RESPONSIBLE FOR THE SUCCESSFUL OPERATION OF ANY SYSTEM.**  
**PERMITTEE RESPONSIBLE FOR OBTAINING FINAL APPROVAL ON THIS PERMIT.**  
**CALL 410-313-1771 TO SCHEDULE INSPECTIONS.**

NOT TO SCALE

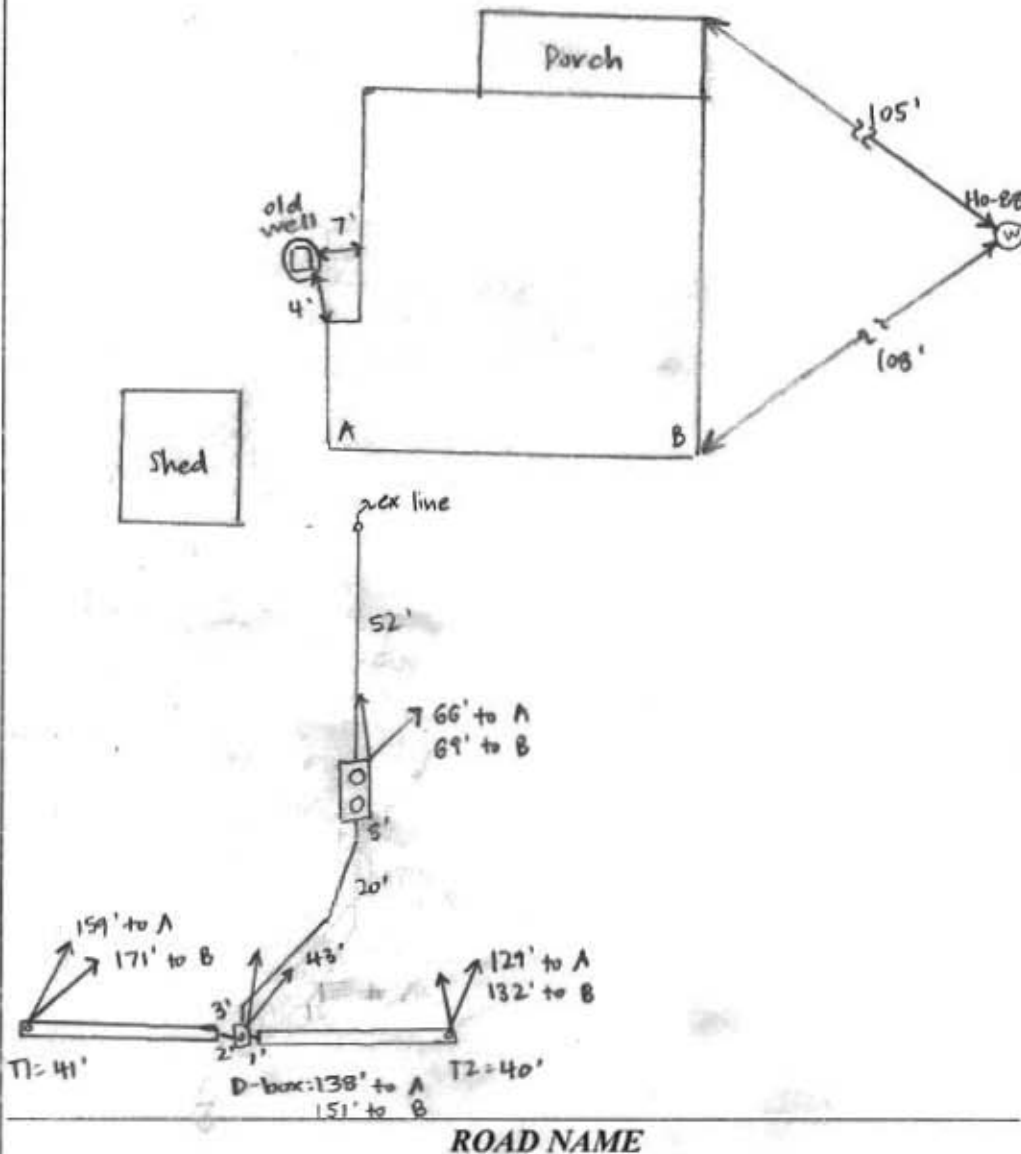

TRENCH/DRAINFIELD DATA		
WIDTH	INLET	BOTTOM
3'	4'	6'
NUMBER OF TRENCHES	2	
TOTAL LENGTH	81'	
ABSORPTION AREA	243' + SIDEWALL	
DISTRIBUTION BOX LEVEL	YES	
DISTRIBUTION BOX BAFFLE	YES	
DISTRIBUTION BOX PORT	YES	

SEPTIC TANK DATA	
SEPTIC TANK I LEVEL	YES
MANUFACTURER	BABYLON
CAPACITY	1500 GAL
SEAM LOC	TOP
TANK LID DEPTH	0.5-1'
BAFFLES	YES
BAFFLE FILTER	NO
MANHOLE LOC	FRONT + REAR
6" PORT LOC	NONE
WATERTIGHT TEST	NO
SLOTTED	YES
DATE ON LID	3-12-10

PUMP/SEPTIC TANK LEVEL	
MANUFACTURER	
CAPACITY	GAL
SEAM LOC	
TANK LID DEPTH	
BAFFLES	
BAFFLE FILTER	
MANHOLE LOC	
6" PORT LOC	
WATERTIGHT TEST	
SLOTTED	
DATE ON LID	

PRE-CONSTRUCTION:

4/20/10 Met Hatfield's on site for layout. Located approx. location of perc hole #1 on Parcel 1 and perc hole #4 on Parcel 2. Shot contour and laid out 2 x 40' trenches just above perc hole #1 on Parcel 1. Metal tank is collapsing - Hatfield's to pump + remove tank. (SC)

INSTALLATION:

4/23/10 New tank set + connected to existing sewer line. D-box set. Dig to 11' @ start of T1 - profile similar to soil description of perc #1 of Parcel 1, maybe less clay. (SC) 4/24/10 Trenches complete - left open for inspection. 3' wide, 3.5-4' to stone. Levelled speed levelers in D-box. old tank pumped + crushed. (SC)

FINAL INSPECTOR Sarah Collins DATE OF APPROVAL 4/24/10

Maura J. Rossman, M.D., Health Officer

April 24, 2018

Homeowner  
3299 Sharp Road  
Glenwood, MD 21738

Re: Old well at 1276 Route 97

Dear Homeowner,

During a recent inspection of the septic installation, the Health Department found an old hand dug well on the property.

The old well must be sealed by a licensed well driller as per *COMAR 26.04.04.34*. A well not in use can contribute to pollution of groundwater and pose a risk to people drinking water in the area. Documentation should be submitted by the driller to the Health Department showing the well has been abandoned and sealed.

I have included a list of well drillers active in Howard County. Feel free to contact me with any questions.

Sincerely,



Sarah Collins, L.E.H.S.  
Howard County Health Department  
Well & Septic Program  
[SCollins@howardcountymd.gov](mailto:SCollins@howardcountymd.gov)  
410-313-6287

Cc: File

SITE INSPECTION SHEET

OWNER: Nelson PHONE #: \_\_\_\_\_

ADDRESS: 1276 Route 97 CONTRACTOR: Hatfield's

WELL TAG #: \_\_\_\_\_

SUBDIVISION: \_\_\_\_\_ LOT: \_\_\_\_\_ COUNTY #: \_\_\_\_\_

PROPOSAL: Replace metal tank that collapsed. install new trenches.

LOCATION DIAGRAM

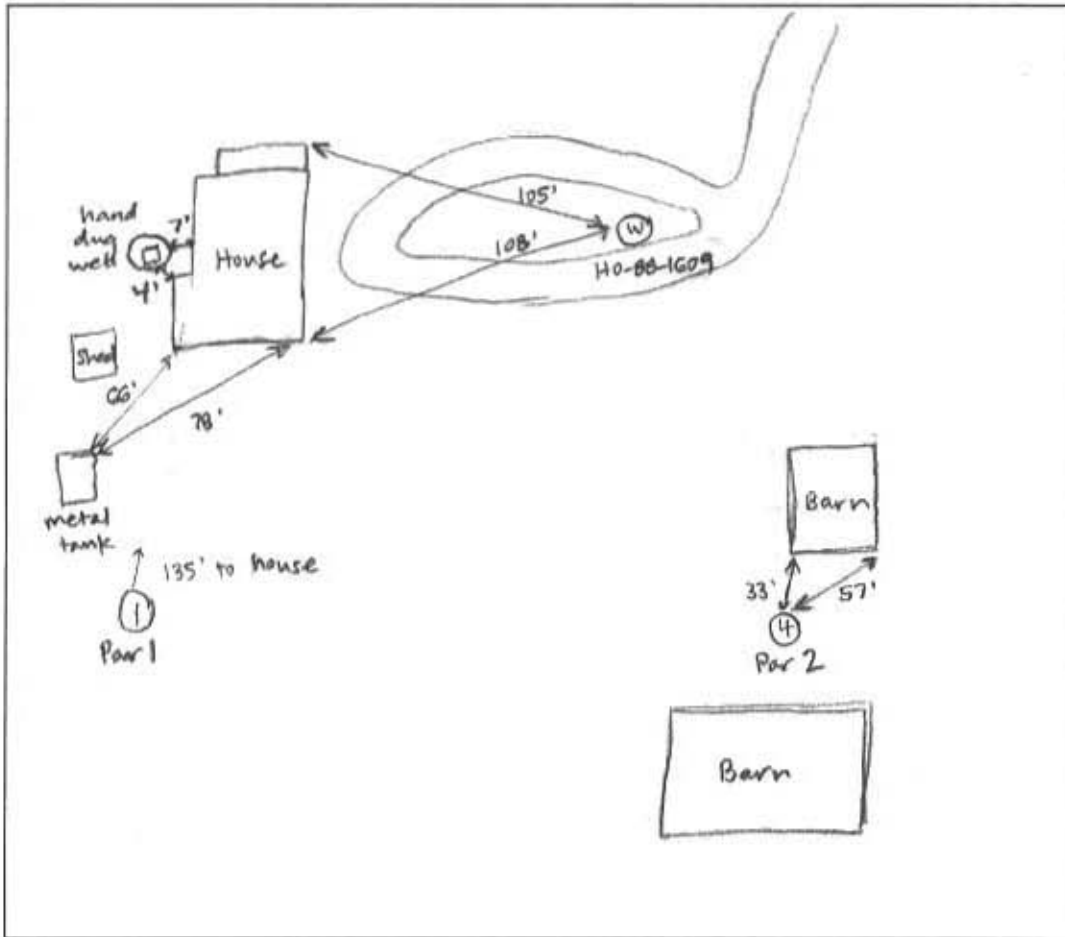

COMMENTS: Met Hatfield's on site. Roughly located two perc holes from 2/20/86 perc notes. Install new system just below perc #1 on Parcel 1.

DATE: 4/20/18 INSPECTOR: Sarah Collins







# HOWARD COUNTY HEALTH DEPARTMENT

62955

4 / 13 / 18  
DATE

Received From

Howard County

PHONE #

301-496-4299

For

Septic Repair Permit - 1276 Route 97

CASH

CHECK

NO.

3950

One thousand & forty five

00/100

Dollars

\$

1165 00

Received By

D. D. K. [unclear]