

HOWARD COUNTY PERMIT APPLICATION

PERMIT NUMBER

BO7001174

Building Address 2041 ORDWAY DR
 Suite/Apt. #: _____ SDP/WP/Petition #: _____
 Census Tract _____ Subdivision _____
 Section _____ Area 5048A Lot _____
 Tax Map _____ Parcel 284 Grid _____
 Zoning _____ Map Coordinates _____ Lot size _____

Property Owner's Name RAULIS MAGER
 Address SAME
 City _____ State _____ Zip Code _____
 Home Phone 410 531 3544 Work Phone _____
 Applicant's Name & Mailing Address, (if other than stated hereon):

 Phone _____ Fax _____

Existing Use _____
 Proposed Use _____
 Estimated Construction Cost \$ 20000
 Description of Work REPLACE ROOF

Contractor Company THOMSON GAS
 Contact Person DOUG MAGER
 Address 6702 JES NATIONALE PIKE
 City _____ State MD Zip Code 21713
 License No. _____
 Phone 301 255-6612 Fax _____

Occupant or Tenant OWNER
 Contact Name _____
 Address _____
 City _____ State _____ Zip Code _____
 Phone _____ Fax _____

Engineer or Architect Company N/A
 Contact Person _____
 Address _____
 City _____ State _____ Zip Code _____
 Phone _____ Fax _____

BUILDING DESCRIPTION - COMMERCIAL

BUILDING DESCRIPTION - RESIDENTIAL

Building Characteristics	Utilities
Height: _____	Water Supply: _____ Public _____ Private _____
No. of stories: _____	Sewage Disposal: _____ Public _____ Private _____
Gross area, sq. ft. per floor: _____	Electric Yes <input type="checkbox"/> No <input type="checkbox"/> Gas Yes <input type="checkbox"/> No <input type="checkbox"/>
Use group: _____	Heating System: _____ Electric <input type="checkbox"/> Oil <input type="checkbox"/> Natural Gas <input type="checkbox"/> Propane Gas <input type="checkbox"/>
Construction type: _____ Reinforced Concrete _____ Structural Steel _____ Masonry _____ Wood Frame _____ State Certified Modular _____	Sprinkler system: <u>N/A</u> <input type="checkbox"/> Full _____ Partial _____ Other Suppression _____ # of Heads _____

Building Characteristics	Utilities
SF Dwelling <input type="checkbox"/> SF Townhouse <input type="checkbox"/> Depth _____ Width _____	Water Supply: _____ Public _____ Private <input checked="" type="checkbox"/>
1st floor: _____	Sewage Disposal: _____ Public _____ Private <input checked="" type="checkbox"/>
2nd floor: _____	Electric Yes <input type="checkbox"/> No <input type="checkbox"/> Gas Yes <input type="checkbox"/> No <input type="checkbox"/>
Basement: _____	Heating System: _____ Electric <input type="checkbox"/> Oil <input type="checkbox"/> Natural Gas <input type="checkbox"/> Propane Gas <input type="checkbox"/>
Finished Basement <input type="checkbox"/> Unfinished Basement <input type="checkbox"/> Crawl space <input type="checkbox"/> Slab on Grade <input type="checkbox"/>	Sprinkler system: <u>N/A</u> <input type="checkbox"/> NFPA #13D _____ NFPA #13R _____ Other: _____
No. of Bedrooms _____	
Multi-family dwellings: _____	
No. of efficiency units: _____	
No. of 1 BR units: _____	
No. of 2 BR units: _____	
No. of 3 BR units: _____	
Other Structure: _____	
Dimensions: _____	
Footings: _____	
Roof: _____	
State Certified Modular _____ Manufactured Home _____	

THE UNDERSIGNED HEREBY CERTIFIES AND AGREES AS FOLLOWS: (1) THAT HE/SHE IS AUTHORIZED TO MAKE THIS APPLICATION; (2) THAT THE INFORMATION IS CORRECT; (3) THAT HE/SHE WILL COMPLY WITH ALL REGULATIONS OF HOWARD COUNTY WHICH ARE APPLICABLE THERETO; (4) THAT HE/SHE WILL PERFORM NO WORK ON THE ABOVE REFERENCED PROPERTY NOT SPECIFICALLY DESCRIBED IN THIS APPLICATION; (5) THAT HE/SHE GRANTS COUNTY OFFICIALS THE RIGHT TO ENTER ONTO THIS PROPERTY FOR THE PURPOSE OF INSPECTING THE WORK PERMITTED AND POSTING NOTICES.

Applicant's Signature [Signature]
 Title/Company _____

Print Name Doug Mager
 Date 4/9/07

Checks payable to: **DIRECTOR OF FINANCE OF HOWARD COUNTY**
**** PLEASE WRITE NEATLY AND LEGIBLY. ****

FOR OFFICE USE ONLY

AGENCY	DATE	SIGNATURE APPROVAL
Land Development, DPZ		
State Highways		
Building Official		
Dev. Engineering, DPZ	<u>4/20/07</u>	<u>[Signature]</u>
Health		
Fire Protection		
Is Sediment Control approval required prior to issuance?		
YES <input type="checkbox"/> NO <input type="checkbox"/>		
CONTINGENCY CONSTRUCTION START: <input type="checkbox"/>		
ONE STOP SHOP: <input type="checkbox"/>		

DPZ SETBACK INFORMATION	PROPERTY ID#
Front: _____	Filing fee \$ _____
Rear: _____	Permit fee \$ _____
Side: _____	Excise tax \$ _____
Side St: _____	Add'l per. fee \$ _____
All minimum setbacks met?	TOTAL FEES \$ _____
YES <input type="checkbox"/> NO <input type="checkbox"/>	Sub-total paid \$ _____
Is Entrance Permit required?	Balance due \$ _____
YES <input type="checkbox"/> NO <input type="checkbox"/>	Check # <u>42110</u>
Historic District?	Validation # _____
YES <input type="checkbox"/> NO <input type="checkbox"/>	
Lot Coverage for NewTown Zone _____	
SDP/Red-line approval date _____	Accepted by _____

Distribution of Copies: White: Building Official Green: LDD, DPZ Yellow: DED, DPZ Pink: Health Gold: SHA

565° 41' 03" E 422.00'

TANK 10 FT
From garage

C.M.P. 601-717

N 31° 09' 08" E - 500.00'

548.00'

Pool HEATED

PROPOSED
240'

Pool

BURIED
GAS
LINE

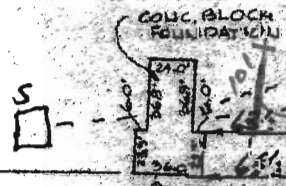

Garage

500 GALLON
ABOVE GROUND
TANK

Part of 1st Line
W.H.H. 422-428

10'

63'

150'

193.00'

N 58° 50' 32" W
18.68'

N 58° 50' 52" W 207.48'

N 59° 31' 00" W

Point of Beginning
769.02' from Beg.
of 1st or N 58° 53' W
2218.38' Line
W.H.H. 422-428

SECTION-3
GREEN HEDGE
10/98

ORDWAY DRIVE
(30' WIDE)
779.02 TO P.C.
E. GREENWAY

Propane tank at
olive gas
line over well line 10' 4/29/07
per SFD SF

This is to certify that I have surveyed the property known as PROPERTY OF HARRIS R. MAGER & BARBARA L. MAGER, HIS WIFE, NORTHEASTERN MOST LIMIT OF ORDWAY DRIVE
3RD ELECTION DISTRICT-HOWARD COUNTY, MARYLAND
for the purpose of locating the improvements thereon, and the improvements are located as shown.

Signed this 19TH day of SEPTEMBER 1973

PIIRDUM AND JESCHKE
ENGINEERS AND LAND SURVEYORS
3697 PARK AVE.
ELLCOTT CITY, MARYLAND 21043

[Signature]
Engineer and Land Surveyor

This plat is not intended for use in
the establishment of property lines.