



Building Permit Application

Howard County Maryland
Department of Inspections, Licenses and Permits
3430 Court House Drive
Permits: 410-313-2455
www.howardcountymd.gov

Date Received: _____

Permit No.: _____

Building Address: 8126 Brookwood Farm Rd
 City: Fulton State: MD Zip Code: 20759
 Suite/Apt. #: _____ SDP/WP/BA #: _____
 Census Tract: _____ Subdivision: _____
 Section: _____ Area: _____ Lot: _____
 Tax Map: _____ Parcel: _____ Grid: _____
 Zoning: _____ Map Coordinates: _____ Lot Size: _____

Property Owner's Name: William McKinzie
 Address: 8126 Brookwood Farm Rd
 City: Fulton State: MD Zip Code: 20759
 Phone: 301-442-7030 Fax: _____
 Email: willmck@mckintek.com

Existing Use: _____
 Proposed Use: _____
 Estimated Construction Cost: \$ _____
 Description of Work: Kitchen remodel
 Occupant/Tenant Name: _____
 Was tenant space previously occupied? Yes No
 Contact Name: _____
 Address: _____
 City: _____ State: _____ Zip Code: _____
 Phone: _____ Fax: _____
 Email: _____

Applicant's Name & Mailing Address, (if other than stated herein)
 Applicant's Name: _____
 Address: _____
 City: _____ State: _____ Zip Code: _____
 Phone: _____ Fax: _____
 Email: _____

Contractor Company: _____
 Contact Person: _____
 Address: _____
 City: _____ State: _____ Zip Code: _____
 License No.: _____
 Phone: _____ Fax: _____
 Email: _____

Engineer/Architect Company: _____
 Responsible Design Prof.: _____
 Address: _____
 City: _____ State: _____ Zip Code: _____
 Phone: _____ Fax: _____
 Email: _____

Commercial Building Characteristics	Residential Building Characteristics	
Height:	<input checked="" type="checkbox"/> SF Dwelling	<input type="checkbox"/> SF Townhouse
No. of stories:	Depth	Width
Gross area, sq. ft./floor:	1 st floor:	
Area of construction (sq. ft.):	2 nd floor:	
Use group:	Basement:	
	<input type="checkbox"/> Finished Basement	
	<input type="checkbox"/> Unfinished Basement	
	<input type="checkbox"/> Crawl Space	
	<input type="checkbox"/> Slab on Grade	
Construction type:	No. of Bedrooms:	
<input type="checkbox"/> Reinforced Concrete	<input type="checkbox"/> Multi-family Dwelling	
<input type="checkbox"/> Structural Steel	No. of efficiency units:	
<input type="checkbox"/> Masonry	No. of 1 BR units:	
<input type="checkbox"/> Wood Frame	No. of 2 BR units:	
<input type="checkbox"/> State Certified Modular	No. of 3 BR units:	
	Other Structure:	
	Dimensions:	
➤ Roadside Tree Project Permit	Footings:	
<input type="checkbox"/> Yes <input type="checkbox"/> No	Roof:	
Roadside Tree Project Permit #	<input type="checkbox"/> State Certified Modular	
	<input type="checkbox"/> Manufactured Home	

Utilities	
Electric:	<input checked="" type="checkbox"/> Yes <input type="checkbox"/> No
Gas:	<input checked="" type="checkbox"/> Yes <input type="checkbox"/> No
Water Supply	
<input type="checkbox"/> Public	
<input checked="" type="checkbox"/> Private	
Sewage Disposal	
<input type="checkbox"/> Public	
<input checked="" type="checkbox"/> Private	
Heating System	
<input type="checkbox"/> Electric	<input type="checkbox"/> Oil
<input checked="" type="checkbox"/> Natural Gas	<input type="checkbox"/> Propane Gas
<input type="checkbox"/> Other:	
Sprinkler System:	
<input type="checkbox"/> Yes	<input checked="" type="checkbox"/> No
Grading Permit Number:	
Building Shell Permit Number:	

THE UNDERSIGNED HEREBY CERTIFIES AND AGREES AS FOLLOWS, (1) THAT HE/SHE IS AUTHORIZED TO MAKE THIS APPLICATION; (2) THAT THE INFORMATION IS CORRECT; (3) THAT HE/SHE WILL COMPLY WITH ALL REGULATIONS OF HOWARD COUNTY WHICH ARE APPLICABLE THERETO; (4) THAT HE/SHE WILL PERFORM NO WORK ON THE ABOVE REFERENCED PROPERTY NOT SPECIFICALLY DESCRIBED IN THIS APPLICATION; (5) THAT HE/SHE GRANTS COUNTY OFFICIALS THE RIGHT TO ENTER ONTO THIS PROPERTY FOR THE PURPOSE OF INSPECTING THE WORK PERMITTED AND POSTING NOTICES.

Applicant's Signature: William M. Kinzie Print Name: William M. Kinzie
 Email Address: willmck@mckintek.com Date: 11/6/2017
 Title/Company: _____

Checks Payable to: DIRECTOR OF FINANCE OF HOWARD COUNTY
 PLEASE WRITE NEATLY & LEGIBLY
 -FOR OFFICE USE ONLY-

AGENCY	DATE	SIGNATURE OF APPROVAL
State Highways		
Building Officials		
PSZA (Zoning)		
PSZA (Engineering)		
Health	<u>11/7/17</u>	<u>[Signature]</u>

Is Sediment Control approval required for issuance? Yes No
 CONTINGENCY CONSTRUCTION START

DPZ SETBACK INFORMATION

Front: _____
 Rear: _____
 Side: _____
 Side St.: _____
 All minimum setbacks met? Yes No
 Is Entrance Permit Required? Yes No
 Historic District? Yes No
 Lot Coverage for New Town Zone: _____
 SOP/Red-line approval date: _____

Filing Fee	\$
Permit Fee	\$
Tech Fee	\$
Excise Tax	\$
PSFS	\$
Guaranty Fund	\$
Add'l per Fee	\$
Total Fees	\$
Sub-Total Paid	\$
Balance Due	\$
Check	#

1 2 3 4 5 6 7 8 9 10 11 12 13 14 15 16 feet

1
2
3
4
5
6
7
8
9
10
11
12
13
14
15
16
17
18
19
20
21
22
23
24
25
26
feet

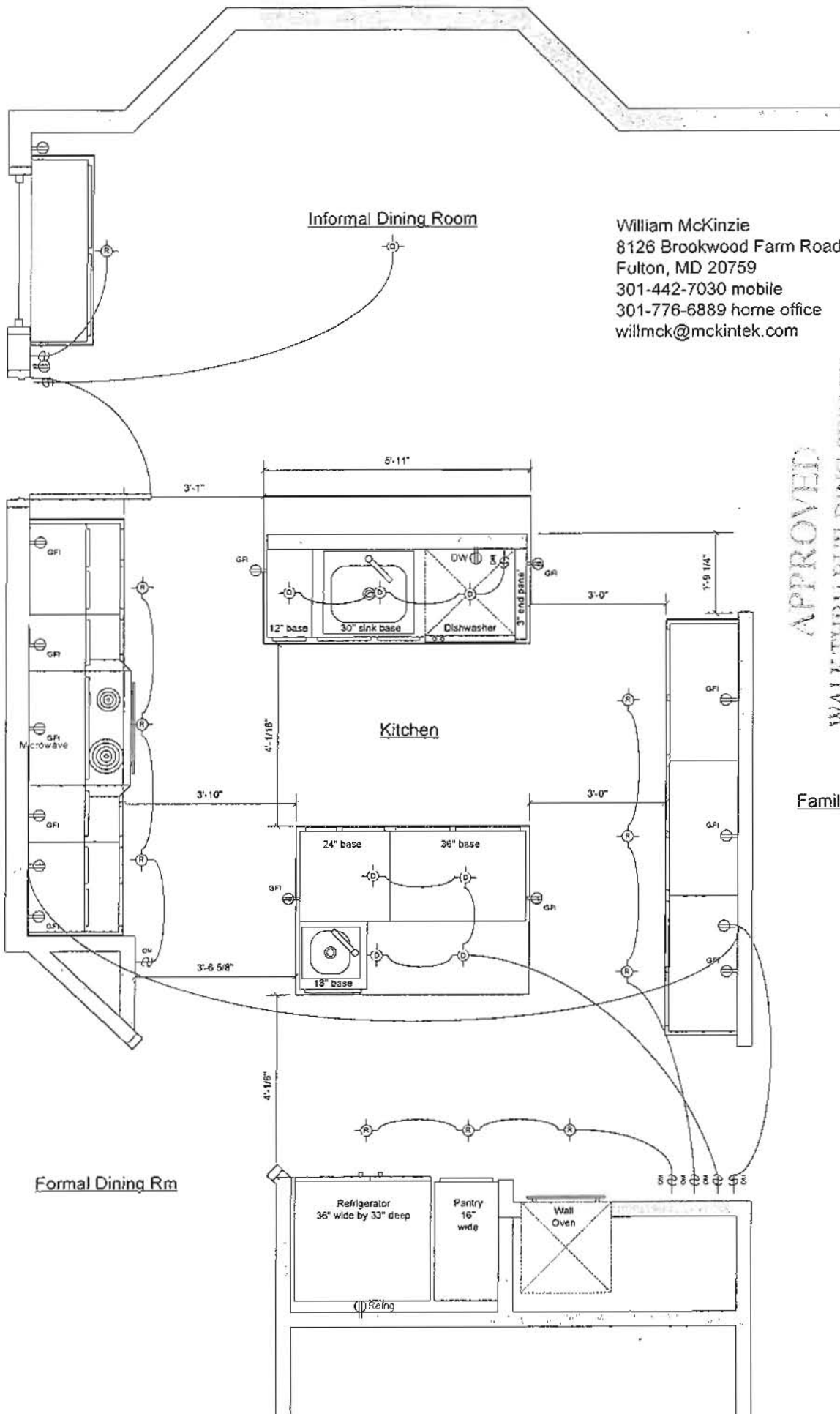

William McKinzie
 8126 Brookwood Farm Road
 Fulton, MD 20759
 301-442-7030 mobile
 301-776-6889 home office
 willmck@mckintek.com

APPROVED
 WALK-TURU BUILDING PERMIT
 BP# A#
 APP. SAN Robert Freeman DATE: 4/17/12
 DESC. OF WORK: Kitchen Remodel

Family Rm