

HOWARD COUNTY
 PERMIT APPLICATION

PERMIT NUMBER
 B00156615

Building Address 15205 OPEN LAND CT
DAYTON MD
 Suite/Apt. #: _____ SDP/WP/Petition #: _____
 Census Tract _____ Subdivision _____
 Section _____ Area _____ Lot _____
 Tax Map _____ Parcel _____ Grid _____
 Zoning _____ Map Coordinates _____ Lot size _____

Property Owner's Name SANTIA CHAIK
 Address 15205 OPEN LAND CT
DAYTON
 City WESTMINSTER State MD Zip Code _____
 Home Phone 2403380490 Work Phone _____
 Applicant's Name & Mailing Address, (if other than stated hereon): _____
 Phone _____ Fax _____

Existing Use SFD
 Proposed Use SFD
 Estimated Construction Cost \$ 14,000
 Description of Work 10' X 24' DECK
W STEPS TO GRADE

Contractor Company TERRAIN DECKING
 Contact Person RAY TAVERNAR
 Address 407 CREST LN
 City WESTMINSTER State MD Zip Code 21157
 License No. 12773
 Phone 4109913532 Fax _____

Occupant or Tenant SAME
 Contact Name _____
 Address _____
 City _____ State _____ Zip Code _____
 Phone _____ Fax _____

Engineer or Architect Company _____
 Contact Person _____
 Address _____
 City _____ State _____ Zip Code _____
 Phone _____ Fax _____

BUILDING DESCRIPTION - COMMERCIAL

BUILDING DESCRIPTION - RESIDENTIAL

Building Characteristics	Utilities
Height: _____	Water Supply: _____ Public _____ Private _____
No. of stories: _____	Sewage Disposal: _____ Public _____ Private _____
Gross area, sq. ft. per floor: _____	Electric Yes <input type="checkbox"/> No <input type="checkbox"/> Gas Yes <input type="checkbox"/> No <input type="checkbox"/>
Use group: _____	Heating System: _____ Electric <input type="checkbox"/> Oil <input type="checkbox"/> Natural Gas <input type="checkbox"/> Propane Gas <input type="checkbox"/>
Construction type: _____ Reinforced Concrete _____ Structural Steel _____ Masonry _____ Wood Frame _____ State Certified Modular _____	Sprinkler system: N/A <input type="checkbox"/> Full _____ Partial _____ Other Suppression _____ # of Heads _____

Building Characteristics	Utilities
SF Dwelling <input checked="" type="checkbox"/> SF Townhouse <input type="checkbox"/> Depth _____ Width _____	Water Supply: _____ Public _____ Private <input checked="" type="checkbox"/>
1st floor: _____	Sewage Disposal: _____ Public _____ Private <input checked="" type="checkbox"/>
2nd floor: _____	Electric Yes <input checked="" type="checkbox"/> No <input type="checkbox"/> Gas Yes <input type="checkbox"/> No <input type="checkbox"/>
Basement: _____ Finished Basement <input type="checkbox"/> Unfinished Basement <input type="checkbox"/> Crawl space <input type="checkbox"/> Slab on Grade <input type="checkbox"/>	Heating System: _____ Electric <input type="checkbox"/> Oil <input type="checkbox"/> Natural Gas <input type="checkbox"/> Propane Gas <input type="checkbox"/>
No. of Bedrooms _____ Height: _____ Multi-family dwellings: No. of efficiency units: _____ No. of 1 BR units: _____ No. of 2 BR units: _____ No. of 3 BR units: _____	Sprinkler system: N/A <input type="checkbox"/> NFPA #13D _____ NFPA #13R _____ Other: _____
Other Structure: _____ Dimensions: _____ Footings: _____ Roof Height: _____ State Certified Modular _____ Manufactured Home _____	

THE UNDERSIGNED HEREBY CERTIFIES AND AGREES AS FOLLOWS: (1) THAT HE/SHE IS AUTHORIZED TO MAKE THIS APPLICATION; (2) THAT THE INFORMATION IS CORRECT; (3) THAT HE/SHE WILL COMPLY WITH ALL REGULATIONS OF HOWARD COUNTY WHICH ARE APPLICABLE THERETO; (4) THAT HE/SHE WILL PERFORM NO WORK ON THE ABOVE REFERENCED PROPERTY NOT SPECIFICALLY DESCRIBED IN THIS APPLICATION; (5) THAT HE/SHE GRANTS COUNTY OFFICIALS THE RIGHT TO ENTER ONTO THIS PROPERTY FOR THE PURPOSE OF INSPECTING THE WORK PERMITTED AND POSTING NOTICES.

Rayan
 Applicant's Signature
OWNER
 Title/Company

RAY TAVERNAR
 Print Name
10/19/05
 Date

Checks payable to: **DIRECTOR OF FINANCE OF HOWARD COUNTY**
 ** PLEASE WRITE NEATLY AND LEGIBLY. **
- FOR OFFICE USE ONLY -

AGENCY	DATE	SIGNATURE APPROVAL
Land Development, DPZ		
State Highway		
Building Official		
Dev. Engineering, DPZ		
Health	<u>10/19/05</u>	<u>[Signature]</u>
Fire Protection		
Is Sediment Control approval required prior to issuance? YES <input type="checkbox"/> NO <input type="checkbox"/>		
CONTINGENCY CONSTRUCTION START: <input type="checkbox"/>		
ONE STOP SHOP: <input type="checkbox"/>		

DPZ SETBACK INFORMATION	PROPERTY ID#
Front: _____	Filing fee \$ _____
Rear: _____	Permit fee \$ _____
Side: _____	Excise tax \$ _____
Side St: _____	Add'l per. fee \$ _____
All minimum setbacks met? YES <input type="checkbox"/> NO <input type="checkbox"/>	TOTAL FEES \$ _____
Is Entrance Permit required? YES <input type="checkbox"/> NO <input type="checkbox"/>	Sub-total paid \$ _____
Historic District? YES <input type="checkbox"/> NO <input type="checkbox"/>	Balance due \$ _____
Lot Coverage for NewTown Zone _____	Check # _____
SDP/Red-line approval date _____	Validation # _____
Accepted by _____	

SEPTIC INFORMATION CHART

INV. OUT OF HOUSE	452.2
INV. IN TANK	451.8
INV. OUT TANK	451.5
TOP OF TANK	452.8
GROUND OVER TANK	455.0
INV. IN PUMP	451.4
GROUND OVER PUMP	454.5
INV. IN DIST. BOX	456.2
GROUND OVER BOX	458.7

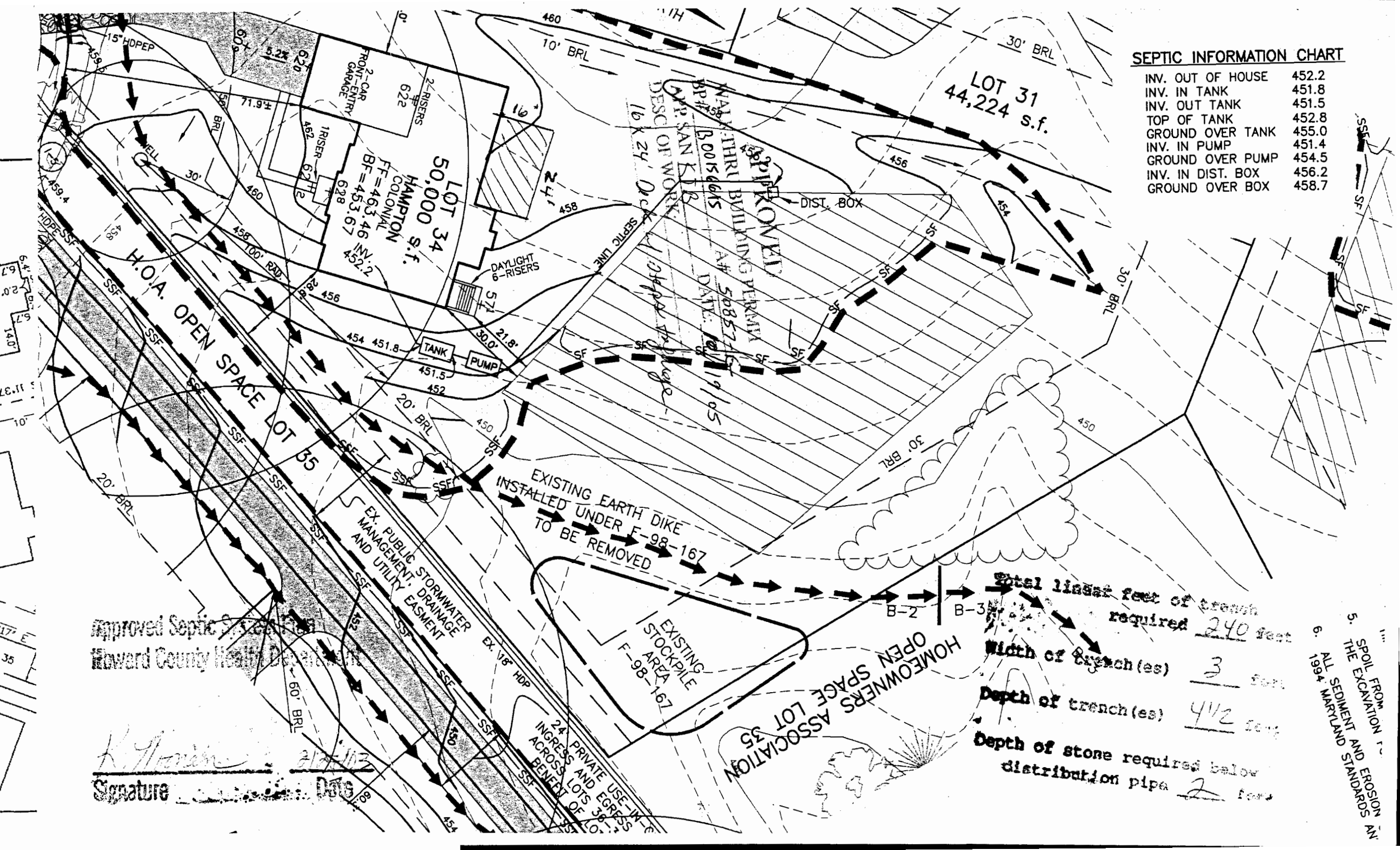

Approved Septic System
Howard County Health Department

K. Moran
Signature

Total linear feet of trench required 240 feet
 Width of trench (es) 3 feet
 Depth of trench (es) 4 1/2 feet
 Depth of stone required below distribution pipe 2 feet

5. SPOIL FROM THE EXCAVATION AND EROSION IN 1994 MARYLAND STANDARDS