

12/21/01
Septic tank replacement
12-1

1/3/02 - PM Check out

1/2/02 Final
PM

ISSUE DATE: 12/13/2001

P 516449

APPROVAL DATE: 1/3/02

A REPAIR

PERMIT INDEXED

ON-SITE SEWAGE DISPOSAL SYSTEM HOWARD COUNTY HEALTH DEPARTMENT BUREAU OF ENVIRONMENTAL HEALTH

Wallace Chaillou IS PERMITTED TO INSTALL ALTER

ADDRESS: 3442 Rosemary Lane PHONE NUMBER: 410-531-2277

SUBDIVISION: Rosemary Estates LOT NUMBER: 7A

ADDRESS: 3442 Rosemary ^{LANE} Estates PROPERTY OWNER: Wallace Chaillou

SEPTIC TANK CAPACITY (GALLONS): 1500

PUMP CHAMBER CAPACITY (GALLONS):

NUMBER OF BEDROOMS: 5

SQUARE FEET PER BEDROOM: 180

LINEAR FEET OF TRENCH REQUIRED: 180

TRENCHES:	Trench to be 2 feet wide. Inlet $3\frac{1}{2}$ - $4\frac{1}{2}$ feet below original grade. Bottom maximum depth $8\frac{1}{2}$ - $9\frac{1}{2}$ feet below original grade. Effective area begins at $4\frac{1}{2}$ feet below original grade. 5 feet of stone below distribution pipe.
LOCATION:	2 TRENCHES IN FRONT YARD 80 + 100 OR 2 - 90'
PURPOSE:	Existing system to be expanded to accommodate 5 bedrooms. To add a 1000 gallon septic tank or abandon existing tank and replace with a 1500 gallon tank. Trench to be added for 2 bedrooms. Call when ground is opened so sanitarian can recommend amount of trench to be installed.

PLANS APPROVED: Brian Baker DATE: 12/13/01

- NOTE: PERMIT VOID AFTER 2 YEARS
- NOTE: CONTRACTOR RESPONSIBLE FOR SCHEDULING A PRE-CONSTRUCTION INSPECTION FOR ALL INSTALLATIONS
- NOTE: WATERTIGHT SEPTIC TANKS REQUIRED
- NOTE: ALL PARTS OF SEPTIC SYSTEM SHALL BE 100 FEET FROM ANY WATER WELL
- NOTE: MANHOLE RISERS REQUIRED ON ALL SEPTIC TANKS AND PUMP CHAMBERS

NEITHER THE HOWARD COUNTY COUNCIL NOR THE HEALTH DEPARTMENT IS RESPONSIBLE FOR THE SUCCESSFUL OPERATION OF ANY SYSTEM PERMITTEE RESPONSIBLE FOR OBTAINING FINAL APPROVAL ON THIS PERMIT CALL 410-313-2640 FOR INSPECTION OF SEPTIC SYSTEM

BUILDING PERMIT SIGNED AND RETURNED 42502
800135653 - AG PROPANE TANK
800139838 - LIVING RM ADDITION

BR00B3258
2 STORY ADDITION 50'x24'

516449

NOT TO SCALE

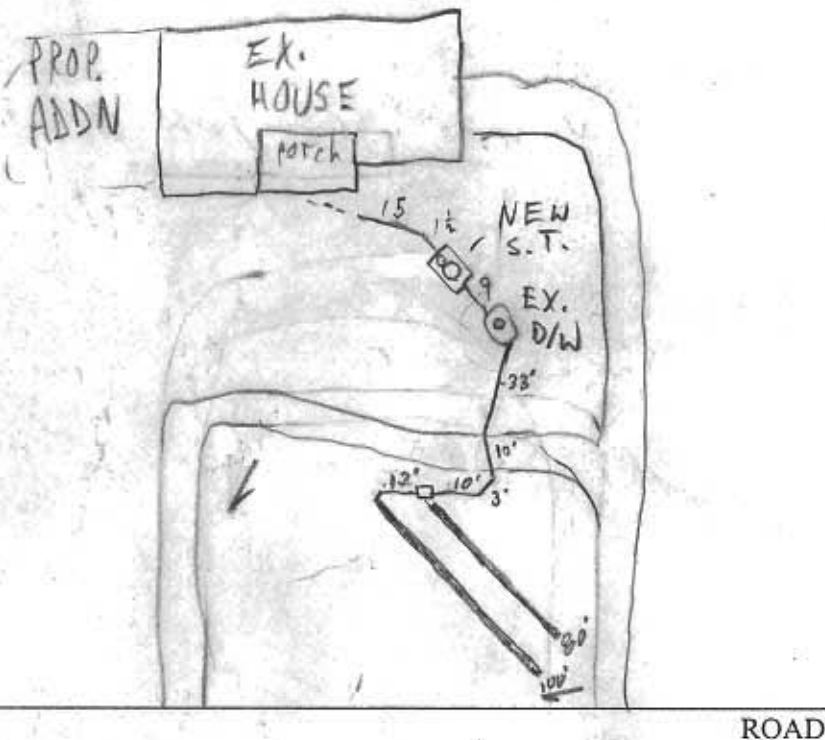

TRENCH/DRAINFIELD DATA		
WIDTH	INLET	BOTTOM
2'	3.5'	8.5'
NUMBER OF TRENCHES		2
TOTAL LENGTH		190'
ABSORPTION AREA		900ft ² +D.W.
DISTRIBUTION BOX LEVEL		1/2s
DISTRIBUTION BOX BAFFLE		1/2s
DISTRIBUTION BOX PORT		NA

SEPTIC TANK DATA	
SEPTIC TANK 1 LEVEL	OK
CAPACITY	1500 GAL
SEAM LOC	TS
TANK LID DEPTH	3'
BAFFLES	✓
BAFFLE FILTER	-
MANHOLE LOC	CTR
6" PORT LOC	FRONT
WATERTIGHT TEST	-
SEPTIC TANK 2 LEVEL	NA
CAPACITY	NA GAL
SEAM LOC	NA
TANK LID DEPTH	NA
BAFFLES	NA
BAFFLE FILTER	NA
MANHOLE LOC	NA
6" PORT LOC	NA
WATERTIGHT TEST	NA

PRE-CONSTRUCTION 12/21/01 CONTRACTOR/OWNER NOT AWARE OF TRENCH REQ'MENT TO BE INSTALLED AFTER REVIEW W/BLDR; EX. D/W FULL, COMPLETE 5BR SYSTEM REQ'D ME/KE

INSTALLATION 1/2/02 - OK TO COVER TO D. BOX, RUN 2 - TRENCHES ON CONTOUR Y/ANNE

AS PER PREVIOUS INSTRUCTIONS - (SRK/50) 1/3/02 OK to cover all work (SC)

FINAL INSPECTOR [Signature] DATE OF APPROVAL 1/3/02

BUILDING PERMIT SIGNED AND RETURNED