

**Bureau of Environmental Health**  
 8930 Stanford Boulevard, Columbia, MD 21045  
 Main: 410-313-2640 | Fax: 410-313-2648  
 TDD 410-313-2323 | Toll Free 1-866-313-6300  
[www.hchealth.org](http://www.hchealth.org)  
 Facebook: [www.facebook.com/hocohealth](http://www.facebook.com/hocohealth)

Maura J. Rossman, M.D., Health Officer

RECEIPT DATE: 1/12/18 **ONSITE SEWAGE DISPOSAL SYSTEM**

5102395A

INSTALLATION APPROVAL DATE: 3/19/18 **PERMIT**  
**SEWER HOUSE CONNECTION**

A \_\_\_\_\_

PROPERTY ADDRESS: 5306 Catalpa Court  
 SUBDIVISION: Walnut Creek LOT: 89 TAX ID: \_\_\_\_\_  
 CONTRACTOR: South Carroll Backhoe EMAIL: scbackhoe@comcast.net  
 CONTRACTOR ADDRESS: 4410 Salem Bottom Road, Westminster, MD 21157 PHONE: 410-596-3618  
 PROPERTY OWNER: NVR Inc. EMAIL: \_\_\_\_\_  
 OWNER ADDRESS: 9720 Patuxent Woods Drive, Columbia, MD 21046 PHONE: 410-379-5956

NUMBER OF BEDROOMS: 5 CONNECTED TO PUBLIC WATER:  YES  NO

|           |  |
|-----------|--|
| LOCATION: | INSTALL 4" SEWER LINE PER APPROVED SITE PLAN.  |
| NOTES:    | Sl Pipe Spec: 4" Silver Line PVC-1120 SCH 40 PR 220 PSI @ 73°F ASTM D-1785 NSF-DW-G * Solvent Welded |

ISSUED BY: Hank Oswald ISSUE DATE: 1/12/18 EXPIRATION DATE: 1/12/19

- NOTE: HOWARD COUNTY BUREAU OF UTILITIES APPROVAL OF GRINDER PUMP INSTALLATION IS REQUIRED PRIOR TO SEPTIC PERMIT APPROVAL
- NOTE: CONTRACTOR MUST SCHEDULE AN INSPECTION AND GAIN APPROVAL OF ALL COMPONENTS PRIOR TO COVERING
- NOTE: AN ELECTRICAL PERMIT IS REQUIRED FOR INSTALLATION OF ANY ELECTRICAL COMPONENTS OF THE SYSTEM

**NEITHER THE HOWARD COUNTY COUNCIL NOR THE HEALTH DEPARTMENT IS RESPONSIBLE FOR THE SUCCESSFUL OPERATION OF ANY SYSTEM. PERMITTEE RESPONSIBLE FOR OBTAINING FINAL APPROVAL ON THIS PERMIT. CALL 410-313-1771 FOR INSPECTION OF SEPTIC SYSTEM.**

NOT TO SCALE

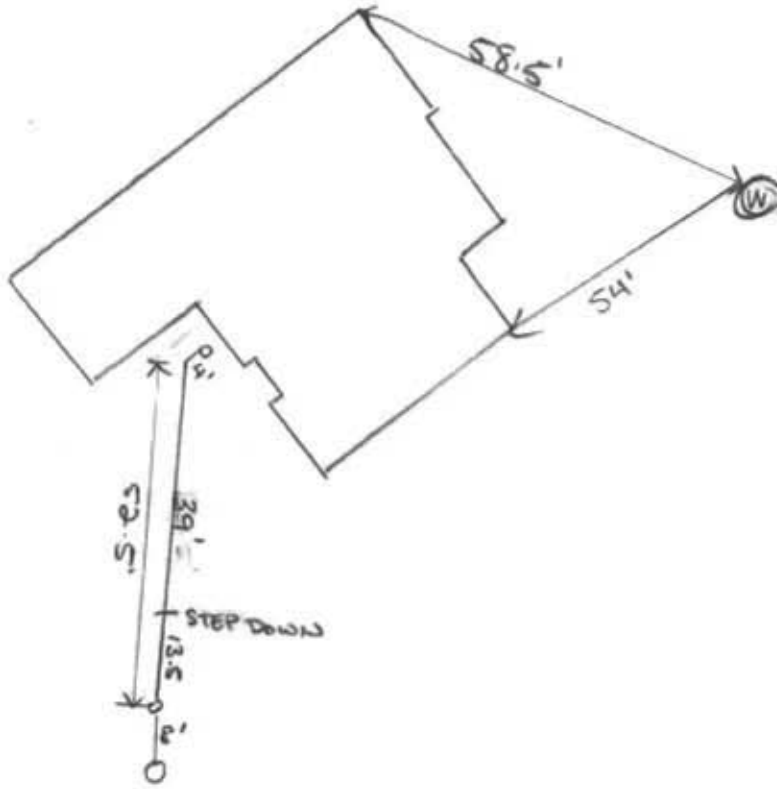

**TRENCH/DRAINFIELD DATA**

WIDTH      INLET      BOTTOM

NUMBER OF TRENCHES \_\_\_\_\_

TOTAL LENGTH \_\_\_\_\_

ABSORPTION AREA \_\_\_\_\_

DISTRIBUTION BOX LEVEL \_\_\_\_\_

DISTRIBUTION BOX BAFFLE \_\_\_\_\_

DISTRIBUTION BOX PORT \_\_\_\_\_

**SEPTIC TANK DATA**

**SEPTIC TANK 1 LEVEL** \_\_\_\_\_

MANUFACTURER \_\_\_\_\_

CAPACITY \_\_\_\_\_ GAL

SEAM LOC \_\_\_\_\_

TANK LID DEPTH \_\_\_\_\_

BAFFLES \_\_\_\_\_

BAFFLE FILTER \_\_\_\_\_

MANHOLE LOC \_\_\_\_\_

6" PORT LOC \_\_\_\_\_

WATERTIGHT TEST \_\_\_\_\_

SLOTTED \_\_\_\_\_

DATE ON LID \_\_\_\_\_

**PUMP/SEPTIC TANK LEVEL** \_\_\_\_\_

MANUFACTURER \_\_\_\_\_

CAPACITY \_\_\_\_\_ GAL

SEAM LOC \_\_\_\_\_

TANK LID DEPTH \_\_\_\_\_

BAFFLES \_\_\_\_\_

BAFFLE FILTER \_\_\_\_\_

MANHOLE LOC \_\_\_\_\_

6" PORT LOC \_\_\_\_\_

WATERTIGHT TEST \_\_\_\_\_

SLOTTED \_\_\_\_\_

DATE ON LID \_\_\_\_\_

Catalpa Court

ROAD NAME

PRE-CONSTRUCTION:

\_\_\_\_\_

\_\_\_\_\_

\_\_\_\_\_

\_\_\_\_\_

INSTALLATION: 2/2/18 Installed sewer line and connected to grinder pit. Reinspect for SHe (to) 3/19/18 startup from DPW mail via email on grinder start-up.

\_\_\_\_\_

\_\_\_\_\_

\_\_\_\_\_

FINAL INSPECTOR

*K. Kelly*

DATE OF APPROVAL

3/19/18

## Wolf, Kevin

---

**From:** Bozzell, Duane  
**Sent:** Thursday, March 15, 2018 3:15 PM  
**To:** Miscbilling  
**Cc:** Hart, Amy; Rocco, Anthony; Martin, Sharhonda; Williams, Jeffrey; Bozzell, Duane; Bernard, Dana; Wolf, Kevin; Collins, Sarah; Tuder, Matt; Cagle, Clint; Srour, Matthew; Anastasia, James  
**Subject:** U&O Release (Street Address)

On the morning of 3-14-2018 observed the start-up of a Sewage Grinder Pump at the Walnut Creek Shared Septic System:

Walnut Creek, Contract #4773  
Builder Name Homes, Lot # 89  
5306 Catapla court  
Ellicott City, MD 21042

The Sewage Grinder Pump test was successful; the Bureau of Utilities releases its hold on this property for U&O.

*Thank You.*

*Duane Bozzell*

*DPW-Bureau of utilities*  
*Phone: (410)313-4900*  
*Fax: (410)313-4989*

