

LAYOUT 5/29/07 INSP 4 _____
INSP 2 5/29/07 INSP 5 _____
INSP 3 5/30/07 INSP 6 _____

ISSUE DATE: 5/8/07

PERMIT

P 526689

APPROVAL DATE: 5/30/2007

A 525589

Logged Into Permit Manager
ON-SITE SEWAGE DISPOSAL SYSTEM
HOWARD COUNTY HEALTH DEPARTMENT
BUREAU OF ENVIRONMENTAL HEALTH

IS PERMITTED TO INSTALL ALTER

ADDRESS: _____ PHONE NUMBER: _____

SUBDIVISION: _____ LOT NUMBER: _____

ADDRESS: 1390 Route 97 RA PROPERTY OWNER: Jill Sears

SEPTIC TANK CAPACITY (GALLONS): 1500 OUTLET BAFFLE FILTER REQUIRED

PUMP CHAMBER CAPACITY (GALLONS): N/A COMPARTMENTED TANK REQUIRED

NUMBER OF BEDROOMS: 4 Trenches 3' Wide

SQUARE FEET PER BEDROOM: _____ Inlet 4'-4.5'

LINEAR FEET OF TRENCH REQUIRED: 125 Bottom 8'
2-62.5' Trenches

TRENCHES:	Trench to be _____ feet wide. Inlet _____ feet below original grade. Bottom maximum depth _____ feet below original grade. Effective area begins at _____ feet below original grade. _____ feet of stone below distribution pipe.
LOCATION:	
NOTES:	

PLANS APPROVED: GAC DATE: 5/8/2007

- NOTE: PERMIT VOID AFTER 2 YEARS
- NOTE: CONTRACTOR RESPONSIBLE FOR SCHEDULING A PRE-CONSTRUCTION INSPECTION FOR ALL INSTALLATIONS
- NOTE: WATERTIGHT SEPTIC TANKS REQUIRED
- NOTE: ALL PARTS OF SEPTIC SYSTEM SHALL BE 100 FEET FROM ANY WATER WELL
- NOTE: MANHOLE RISERS REQUIRED ON ALL SEPTIC TANKS AND PUMP CHAMBERS UNLESS SPECIFICALLY AUTHORIZED

NEITHER THE HOWARD COUNTY COUNCIL NOR THE HEALTH DEPARTMENT IS RESPONSIBLE FOR THE SUCCESSFUL OPERATION OF ANY SYSTEM PERMITTEE RESPONSIBLE FOR OBTAINING FINAL APPROVAL ON THIS PERMIT CALL 410-313-2640 FOR INSPECTION OF SEPTIC SYSTEM

NOT TO SCALE

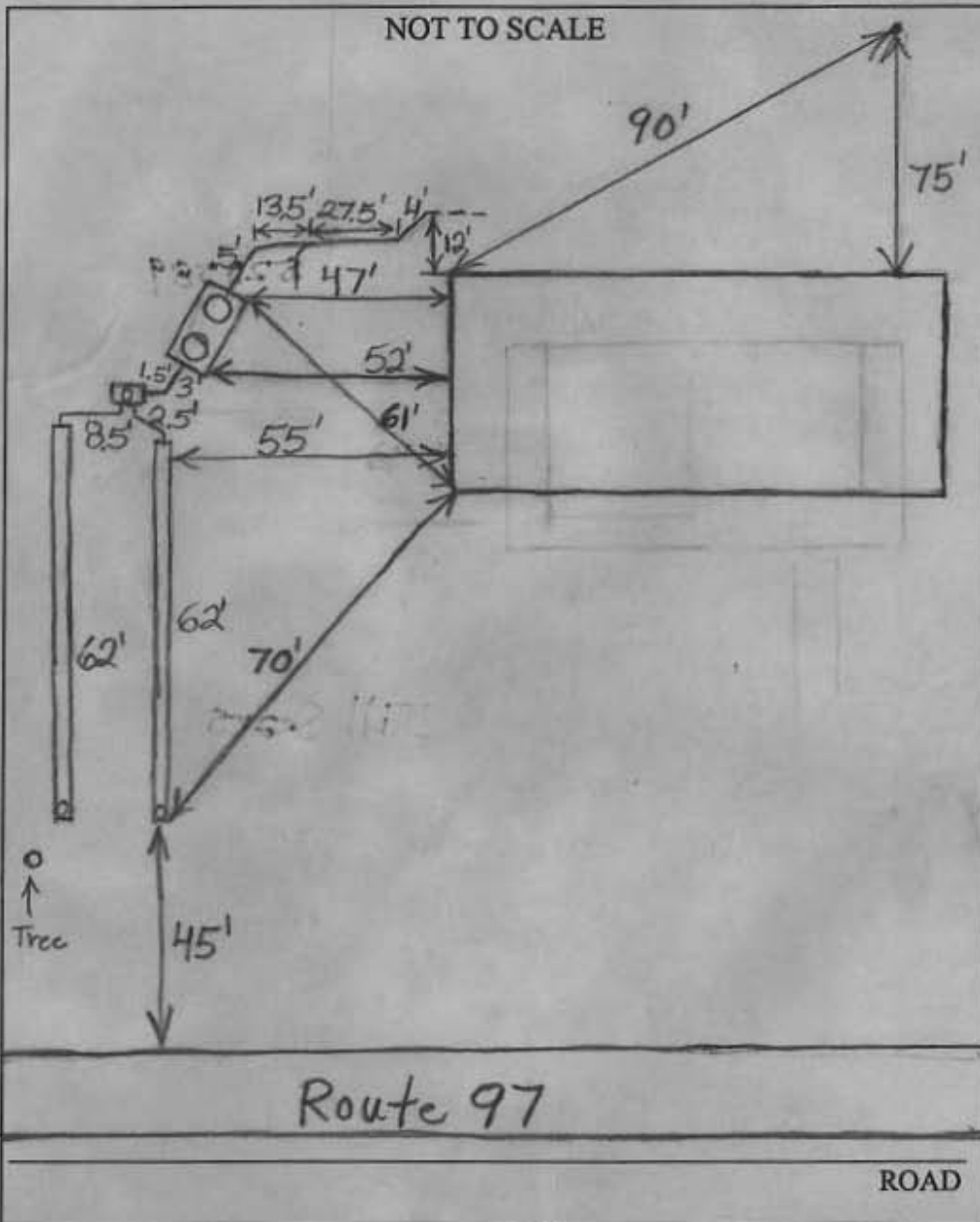

TRENCH/DRAINFIELD DATA		
WIDTH	INLET	BOTTOM
3'	4'-4.5'	8'-8.5'
NUMBER OF TRENCHES		2
TOTAL LENGTH		124'
ABSORPTION AREA		372+Sidewall
DISTRIBUTION BOX LEVEL		Levelers
DISTRIBUTION BOX BAFFLE		Yes
DISTRIBUTION BOX PORT		Yes

SEPTIC TANK DATA	
SEPTIC TANK 1 LEVEL	Yes
CAPACITY	1500 GAL
SEAM LOC	Top
TANK LID DEPTH	1.5'-2'
BAFFLES	Yes
BAFFLE FILTER	No
MANHOLE LOC	Front+Rear
6" PORT LOC	None
WATERTIGHT TEST	No
SEPTIC TANK 2 LEVEL	N/A
CAPACITY	GAL
SEAM LOC	
TANK LID DEPTH	
BAFFLES	
BAFFLE FILTER	
MANHOLE LOC	
6" PORT LOC	
WATERTIGHT TEST	

PRE-CONSTRUCTION 5/29/07 Set tank at least 10' from proposed addition. Install 2 - 62.5' trenches on contour directly uphill of large evergreen that is close to proposed addition. Stay 100' from neighbor's well. Well is located in small shed near road. (BB)

5/29/07 Tank set. (BB)

5/30/07 Started bottom trench. House connection made. Old tank and septic system pumped out and filled in. (BB)

5/30/07 System finished. O.K. to cover. (BB)

FINAL INSPECTOR B. Baper

DATE OF APPROVAL 5/30/2007