



HOWARD COUNTY HEALTH DEPARTMENT

61528

DATE
9/1/17

PS

Received From

Tyler Septic Clean PHONE # 410-95-5070

For

Tank replacement - 12408
Person Biaver Rd.

CASH

CHECK

NO.

58093 One hundred fifty five Dollars

\$ 165.00

Received By

G King

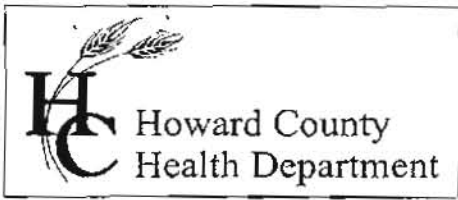

Bureau of Environmental Health
 8930 Stanford Boulevard, Columbia, MD 21045
 Main: 410-313-2640 | Fax: 410-313-2648
 TDD 410-313-2323 | Toll Free 1-866-313-6300
www.hchealth.org
 Facebook: www.facebook.com/hocohealth

Maura J. Rossman, M.D., Health Officer

RECEIPT DATE: 9/19/17

ONSITE SEWAGE DISPOSAL SYSTEM

P 561528

INSTALLATION
 APPROVAL DATE: 10/19/17

PERMIT
TANK REPLACEMENT

A _____

PROPERTY ADDRESS: 12408 Benson Branch Road

SUBDIVISION: Woodmark

LOT: 4

TAX ID: 03-304876

CONTRACTOR: Fogle's Septic Clean Inc.

EMAIL: kim@foglesinc.com

CONTRACTOR ADDRESS: 580 Obrecht Road, Sykesville, MD 21784

PHONE: 410-795-5670

PROPERTY OWNER: Noel Longuemare

EMAIL: _____

OWNER ADDRESS: 12408 Benson Branch Road, Ellicott City, MD 21043

PHONE: 410-382-6828

BAT UNIT MODEL: _____

PUMP SIZE: N/A

PUMP TANK CAPACITY: N/A

NUMBER OF BEDROOMS: _____

SEPTIC TANK SIZE: _____

DRAINFIELD SIZE/TYPE: _____

LOCATION:	Tanks Not Replaced. Ex. S.T. sealed @ seam by / at contractor.
NOTES:	* Must dig perc test next to Ex. Drq with 4' below bottom to verify an adequate 4' treatment zone.

ISSUED BY: K. W. LF

ISSUE DATE: 9/21/17

EXPIRATION DATE: _____

NOTE: CONTRACTOR MUST SCHEDULE AN INSPECTION AND GAIN APPROVAL OF ALL COMPONENTS PRIOR TO COVERING

NOTE: AN ELECTRICAL PERMIT IS REQUIRED FOR INSTALLATION OF ANY ELECTRICAL COMPONENTS OF THE SYSTEM

NOTE: MDE RECOMMENDS SEPTIC TANKS, BAT, AND OTHER PRETREATMENT UNITS BE PUMPED AT A FREQUENCY ADEQUATE TO ENSURE THAT SOLIDS ARE NOT DISCHARGED TO THE DISPOSAL AREA

NEITHER THE HOWARD COUNTY COUNCIL NOR THE HEALTH DEPARTMENT IS RESPONSIBLE FOR THE SUCCESSFUL OPERATION OF ANY SYSTEM.

PERMITTEE RESPONSIBLE FOR OBTAINING FINAL APPROVAL ON THIS PERMIT.

CALL 410-313-1771 FOR INSPECTION OF SEPTIC SYSTEM.

NOT TO SCALE

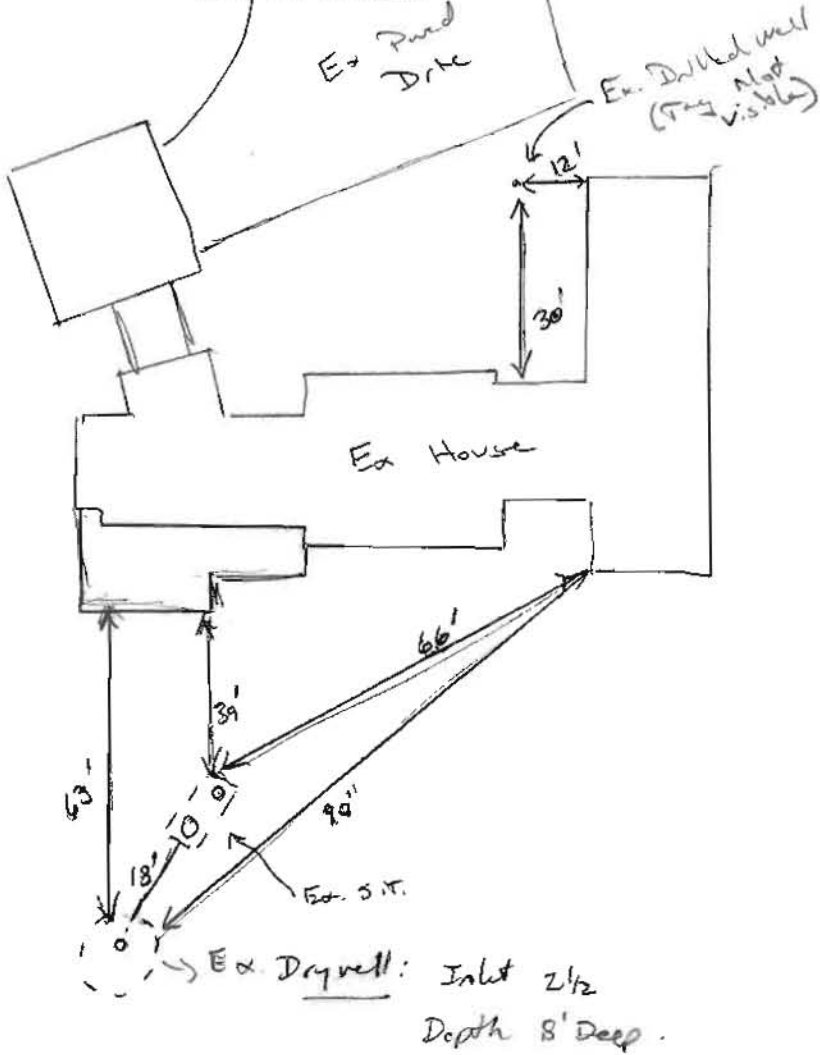

ROAD NAME

TRENCH/DRAINFIELD DATA

WIDTH	INLET	BOTTOM
NUMBER OF TRENCHES		
TOTAL LENGTH		
ABSORPTION AREA		
DISTRIBUTION BOX LEVEL		
DISTRIBUTION BOX BAFFLE		
DISTRIBUTION BOX PORT		

SEPTIC TANK DATA

SEPTIC TANK I LEVEL	Yes
MANUFACTURER	N/A
CAPACITY	1250 GAL
SEAM LOC	mid
TANK LID DEPTH	2'
BAFFLES	Yes
BAFFLE FILTER	N/A
MANHOLE LOC	Rear
6" PORT LOC	Front
WATERTIGHT TEST	not performed
SLOTTED	no
DATE ON LID	N/A

PUMP/SEPTIC TANK LEVEL

MANUFACTURER	
CAPACITY	GAL
SEAM LOC	
TANK LID DEPTH	
BAFFLES	
BAFFLE FILTER	
MANHOLE LOC	
6" PORT LOC	
WATERTIGHT TEST	
SLOTTED	
DATE ON LID	

PRE-CONSTRUCTION:

INSTALLATION: 10/19/17 Existed midseam sealed by contractor (Hydrate cement) Not verified by H.D. No watertight test performed. Drywell empty. Replaced backline w/ sch 40, new outlet baffle and 6" stub pipe on Drywell. Future building permit will require H₂O test on tank or replacement of new top seam tank (KID)

FINAL INSPECTOR

DATE OF APPROVAL

10/19/17

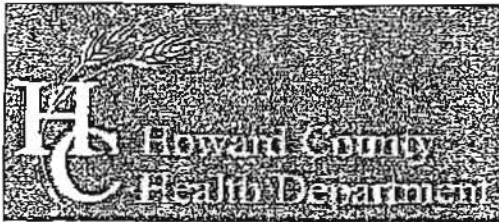

Bureau of Environmental Health

8930 Stanford Boulevard, Columbia, MD 21045

Main: 410-313-2640 | Fax: 410-313-2648

TDD 410-313-2323 | Toll Free 1-866-313-6300

www.hchealth.org

Facebook: www.facebook.com/hocohealth

Twitter: HowardCoHealthDep

Dr. Maura J. Rossman, M.D., Health Officer

INFORMATION FORM - SEPTIC SYSTEM REPAIR/UPGRADE

Reason for Request:

- Reason for Request:
- [] Failing System
- [] System relocation for proposed addition
- [] System upgrade for proposed addition
- [] Inadequate treatment zone
- [x] Leaking collapsed septic tank
- [] Collapsed drywell

Has the septic tank been pumped within the last month?

- Has the septic tank been pumped within the last month?
- [] Yes Date pumped:
- [x] No

Was a visual inspection of the septic tank and/or drain fields conducted?

- Was a visual inspection of the septic tank and/or drain fields conducted?
- [] Yes Explain observations:
- [] No

Existing system design

- Existing system design
- [x] Drywell
- [] Trench
- [] Mound
- [] Unknown
- [] Other:

Was a visual inspection of the sewage line conducted?

- Was a visual inspection of the sewage line conducted?
- [] Yes
 - Blockage leading to the tank
 - [] Yes. Explain:
 - [] No
 - Blockage leading to the field
 - [] Yes Explain:
 - [] No
- [] No

Is discharge surfacing on the ground?

- Is discharge surfacing on the ground?
- [] Yes
- [x] No

Additional Comments:

*For REPAIRS, are the owners proposing, or do they plan to add in the future, any additions or modifications to the property, i.e. pools, living space additions, garages, etc? This information must be disclosed at the time of this application. The Health Department will not be able to accommodate requests in the field for property modifications unrelated to the repair request. Such requests may require an additional fee, testing, and submittal of a Percolation Certification Plan, if the property does not meet current Code and Regulation.

Septic Contractor: Fagle's Septic Contractor's Phone: 410-795-5670
Contractor's Address: 580 Obrecht Rd Sykesville, MD 21784
Property Address: 12408 Benson Branch Rd County file: #
Subdivision: Woodmark Lot: 4 Year Built: 1978
Owner's Name: Noel Longwemare Owner's Phone: 410-382-6828
Name of previous owners: George Collins Existing bedrooms: 4
Proposed bedrooms:

Has this request been previously discussed with a Sanitarian? (Name):
Public Sewer available/nearby:

*A Sanitarian will be in contact within three business days, depending upon the urgency of the situation, to coordinate the scheduling/review of the repair or upgrade.

Prior to scheduling inspections, scaled plans should be submitted to clarify the nature of the addition.

Print out a copy of Real Property Data via Dept. of Taxation website Indexed file found

If public sewer may be nearby, verify whether sewer is technically "available" through the Bureau of Engineering.

If sewer is available and the property is within the Metropolitan District, connection to sewer is required: If the owner believes reason for exemption exists, the owner should justify the request in writing.

If soil/site conditions are limited and sewer and/or Metro District status is not conducive to connection, the Sanitarian may recommend pursuit of Emergency Sewer Extension or Emergency Metro District Inclusion. The Owner should contact the Bureau of Utilities for details.

No permit is to be issued nor inspection to be scheduled without prior fee collection at the office unless an emergency situation exists. The contractor is to notify office of the emergency situation as soon as possible.