

APPLICATION

PERCOLATION TESTING

A 45335
P _____

HOWARD COUNTY HEALTH DEPARTMENT
BUREAU OF ENVIRONMENTAL HEALTH
P.O. BOX 476 ELLICOTT CITY, MARYLAND 21043
TELEPHONE: 461-9933

DISTRICT _____
DATE 12/12/89

TO: THE COUNTY HEALTH OFFICER
ELLICOTT CITY, MARYLAND

I HEREBY APPLY FOR THE NECESSARY TEST IN ORDER TO CONSTRUCT (OR RECONSTRUCT) A SEWAGE DISPOSAL SYSTEM.

PROPERTY OWNER SARAH STOUT

ADDRESS 15802 OLD FREDERICK RD WOODBINE, MD 21797 PHONE (301) 403-4836

PROSPECTIVE BUYER - N/A

ADDRESS _____ PHONE _____

PROPERTY LOCATION: Hong

SUBDIVISION STOUT PROPERTY LOTS 4-7 LOT NO. \$ 2

ROAD AND DESCRIPTION SOUTH SIDE OF OLD FREDERICK RD 1300' EAST
OF ROUTE 94 15807 Old Frederick Road

TAX MAP 7 PARCEL # 3

SIZE OF LOT 3.26 Ac. TYPE BLDG. SINGLE
(SINGLE FAMILY DWELLING OR COMMERCIAL)

THE SYSTEM INSTALLED UNDER THIS APPLICATION IS ACCEPTABLE ONLY UNTIL PUBLIC FACILITIES BECOME AVAILABLE. I FULLY UNDERSTAND THE FEE CONNECTED WITH THE FILING OF THIS PERC TEST APPLICATION IS NON-REFUNDABLE UNDER ANY CIRCUMSTANCES. I ALSO AGREE TO COMPLY WITH ALL M.O.S.H.A. REQUIREMENTS IN TESTING THIS LOT. Sarah Stout
(SIGNATURE OF APPLICANT)

APPROVED BY _____ FOR _____ DATE _____

REJECTED BY _____ FOR _____ DATE _____

HOLD PENDING FURTHER TESTS _____ DATE _____

REASONS FOR REJECTION OR HOLDING PERC OK - HOLD FOR PLAT MR 1/12/90

THIS IS NOT A PERMIT

Lot 5
A 45335

1) 2) 3) 4)
SOIL PROFILE

3 2
org clay loam
org, yel brn red silt
5-10% frags

10-11

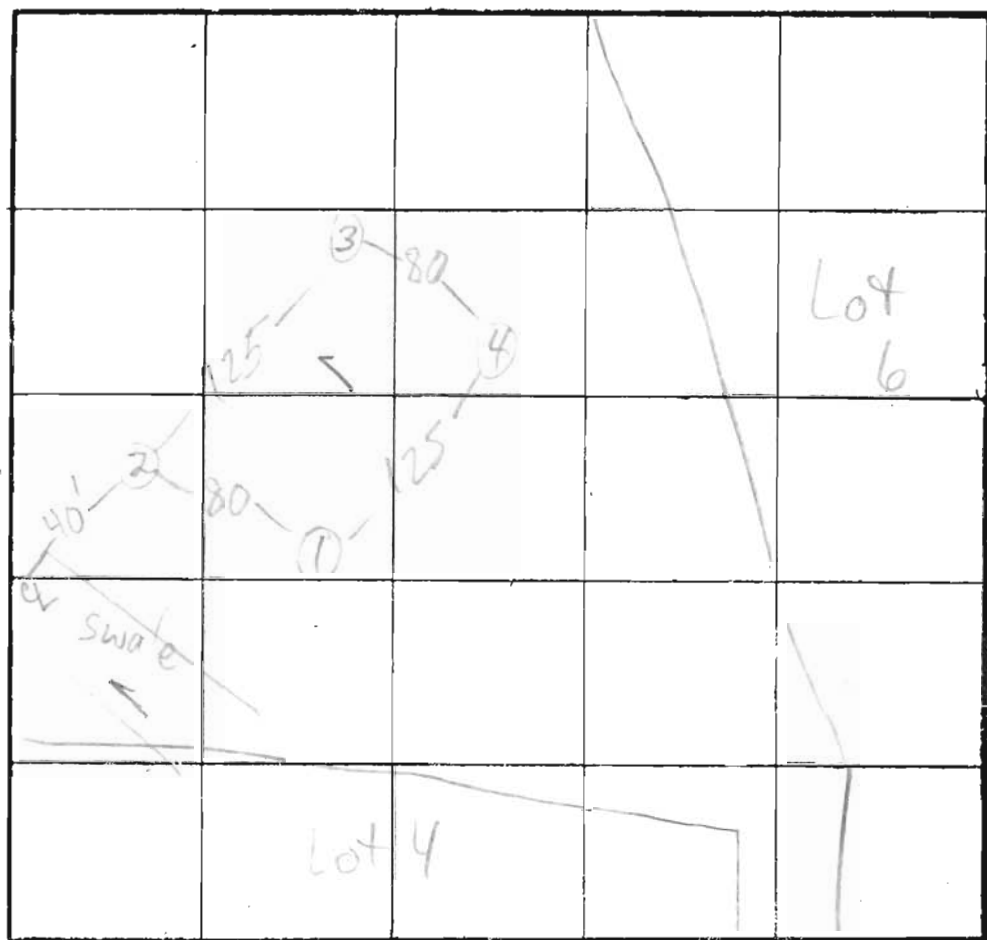

1) 4) H1

2) 3) L0

$\bar{x} = 11$
210 BR
Inlet 3 1/2'
Bottom 5'

OLD FRED RD INDICATE NORTH - NAME ADJOINING ROADWAY AS BASE LINE.

DATE	TEST NO.	DEPTH	PRE-WET		TEST - 1" DROP		TIME	
			START	STOP	START	STOP		
1/12/90	1 S	7 1/2	10:21	10:26	10:32	10:36	10:24	
	1 V	11	see profile					
	2 S	5	10:23	10:26	10:26	10:30	4	
	2 V	10	sim to 1) 10% frags 4' clay					
	3 S	4 1/2	10:32	10:33	10:33	10:38	5	
	3 V	11	sim to 1) 15% frags 3 1/2' clay					
	4 V	9	OK sim to 1) 20% frags 3' clay					

HARD
BOT

01-12-10/9

REMARKS HOLES DUG PER PLAT - SHALLOW ONLY

TYPE OF SOIL _____

TESTED BY M. Riffin ALSO PRESENT Dave