

1-14-81. Need 14'-15' Visual F

APPLICATION

A 16338

SEWAGE DISPOSAL TESTING

P

MARYLAND STATE DEPARTMENT OF HEALTH

HOWARD COUNTY *Septic Tank - 3 bedroom - 1000 gal.* ELLICOTT CITY

4 " - 1250 gal.
Dry Well - 100 sq. ft. absorbent sidewall area per bedroom to begin below the first 3 ft.

DISTRICT 5

DATE 2/28/71

of non-porous soil. Maximum depth permitted for dry well is 11 ft. below original grade.

Locate dry well 150 ft. from front property line and 66 ft. from left side line as seen from Reservoir Rd.

Set mat. 3 ft. of total depth 7 ft. max. below orig. grade B.O.G.

TO: THE COUNTY HEALTH OFFICER
ELLICOTT CITY, MARYLAND

I, HEREBY, APPLY FOR THE NECESSARY TESTS IN ORDER TO CONSTRUCT (OR RECONSTRUCT) A SEWAGE DISPOSAL SYSTEM.

PROPERTY OWNER Henry J. Lillienfield

Any questions call:

ADDRESS Reservoir Road, Fulton, Md.

PHONE Purdum & Heschke
HO 5-1635

PROPERTY LOCATION:

SUBDIVISION _____ LOT NO. 2, Blk. A

ROAD AND DESCRIPTION Reservoir Road

OCCUPANT _____ PHONE _____

PERSON TO CONSTRUCT SYSTEM _____

ADDRESS _____ PHONE _____

SIZE OF LOT 60,000 sq. ft. TYPE BLDG. 3 or 4

NUMBER OF BEDROOMS

(Single Fmly. Dwlg.)

IF NOT SINGLE RESIDENCE DESCRIBE _____

SIGNATURE OF APPLICANT /s/ Ron Carter

APPROVED BY Robert V. Tove FOR Dry Well DATE 2/23/72
(KIND OF SYSTEM)

REJECTED BY _____ FOR _____ DATE _____
(KIND OF SYSTEM)

HOLD PENDING FURTHER TESTS _____ DATE _____

REASONS FOR REJECTION OR HOLDING _____

THIS IS NOT A PERMIT

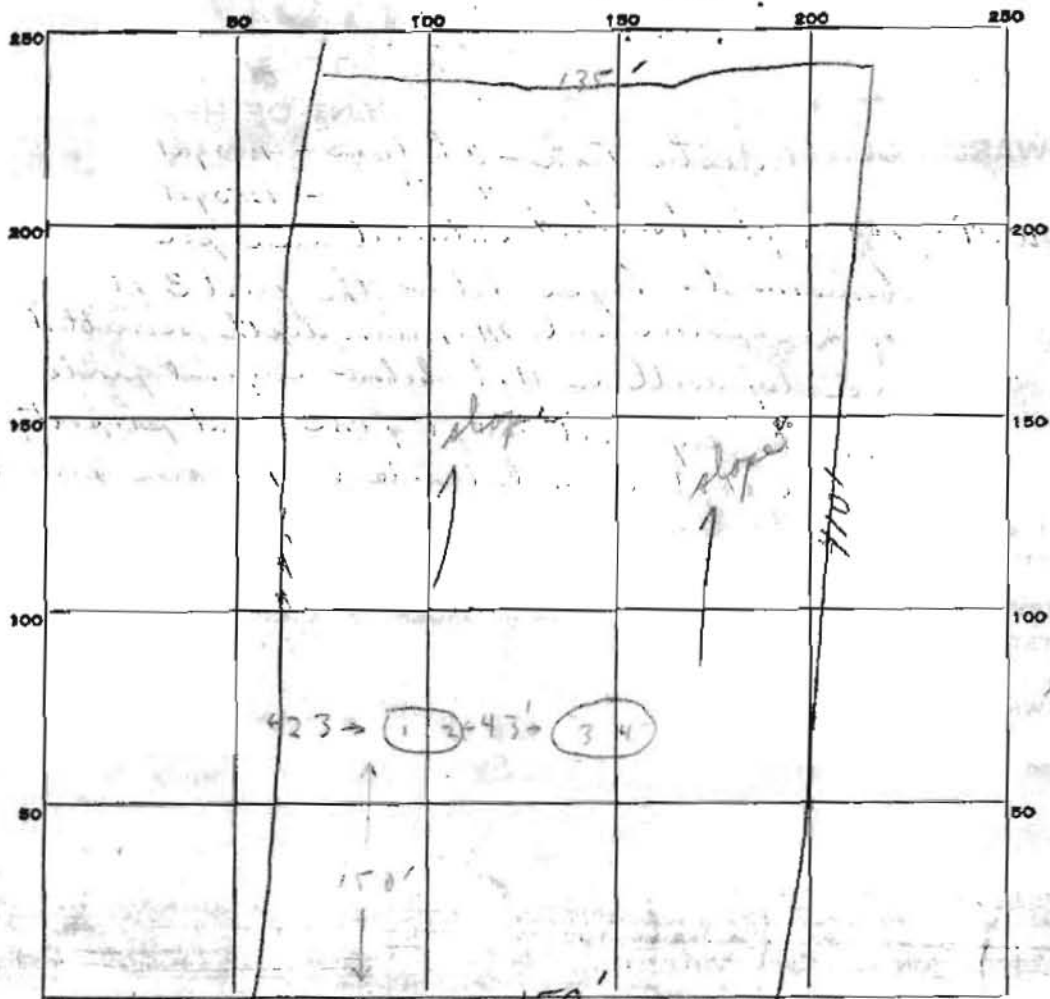

INDICATE NORTH. - NAME ADJOINING ROADWAY AS BASE LINE.

Reservoir Road

DATE	TEST NO.	DEPTH	PRE-WET		TEST - 1" DROP		TIME
			START	STOP	START	STOP	
10/2/72	1	11'	10:36	10:39	10:39	10:43	4 min
	2	6 1/2'	10:44	10:49	10:49	10:59	10 min
	3	3'	10:50	10:53	10:53	10:58	5 min
	4	10'	11:00	11:02	11:02	11:08	6 min

SOIL AUGER FINDING _____

TESTED BY H.S.

REMARKS Use slope 3+4 (per test)

APPLICATION

A 16338

SEWAGE DISPOSAL TESTING

P _____

MARYLAND STATE DEPARTMENT OF HEALTH

HOWARD COUNTY *Septic Tank - 3 bedroom - 1000 gal.
4 " - 1250 gal.*

ELLCOTT CITY

DISTRICT 5

DATE 9/28/71

Dry Well - 100 sq ft absorbent sidewall area per bedroom to begin below the first 3 ft of non-porous soil. Maximum depth permitted for dry well is 11 ft below original grade. Locate dry well 150 ft from front property line and 66 ft from left side line as seen from Reservoir Rd.

TO: THE COUNTY HEALTH OFFICER
ELLCOTT CITY, MARYLAND

I, HEREBY, APPLY FOR THE NECESSARY TESTS IN ORDER TO CONSTRUCT (OR RECONSTRUCT) A SEWAGE DISPOSAL SYSTEM.

PROPERTY OWNER Henry J. Lilienfield

ADDRESS Reservoir Road, Fulton, Md. PHONE Purdum & Heschke
HO 5-1635

Any questions call:
Purdum & Heschke
HO 5-1635

PROPERTY LOCATION:

SUBDIVISION _____ LOT NO. 2, Blk. A

ROAD AND DESCRIPTION Reservoir Road

OCCUPANT _____ PHONE _____

PERSON TO CONSTRUCT SYSTEM _____

ADDRESS _____ PHONE _____

SIZE OF LOT 60,000 sq. ft. TYPE BLDG. 3 or 4

NUMBER OF BEDROOMS

IF NOT SINGLE RESIDENCE DESCRIBE _____ (Single Fmly. Dwllg.)

SIGNATURE OF APPLICANT /s/ Ron Carter

APPROVED BY Robert V. Tamm FOR Dry Well DATE 2/23/72
(KIND OF SYSTEM)

REJECTED BY _____ FOR _____ DATE _____
(KIND OF SYSTEM)

HOLD PENDING FURTHER TESTS _____ DATE _____

REASONS FOR REJECTION OR HOLDING _____

THIS IS NOT A PERMIT

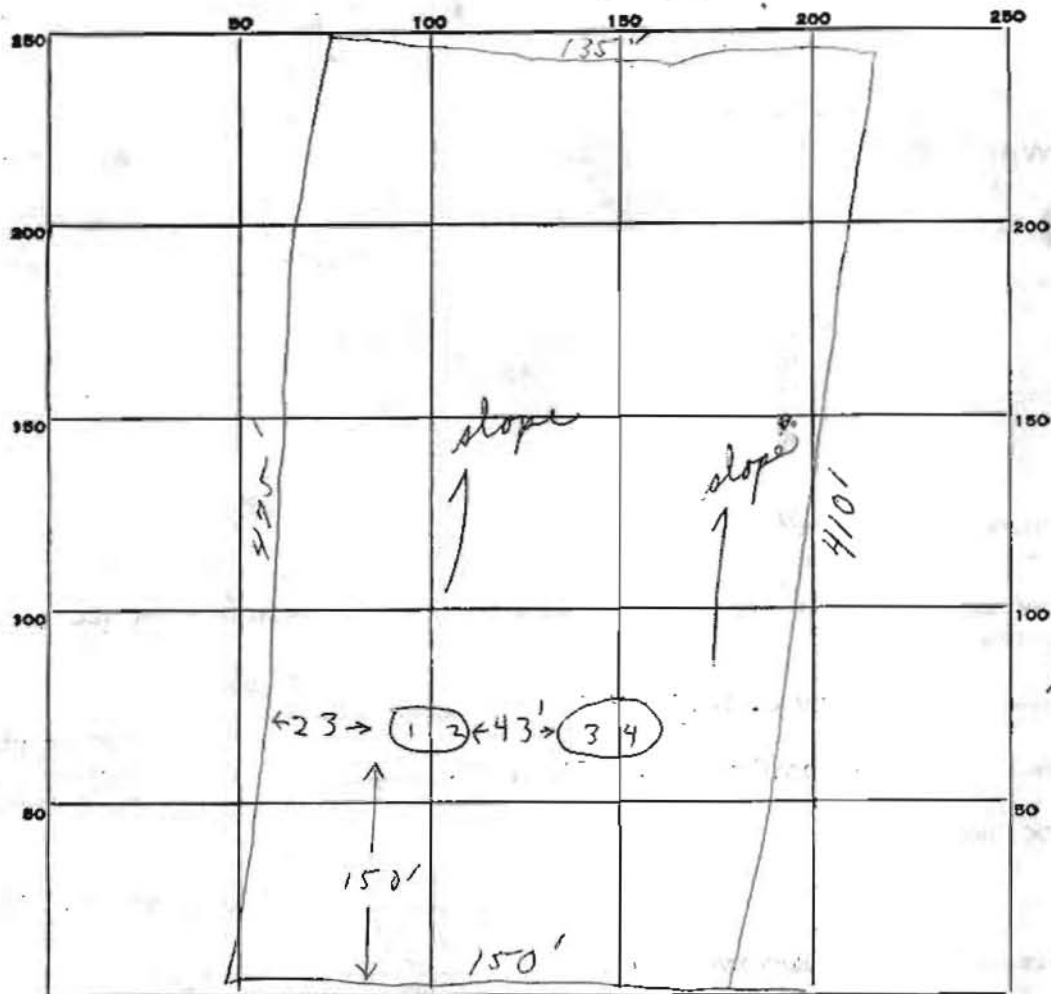

INDICATE NORTH. - NAME ADJOINING ROADWAY AS BASE LINE.

Reservoir Road

DATE	TEST NO.	DEPTH	PRE-WET		TEST - 1" DROP		TIME
			START	STOP	START	STOP	
10/21/77	1	11'	1036	1039	10:39	10:43	4 min
	2	6 1/2'	1044	1049	10:49	10:59	10 min
	3	3'	10:50	1053	10:53	10:58	5 min
	4	10'	11:00	1102	11:02	11:08	6 min

*inlet 3ft
Avg time
6 min*

SOIL AUGER FINDING _____

TESTED BY B.S.

REMARKS Use holes 3+4 (grout system)

HOWARD COUNTY OFFICE OF PLANNING AND ZONING
 DIVISION OF LAND DEVELOPMENT
 COUNTY OFFICE BUILDING
 3450 COURT HOUSE DRIVE
 ELLICOTT CITY, MARYLAND 21043

DATE: 11-05-80

P & Z File No. F81-40

Agencies

Office of Planning and Zoning

- Director, Department of Public Works
- Bureau of Engineering
- Bureau of Inspections and Permits
- Fire Administrator
- Police Department
- State Highway Administration
- Division of Environmental Health
- Howard County Public School System
- Recreation and Parks
- Soil Conservation Service
- County Assessment

- Director
- Chief, Division of Land Development
- Transportation Planning
- File
- Division of Comprehensive Planning
- Division of Zoning
- Planning Board Members

RE: H. J. Lilienfield, Sec. 2, lot 1

FOR PLAN REVIEW MEETING OF _____ (Date) _____ (Time) _____ (Place)

ENCLOSED FOR YOUR: Signature Approval Review & Comments Files

THE ENCLOSED: Original Copy

	<u>No. of Sheets</u>		<u>No. of Sheets</u>
<input type="checkbox"/> Preliminary Plan	_____	<input type="checkbox"/> Final Road and/or Storm Drainage Plan	_____
<input type="checkbox"/> Preliminary Road Profile	_____	<input type="checkbox"/> Final Storm Drainage Computations	_____
<input type="checkbox"/> Preliminary Drainage Study and/or Computations	_____	<input type="checkbox"/> Site Development Plan	_____
<input type="checkbox"/> Final Development Criteria	_____	<input type="checkbox"/> Sketch Plan	_____
<input type="checkbox"/> Final Development Plan	_____		_____
<input checked="" type="checkbox"/> Final Plat	_____		_____

WAS: Received Tentatively Approved Recorded
 Received & Revised Approved On 10-24-80

COMMENTS: _____

Check box and return to Office of Planning and Zoning if plan is approved with no comments.

CURVE DATA

No.	Radius	Length	Delta	Tan	Chord	Chord Bearing
7-1	488.37'	105.21'	12°20'55"	52.81'	105.00'	N41°00'33"E
9-10	458.37'	107.68'	13°27'36"	54.09'	107.43'	N40°27'02"E

N 474,500
E 814,750

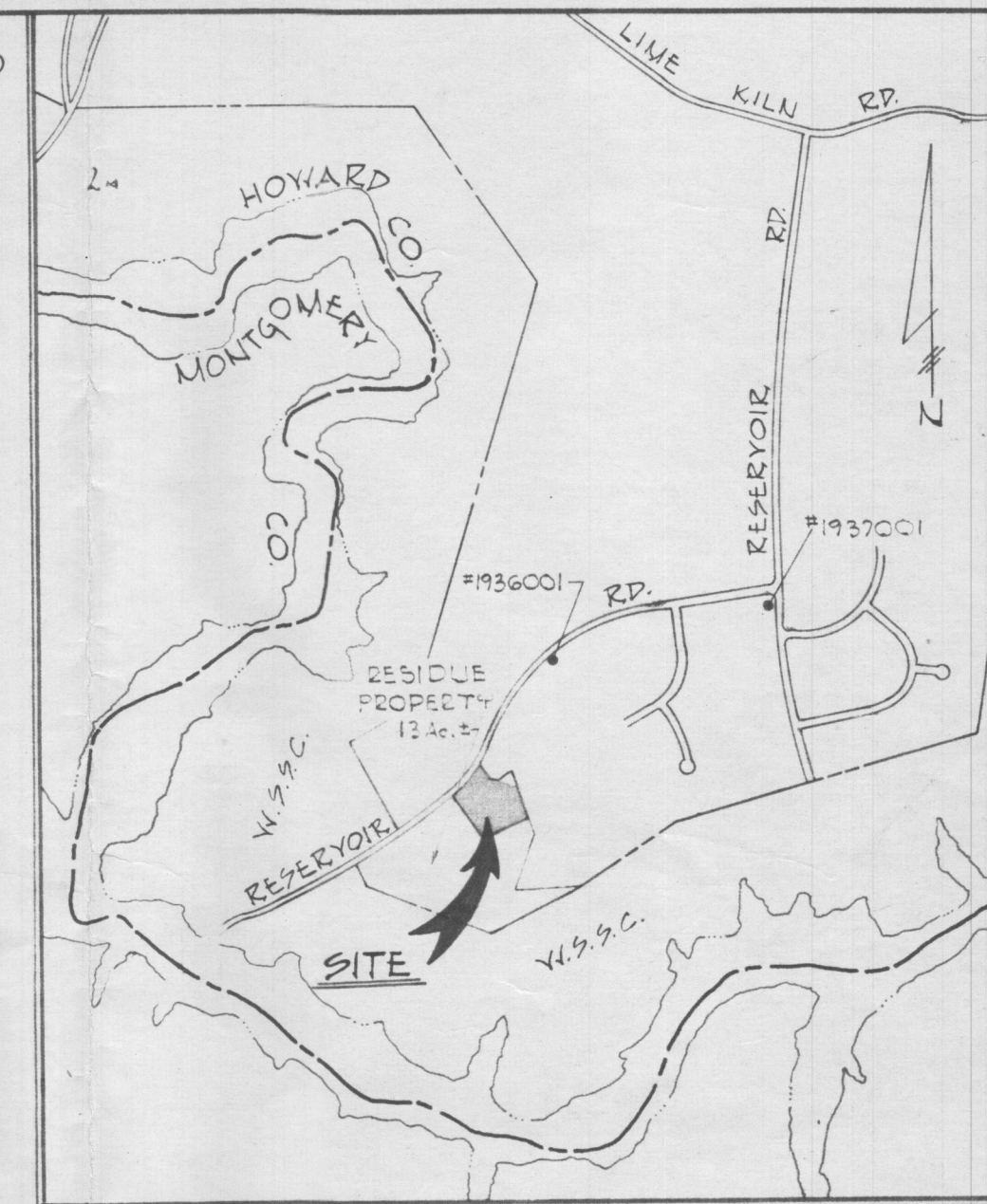

VICINITY MAP
Not to Scale

COORDINATES		
No.	NORTH	EAST
1	474408.02	814431.59
2	474294.08	814522.61
3	474270.03	814689.50
4	474033.52	814772.36
5	474952.75	814459.52
6	474224.11	814249.72
7	474328.78	814362.68
8	474247.94	814231.30
9	474350.78	814342.29
10	474432.54	814412.00



- NOTES:
- The coordinates shown hereon are based on the Maryland State Plane Coordinate System, Howard County Geodetic Control Stations: #1936001 N475393.396 E815436.916 #1937001 N475529.510 E816397.903
 - Property zoned "2" per 10/3/77 Comprehensive Zoning Plan.
 - Plan subject to VP81-17
 - An existing dwelling is situated on Lot No. 1

RECORDED PLAT 4699
10-24 1980 AMONG THE LAND RECORDS OF
HOWARD COUNTY, MD.

1. Total Number of Lots to be recorded	1
2. Total Area of Lots	3.021 Act
3. Total Area of Roadways to be recorded including widening strips	0.178 Act
4. Total Area of Subdivision to be recorded	3.199 Act

APPROVED: For private water and private sewerage systems.
Howard County Health Department.
Dwight M. Boyd / *10-23-80*
County Health Officer Date

APPROVED: Howard County Office of Planning and Zoning.
John F. Muschman / *10-23-80*
Director Date

APPROVED: For storm drainage systems, and public road.
Howard County Department of Public Works.
George F. Newmyer / *10-23-80*
Director Date

OWNER'S CERTIFICATE

I, Lawrence S. Lilienfield M.D., personal representative of the estate of Henry J. Lilienfield, owner of the property shown and described hereon, hereby adopt this plan of subdivision, and in consideration of the approval of this final plat by the office of planning and zoning, establish the minimum building restriction lines and grant unto Howard County, Maryland, its successors and assigns, (1) the right to lay, construct and maintain sewers, drains, water pipes and other municipal utilities and services, in and under all roads and street right-of-ways and the specific easement shown hereon; (2) the right to require dedication for public use the beds of the streets and/or roads, and floodplains and open space where applicable and for good and other valuable consideration, hereby grant the right and option to Howard County to acquire the fee simple title to the beds of the street and/or roads and floodplains, storm drainage facilities and open space where applicable; and (3) the right to require dedication of waterways and drainage easements for the specific purpose of their construction, repair and maintenance; and (4) that no building or similar structure of any kind shall be erected on or over the said easements and right-of-ways.

WITNESS MY HAND THIS 18th day of August 1980
Lawrence S. Lilienfield M.D. Personal Representative
Brian L. Childress Witness
Henry J. Lilienfield

SURVEYOR'S CERTIFICATE

I hereby certify that the Final Plat shown hereon is correct; that it is a subdivision of part of the property conveyed by George W. Mills and Rosa V. Mills to Henry J. Lilienfield and recorded in the Land Records of Howard County, Maryland in Liber 182 Folio 560 and that all monuments are in place as shown in accordance with the Annotated Code of Maryland as amended.

William G. Rasch / *9/18/80*
William G. Rasch, II Reg. No 4575 Date

PURDUM & JESCHKE
CONSULTING ENGINEERS AND LAND SURVEYORS
1023 N. Calvert Street
Baltimore, Maryland 21202

OWNER:
LAWRENCE S. LILIENFIELD, MD.
6304 MAIDEN LANE
BETHESDA, MD. 20034

LOT NO. 1
SECTION 2
PROPERTY OF
HENRY J. LILIENFIELD

FIFTH ELECTION DISTRICT
HOWARD COUNTY MARYLAND

Scale 1"=50'
Tax Map 45

September 15, 1980
Parcel 7