



# Building Permit Application

Howard County Maryland  
Department of Inspections, Licenses and Permits  
3430 Court House Drive  
Permits: 410-313-2455  
www.howardcountymd.gov

Date Received: \_\_\_\_\_

Permit No.: \_\_\_\_\_

Building Address: 11570 Chapel Rise  
City: Clarksville State: Md Zip Code: 21029  
Suite/Apt. # \_\_\_\_\_ SDP/WP/BA #: \_\_\_\_\_  
Census Tract: \_\_\_\_\_ Subdivision: \_\_\_\_\_  
Section: \_\_\_\_\_ Area: \_\_\_\_\_ Lot: \_\_\_\_\_  
Tax Map: \_\_\_\_\_ Parcel: \_\_\_\_\_ Grid: \_\_\_\_\_  
Zoning: \_\_\_\_\_ Map Coordinates: \_\_\_\_\_ Lot Size: \_\_\_\_\_

Existing Use: yard  
Proposed Use: pool, patio, fenced area  
Estimated Construction Cost: \$ 123,790.94  
Description of Work: Installation of a fiberglass 33' x 16' pool patio and aluminum fence (4' tall). Pool will have safety cover  
Occupant or Tenant: \_\_\_\_\_  
Was tenant space previously occupied?  Yes  No  
Contact Name: \_\_\_\_\_  
Address: \_\_\_\_\_  
City: \_\_\_\_\_ State: \_\_\_\_\_ Zip Code: \_\_\_\_\_  
Phone: \_\_\_\_\_ Fax: \_\_\_\_\_  
Email: \_\_\_\_\_

Property Owner's Name: Ferie & Ali Sarraf  
Address: 11570 Chapel Rise  
City: Clarksville State: Md Zip Code: 21029  
Phone: \_\_\_\_\_ Fax: \_\_\_\_\_  
Email: \_\_\_\_\_

Applicant's Name & Mailing Address, (If other than stated herein)  
Applicant's Name: Colleen Curro  
Address: 1902 Blakewood Ct  
City: Fallston State: Md Zip Code: 21047  
Phone: 410-838-9888  
Email: petercwfl@gmail.com

Contractor Company: Woodfield Landscaping  
Contact Person: Peter Curro  
Address: 2112 Bel Air Rd Suite 4A  
City: Fallston State: Md Zip Code: 21047  
License No.: 121071 MHAIC  
Phone: 410-838-9888  
Email: petercwfl@gmail.com

Engineer/Architect Company: \_\_\_\_\_  
Responsible Design Prof.: \_\_\_\_\_  
Address: \_\_\_\_\_  
City: \_\_\_\_\_ State: \_\_\_\_\_ Zip Code: \_\_\_\_\_  
Phone: \_\_\_\_\_ Fax: \_\_\_\_\_  
Email: \_\_\_\_\_

Commercial Building Characteristics	Residential Building Characteristics	
Height:	<input checked="" type="checkbox"/> SF Dwelling <input type="checkbox"/> SF Townhouse	
No. of stories:	Depth	Width
Gross area, sq. ft./floor:	1 <sup>st</sup> floor:	
	2 <sup>nd</sup> floor:	
Area of construction (sq. ft.):	Basement:	
	<input type="checkbox"/> Finished Basement	
Use group:	<input type="checkbox"/> Unfinished Basement	
	<input type="checkbox"/> Crawl Space	
<b>Construction type:</b>	<input type="checkbox"/> Slab on Grade	
<input type="checkbox"/> Reinforced Concrete	No. of Bedrooms:	
<input type="checkbox"/> Structural Steel	<b>Multi-family Dwelling</b>	
<input type="checkbox"/> Masonry	No. of efficiency units:	
<input type="checkbox"/> Wood Frame	No. of 1 BR units:	
<input type="checkbox"/> State Certified Modular	No. of 2 BR units:	
	No. of 3 BR units:	
	Other Structure:	
	Dimensions:	
<input checked="" type="checkbox"/> Roadside Tree Project Permit	Footings:	
<input type="checkbox"/> Yes <input checked="" type="checkbox"/> No	Roof:	
Roadside Tree Project Permit #	<input type="checkbox"/> State Certified Modular	
	<input type="checkbox"/> Manufactured Home	

Utilities	
<b>Water Supply</b>	
<input type="checkbox"/> Public	
<input checked="" type="checkbox"/> Private	
<b>Sewage Disposal</b> ?	
<input type="checkbox"/> Public	
<input checked="" type="checkbox"/> Private	
Electric: <input type="checkbox"/> Yes <input type="checkbox"/> No	
Gas: <input type="checkbox"/> Yes <input type="checkbox"/> No	
<b>Heating System</b>	
<input checked="" type="checkbox"/> Electric <input type="checkbox"/> Oil	
<input type="checkbox"/> Natural Gas <input type="checkbox"/> Propane Gas	
Other: <u>Heat pump</u>	
<b>Sprinkler System:</b>	
<input type="checkbox"/> Yes <input type="checkbox"/> No	
Grading Permit Number:	
Building Shell Permit Number:	

THE UNDERSIGNED HEREBY CERTIFIES AND AGREES AS FOLLOWS: (1) THAT HE/SHE IS AUTHORIZED TO MAKE THIS APPLICATION; (2) THAT THE INFORMATION IS CORRECT; (3) THAT HE/SHE WILL COMPLY WITH ALL REGULATIONS OF HOWARD COUNTY WHICH ARE APPLICABLE THERETO; (4) THAT HE/SHE WILL PERFORM NO WORK ON THE ABOVE REFERENCED PROPERTY NOT SPECIFICALLY DESCRIBED IN THIS APPLICATION; (5) THAT HE/SHE GRANTS COUNTY OFFICIALS THE RIGHT TO ENTER ONTO THIS PROPERTY FOR THE PURPOSE OF INSPECTING THE WORK PERMITTED AND POSTING NOTICES.

Colleen Curro Applicant's Signature Colleen Curro Print Name  
petercwfl@gmail.com Email Address 5/22/17 Date  
secr. / Woodfield Landscaping, Inc. Title/Company

Checks Payable to: DIRECTOR OF FINANCE OF HOWARD COUNTY  
\*\*PLEASE WRITE NEATLY & LEGIBLY\*\*  
-FOR OFFICE USE ONLY-

AGENCY	DATE	SIGNATURE OF APPROVAL
<input checked="" type="checkbox"/> State Highways		
<input checked="" type="checkbox"/> Building Officials		
<input checked="" type="checkbox"/> PSZA ( Zoning )		
<input checked="" type="checkbox"/> PSZA ( Engineering )		
<input checked="" type="checkbox"/> Health	<u>5/22/17</u>	<u>RBuck</u>

Is Sediment Control approval required for issuance?  Yes  No  
 CONTINGENCY CONSTRUCTION START

DPZ SETBACK INFORMATION	
Front:	
Rear:	
Side:	
Side St.:	
All minimum setbacks met?	<input type="checkbox"/> Yes <input type="checkbox"/> No
Is Entrance Permit Required?	<input type="checkbox"/> Yes <input type="checkbox"/> No
Historic District?	<input type="checkbox"/> Yes <input type="checkbox"/> No
Lot Coverage for New Town Zone:	
SDP/Red-line approval date:	

Filing Fee	\$ <u>275.00</u>
Permit Fee	\$
Tech Fee	\$
Excise Tax	\$
PSFS	\$
Guaranty Fund	\$
Add'l per Fee	\$
Total Fees	\$
Sub-Total Paid	\$
Balance Due	\$
Check	#

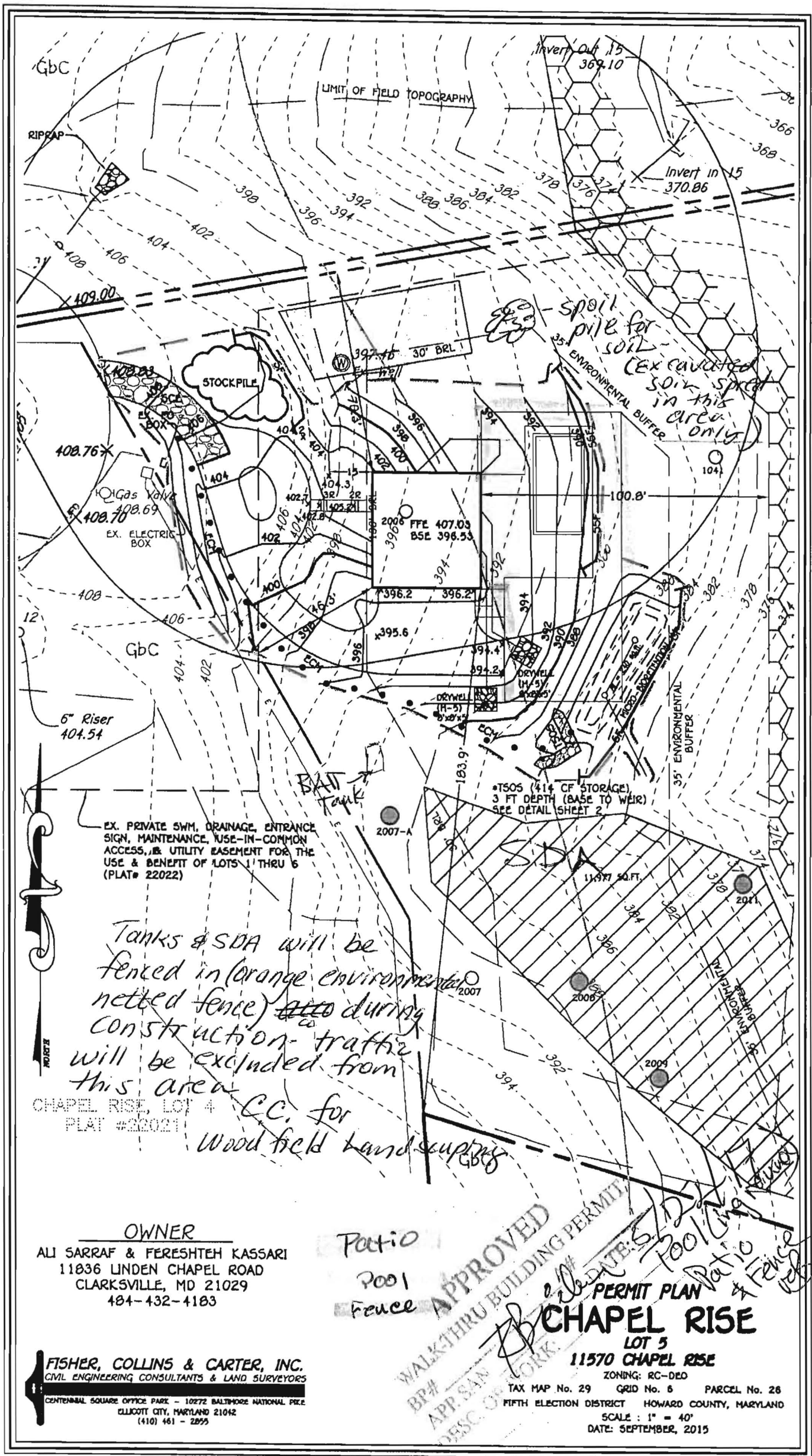

EX. PRIVATE SWM, DRAINAGE, ENTRANCE SIGN, MAINTENANCE, USE-IN-COMMON ACCESS, & UTILITY EASEMENT FOR THE USE & BENEFIT OF LOTS 1 THRU 6 (PLAT # 22022)

*Tanks & SDA will be fenced in (orange environmental netted fence) during construction traffic will be excluded from this area*

CHAPEL RISE, LOT 4  
PLAT #22021

*CC. for Wood field Landscaping*

**OWNER**  
ALI SARRAF & FERESHTEH KASSARI  
11836 LINDEN CHAPEL ROAD  
CLARKSVILLE, MD 21029  
484-432-4183

**FISHER, COLLINS & CARTER, INC.**  
CIVIL ENGINEERING CONSULTANTS & LAND SURVEYORS  
CENTENNIAL SQUARE OFFICE PARK - 10272 BALTIMORE NATIONAL PIKE  
ELLICOTT CITY, MARYLAND 21042  
(410) 461-2899

*Patio  
Pool  
Fence*

**APPROVED**  
WALK-THRU BUILDING PERMIT  
DATE: 9/22/15  
APP. SANITARY WORKS  
DESC. OF WORKS

**PERMIT PLAN**  
**CHAPEL RISE**  
LOT 5  
11570 CHAPEL RISE

ZONING: RC-DEO  
TAX MAP No. 29 GRID No. 6 PARCEL No. 28  
FIFTH ELECTION DISTRICT HOWARD COUNTY, MARYLAND  
SCALE: 1" = 40'  
DATE: SEPTEMBER, 2015