

APPLICATION

HOWARD COUNTY HEALTH DEPARTMENT
BUREAU OF ENVIRONMENTAL HEALTH
PO BOX 476 ELLICOTT CITY MARYLAND 21043
TELEPHONE 461-9933

PERCOLATION TESTING

*PERCOLATION OK. IN REAR OF
WELL SINK. 130 PUBLIC WATER
WELL SINK. PINE
MORE THAN 100
TO MAXIMIZE
6/19/92 (will)*

A 4/8/92
P _____
DISTRICT 2ND
DATE 5/19/92

TO: THE COUNTY HEALTH OFFICER
ELLICOTT CITY, MARYLAND

I, HEREBY, APPLY FOR THE NECESSARY TEST IN ORDER TO CONSTRUCT (OR RECONSTRUCT) A SEWAGE DISPOSAL SYSTEM.

PROPERTY OWNER MRS. ELIZABETH SAUTER James & Linda McArthur
ADDRESS 8431 OLD FREDERICK RD ELLICOTT CITY, MD 21093 PHONE 410-1354-653-5974
PROSPECTIVE BUYER N/A
ADDRESS _____ PHONE _____

PROPERTY LOCATION:

SUBDIVISION SAUTER PROPERTY LOT NO. 2
ROAD AND DESCRIPTION EAST SIDE OF OLD FREDERICK ROAD 250' NORTHEAST OF INTERSECTION OF ROLLING RIDGE COURT (8431 OLD FREDERICK ROAD)
TAX MAP 18 PARCEL # 313
SIZE OF LOT 5.023 AC. ± TYPE BLDG PROPOSED SINGLE FAMILY
(SINGLE FAMILY DWELLING OR COMMERCIAL)

THE SYSTEM INSTALLED UNDER THIS APPLICATION IS ACCEPTABLE ONLY UNTIL PUBLIC FACILITIES BECOME AVAILABLE. I FULLY UNDERSTAND THE FEE CONNECTED WITH THE FILING OF THIS PERC TEST APPLICATION IS NON-REFUNDABLE UNDER ANY CIRCUMSTANCES. I ALSO AGREE TO COMPLY WITH ALL M.O.S.H.A. REQUIREMENTS IN TESTING THIS LOT.

Elizabeth Sauter
(SIGNATURE OF APPLICANT)

APPROVED BY _____ FOR _____ DATE _____
REJECTED BY _____ FOR _____ DATE _____
HOLD PENDING FURTHER TESTS _____ DATE _____

REASONS FOR REJECTION OR HOLDING PERC OK, HOLD FOR PLAT 6/23/92 MR

BLDG. PERMIT SIGNED
AND RETURNED 5/17/92
Seal # 476 SF
Residential SFD - 4 Bedroom

THIS IS NOT A PERMIT

HD-216

Lot 2
18172

(2)(3)(4)
SOIL PROFILE

red brn
sa
cl lm
10-20% frags
tan beige
sa lm
10-20%
sandstone
frags

3-3 1/2

12 1/2-13

(1)(5)(6)(7)

brn sa
cl lm
30% frags
tan beige
sa lm
20-30%
hard
sandstone
frags
HARD BOT

9 1/2, 13, 3, 5 1/4
(1)(5)(6)(7)

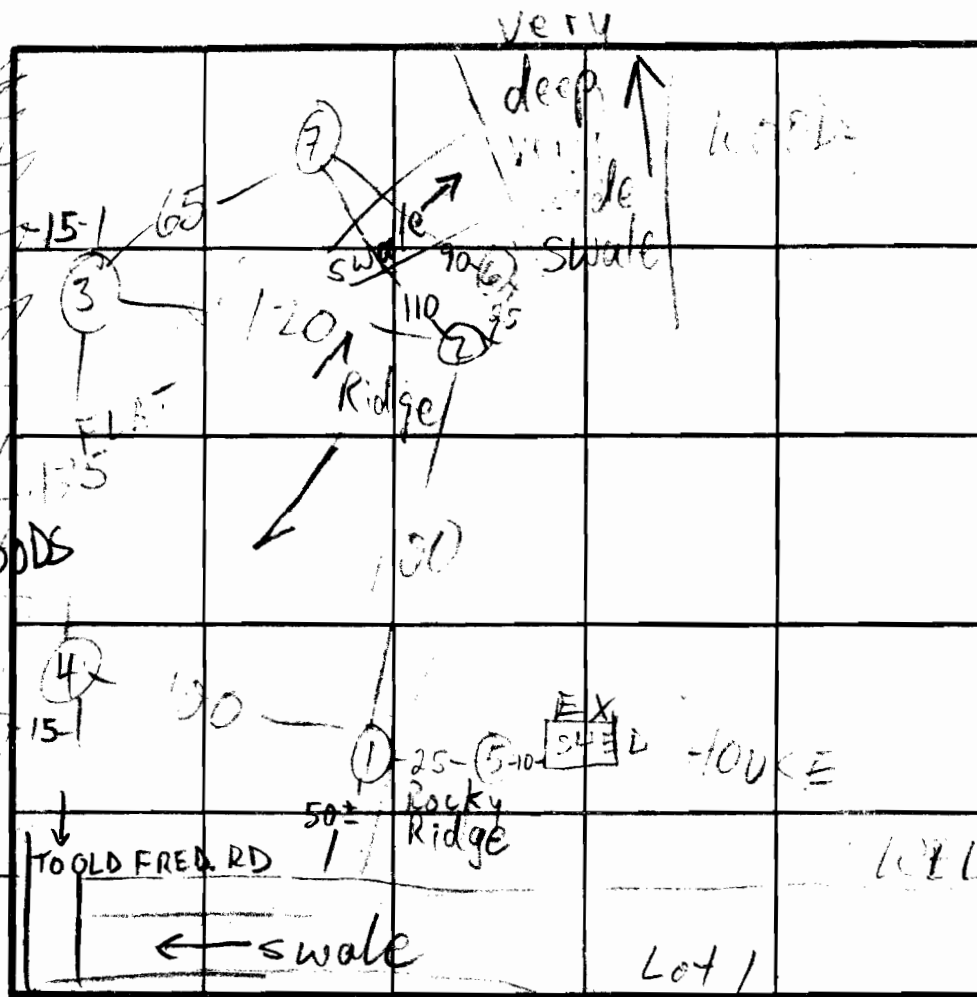

(2)(3) H1
(1)(4) - 0

$\bar{x} = 5$

180 ft. Bil
Inlet 3'
Bottom 5'

INDICATE NORTH - NAME ADJOINING ROADWAY AS BASE LINE.

| DATE | TEST NO. | DEPTH | PRE-WET | | TEST - 1" DROP | | TIME |
|---------|----------|-------|---------|---------|----------------|------|--------------|
| | | | START | STOP | START | STOP | |
| 6/12/92 | 1 S | 3 | 12:59 | 1:02 | 1:02 | 1:15 | 3 1/2 |
| | 1 V | 7 1/2 | see | profile | | | |
| | 2 H | 7 | 1:15 | 1:18 | 1:18 | 1:29 | 6 FT ST |
| | 2 I | 12 | 1:15 | 1:17 | 1:17 | 1:20 | 3 FT ST |
| | 2 I | 12 | see | profile | | | |
| | 3 S | 4 | 1:15 | 1:16 | 1:16 | 1:20 | 2 |
| | 3 I | 13 | see | profile | | | |
| | 4 I | 4 1/2 | 1:13:30 | 1:15 | 1:15 | 1:20 | 2 FT ST |
| | 5 I | 13 | see | profile | | | |
| | 5 V | 15 | see | profile | | | |
| | 6 V | 3 | HARD | 1 inch | | | REFUSAL FALL |

REMARKS HOLE (2) 5' 9" SIM TO PROFILE PER PLAN. 2/2/92

TYPE OF SOIL USE (1)-(2)-(3)-(4)

TESTED BY M. Rifkin ALSO PRESENT OK Jr