

B110000577

Building Address: 2120 Robin Branch Court  
MT Airy MD 21771

Suite/Apt. # \_\_\_\_\_ SDP/WP/BA #: \_\_\_\_\_

Census Tract: \_\_\_\_\_ Subdivision: \_\_\_\_\_

Section: \_\_\_\_\_ Area: \_\_\_\_\_ Lot: \_\_\_\_\_

Tax Map: \_\_\_\_\_ Parcel: \_\_\_\_\_ Grid: \_\_\_\_\_

Zoning: \_\_\_\_\_ Map Coordinates: \_\_\_\_\_ Lot Size: \_\_\_\_\_

Property Owner's Name: Kathryn Brosted

Address: 2120 Robin Branch Ct

City: \_\_\_\_\_ State: \_\_\_\_\_ Zip Code: \_\_\_\_\_

Home Phone: \_\_\_\_\_ Work Phone: \_\_\_\_\_

Applicant's Name & Mailing Address, (if other than stated herein): \_\_\_\_\_

Phone: \_\_\_\_\_ Fax: \_\_\_\_\_

Email: \_\_\_\_\_

Existing Use: \_\_\_\_\_

Proposed Use: propane tank

Estimated Construction Cost: \$ \_\_\_\_\_

Description of Work: Install 500 gal U/G propane tank

Occupant or Tenant: \_\_\_\_\_

Was tenant space previously occupied?  Yes  No

Contractor Company: \_\_\_\_\_

Contact Person: \_\_\_\_\_

Address: \_\_\_\_\_

City: \_\_\_\_\_ State: \_\_\_\_\_ Zip Code: \_\_\_\_\_

License No.: \_\_\_\_\_

Phone: \_\_\_\_\_ Fax: \_\_\_\_\_

Email: \_\_\_\_\_

Contact Name: \_\_\_\_\_

Address: \_\_\_\_\_

City: \_\_\_\_\_ State: \_\_\_\_\_ Zip Code: \_\_\_\_\_

Phone: \_\_\_\_\_ Fax: \_\_\_\_\_

Email: \_\_\_\_\_

Engineer/Architect Company: \_\_\_\_\_

Responsible Design Prof.: \_\_\_\_\_

Address: \_\_\_\_\_

City: \_\_\_\_\_ State: \_\_\_\_\_ Zip Code: \_\_\_\_\_

Phone: \_\_\_\_\_ Fax: \_\_\_\_\_

Email: \_\_\_\_\_

BUILDING DESCRIPTION - COMMERCIAL	
Building Characteristics	Utilities
Height:	<u>Water Supply</u>
No. of stories:	<input type="checkbox"/> Public
Gross area, sq. ft./floor:	<input type="checkbox"/> Private
Area of construction (sq. ft.):	<u>Sewage Disposal</u>
Use group:	<input type="checkbox"/> Public
	<input type="checkbox"/> Private
	Electric: <input type="checkbox"/> Yes <input type="checkbox"/> No
	Gas: <input type="checkbox"/> Yes <input type="checkbox"/> No
<u>Construction type:</u>	<u>Heating System</u>
<input type="checkbox"/> Reinforced Concrete	<input type="checkbox"/> Electric <input type="checkbox"/> Oil
<input type="checkbox"/> Structural Steel	<input type="checkbox"/> Natural Gas <input type="checkbox"/> Propane Gas
<input type="checkbox"/> Masonry	<u>Sprinkler System:</u>
<input type="checkbox"/> Wood Frame	<input type="checkbox"/> N/A
<input type="checkbox"/> State Certified Modular	<input type="checkbox"/> Full
<input checked="" type="checkbox"/> <u>Roadside Tree Project Permit</u>	<input type="checkbox"/> Partial
<input type="checkbox"/> Yes <input type="checkbox"/> No	<input type="checkbox"/> Other Suppression
<u>Roadside Tree Project Permit #</u>	No. of Heads: _____

BUILDING DESCRIPTION - RESIDENTIAL	
Building Characteristics	Utilities
<input type="checkbox"/> SF Dwelling <input type="checkbox"/> SF Townhouse	<u>Water Supply</u>
<u>Depth</u> <u>Width</u>	<input type="checkbox"/> Public
1 <sup>st</sup> floor:	<input type="checkbox"/> Private
2 <sup>nd</sup> floor:	<u>Sewage Disposal</u>
Basement:	<input type="checkbox"/> Public
<input type="checkbox"/> Finished Basement	<input type="checkbox"/> Private
<input type="checkbox"/> Unfinished Basement	Electric: <input type="checkbox"/> Yes <input type="checkbox"/> No
<input type="checkbox"/> Crawl Space	Gas: <input type="checkbox"/> Yes <input type="checkbox"/> No
<input type="checkbox"/> Slab on Grade	<u>Heating System</u>
No. of Bedrooms:	<input type="checkbox"/> Electric
<u>Multi-family Dwelling</u>	<input type="checkbox"/> Oil
No. of efficiency units:	<input type="checkbox"/> Natural Gas
No. of 1 BR units:	<input type="checkbox"/> Propane Gas
No. of 2 BR units:	
No. of 3 BR units:	
Other Structure:	
Dimensions:	
Footings:	<input checked="" type="checkbox"/> <u>Roadside Tree Project Permit</u>
Roof:	<input type="checkbox"/> Yes <input type="checkbox"/> No
<input type="checkbox"/> State Certified Modular	<u>Roadside Tree Project Permit #</u>
<input type="checkbox"/> Manufactured Home	

THE UNDERSIGNED HEREBY CERTIFIES AND AGREES AS FOLLOWS: (1) THAT HE/SHE IS AUTHORIZED TO MAKE THIS APPLICATION; (2) THAT THE INFORMATION IS CORRECT; (3) THAT HE/SHE WILL COMPLY WITH ALL REGULATIONS OF HOWARD COUNTY WHICH ARE APPLICABLE THERETO; (4) THAT HE/SHE WILL PERFORM NO WORK ON THE ABOVE REFERENCED PROPERTY NOT SPECIFICALLY DESCRIBED IN HIS APPLICATION; (5) THAT HE/SHE GRANTS COUNTY OFFICIALS THE RIGHT TO ENTER ONTO THIS PROPERTY FOR THE PURPOSE OF INSPECTING THE WORK PERMITTED AND POSTING NOTICES.

Applicant's Signature \_\_\_\_\_

Print Name \_\_\_\_\_

Email Address \_\_\_\_\_

Date \_\_\_\_\_

Title/Company \_\_\_\_\_

Checks Payable to: DIRECTOR OF FINANCE OF HOWARD COUNTY

\*\*PLEASE WRITE NEATLY & LEGIBLY\*\*

-FOR OFFICE USE ONLY-

AGENCY	DATE	SIGNATURE OF APPROVAL
State Highways		
Building Officials		
PSZA ( Zoning )		
PSZA ( Engineering )		
Health	1-19-11	<i>[Signature]</i>
Fire Protection		

DPZ SETBACK INFORMATION
Front: _____
Rear: _____
Side: _____
Side St.: _____
All minimum setbacks met? <input type="checkbox"/> Yes <input type="checkbox"/> No
Is Entrance Permit Required? <input type="checkbox"/> Yes <input type="checkbox"/> No
Historic District? <input type="checkbox"/> Yes <input type="checkbox"/> No
Lot Coverage for New Town Zone: _____
SDP/Red-line approval date: _____

Filing Fee	\$
Permit Fee	\$ 15
Tech Fee	\$ 10
Excise Tax	\$
PSFS	\$
Guaranty Fund	\$
Add'l per Fee	\$
Total Fees	\$
Sub- Total Paid	\$
Balance Due	\$

Is Sediment Control approval required for issuance?  Yes  No  
 CONTINGENCY CONSTRUCTION START  
 ONE STOP SHOP

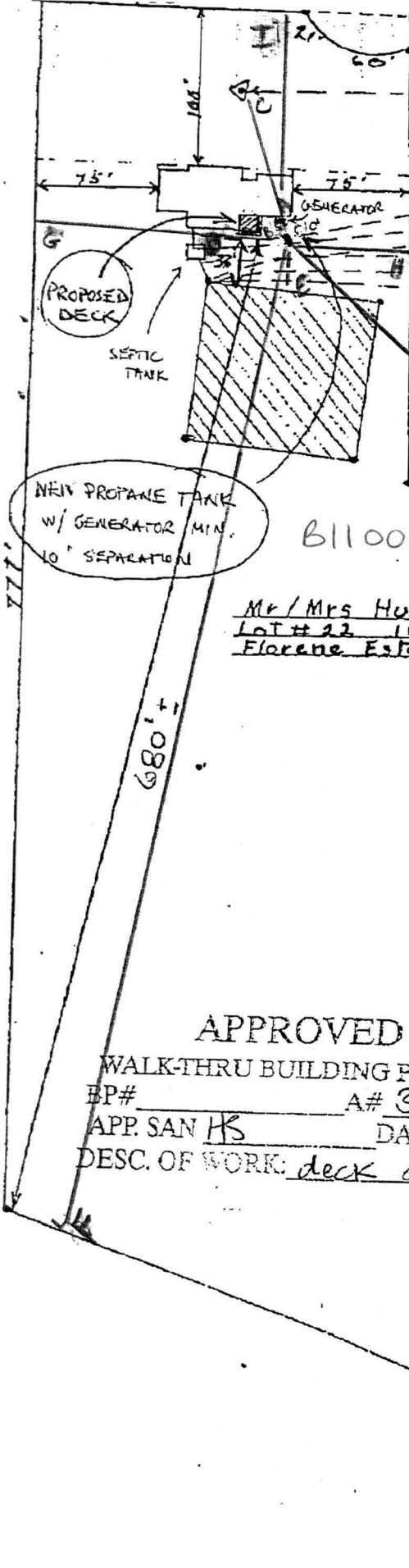

Elev. at wall 632'

1" = 100'

Finish First Fl.	634.5	✓
" Base. Fl.	625	✓
LNK Elev.	623.5	✓
LNK Elev.	623	✓
Existing Elev.	623	✓
LNK Elev.	621.5	✓
Existing Elev.	623	✓
perc. Elev.	623	✓
Trench Inlet	620	✓

BASEMENT ON GRAVITY

619.5 INLET INTO TRENCH

500 Gallon underground propane tank

elevations ok  
w/ change in  
inlet depth into  
trench  
11/26/88  
S. Star

B11000057 OK

Mr/Mrs Hubert Snapp  
Lot # 22 10.25 AC.  
Florence Estates

LP tank  
1-19-11

BLDG. PERMIT SIGNED  
AND RETURNED 11/24/88  
S. Star

BP 9114

APPROVED

WALK-THRU BUILDING PERMIT

BP# \_\_\_\_\_ A# 31551

APP. SAN HS DATE: 11-5-10

DESC. OF WORK: deck as shown