

\$506.00 PERK



# APPLICATION

## FOR PERCOLATION TESTING AND SITE EVALUATION

TEST DATE(S) April 29, 2010 TEST TIME 9:30 am APP 533208  
 AGENCY REVIEW: Robert Bricker, RS/REHS, CPSS DATE 4/22/2010

DO NOT WRITE ABOVE THIS LINE

I HEREBY APPLY FOR THE NECESSARY TESTING/EVALUATION PRIOR TO ISSUANCE OF SEWAGE DISPOSAL SYSTEM PERMIT(S) TO:

CHECK AS NEEDED:

- CONSTRUCT NEW SEPTIC SYSTEM(S)
- REPAIR/ADD TO AN EXISTING SEPTIC SYSTEM
- REPLACE AN EXISTING SEPTIC SYSTEM

CHECK AS NEEDED:

- NEW STRUCTURE(S)
- ADDITION TO AN EXISTING STRUCTURE
- REPLACE AN EXISTING STRUCTURE

CHECK ONE:

- CREATE NEW LOT(S)
- BUILD ON AN EXISTING LOT IN A SUBDIVISION
- BUILD ON AN EXISTING PARCEL OF RECORD

IS THE PROPERTY WITHIN 2500' OF ANY RESERVOIR?

- YES
- NO

THE TYPE OF STRUCTURE IS:

- RESIDENTIAL WITH \_\_\_\_\_ PROPOSED BEDROOMS IN THE COMPLETED STRUCTURE (NOTE *UNKNOWN* IF APPROPRIATE)
- COMMERCIAL (PROVIDE DETAIL OF NUMBERS AND TYPES OF EMPLOYEES/CUSTOMERS ON ACCOMPANYING PLAN)
- INSTITUTIONAL/GOVERNMENT (PROVIDE DETAIL OF NUMBERS AND TYPES OF EMPLOYEES/USERS ON ACCOMPANYING PLAN)

PROPERTY OWNER(S) JOAN BAUGHER

DAYTIME PHONE 410-465-3146 CELL 443-996-7056 FAX \_\_\_\_\_

MAILING ADDRESS 4767 Montgomery Rd. Ellicott City, Md 21043

APPLICANT JAMES HOBSON

DAYTIME PHONE 410-313-3966 CELL 443-980-8807 FAX 410-313-3298

MAILING ADDRESS 8405 Jenn Nicole Ct. Ellicott City, Md 21043

APPLICANT'S ROLE: DEVELOPER BUILDER BUYER RELATIVE/FRIEND REALTOR CONSULTANT

PROPERTY LOCATION SUBDIVISION/PROPERTY NAME 4775 BAUGHER FARM Rd. LOT NO. Parcel 800

PROPERTY ADDRESS 4775 BAUGHER FARM Rd, Ellicott City, Md 21043

AX MAP PAGE(S) 31 GRID 7 PARCEL(S) 800 PROPOSED LOT SIZE 1.0 AC

AS APPLICANT, I UNDERSTAND THE FOLLOWING: THE SYSTEM INSTALLED SUBSEQUENT TO THIS APPLICATION IS ACCEPTABLE ONLY UNTIL PUBLIC SEWERAGE IS AVAILABLE. THIS APPLICATION IS COMPLETE WHEN ALL APPLICABLE FEES AND A DETAILED SITE PLAN HAVE BEEN RECEIVED. I ACCEPT THE RESPONSIBILITY FOR COMPLIANCE WITH ALL M.O.S.H. AND "MINIMUM UTILITY" REQUIREMENTS. APPROVAL IS BASED UPON SATISFACTORY REVIEW OF A PERC CERTIFICATION PLAN. TEST RESULTS WILL BE MAILED TO APPLICANT.

James Hobson  
SIGNATURE OF APPLICANT

RECEIVED  
HOWARD COUNTY HEALTH DEPT  
APR 22 PM 5:05

HOWARD COUNTY HEALTH DEPARTMENT, BUREAU OF ENVIRONMENTAL HEALTH, WELL AND SEPTIC PROGRAM  
7178 COLUMBIA GATEWAY DRIVE COLUMBIA, MARYLAND 21046 (410) 313-1771 FAX (410) 313-2648  
TDD (410) 313-2323 TOLL FREE 1-877-4MD-DHMH

SITE INSPECTION SHEET

OWNER: Joan Baugher PHONE #: \_\_\_\_\_  
ADDRESS: 4775 Baugher Farm Rd CONTRACTOR: \_\_\_\_\_  
SUBDIVISION: \_\_\_\_\_ LOT: \_\_\_\_\_ WELL TAG #: Public water  
PROPOSAL: 3 Bedroom SFD; (2 Bedroom planned) COUNTY #: \_\_\_\_\_  
LTIR = 1.29 / ft<sup>2</sup> / d

LOCATION DIAGRAM

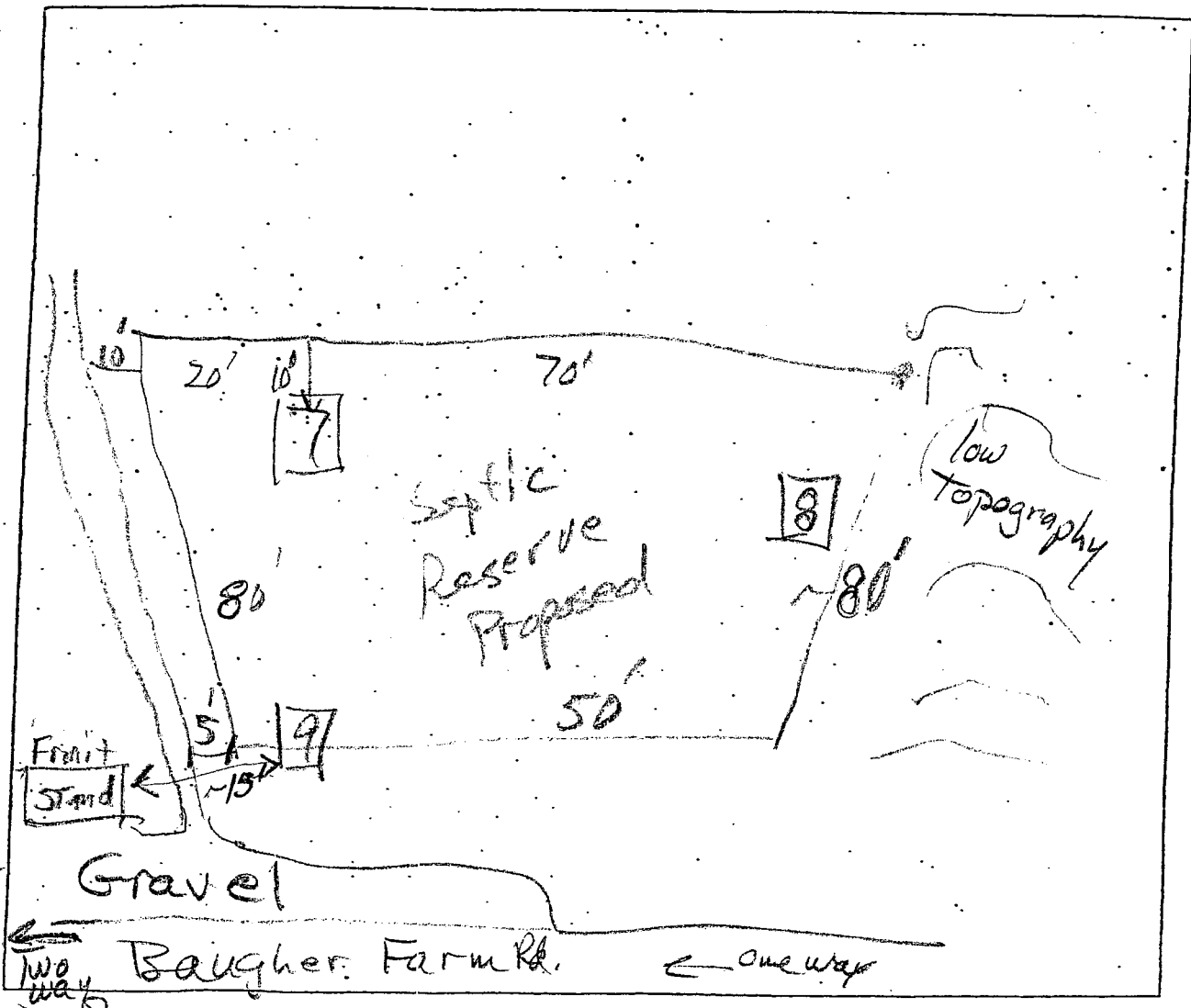

COMMENTS: Sketch shows approximate dimensions  
a area approvable as septic reserve, and  
The spatial relationship of passing porcs to  
the 'fruit' stand.

new construction proposed at 4775 Baugher Farm Rd.

AP

①  
0.8' dk grey-brn pe sl  
0.8' brn vpe scl  
2' brn vco scl  
5' brn vco sl  
0.5' yel brn clay slightly sticky

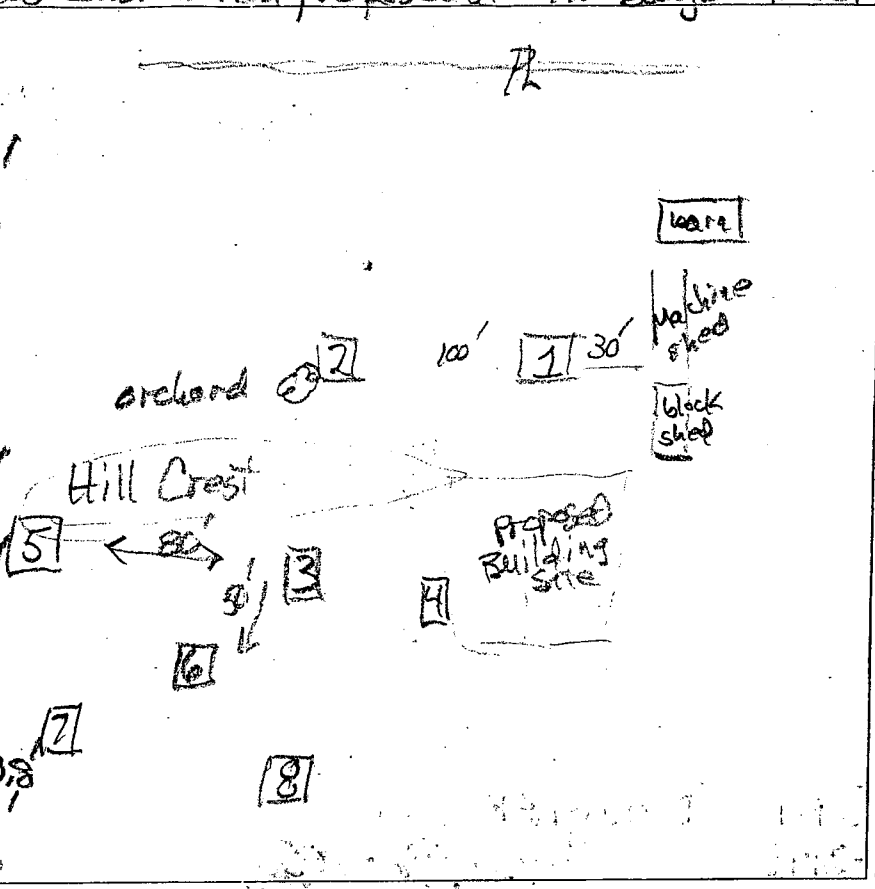

(4)  
0.8' dk grey-brn sl  
2.3' yel-red pe scl  
yel red scl  
5.3' 10% pe sco  
yel-brn sc

②  
0.8' dk grey-brn sl  
brn vpe scl  
brn vco scl

(6)  
1.7' dk grey-brn sl  
4.5' brn gr scl slightly sticky  
1' gr cl  
6' yel-brn sl moist somewhat dense  
11.5' yel-brn fsl w/ 2d grey more dense  
2.5' yel-brn fsl w/ cad grey

brn cosl slightly sticky  
6' yel brn sl very moist  
#2 dk to grey  
#2 d grey w/ brn sc

DATE	TEST #	DEPTH	START	BREAK 1" DROP	STOP 2" DROP	TIME OF 2ND INCH	P/F/H
4/29/10	1	4.6' / 6.5'	10:35	10:50	no movement		F
4/29/10	3	2.2' / 7.5'	11:22	11:25	11:31	6	P
4/29/10	5	2.2' / 7'	12:18	12:38	1:07	29	P
4/29/10	6	6.8' / 2.5'	1:21	1:50	2:25	35	
4/29/10	7	5' / 11'	2:01	2:02	2:05	3	P

(3) #5  
0.8' dk grey-brn sl  
0.8' yel-brn gr sl

(7)  
0.7' dk grey-brn sl  
1.6' brn gr scl  
2.8' brn scl  
5' brn sl if pl  
6' yel-brn sl  
11' yel-brn sl w/ pale yellow  
11.5' dk grey (C3d)

brn gr scl  
4.7' brn vco pe sl  
7' yel-brn clay #5  
#3 good to 7.5'

REMARKS Do = pebbles, co = cobbles  
SANITARIAN RB BACKHOE Otis OTHERS Jim Hobson Joan Baugher  
TEST HOLES USED IN SDA 7, 8 & 9 AVG. PERC TIME 25 mins. FT/BR 125  
TRENCH WIDTH 3 INLET DEPTH 3 MAX. BOT DEPTH 7 EFFECTIVE S/W 2

Linear Feet = 80 (77.5)

new construction Proposed at 4775 Baughen Farm Road

AP

8  
 dk grey brnsl 0.9  
 brn grscl 2.5  
 yel-red s dense du 3.6  
 yel-brn s w/pockets pale yellow ls 9.5  
 pale brn w/pale yellow & grey csa 10.5

9  
 dk grey brnsl 0.7  
 yel-brn s 10% gravel 1.5  
 brn grscl 3.1  
 yel-red s 4.1  
 yel-brn s 9.1  
 pale brnsl 7.2  
 grey 2.2  
 yel brn clay w/d grey 7.5

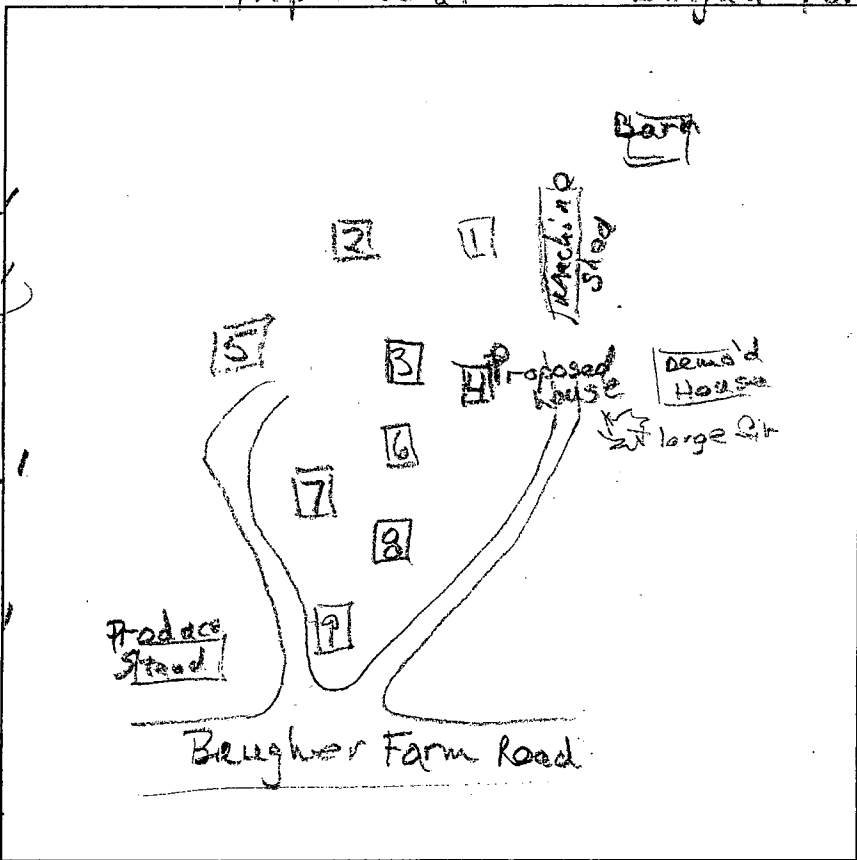

DATE	TEST #	DEPTH	START	BREAK 1" DROP	STOP 2" DROP	TIME OF 2ND INCH	P/F/H
4/29/10	8	5' 9.5"	2:35	2:38:40	2:37	1.3	refound
4/29/10	8	5' 9.5"	2:38	2:39:30	2:41	1.5	refound
4/29/10	8	5' 9.5"	2:42	2:43:10	2:45:20	2.2	P
4/29/10	9	5' 9"	3:18	3:19:30	3:21:30	2	P

REMARKS Trench Bottom more shallow; 5.5' @ #8, 5' @ #9  
 SANITARIAN RR BACKHOE Otis Kettmann OTHERS Jim Holson  
 TEST HOLES USED IN SDA 7, 8, 9 AVG. PERC TIME 2min SQ. FT/BR 125  
 TRENCH WIDTH 2 DEPTH 5.5 MAX. BOT DEPTH See EFFECTIVE SAW 2  
 Linear feet = 110  
 (107')