



Bureau of Environmental Health
 8930 Stanford Boulevard, Columbia, MD 21045
 Main: 410-313-2640 | Fax: 410-313-2648
 TDD 410-313-2323 | Toll Free 1-866-313-6300
www.hchealth.org
 Facebook: www.facebook.com/hocohealth

Maura J. Rossman, M.D., Health Officer

RECEIPT DATE: 8/3/17 **ONSITE SEWAGE DISPOSAL SYSTEM** P 561814

APPROVAL DATE: 8/10/17 **PERMIT: REPAIR** A _____

PROPERTY ADDRESS: 13578 Broccolino Way

SUBDIVISION: Brighton Mill LOT: 8 TAX ID: 05-450098

CONTRACTOR: DWM Enterprises II EMAIL: _____

CONTRACTOR ADDRESS: PO Box 505 / Reisterstown, MD 21136 PHONE: 443-831-7468

PROPERTY OWNER: Ramz Khleif EMAIL: _____

OWNER ADDRESS: 13578 Broccolino Way / Clarksville, MD 21029 PHONE: _____

SEPTIC TANK SIZE (GALLONS): 2000 PUMP CHAMBER CAPACITY (GALLONS): N/A PUMP SIZE: N/A

NUMBER OF BEDROOMS: 7 HOUSE SQ. FT. _____ APPLICATION RATE: 1.2

DISTRIBUTION SYSTEM: GRAVITY FED LOW PRESSURE DOSED

TRENCHES:	LINEAR FEET REQUIRED: <u>150</u>	INLET DEPTH: <u>3.5</u>
	TRENCH WIDTH: <u>3</u>	MAXIMUM BOTTOM DEPTH: <u>8</u>
	MINIMUM SPACE BETWEEN TRENCHES: <u>9</u>	EFFECTIVE AREA BEGINNING DEPTH: <u>3.5 S'</u>
LOCATION:	TO BE STAKED BY SANITARIAN DURING PRE-CONSTRUCTION INSPECTION.	
NOTES:	Install 3x50' trenches on contour in SDA. Install a bull run valve to enable switching to the original system after recovery.	

ISSUED BY: Sarah Collins ISSUE DATE: 8/3/17 EXPIRATION DATE: 8/3/18

- NOTE: CONTRACTOR MUST SCHEDULE A PRE-CONSTRUCTION INSPECTION PRIOR TO BEGINNING ANY INSTALLATION**
- NOTE: CONTRACTOR MUST SCHEDULE AN INSPECTION AND GAIN APPROVAL OF ALL COMPONENTS PRIOR TO COVERING
- NOTE: STONE MUST BE APPROVED BY HEALTH DEPARTMENT AND GRAVEL TICKET MUST BE AVAILABLE FOR REVIEW.
- NOTE: WATERTIGHT SEPTIC TANKS REQUIRED
- NOTE: ALL PARTS OF SEPTIC SYSTEM SHALL BE AT LEAST 100 FEET DOWNGRAIDENT FROM ANY WATER WELL
- NOTE: MANHOLE RISERS REQUIRED ON ALL SEPTIC TANKS AND PUMP CHAMBERS
- NOTE: AN ELECTRICAL PERMIT IS REQUIRED FOR INSTALLATION OF ANY ELECTRICAL COMPONENTS OF THE SYSTEM**
 ELECTRICAL PERMIT ISSUED E N/A
- NOTE: THE HCHD DOES NOT WARRANTY ANY SYSTEM AND CANNOT GUARANTEE THE PERFORMANCE OF THIS SYSTEM AS DESIGNED. BY ACCEPTING THIS PERMIT, THE OWNER AND/OR APPLICANT ACKNOWLEDGE THAT THE SPECIFICATIONS DETAILED IN THIS DESIGN ARE ONE POSSIBLE OPTION AND THAT THE HCHD WILL REVIEW OTHER PROPOSALS. YOU HAVE THE OPTION TO SEEK THE ADVICE OF A QUALIFIED DESIGN CONSULTANT OR PROFESSIONAL ENGINEER FOR FURTHER GUIDANCE.**
- NOTE: MDE RECOMMENDS SEPTIC TANKS, BAT, AND OTHER PRETREATMENT UNITS BE PUMPED AT A FREQUENCY ADEQUATE TO ENSURE THAT SOLIDS ARE NOT DISCHARGED TO THE DISPOSAL AREA

**NEITHER THE HOWARD COUNTY COUNCIL NOR THE HEALTH DEPARTMENT IS RESPONSIBLE FOR THE SUCCESSFUL OPERATION OF ANY SYSTEM.
 PERMITTEE RESPONSIBLE FOR OBTAINING FINAL APPROVAL ON THIS PERMIT.
 CALL 410-313-1771 TO SCHEDULE INSPECTIONS.**

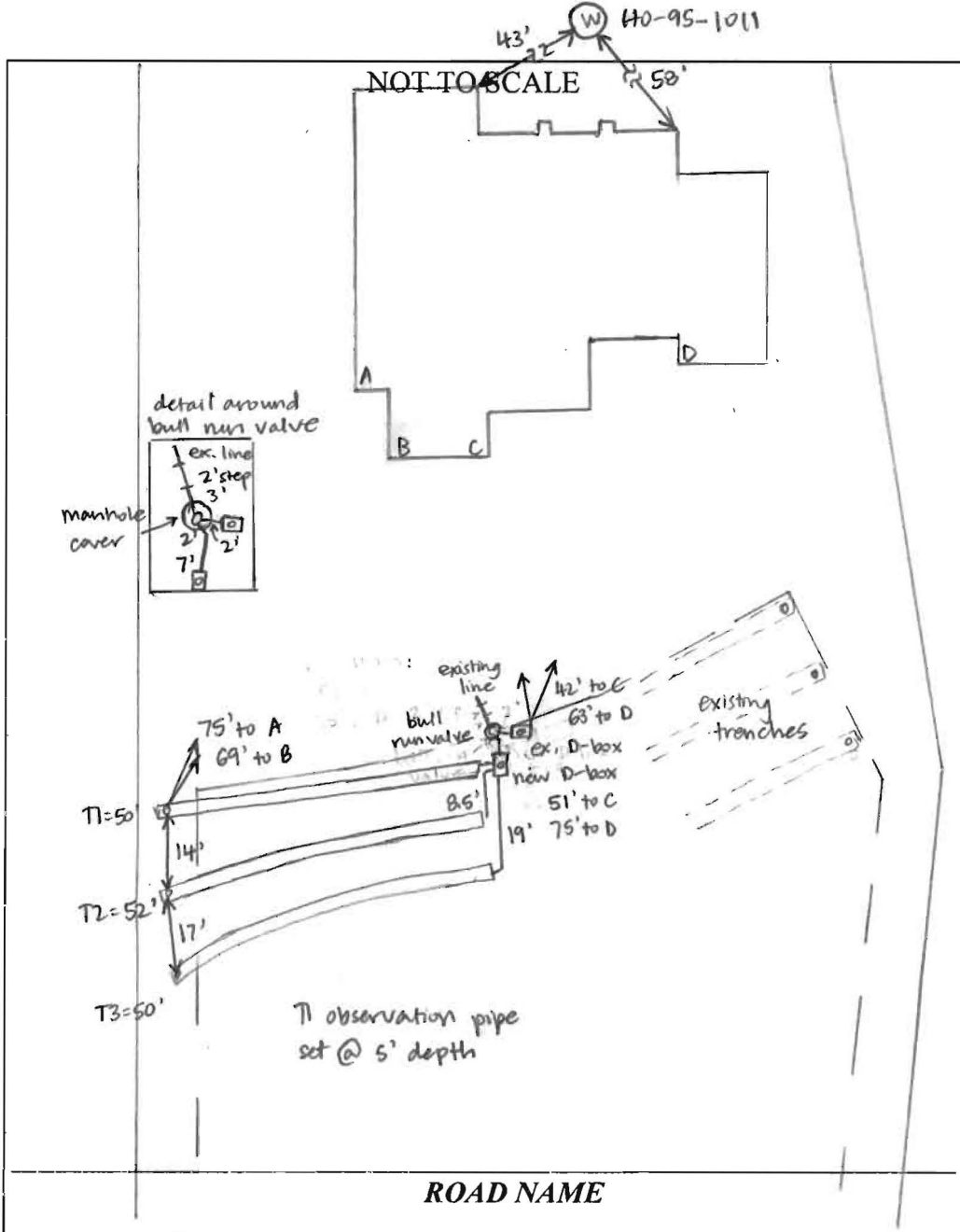

TRENCH/DRAINFIELD DATA		
WIDTH	INLET	BOTTOM
3'	3.5-4'	8'
NUMBER OF TRENCHES		3
TOTAL LENGTH		152'
ABSORPTION AREA		456' + SIDEWALL
DISTRIBUTION BOX LEVEL		YES
DISTRIBUTION BOX BAFFLE		YES
DISTRIBUTION BOX PORT		YES

SEPTIC TANK DATA	
SEPTIC TANK I LEVEL [Existing]	
MANUFACTURER	BAYSTAR
CAPACITY	2000 GAL
SEAM LOC	TOP
TANK LID DEPTH	2'
BAFFLES	YES
BAFFLE FILTER	NO
MANHOLE LOC	FRONT + REAR
6" PORT LOC	NONE
WATERTIGHT TEST	NO
SLOTTED	YES
DATE ON LID	
PUMP/SEPTIC TANK LEVEL	
MANUFACTURER	
CAPACITY	
SEAM LOC	
TANK LID DEPTH	
BAFFLES	
BAFFLE FILTER	
MANHOLE LOC	
6" PORT LOC	
WATERTIGHT TEST	
SLOTTED	
DATE ON LID	

PRE-CONSTRUCTION: 8/3/17 Met Dennis from DWM on site for layout. Shot contour and laid out 3x50' trenches. Starts are 11' center-to-center, ends are farther apart. Must use laser while digging trenches. (SC)

INSTALLATION: 8/3/17 Existing D-box uncovered, brick used as baffle fell over + may have been partly blocking T1 hole. Speed levelers of T2 + T3 look level. Dig test hole to 1.5' and no obvious restrictive layers deep. On site for digging of T1 - no laser used. I measured 8' depth every 10'. (SC) 8/3/17 T1 dug, using stone shooter to add #57 stone to T1. Inlet 3.5-4'. T3 dug, I measured 8' depth while digging. Stone added via shooter to T3 - 3.5' inlet. OK to cover T1, T3 not yet finished. (SC) 8/9/17 T2 dug, measured 8' bottom. Dennis waiting on stone for T3 + T2. Manhole riser installed over bull run valve. (SC) 8/10/17 T2 finished + left open for inspection. Dennis put some stone over cloth in all 3 trenches. Levelled speed levelers in D-box.

FINAL INSPECTOR Sarah Collins DATE OF APPROVAL 8/10/17



HOWARD COUNTY HEALTH DEPARTMENT

61814

DATE 8/3/17

PS

Received From

~~James~~ *James* *Mertson*

PHONE #

410 596-9623

For

Septic Repair - 13578

Successdennis edy

CASH

CHECK

NO.

One hundred sixty five

Dollars

\$

165 | 00

Received By

D. King

